

# THRASHER

THE THRASHER GROUP, INC.  
600 WHITE OAKS BLVD.  
BRIDGEPORT, WV 26330  
PHONE 304-624-4108

- NOTES ON SURVEY**
- COORDINATES SYSTEM IS UTM, NAD 83 DATUM, ZONE 17, U.S. FOOT AND WELL COORDINATES ESTABLISHED USING SURVEY GRADE GPS.
  - SURFACE AND ROYALTY OWNER INFORMATION AND THEIR BOUNDARIES SHOWN HEREON WERE PLOTTED FROM DEEDS AND/OR TAX PARCEL MAPS PROVIDED BY CLIENT AND FIELD LOCATIONS.
  - THIS PLAT DOES NOT REPRESENT A BOUNDARY SURVEY OF THE PARCELS SHOWN HEREON.
  - NO DWELLINGS AND BUILDINGS WITHIN 625 FEET OF PROPOSED OF CENTER OF PAD.
  - NO WATER WELLS OR DEVELOPED SPRINGS WITHIN 250 FEET OF PROPOSED WELL.
  - NO PERENNIAL STREAMS, LAKES, PONDS, RESERVOIRS OR WETLANDS WITHIN 100 FEET OF THE LIMITS OF DISTURBANCE.
  - NO NATURALLY PRODUCING TROUT STREAM WITHIN 300 FEET OF LIMITS OF DISTURBANCE.

TRACT	SURFACE OWNER (S) / ROYALTY OWNER (R)	TAX PARCEL	ACRES
1	SHAWN W. COUCH TRUST (S) / GEORGE W. COUCH (R)	3-L-4011000000000	121.56
2	MICHAEL J. MILLER AND PENELOPE T. MILLER (S/R)	3-L-4011700000000	139.51
3	EDWARD L & B W STUPAK (S/R)	3-L-4011800010000	23.60
4	JAMES W. LOEW & HELEN LOUISE LOEW (R)	3-L-4012000000000	198.35
5	HERBERT P. MINCH AND CAROL A. MINCH (S/R)	3-L-7000400000000	184.75
6	WAYNE L. WILHELM AND MARQUETTE B. WILHELM(S/R)	3-L-7001000000000	3.04
7	JAMES A. PARSONS AND CAROL L. PARSONS (S/R)	3-L-7001100000000	109.36
8	JOHN L. SMITH II AND JOAN MARIE SMITH A/K/A JOAN M. SMITH (S/R)	3-L-7004800000000	120.49

LINE	DESCRIPTION	DISTANCE	DESCRIPTION	MONUMENT
L1	N 65°26'55" E	55.99'	SHL TO 069-00105	EXISTING WELL HEAD
L2	N 39°49'15" W	46.71'	SHL TO 069-00072	EXISTING WELL HEAD
L3	S 75°24'23" W	1575.04'	SHL TO LANDMARK	IRF FOUND
L4	N 87°29'35" W	1693.07'	SHL TO LANDMARK	IRF FOUND
L5	S 50°13'24" W	1540.91'	SHL TO LP	LANDING POINT

**SURFACE HOLE LOCATION (SHL)**

UTM (NAD83, ZONE 17, METERS):  
NORTHING: 4,444,241.300  
EASTING: 535,031.840  
NORTHING: 4,444,241.297  
EASTING: 535,031.756

**LANDING POINT LOCATION (LPL)**

UTM (NAD83, ZONE 17, METERS):  
NORTHING: 4,443,868.008  
EASTING: 534,691.835  
NORTHING: 4,443,940.804  
EASTING: 534,670.790

**BOTTOM HOLE LOCATION (BHL)**

UTM (NAD83, ZONE 17, METERS):  
NORTHING: 4,441,330.604  
EASTING: 535,533.249  
NORTHING: 4,441,326.584  
EASTING: 535,534.095

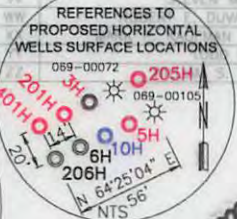
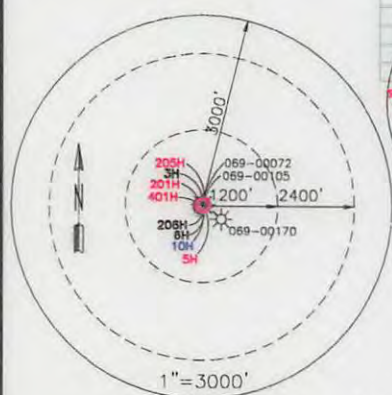

I, THE UNDERSIGNED, HEREBY CERTIFY THAT THIS PLAT IS CORRECT TO THE BEST OF MY KNOWLEDGE AND BELIEF AND SHOWS ALL THE INFORMATION REQUIRED BY LAW AND REGULATIONS ISSUED AND PRESCRIBED BY THE DEPARTMENT OF ENVIRONMENTAL PROTECTION.

P.S. 2270 *M.S. Wolf* 4/28/17



(+) DENOTES LOCATION OF WELL ON UNITED STATES TOPOGRAPHIC MAPS  
WVDEP  
OFFICE OF OIL & GAS  
601 57TH STREET  
CHARLESTON, WV 25034

MINIMUM DEGREE OF ACCURACY: 1/200  
PROVEN SURVEY SOURCE OF GRADE GPS ELEVATION: (NAVD 88, US FT)

COMPANY:	<b>SWN</b> Production Company, LLC	<b>SWN</b> Production Company, LLC
OPERATOR'S WELL #:	SHAWN COUCH OHI 206H	
API WELL #:	<b>47</b>	<b>069 00207</b>
	STATE	COUNTY PERMIT

WELL TYPE: OIL  WASTE DISPOSAL  PRODUCTION  DEEP  GAS  LIQUID INJECTION  STORAGE  SHALLOW

WATERSHED: WEIDMANS RUN ELEVATION: 1247

DISTRICT: LIBERTY COUNTY: OHIO QUADRANGLE: BETHANY

SURFACE OWNER: SHAWN W. COUCH TRUST ACREAGE: 121.56

OIL & GAS ROYALTY OWNER: GEORGE W. COUCH ACREAGE: 121.56

DRILL  DRILL DEEPER  REDRILL  FRACTURE OR STIMULATE  PLUG OFF OLD FORMATION  PERFORATE NEW FORMATION

CONVERT  PLUG & ABANDON  CLEAN OUT & REPLUG  OTHER CHANGE  (SPECIFY) AS-DRILLED

TARGET FORMATION: MARCELLUS ESTIMATED DEPTH: 6,177 TVD 15,750 TMD

WELL OPERATOR: SWN PRODUCTION COMPANY, LLC DESIGNATED AGENT: DEE SOUTHALL

ADDRESS: P.O. BOX 1300 ADDRESS: P.O. BOX 1300

CITY: JANE LEW STATE: WV ZIP CODE: 26378 CITY: JANE LEW STATE: WV ZIP CODE: 26378

**LEGEND:**

○ PROPOSED SURFACE HOLE / BOTTOM HOLE	--- LEASE BOUNDARY
☀ EXISTING / PRODUCING WELLHEAD	--- PROPOSED DHP
⊗ ABANDONED WELL	--- AS-DRILLED DHP
⊗ PLUGGED & ABANDONED WELL	--- ABANDONED DHP
△ CUT CONDUCTOR	

REVISIONS:	DATE: 04-28-2017
REVISIONS:	DRAWN BY: K. POTH
	SCALE: 1" = 2000'
	DRAWING NO: 050-5635
	WELL LOCATION PLAT