



320 O'Bryan Lane • Van Buren, AR 72956
Office: 479.474.7916 • Fax: 479.474.2450
Surveying • handa-inc.com

LINE	BEARING	DISTANCE	DESCRIPTION	MONUMENT
L1	N 85°25'11" W	423.91'	SHL TO LANDMARK	1/2" IRON PIPE
L2	S 37°27'06" W	641.56'	SHL TO LANDMARK	CONCRETE MONUMENT
L3	N 28°09'08" E	239.04'	SHL TO REF. PNT.	5/8" REBAR SET
L4	S 02°58'49" E	27.94'	SHL TO REF. PNT.	WILLIAM RODGERS OHI 3H WELL HEAD (069-00094)
LINE	BEARING	DISTANCE	CURVE LENGTH	DESCRIPTION
L5	N 54°01'17" E	2682.86'		SHL TO LP
L6	N 23°27'06" W	7196.99'		LP TO BHL

Latitude: 40°07'30"

Longitude: 80°30'00"

TRACT	SURFACE OWNER (S) / ROYALTY OWNER (R)	TAX PARCEL	ACRES
1	WILLIAM I. RODGERS & DOUGLAS WAYNE RODGERS (S/R)	3-L12-1	143.09
2	TUNNEL RIDGE, LLC. (S) LOIS MILLER (R) ALICE ANDERSON (R)	3-L12-4.6	60.00
3	RAYMOND MILLER C/O HILDA E. MILLER (S) HILDA E. MILLER (R)	3-L12-2	44.15
4	JEFFREY S. OCH & DANA R. OCH (S) HILDA E. MILLER (R)	3-L12-2.1	44.15
5	JEFFREY S. OCH & DANA R. OCH (S/R)	3-L9-18	49.80
6	THELMA A. MILLER LIFE ESTATE (S/R) CARL E. MILLER JR., REMAINDERMAN (S/R)	3-L9-15	54.91
7	THELMA A. MILLER LIFE ESTATE (S/R) CARL E. MILLER JR., REMAINDERMAN (S/R)	3-L9-15.3	42.38
8	THELMA A. MILLER LIFE ESTATE (S/R) CARL E. MILLER JR., REMAINDERMAN (S/R)	3-L9-15.4	60.91
9	DANIEL LEE HENRY & DIANE L. HENRY (S/R)	3-L9-6.5	30.28
10	DAVID E. MCNABB & BRENDA L. MCNABB (S/R)	3-L9-6.8	15.66
11	MICHAEL E. FISHER & SUSAN K. FISHER (S/R)	3-L9-6.6	29.65
12	ROONEY L. PLANTS & JESSICA L. PLANTS (S/R)	3-L9-2	112.08

NOTES ON SURVEY

- COORDINATE SYSTEM IS UTM, NAD 83 DATUM, ZONE 17, U.S. FOOT AND WELL COORDINATES ESTABLISHED USING SURVEY GRADE GPS.
- SURFACE AND ROYALTY OWNER INFORMATION AND THEIR BOUNDARIES SHOWN HEREON WERE PLOTTED FROM DEEDS AND/OR TAX PARCEL MAPS PROVIDED BY CLIENT AND/OR FIELD LOCATIONS.
- THIS PLAT DOES NOT REPRESENT A BOUNDARY SURVEY OF THE PARCELS SHOWN HEREON.
- NO OCCUPIED DWELLINGS AND AGRICULTURE BUILDINGS GREATER THAN 2500 SQ FT. WITHIN 625 FEET OF PROPOSED CENTER OF PAD.
- NO WATER WELLS OR DEVELOPED SPRINGS WITHIN 250 FEET OF PROPOSED WELL.
- NO PERENNIAL STREAMS, LAKES, PONDS, OR RESERVOIRS WITHIN 100 FEET OF THE LIMITS OF DISTURBANCE.
- NO NATURALLY PRODUCING TROUT STREAM WITHIN 300 FEET OF LIMITS OF DISTURBANCE.
- NO GROUND INTAKE OR PUBLIC WATER SUPPLY WITHIN 1000 FEET OF WELL PAD, LIMITS OF DISTURBANCE, E & S CONTROLS OR PUBLIC WATER SUPPLY.

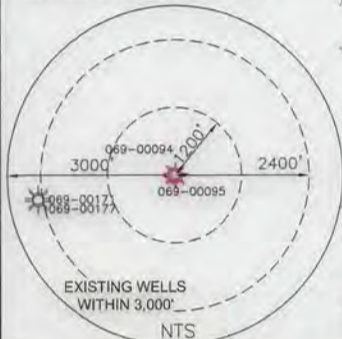

SURFACE HOLE LOCATION (SHL): UTM (NAD83, ZONE 17, METERS): NORTHING: 4,439,726.490 EASTING: 539,870.798
LANDING POINT LOCATION (LPL): UTM (NAD83, ZONE 17, METERS): NORTHING: 4,440,206.896 EASTING: 540,532.542
BOTTOM HOLE LOCATION (BHL): UTM (NAD83, ZONE 17, METERS): NORTHING: 4,442,219.342 EASTING: 539,659.529

I, THE UNDERSIGNED, HEREBY CERTIFY THAT THIS PLAT IS CORRECT TO THE BEST OF MY KNOWLEDGE AND BELIEF AND SHOWS ALL THE INFORMATION REQUIRED BY LAW AND REGULATIONS ISSUED AND PRESCRIBED BY THE DEPARTMENT OF ENVIRONMENTAL PROTECTION.

P.S. 2315

Samuel Earl Smith

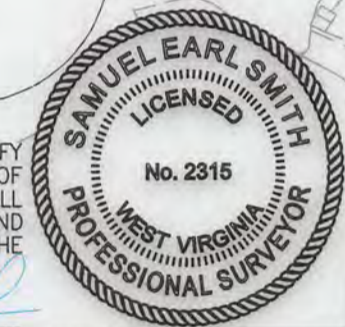

ADJOINING OWNER INFORMATION
(SEE ADJOINING OWNERS SHEET)

SWN PRODUCTION COMPANY, LLC
"WILLIAM RODGERS OHI 405H"
SURFACE HOLE
ELEV: 1280.0'

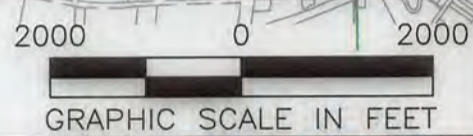

COMPANY: **SWN** Production Company, LLC

(+) DENOTES LOCATION OF WELL ON UNITED STATES TOPOGRAPHIC MAPS

WVDEP
OFFICE OF OIL & GAS
601 57TH STREET
CHARLESTON, WV 25034

MINIMUM DEGREE OF ACCURACY: 1/200

PROVEN SURVEY SOURCE OF GRADE GPS ELEVATION: (NAVD 88, US FT)

WILLIAM RODGERS OHI

OPERATOR'S WELL #: 405H

API WELL #: 47 STATE 69 COUNTY 00203H6A PERMIT

WELL TYPE: OIL WASTE DISPOSAL PRODUCTION DEEP GAS LIQUID INJECTION STORAGE SHALLOW

WATERSHED: WHEELING CREEK ELEVATION: 1280.0'

DISTRICT: LIBERTY COUNTY: OHIO QUADRANGLE: VALLEY GROVE, WV

SURFACE OWNER: WILLIAM I. RODGERS & DOUGLAS W. RODGERS ACREAGE: ±143.09

OIL & GAS ROYALTY OWNER: WILLIAM I. RODGERS & DOUGLAS W. RODGERS ACREAGE: ±143.09

DRILL DRILL DEEPER REDRILL FRACTURE OR STIMULATE PLUG OFF OLD FORMATION PERFORATE NEW FORMATION

CONVERT PLUG & ABANDON CLEAN OUT & REPLUG OTHER CHANGE (SPECIFY)

TARGET FORMATION: MARCELLUS ESTIMATED DEPTH: 6,552' TVD 14,731' TMD

WELL OPERATOR: SWN PRODUCTION COMPANY, LLC ADDRESS: P.O. BOX 1300 CITY: JANE LEW STATE: WV ZIP CODE: 26378

DESIGNATED AGENT: DEE SOUTHALL ADDRESS: P.O. BOX 1300 CITY: JANE LEW STATE: WV ZIP CODE: 26378

LEGEND:	REVISIONS:	DATE: 09-24-2015
○ PROPOSED SURFACE HOLE / BOTTOM HOLE	△ REVISED DIRECTIONAL PATH 08-17-2015	
⊙ EXISTING / PRODUCING WELLHEAD	△ ADDED ADJACENT PARCEL OWNERS, TAX MAP	DRAWN BY: C. BROWN
⊘ ABANDONED WELL	PARCEL NUMBER, & ACREAGE, 09-21-2015	SCALE: 1" = 2000'
⊙⊘ PLUGGED & ABANDONED WELL		DRAWING NO: 59095
△ CUT CONDUCTOR		WELL LOCATION PLAT

11/13/2015 64-00203



320 O'Bryan Lane • Van Buren, AR 72956
Office: 479.474.7916 • Fax: 479.474.2450
Surveying • handa-inc.com

GRID NORTH
UTM, NAD83 DATA ZONE 17, US FT

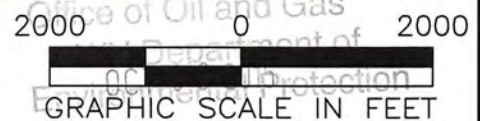
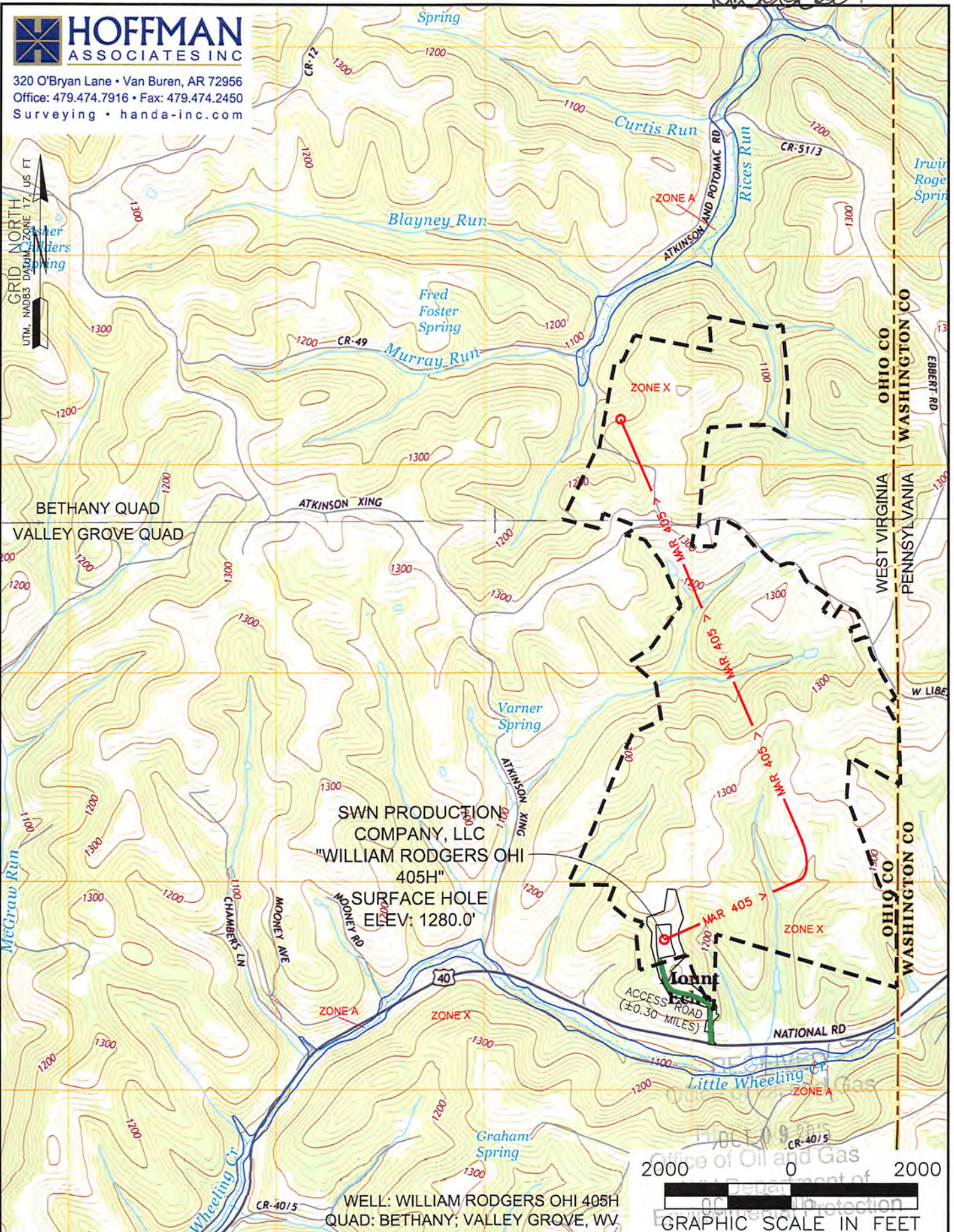

WELL: WILLIAM RODGERS OHI 405H
QUAD: BETHANY; VALLEY GROVE, WV

NAME AND DISTANCE TO THE NEAREST STREAM: UNNAMED TRIBUTARY OF LITTLE WHEELING CREEK ±0.14 MILES SOUTHEAST OF THE CENTER OF THE DRILL PAD.		STREAM CROSSING COORDINATES (NAD 83): NO NEW CROSSINGS.	COMPANY: SWN WV Department of Environmental Protection Production Company, LLC	SWN R ² -V ⁺ Production Company™
WELL RESTRICTIONS: WELL PAD, LOD, & E & S CONTROL FEATURES TO PERENNIAL STREAM, LAKE, POND, RESERVOIR OR WETLAND: >100 FEET WELL PAD, LOD, & E & S CONTROL FEATURES TO NATURALLY PRODUCING TROUT STREAM: >300 FEET WELL PAD, LOD, & E & S CONTROL FEATURES TO GROUNDWATER INTAKE OR PUBLIC WATER SUPPLY: >1000 FEET WELL SHL TO EXISTING WATER WELL OR DEVELOPED SPRING: >250 FEET CENTER OF PAD TO OCCUPIED DWELLING STRUCTURE: >625 FEET CENTER OF PAD TO AGRICULTURAL BUILDINGS LAGER THAN 2500 SQ FT: >625 FEET		OPERATOR'S WILLIAM RODGERS OHI	WELL #: 405H	LOCATION: LIBERTY DISTRICT, OHIO COUNTY, WEST VIRGINIA
FEMA FLOOD INFORMATION: BY GRAPHIC PLOTTING ONLY FEMA FIRM INCORPORATED AREA OF OHIO COUNTY, WEST VIRGINIA; MAP NUMBER 54069C0085D & 54069C0045D; EFFECTIVE DATE: JULY 17, 2006.		SURFACE HOLE LOCATION: GEOGRAPHIC (NAD83): LATITUDE: 40.106895° LONGITUDE: -80.532179°		11/13/2015
LEGEND: ● PROPOSED SURFACE HOLE / BOTTOM HOLE ⊙ EXISTING / PRODUCING WELLHEAD ⊗ ABANDONED WELL ⊗ CUT & ABANDONED WELL △ PLUGGED & ABANDONED WELL △ CUT CONDUCTOR		● EXISTING SPRING ⊙ EXISTING WATER WELL — ACCESS ROAD — ACCESS ROAD TO PREV. SITE — HIGHWAY/INTERSTATE — COUNTY ROAD	REVISIONS: △ REVISED DIRECTIONAL PATH 08-17-2015 △ ADDED ADJACENT PARCEL OWNERS, TAX MAP PARCEL NUMBER, & ACREAGE, 09-21-2015	DATE: 09-24-2015 DRAWN BY: C. BROWN SCALE: 1" = 2000' DRAWING NO: 59095 TOPOGRAPHIC MAP