



320 O'Bryan Lane • Van Buren, AR 72956
Office: 479.474.7916 • Fax: 479.474.2450
Surveying • handa-inc.com

| LINE | BEARING | DISTANCE | DESCRIPTION | MONUMENT |
|------|---------------|-------------|------------------|---|
| L1 | S 17°13'50" E | 303.39' | SHL TO LANDMARK | FOUND POST |
| L2 | N 50°55'23" E | 1081.58' | SHL TO LANDMARK | FOUND REBAR |
| L3 | N 38°23'38" W | 43.15' | SHL TO REF. PNT. | GLENN DIDRIKSEN OHI 1H WELLHEAD (069-00123) |
| L4 | N 02°27'40" W | 34.47' | SHL TO REF. PNT. | GLENN DIDRIKSEN OHI 8H WELLHEAD (069-00064) |
| LINE | CHORD BEARING | CHORD DIST. | CURVE LENGTH | DESCRIPTION |
| L5 | N 50°14'23" E | 1293.04' | | SHL TO LP |
| L6 | N 21°50'56" W | 6059.24' | | LP TO BHL |

Latitude: 40°07'30"

Longitude: 80°35'00"

| TRACT | SURFACE OWNER (S) ROYALTY OWNER (R) | TAX PARCEL | ACRES | LEASE NUMBER |
|-------|--|------------|--------|--------------|
| 1 | GLENN DIDRIKSEN (S) D&D FAST FOOD, INC. (R) | 3-L7-42 | 47.93 | |
| 2 | ROBERT WALTER & DONNA JEAN LASCH (S/R) | 3-L7-42 | 47.93 | 1-268336-000 |
| 3 | DENISE KNOUSE-SNYDER & STEPHEN P. SNYDER (S/R) | 3-L10-40 | 141.71 | 1-313594-001 |
| 4 | ROBERT HEYMAN TOMINACK (S/R) | 3-L7-42.1 | 22.32 | 1-384423-000 |
| 5 | THOMAS SCOTT TOMINACK (S/R) | 3-L7-39.3 | 8.945 | 1-385500-000 |
| 6 | CECIL R. TOMINACK & DONNA L. TOMINACK (S/R) | 3-L7-39.2 | 8.945 | 1-385499-000 |
| 7 | MARY LOU HUDNALL (S/R) | 3-L7-39.1 | 8.99 | 1-385488-000 |
| 8 | WANDA J. LARUE & PAUL J. LARUE (S/R) | 3-L7-40 | 18.431 | 1-385502-000 |
| 9 | ROBERT WALTER & DONNA JEAN LASCH (S/R) | 3-L7-38.8 | 7.57 | 1-385496-000 |
| 10 | ROBERT WALTER & DONNA JEAN LASCH (S/R) | 3-L7-16.1 | 19.00 | 1-313594-001 |
| 11 | ROBERT WALTER & DONNA JEAN LASCH (S/R) | 3-L7-16 | 60.397 | 1-313594-001 |
| 12 | ROBERT A. GREEN & KATHY L. GREEN (S/R) | 3-L7-3.1 | 5.00 | 1-385494-000 |
| 13 | MARY ELLEN BURKHART aka MARY ELLEN MOORE (S/R) | 3-L7-3.2 | 5.00 | 1-385495-001 |
| 14 | ROBERT J. GRIMES & LORINE S. GRIMES (S/R) | 3-L7-3 | 28.21 | 1-385493-001 |

| | | |
|-------------------|---------------|----------|
| SHL TO "S" #1 | N 58°39'57" E | 1476.66' |
| SHL TO "S" #2 | N 76°13'30" E | 1336.03' |
| SHL TO WATER WELL | N 82°55'35" E | 1337.20' |

GRID NORTH
UTM, NAD83 DATUM, ZONE 17, U.S. FT



NOTES ON SURVEY

- COORDINATE SYSTEM IS UTM, NAD 83 DATUM, ZONE 17, U.S. FOOT AND WELL COORDINATES ESTABLISHED USING SURVEY GRADE GPS.
- SURFACE AND ROYALTY OWNER INFORMATION AND THEIR BOUNDARIES SHOWN HEREON WERE PLOTTED FROM DEEDS AND/OR TAX PARCEL MAPS PROVIDED BY CLIENT AND/OR FIELD LOCATIONS.
- THIS PLAT DOES NOT REPRESENT A BOUNDARY SURVEY OF THE PARCELS SHOWN HEREON.
- NO OCCUPIED DWELLINGS AND AGRICULTURE BUILDINGS GREATER THAN 2500 SQ. FT. WITHIN 625 FEET OF PROPOSED CENTER OF PAD.
- NO WATER WELLS OR DEVELOPED SPRINGS WITHIN 250 FEET OF PROPOSED WELL.
- NO PERENNIAL STREAMS, LAKES, PONDS, OR RESERVOIRS WITHIN 100 FEET OF THE LIMITS OF DISTURBANCE.
- NO NATURALLY PRODUCING TROUT STREAM WITHIN 300 FEET OF LIMITS OF DISTURBANCE.
- NO GROUND INTAKE OR PUBLIC WATER SUPPLY WITHIN 1000 FEET OF WELL PAD, LIMITS OF DISTURBANCE, E & S CONTROLS OR PUBLIC WATER SUPPLY.

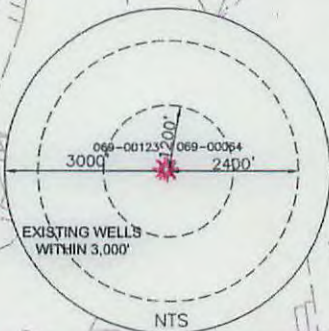

SWN PRODUCTION COMPANY, LLC
"GLENN DIDRIKSEN OHI 205H"
SURFACE HOLE
ELEV: 1,382.2'

| |
|--|
| SURFACE HOLE LOCATION (SHL): |
| UTM (NAD83, ZONE 17, METERS): NORTHING: 4,440,485.765 EASTING: 534,511.826 |
| LANDING POINT (LP): |
| UTM (NAD83, ZONE 17, METERS): NORTHING: 4,440,737.835 EASTING: 534,814.797 |
| BOTTOM HOLE LOCATION (BHL): |
| UTM (NAD83, ZONE 17, METERS): NORTHING: 4,442,452.033 EASTING: 534,127.472 |

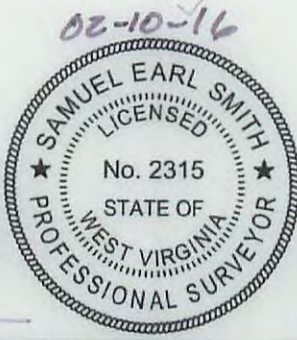
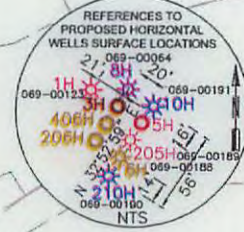

I, THE UNDERSIGNED, HEREBY CERTIFY THAT THIS PLAT IS CORRECT TO THE BEST OF MY KNOWLEDGE AND BELIEF AND SHOWS ALL THE INFORMATION REQUIRED BY LAW AND REGULATIONS ISSUED AND PRESCRIBED BY THE DEPARTMENT OF ENVIRONMENTAL PROTECTION.

P.S. 2315



(+) DENOTES LOCATION OF WELL ON UNITED STATES TOPOGRAPHIC MAPS
WVDEP
OFFICE OF OIL & GAS
601 57TH STREET
CHARLESTON, WV 25034

MINIMUM DEGREE OF ACCURACY: 1/200
PROVEN SURVEY SOURCE OF ELEVATION: GRADE GPS (NAVD 88, US FT)

COMPANY: **SWN** Production Company, LLC
SWN Production Company, LLC

GLENN DIDRIKSEN OHI
OPERATOR'S WELL #: 205H
API WELL #: 47 STATE 69 COUNTY 00189 PERMIT

WELL TYPE: OIL | WASTE DISPOSAL | PRODUCTION | DEEP | GAS | LIQUID INJECTION | STORAGE | SHALLOW
WATERSHED: LITTLE WHEELING CREEK | ELEVATION: 1,382.2'
DISTRICT: LIBERTY | COUNTY: OHIO | QUADRANGLE: VALLEY GROVE, WV
SURFACE OWNER: GLENN DIDRIKSEN | ACREAGE: ±47.93
OIL & GAS ROYALTY OWNER: D&D FAST FOOD, INC. | ACREAGE: ±47.93
DRILL | DRILL DEEPER | REDRILL | FRACTURE OR STIMULATE | PLUG OFF OLD FORMATION | PERFORATE NEW FORMATION
CONVERT | PLUG & ABANDON | CLEAN OUT & REPLUG | OTHER CHANGE (SPECIFY) AS-DRILLED
TARGET FORMATION: MARCELLUS | DEPTH: 6,425' TVD, 13,052' TMD

WELL OPERATOR: SWN PRODUCTION COMPANY, LLC | DESIGNATED AGENT: DEE SOUTHALL
ADDRESS: P.O. BOX 1300 | ADDRESS: P.O. BOX 1300
CITY: JANE LEW | STATE: WV | ZIP CODE: 26378 | CITY: JANE LEW | STATE: WV | ZIP CODE: 26378

| LEGEND: | REVISIONS: | DATE: |
|---------------------------------------|---|------------|
| ○ PROPOSED SURFACE HOLE / BOTTOM HOLE | △ REVISED SHL, LP, & BHL FOR ASDRILLED | 07-21-2015 |
| ⊙ EXISTING / PRODUCING WELLHEAD | — DIRECTIONAL PATH 11-16-2015 | |
| ⊗ ABANDONED WELL | △ REVISED ASDRILLED & PERMITTED DIRECTIONAL | |
| ⊗ CUT & ABANDONED WELL | — PATH COLOR, ADD LP COORDINATES 02-09-2016 | |
| △ CUT CONDUCTOR | | |
| — LEASE BOUNDARY | | |
| — AS-DRILLED PATH | | |
| — PERMITTED DIRECTIONAL PATH | | |
| — ABANDONED PATH | | |