

SOUTHWESTERN ENERGY

Location: Ohio County, WV
Field: Ohio
Facility: Glenn Didriksen OHI Pad 1

Slot: Slot #06
Well: Glenn Didriksen OHI 6H
Wellbore: Glenn Didriksen OHI 6H PWB

Plot reference wellpath is Glenn Didriksen OHI 6H PWB Ex-00	
True vertical depths are referenced to Rig on Slot #06 (RKB)	Grid System: NAD83 / UTM Zone 17 North, US feet
Measured depths are referenced to Rig on Slot #06 (RKB)	North Reference: Grid north
Rig on Slot #06 (RKB) to Mean Sea Level: 1408 feet	Scale: True distance
Mean Sea Level to Mud line (At Slot: Slot #06): -1382 feet	Depths are in feet
Coordinates are in feet referenced to Slot	Created by: edcaryar on 15/Apr/2015

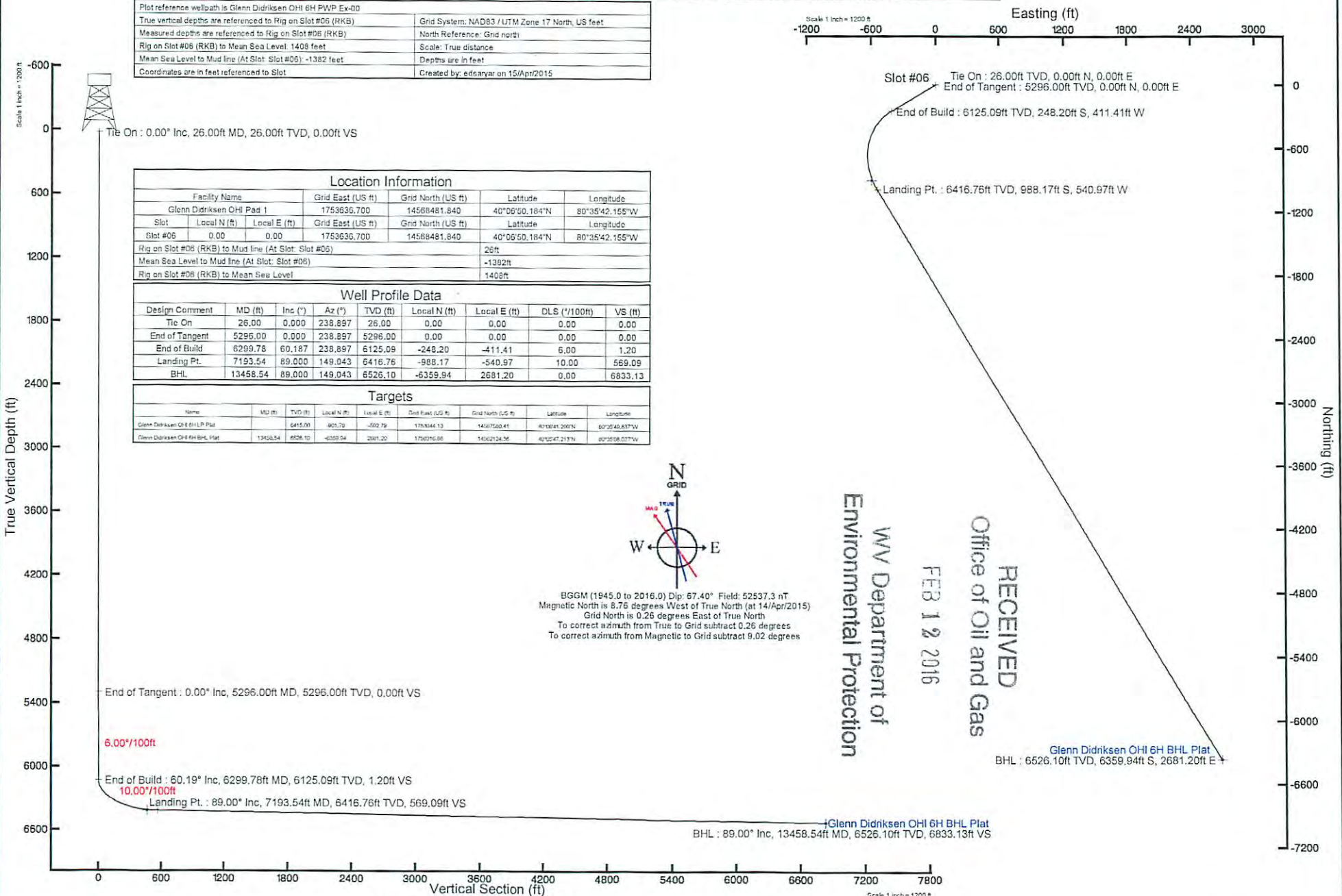

Location Information				
Facility Name	Grid East (US ft)	Grid North (US ft)	Latitude	Longitude
Glenn Didriksen OHI Pad 1	1753636.700	14568481.840	40°06'50.184"N	80°35'42.155"W
Slot	Local N (ft)	Local E (ft)	Grid East (US ft)	Grid North (US ft)
Slot #06	0.00	0.00	1753636.700	14568481.840
			40°06'50.184"N	80°35'42.155"W
Rig on Slot #06 (RKB) to Mud line (At Slot: Slot #06)			26ft	
Mean Sea Level to Mud line (At Slot: Slot #06)			-1382ft	
Rig on Slot #06 (RKB) to Mean Sea Level			1408ft	

Well Profile Data							
Design Comment	MD (ft)	Inc (°)	Az (°)	TVD (ft)	Local N (ft)	Local E (ft)	DLS (°/100ft)
Tie On	26.00	0.000	238.897	26.00	0.00	0.00	0.00
End of Tangent	5296.00	0.000	238.897	5296.00	0.00	0.00	0.00
End of Build	6299.78	60.187	238.897	6125.09	-248.20	-411.41	6.00
Landing Pt.	7193.54	89.000	149.043	6416.76	-988.17	-540.97	10.00
BHL	13458.54	89.000	149.043	6526.10	-6359.94	2681.20	0.00

Targets							
Name	MD (ft)	TVD (ft)	Local N (ft)	Local E (ft)	Grid East (US ft)	Grid North (US ft)	Latitude
Glenn Didriksen OHI 6H LP Plat	6415.00	601.79	-592.79	1793044.13	14567500.41	4010241.2007N	80°20'45.837"W
Glenn Didriksen OHI 6H BHL Plat	13458.54	6526.10	-6359.94	2681.20	14562124.36	4010247.2117N	80°35'08.077"W

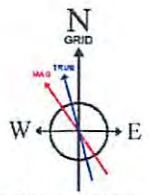

BGGM (1945.0 to 2016.0) Dip: 67.40° Field: 52537.3 nT
Magnetic North is 8.76 degrees West of True North (at 14/Apr/2015)
Grid North is 0.26 degrees East of True North
To correct azimuth from True to Grid subtract 0.26 degrees
To correct azimuth from Magnetic to Grid subtract 9.02 degrees

RECEIVED
 Office of Oil and Gas
 FEB 12 2016
 WV Department of
 Environmental Protection

Glenn Didriksen OHI 6H BHL Plat
BHL : 6526.10ft TVD, 6359.94ft S, 2681.20ft E

Glenn Didriksen OHI 6H BHL Plat
BHL : 89.00° Inc, 13458.54ft MD, 6526.10ft TVD, 6833.13ft VS

Azimuth 149.04° with reference 0.00 N, 0.00 E

Scale 1 inch = 1200 ft



Planned Wellpath Report

Glenn Didriksen OHI 6H PWP Ex-00

Page 1 of 7



REFERENCE WELLPATH IDENTIFICATION

Operator	SOUTHWESTERN ENERGY	Slot	Slot #06
Area	Ohio County, WV	Well	Glenn Didriksen OHI 6H
Field	Ohio	Wellbore	Glenn Didriksen OHI 6H PWB
Facility	Glenn Didriksen OHI Pad 1		

REPORT SETUP INFORMATION

Projection System	NAD83 / UTM Zone 17 North, US feet	Software System	WellArchitect® 4.0.1
North Reference	Grid	User	Edsaryar
Scale	0.999615	Report Generated	15/Apr/2015 at 07:42
Convergence at slot	0.26° East	Database/Source file	WellArchitectEasternDB/Glenn_Didriksen_OHI_6H_PWB.xml

WELLPATH LOCATION

	Local coordinates		Grid coordinates		Geographic coordinates	
	North[ft]	East[ft]	Easting[US ft]	Northing[US ft]	Latitude	Longitude
Slot Location	0.00	0.00	1753636.70	14568481.84	40°06'50.184"N	80°35'42.155"W
Facility Reference Pt			1753636.70	14568481.84	40°06'50.184"N	80°35'42.155"W
Field Reference Pt			0.00	0.00	0°00'00.000"	85°29'19.478"W

WELLPATH DATUM

Calculation method	Minimum curvature	Rig on Slot #06 (RKB) to Facility Vertical Datum	26.00ft
Horizontal Reference Pt	Slot	Rig on Slot #06 (RKB) to Mean Sea Level	1408.00ft
Vertical Reference Pt	Rig on Slot #06 (RKB)	Rig on Slot #06 (RKB) to Mud Line at Slot (Slot #06)	26.00ft
MD Reference Pt	Rig on Slot #06 (RKB)	Section Origin	N 0.00, E 0.00 ft
Field Vertical Reference	Mean Sea Level	Section Azimuth	149.04°

RECEIVED
Office of Oil and Gas
FEB 12 2016
WV Department of
Environmental Protection



FEB 11 2015
Planned Wellpath Report

Glenn Didriksen OHI 6H PWP Ex-00

WV Department of Environmental Protection Page 2 of 7

Environmental Protection



REFERENCE WELLPATH IDENTIFICATION			
Operator	SOUTHWESTERN ENERGY	Slot	Slot #06
Area	Ohio County, WV	Well	Glenn Didriksen OHI 6H
Field	Ohio	Wellbore	Glenn Didriksen OHI 6H PWB
Facility	Glenn Didriksen OHI Pad 1		

WELLPATH DATA (140 stations) † = interpolated/extrapolated station															
MD [ft]	Inclination [°]	Azimuth [°]	TVD [ft]	Vert Sect [ft]	North [ft]	East [ft]	Grid East [US ft]	Grid North [US ft]	Latitude	Longitude	Closure Dist [ft]	Closure Dir [°]	DLS [°/100ft]	Build Rate [°/100ft]	Turn Rate [°/100ft]
0.00†	0.000	238.897	0.00	0.00	0.00	0.00	1753636.70	14568481.84	40°06'50.184"N	80°35'42.155"W	0.00	0.000	0.00	0.00	0.00
26.00	0.000	238.897	26.00	0.00	0.00	0.00	1753636.70	14568481.84	40°06'50.184"N	80°35'42.155"W	0.00	0.000	0.00	0.00	0.00
126.00†	0.000	238.897	126.00	0.00	0.00	0.00	1753636.70	14568481.84	40°06'50.184"N	80°35'42.155"W	0.00	0.000	0.00	0.00	0.00
226.00†	0.000	238.897	226.00	0.00	0.00	0.00	1753636.70	14568481.84	40°06'50.184"N	80°35'42.155"W	0.00	0.000	0.00	0.00	0.00
326.00†	0.000	238.897	326.00	0.00	0.00	0.00	1753636.70	14568481.84	40°06'50.184"N	80°35'42.155"W	0.00	0.000	0.00	0.00	0.00
426.00†	0.000	238.897	426.00	0.00	0.00	0.00	1753636.70	14568481.84	40°06'50.184"N	80°35'42.155"W	0.00	0.000	0.00	0.00	0.00
526.00†	0.000	238.897	526.00	0.00	0.00	0.00	1753636.70	14568481.84	40°06'50.184"N	80°35'42.155"W	0.00	0.000	0.00	0.00	0.00
626.00†	0.000	238.897	626.00	0.00	0.00	0.00	1753636.70	14568481.84	40°06'50.184"N	80°35'42.155"W	0.00	0.000	0.00	0.00	0.00
726.00†	0.000	238.897	726.00	0.00	0.00	0.00	1753636.70	14568481.84	40°06'50.184"N	80°35'42.155"W	0.00	0.000	0.00	0.00	0.00
826.00†	0.000	238.897	826.00	0.00	0.00	0.00	1753636.70	14568481.84	40°06'50.184"N	80°35'42.155"W	0.00	0.000	0.00	0.00	0.00
926.00†	0.000	238.897	926.00	0.00	0.00	0.00	1753636.70	14568481.84	40°06'50.184"N	80°35'42.155"W	0.00	0.000	0.00	0.00	0.00
1026.00†	0.000	238.897	1026.00	0.00	0.00	0.00	1753636.70	14568481.84	40°06'50.184"N	80°35'42.155"W	0.00	0.000	0.00	0.00	0.00
1126.00†	0.000	238.897	1126.00	0.00	0.00	0.00	1753636.70	14568481.84	40°06'50.184"N	80°35'42.155"W	0.00	0.000	0.00	0.00	0.00
1226.00†	0.000	238.897	1226.00	0.00	0.00	0.00	1753636.70	14568481.84	40°06'50.184"N	80°35'42.155"W	0.00	0.000	0.00	0.00	0.00
1326.00†	0.000	238.897	1326.00	0.00	0.00	0.00	1753636.70	14568481.84	40°06'50.184"N	80°35'42.155"W	0.00	0.000	0.00	0.00	0.00
1426.00†	0.000	238.897	1426.00	0.00	0.00	0.00	1753636.70	14568481.84	40°06'50.184"N	80°35'42.155"W	0.00	0.000	0.00	0.00	0.00
1526.00†	0.000	238.897	1526.00	0.00	0.00	0.00	1753636.70	14568481.84	40°06'50.184"N	80°35'42.155"W	0.00	0.000	0.00	0.00	0.00
1626.00†	0.000	238.897	1626.00	0.00	0.00	0.00	1753636.70	14568481.84	40°06'50.184"N	80°35'42.155"W	0.00	0.000	0.00	0.00	0.00
1726.00†	0.000	238.897	1726.00	0.00	0.00	0.00	1753636.70	14568481.84	40°06'50.184"N	80°35'42.155"W	0.00	0.000	0.00	0.00	0.00
1826.00†	0.000	238.897	1826.00	0.00	0.00	0.00	1753636.70	14568481.84	40°06'50.184"N	80°35'42.155"W	0.00	0.000	0.00	0.00	0.00
1926.00†	0.000	238.897	1926.00	0.00	0.00	0.00	1753636.70	14568481.84	40°06'50.184"N	80°35'42.155"W	0.00	0.000	0.00	0.00	0.00
2026.00†	0.000	238.897	2026.00	0.00	0.00	0.00	1753636.70	14568481.84	40°06'50.184"N	80°35'42.155"W	0.00	0.000	0.00	0.00	0.00
2126.00†	0.000	238.897	2126.00	0.00	0.00	0.00	1753636.70	14568481.84	40°06'50.184"N	80°35'42.155"W	0.00	0.000	0.00	0.00	0.00
2226.00†	0.000	238.897	2226.00	0.00	0.00	0.00	1753636.70	14568481.84	40°06'50.184"N	80°35'42.155"W	0.00	0.000	0.00	0.00	0.00
2326.00†	0.000	238.897	2326.00	0.00	0.00	0.00	1753636.70	14568481.84	40°06'50.184"N	80°35'42.155"W	0.00	0.000	0.00	0.00	0.00
2426.00†	0.000	238.897	2426.00	0.00	0.00	0.00	1753636.70	14568481.84	40°06'50.184"N	80°35'42.155"W	0.00	0.000	0.00	0.00	0.00
2526.00†	0.000	238.897	2526.00	0.00	0.00	0.00	1753636.70	14568481.84	40°06'50.184"N	80°35'42.155"W	0.00	0.000	0.00	0.00	0.00
2626.00†	0.000	238.897	2626.00	0.00	0.00	0.00	1753636.70	14568481.84	40°06'50.184"N	80°35'42.155"W	0.00	0.000	0.00	0.00	0.00
2726.00†	0.000	238.897	2726.00	0.00	0.00	0.00	1753636.70	14568481.84	40°06'50.184"N	80°35'42.155"W	0.00	0.000	0.00	0.00	0.00
2826.00†	0.000	238.897	2826.00	0.00	0.00	0.00	1753636.70	14568481.84	40°06'50.184"N	80°35'42.155"W	0.00	0.000	0.00	0.00	0.00



Planned Wellpath Report
 RECEIVED Glenn Didriksen OHI 6H PWP Ex-00
 Office of Oil and Gas Page 3 of 7



REFERENCE WELLPATH IDENTIFICATION			
Operator	SOUTHWESTERN ENERGY	Slot	Slot #06
Area	Ohio County, WV	Well	Glenn Didriksen OHI 6H
Field	Ohio	Wellbore	Glenn Didriksen OHI 6H PWB
Facility	Glenn Didriksen OHI Pad 1		

WELLPATH DATA (140 stations) † = interpolated/extrapolated station															
MD [ft]	Inclination [°]	Azimuth [°]	TVD [ft]	Vert Sect [ft]	North [ft]	East [ft]	Grid East [US ft]	Grid North [US ft]	Latitude	Longitude	Closure Dist [ft]	Closure Dir [°]	DLS [°/100ft]	Build Rate [°/100ft]	Turn Rate [°/100ft]
2926.00†	0.000	238.897	2926.00	0.00	0.00	0.00	1753636.70	14568481.84	40°06'50.184"N	80°35'42.155"W	0.00	0.000	0.00	0.00	0.00
3026.00†	0.000	238.897	3026.00	0.00	0.00	0.00	1753636.70	14568481.84	40°06'50.184"N	80°35'42.155"W	0.00	0.000	0.00	0.00	0.00
3126.00†	0.000	238.897	3126.00	0.00	0.00	0.00	1753636.70	14568481.84	40°06'50.184"N	80°35'42.155"W	0.00	0.000	0.00	0.00	0.00
3226.00†	0.000	238.897	3226.00	0.00	0.00	0.00	1753636.70	14568481.84	40°06'50.184"N	80°35'42.155"W	0.00	0.000	0.00	0.00	0.00
3326.00†	0.000	238.897	3326.00	0.00	0.00	0.00	1753636.70	14568481.84	40°06'50.184"N	80°35'42.155"W	0.00	0.000	0.00	0.00	0.00
3426.00†	0.000	238.897	3426.00	0.00	0.00	0.00	1753636.70	14568481.84	40°06'50.184"N	80°35'42.155"W	0.00	0.000	0.00	0.00	0.00
3526.00†	0.000	238.897	3526.00	0.00	0.00	0.00	1753636.70	14568481.84	40°06'50.184"N	80°35'42.155"W	0.00	0.000	0.00	0.00	0.00
3626.00†	0.000	238.897	3626.00	0.00	0.00	0.00	1753636.70	14568481.84	40°06'50.184"N	80°35'42.155"W	0.00	0.000	0.00	0.00	0.00
3726.00†	0.000	238.897	3726.00	0.00	0.00	0.00	1753636.70	14568481.84	40°06'50.184"N	80°35'42.155"W	0.00	0.000	0.00	0.00	0.00
3826.00†	0.000	238.897	3826.00	0.00	0.00	0.00	1753636.70	14568481.84	40°06'50.184"N	80°35'42.155"W	0.00	0.000	0.00	0.00	0.00
3926.00†	0.000	238.897	3926.00	0.00	0.00	0.00	1753636.70	14568481.84	40°06'50.184"N	80°35'42.155"W	0.00	0.000	0.00	0.00	0.00
4026.00†	0.000	238.897	4026.00	0.00	0.00	0.00	1753636.70	14568481.84	40°06'50.184"N	80°35'42.155"W	0.00	0.000	0.00	0.00	0.00
4126.00†	0.000	238.897	4126.00	0.00	0.00	0.00	1753636.70	14568481.84	40°06'50.184"N	80°35'42.155"W	0.00	0.000	0.00	0.00	0.00
4226.00†	0.000	238.897	4226.00	0.00	0.00	0.00	1753636.70	14568481.84	40°06'50.184"N	80°35'42.155"W	0.00	0.000	0.00	0.00	0.00
4326.00†	0.000	238.897	4326.00	0.00	0.00	0.00	1753636.70	14568481.84	40°06'50.184"N	80°35'42.155"W	0.00	0.000	0.00	0.00	0.00
4426.00†	0.000	238.897	4426.00	0.00	0.00	0.00	1753636.70	14568481.84	40°06'50.184"N	80°35'42.155"W	0.00	0.000	0.00	0.00	0.00
4526.00†	0.000	238.897	4526.00	0.00	0.00	0.00	1753636.70	14568481.84	40°06'50.184"N	80°35'42.155"W	0.00	0.000	0.00	0.00	0.00
4626.00†	0.000	238.897	4626.00	0.00	0.00	0.00	1753636.70	14568481.84	40°06'50.184"N	80°35'42.155"W	0.00	0.000	0.00	0.00	0.00
4726.00†	0.000	238.897	4726.00	0.00	0.00	0.00	1753636.70	14568481.84	40°06'50.184"N	80°35'42.155"W	0.00	0.000	0.00	0.00	0.00
4826.00†	0.000	238.897	4826.00	0.00	0.00	0.00	1753636.70	14568481.84	40°06'50.184"N	80°35'42.155"W	0.00	0.000	0.00	0.00	0.00
4926.00†	0.000	238.897	4926.00	0.00	0.00	0.00	1753636.70	14568481.84	40°06'50.184"N	80°35'42.155"W	0.00	0.000	0.00	0.00	0.00
5026.00†	0.000	238.897	5026.00	0.00	0.00	0.00	1753636.70	14568481.84	40°06'50.184"N	80°35'42.155"W	0.00	0.000	0.00	0.00	0.00
5126.00†	0.000	238.897	5126.00	0.00	0.00	0.00	1753636.70	14568481.84	40°06'50.184"N	80°35'42.155"W	0.00	0.000	0.00	0.00	0.00
5226.00†	0.000	238.897	5226.00	0.00	0.00	0.00	1753636.70	14568481.84	40°06'50.184"N	80°35'42.155"W	0.00	0.000	0.00	0.00	0.00
5296.00	0.000	238.897	5296.00	0.00	0.00	0.00	1753636.70	14568481.84	40°06'50.184"N	80°35'42.155"W	0.00	0.000	0.00	0.00	0.00
5326.00†	1.799	238.897	5326.00	0.00	-0.24	-0.40	1753636.30	14568481.60	40°06'50.182"N	80°35'42.160"W	0.47	238.897	6.00	6.00	0.00
5426.00†	7.795	238.897	5425.60	0.02	-4.56	-7.56	1753629.14	14568477.28	40°06'50.139"N	80°35'42.252"W	8.83	238.897	6.00	6.00	0.00
5526.00†	13.791	238.897	5523.79	0.07	-14.23	-23.59	1753613.12	14568467.62	40°06'50.044"N	80°35'42.459"W	27.55	238.897	6.00	6.00	0.00
5626.00†	19.787	238.897	5619.48	0.14	-29.14	-48.31	1753588.41	14568452.71	40°06'49.898"N	80°35'42.778"W	56.42	238.897	6.00	6.00	0.00
5726.00†	25.783	238.897	5711.63	0.24	-49.14	-81.45	1753555.28	14568432.72	40°06'49.702"N	80°35'43.206"W	95.13	238.897	6.00	6.00	0.00



FEB 12 2016
Planned Wellpath Report
Glenn Didriksen OHI 6H PWP Ex-00
WV Department of Environmental Protection
Page 4 of 7



REFERENCE WELLPATH IDENTIFICATION				
Operator	SOUTHWESTERN ENERGY		Slot	Slot #06
Area	Ohio County, WV		Well	Glenn Didriksen OHI 6H
Field	Ohio		Wellbore	Glenn Didriksen OHI 6H PWB
Facility	Glenn Didriksen OHI Pad 1			

WELLPATH DATA (140 stations) † = interpolated/extrapolated station															
MD [ft]	Inclination [°]	Azimuth [°]	TVD [ft]	Vert Sect [ft]	North [ft]	East [ft]	Grid East [US ft]	Grid North [US ft]	Latitude	Longitude	Closure Dist [ft]	Closure Dir [°]	DLS [°/100ft]	Build Rate [°/100ft]	Turn Rate [°/100ft]
5826.00†	31.779	238.897	5799.24	0.36	-74.00	-122.66	1753514.09	14568407.87	40°06'49.458"N	80°35'43.738"W	143.25	238.897	6.00	6.00	0.00
5926.00†	37.775	238.897	5881.34	0.50	-103.45	-171.47	1753465.29	14568378.43	40°06'49.169"N	80°35'44.368"W	200.26	238.897	6.00	6.00	0.00
6026.00†	43.771	238.897	5957.04	0.66	-137.17	-227.37	1753409.42	14568344.72	40°06'48.839"N	80°35'45.089"W	265.54	238.897	6.00	6.00	0.00
6126.00†	49.767	238.897	6025.50	0.84	-174.79	-289.72	1753347.09	14568307.12	40°06'48.470"N	80°35'45.894"W	338.37	238.897	6.00	6.00	0.00
6226.00†	55.763	238.897	6085.98	1.04	-215.90	-357.86	1753278.97	14568266.02	40°06'48.067"N	80°35'46.773"W	417.95	238.897	6.00	6.00	0.00
6299.78	60.187	238.897	6125.09	1.20	-248.20	-411.41	1753225.45	14568233.73	40°06'47.750"N	80°35'47.465"W	480.48	238.897	6.00	6.00	0.00
6326.00†	60.185	235.875	6138.13	1.85	-260.46	-430.57	1753206.30	14568221.48	40°06'47.629"N	80°35'47.712"W	503.22	238.829	10.00	-0.01	-11.53
6426.00†	60.805	224.402	6187.51	15.31	-316.13	-497.19	1753139.70	14568165.84	40°06'47.082"N	80°35'48.573"W	589.18	237.551	10.00	0.62	-11.47
6526.00†	62.383	213.171	6235.20	45.75	-384.57	-552.11	1753084.80	14568097.42	40°06'46.408"N	80°35'49.283"W	672.84	235.141	10.00	1.58	-11.23
6626.00†	64.835	202.344	6279.75	92.24	-463.71	-593.66	1753043.27	14568018.31	40°06'45.628"N	80°35'49.823"W	753.30	232.006	10.00	2.45	-10.83
6726.00†	68.038	192.004	6319.81	153.37	-551.15	-620.58	1753016.36	14567930.91	40°06'44.765"N	80°35'50.174"W	829.99	228.391	10.00	3.20	-10.34
6826.00†	71.857	182.162	6354.17	227.29	-644.22	-632.04	1753004.90	14567837.87	40°06'43.846"N	80°35'50.327"W	902.50	224.453	10.00	3.82	-9.84
6926.00†	76.154	172.765	6381.77	311.74	-740.11	-627.71	1753009.23	14567742.02	40°06'42.898"N	80°35'50.277"W	970.45	220.302	10.00	4.30	-9.40
7026.00†	80.794	163.721	6401.79	404.16	-835.89	-607.71	1753029.22	14567646.28	40°06'41.951"N	80°35'50.025"W	1033.45	216.018	10.00	4.64	-9.04
7126.00†	85.654	154.917	6413.61	501.75	-928.65	-572.65	1753064.27	14567553.55	40°06'41.033"N	80°35'49.580"W	1091.02	211.660	10.00	4.86	-8.80
7193.54	89.000	149.043	6416.76†	569.09	-988.17	-540.97	1753095.94	14567494.05	40°06'40.443"N	80°35'49.175"W	1126.56	208.698	10.00	4.95	-8.70
7226.00†	89.000	149.043	6417.33	601.54	-1016.01	-524.28	1753112.63	14567466.23	40°06'40.167"N	80°35'48.962"W	1143.30	207.294	0.00	0.00	0.00
7326.00†	89.000	149.043	6419.07	701.53	-1101.75	-472.85	1753164.04	14567380.52	40°06'39.318"N	80°35'48.305"W	1198.93	203.228	0.00	0.00	0.00
7426.00†	89.000	149.043	6420.82	801.51	-1187.49	-421.41	1753215.45	14567294.81	40°06'38.468"N	80°35'47.648"W	1260.05	199.539	0.00	0.00	0.00
7526.00†	89.000	149.043	6422.56	901.50	-1273.24	-369.98	1753266.86	14567209.10	40°06'37.618"N	80°35'46.991"W	1325.90	196.203	0.00	0.00	0.00
7626.00†	89.000	149.043	6424.31	1001.48	-1358.98	-318.55	1753318.27	14567123.39	40°06'36.769"N	80°35'46.334"W	1395.81	193.192	0.00	0.00	0.00
7726.00†	89.000	149.043	6426.05	1101.47	-1444.72	-267.12	1753369.68	14567037.68	40°06'35.919"N	80°35'45.677"W	1469.21	190.475	0.00	0.00	0.00
7826.00†	89.000	149.043	6427.80	1201.45	-1530.46	-215.69	1753421.09	14566951.97	40°06'35.070"N	80°35'45.020"W	1545.59	188.022	0.00	0.00	0.00
7926.00†	89.000	149.043	6429.54	1301.44	-1616.21	-164.26	1753472.51	14566866.26	40°06'34.220"N	80°35'44.364"W	1624.53	185.803	0.00	0.00	0.00
8026.00†	89.000	149.043	6431.29	1401.42	-1701.95	-112.83	1753523.92	14566780.55	40°06'33.370"N	80°35'43.707"W	1705.68	183.793	0.00	0.00	0.00
8126.00†	89.000	149.043	6433.03	1501.41	-1787.69	-61.40	1753575.33	14566694.84	40°06'32.521"N	80°35'43.050"W	1788.74	181.967	0.00	0.00	0.00
8226.00†	89.000	149.043	6434.78	1601.39	-1873.43	-9.96	1753626.74	14566609.13	40°06'31.671"N	80°35'42.393"W	1873.46	180.305	0.00	0.00	0.00
8326.00†	89.000	149.043	6436.52	1701.38	-1959.18	41.47	1753678.15	14566523.42	40°06'30.822"N	80°35'41.736"W	1959.61	178.787	0.00	0.00	0.00
8426.00†	89.000	149.043	6438.27	1801.36	-2044.92	92.90	1753729.56	14566437.71	40°06'29.972"N	80°35'41.079"W	2047.03	177.399	0.00	0.00	0.00
8526.00†	89.000	149.043	6440.02	1901.35	-2130.66	144.33	1753780.97	14566352.00	40°06'29.122"N	80°35'40.422"W	2135.54	176.125	0.00	0.00	0.00



RECEIVED
Office of Oil and Gas

FEB 12 2016
Planned Wellpath Report
Glenn Didriksen OHI 6H PWP Ex-00

WV Department of
Environmental Protection



REFERENCE WELLPATH IDENTIFICATION					
Operator	SOUTHWESTERN ENERGY			Slot	Slot #06
Area	Ohio County, WV			Well	Glenn Didriksen OHI 6H
Field	Ohio			Wellbore	Glenn Didriksen OHI 6H PWB
Facility	Glenn Didriksen OHI Pad 1				

WELLPATH DATA (140 stations) † = interpolated/extrapolated station															
MD [ft]	Inclination [°]	Azimuth [°]	TVD [ft]	Vert Sect [ft]	North [ft]	East [ft]	Grid East [US ft]	Grid North [US ft]	Latitude	Longitude	Closure Dist [ft]	Closure Dir [°]	DLS [°/100ft]	Build Rate [°/100ft]	Turn Rate [°/100ft]
8626.00†	89.000	149.043	6441.76	2001.33	-2216.40	195.76	1753832.39	14566266.30	40°06'28.273"N	80°35'39.765"W	2225.03	174.953	0.00	0.00	0.00
8726.00†	89.000	149.043	6443.51	2101.32	-2302.15	247.19	1753883.80	14566180.59	40°06'27.423"N	80°35'39.108"W	2315.38	173.871	0.00	0.00	0.00
8826.00†	89.000	149.043	6445.25	2201.30	-2387.89	298.62	1753935.21	14566094.88	40°06'26.573"N	80°35'38.452"W	2406.49	172.872	0.00	0.00	0.00
8926.00†	89.000	149.043	6447.00	2301.29	-2473.63	350.05	1753986.62	14566009.17	40°06'25.724"N	80°35'37.795"W	2498.28	171.945	0.00	0.00	0.00
9026.00†	89.000	149.043	6448.74	2401.27	-2559.37	401.49	1754038.03	14565923.46	40°06'24.874"N	80°35'37.138"W	2590.67	171.085	0.00	0.00	0.00
9126.00†	89.000	149.043	6450.49	2501.26	-2645.12	452.92	1754089.44	14565837.75	40°06'24.024"N	80°35'36.481"W	2683.61	170.284	0.00	0.00	0.00
9226.00†	89.000	149.043	6452.23	2601.24	-2730.86	504.35	1754140.85	14565752.04	40°06'23.175"N	80°35'35.824"W	2777.04	169.536	0.00	0.00	0.00
9326.00†	89.000	149.043	6453.98	2701.23	-2816.60	555.78	1754192.26	14565666.33	40°06'22.325"N	80°35'35.167"W	2870.91	168.838	0.00	0.00	0.00
9426.00†	89.000	149.043	6455.72	2801.21	-2902.34	607.21	1754243.68	14565580.62	40°06'21.476"N	80°35'34.510"W	2965.18	168.183	0.00	0.00	0.00
9526.00†	89.000	149.043	6457.47	2901.19	-2988.09	658.64	1754295.09	14565494.91	40°06'20.626"N	80°35'33.854"W	3059.81	167.569	0.00	0.00	0.00
9626.00†	89.000	149.043	6459.21	3001.18	-3073.83	710.07	1754346.50	14565409.20	40°06'19.776"N	80°35'33.197"W	3154.78	166.992	0.00	0.00	0.00
9726.00†	89.000	149.043	6460.96	3101.16	-3159.57	761.50	1754397.91	14565323.49	40°06'18.927"N	80°35'32.540"W	3250.04	166.449	0.00	0.00	0.00
9826.00†	89.000	149.043	6462.70	3201.15	-3245.31	812.94	1754449.32	14565237.78	40°06'18.077"N	80°35'31.883"W	3345.58	165.937	0.00	0.00	0.00
9926.00†	89.000	149.043	6464.45	3301.13	-3331.06	864.37	1754500.73	14565152.07	40°06'17.227"N	80°35'31.226"W	3441.38	165.453	0.00	0.00	0.00
10026.00†	89.000	149.043	6466.19	3401.12	-3416.80	915.80	1754552.14	14565066.37	40°06'16.378"N	80°35'30.569"W	3537.40	164.996	0.00	0.00	0.00
10126.00†	89.000	149.043	6467.94	3501.10	-3502.54	967.23	1754603.56	14564980.66	40°06'15.528"N	80°35'29.913"W	3633.64	164.562	0.00	0.00	0.00
10226.00†	89.000	149.043	6469.68	3601.09	-3588.28	1018.66	1754654.97	14564894.95	40°06'14.678"N	80°35'29.256"W	3730.07	164.152	0.00	0.00	0.00
10326.00†	89.000	149.043	6471.43	3701.07	-3674.03	1070.09	1754706.38	14564809.24	40°06'13.829"N	80°35'28.599"W	3826.69	163.761	0.00	0.00	0.00
10426.00†	89.000	149.043	6473.17	3801.06	-3759.77	1121.52	1754757.79	14564723.53	40°06'12.979"N	80°35'27.942"W	3923.48	163.390	0.00	0.00	0.00
10526.00†	89.000	149.043	6474.92	3901.04	-3845.51	1172.95	1754809.20	14564637.82	40°06'12.129"N	80°35'27.285"W	4020.42	163.037	0.00	0.00	0.00
10626.00†	89.000	149.043	6476.67	4001.03	-3931.25	1224.39	1754860.61	14564552.11	40°06'11.280"N	80°35'26.629"W	4117.51	162.701	0.00	0.00	0.00
10726.00†	89.000	149.043	6478.41	4101.01	-4017.00	1275.82	1754912.02	14564466.40	40°06'10.430"N	80°35'25.972"W	4214.73	162.380	0.00	0.00	0.00
10826.00†	89.000	149.043	6480.16	4201.00	-4102.74	1327.25	1754963.43	14564380.69	40°06'09.581"N	80°35'25.315"W	4312.08	162.073	0.00	0.00	0.00
10926.00†	89.000	149.043	6481.90	4300.98	-4188.48	1378.68	1755014.85	14564294.98	40°06'08.731"N	80°35'24.658"W	4409.55	161.781	0.00	0.00	0.00
11026.00†	89.000	149.043	6483.65	4400.97	-4274.22	1430.11	1755066.26	14564209.27	40°06'07.881"N	80°35'24.002"W	4507.13	161.500	0.00	0.00	0.00
11126.00†	89.000	149.043	6485.39	4500.95	-4359.97	1481.54	1755117.67	14564123.56	40°06'07.032"N	80°35'23.345"W	4604.81	161.232	0.00	0.00	0.00
11226.00†	89.000	149.043	6487.14	4600.94	-4445.71	1532.97	1755169.08	14564037.85	40°06'06.182"N	80°35'22.688"W	4702.59	160.975	0.00	0.00	0.00
11326.00†	89.000	149.043	6488.88	4700.92	-4531.45	1584.41	1755220.49	14563952.14	40°06'05.332"N	80°35'22.031"W	4800.46	160.728	0.00	0.00	0.00
11426.00†	89.000	149.043	6490.63	4800.91	-4617.19	1635.84	1755271.90	14563866.43	40°06'04.483"N	80°35'21.375"W	4898.41	160.491	0.00	0.00	0.00
11526.00†	89.000	149.043	6492.37	4900.89	-4702.94	1687.27	1755323.31	14563780.73	40°06'03.633"N	80°35'20.718"W	4996.45	160.264	0.00	0.00	0.00



Planned Wellpath Report

Glenn Didriksen OHI 6H PWP Ex-00

Page 6 of 7



REFERENCE WELLPATH IDENTIFICATION

Operator	SOUTHWESTERN ENERGY	Slot	Slot #06
Area	Ohio County, WV	Well	Glenn Didriksen OHI 6H
Field	Ohio	Wellbore	Glenn Didriksen OHI 6H PWB
Facility	Glenn Didriksen OHI Pad 1		

WELLPATH DATA (140 stations) † = interpolated/extrapolated station

MD [ft]	Inclination [°]	Azimuth [°]	TVD [ft]	Vert Sect [ft]	North [ft]	East [ft]	Grid East [US ft]	Grid North [US ft]	Latitude	Longitude	Closure Dist [ft]	Closure Dir [°]	DLS [°/100ft]	Build Rate [°/100ft]	Turn Rate [°/100ft]
11626.00†	89.000	149.043	6494.12	5000.87	-4788.68	1738.70	1755374.73	14563695.02	40°06'02.783"N	80°35'20.061"W	5094.56	160.045	0.00	0.00	0.00
11726.00†	89.000	149.043	6495.86	5100.86	-4874.42	1790.13	1755426.14	14563609.31	40°06'01.934"N	80°35'19.404"W	5192.74	159.834	0.00	0.00	0.00
11826.00†	89.000	149.043	6497.61	5200.84	-4960.16	1841.56	1755477.55	14563523.60	40°06'01.084"N	80°35'18.748"W	5290.99	159.632	0.00	0.00	0.00
11926.00†	89.000	149.043	6499.35	5300.83	-5045.91	1892.99	1755528.96	14563437.89	40°06'00.234"N	80°35'18.091"W	5389.30	159.436	0.00	0.00	0.00
12026.00†	89.000	149.043	6501.10	5400.81	-5131.65	1944.42	1755580.37	14563352.18	40°05'59.385"N	80°35'17.434"W	5487.68	159.248	0.00	0.00	0.00
12126.00†	89.000	149.043	6502.84	5500.80	-5217.39	1995.86	1755631.78	14563266.47	40°05'58.535"N	80°35'16.777"W	5586.11	159.066	0.00	0.00	0.00
12226.00†	89.000	149.043	6504.59	5600.78	-5303.13	2047.29	1755683.19	14563180.76	40°05'57.685"N	80°35'16.121"W	5684.59	158.891	0.00	0.00	0.00
12326.00†	89.000	149.043	6506.33	5700.77	-5388.88	2098.72	1755734.60	14563095.05	40°05'56.836"N	80°35'15.464"W	5783.13	158.721	0.00	0.00	0.00
12426.00†	89.000	149.043	6508.08	5800.75	-5474.62	2150.15	1755786.02	14563009.34	40°05'55.986"N	80°35'14.807"W	5881.72	158.558	0.00	0.00	0.00
12526.00†	89.000	149.043	6509.82	5900.74	-5560.36	2201.58	1755837.43	14562923.63	40°05'55.136"N	80°35'14.151"W	5980.35	158.399	0.00	0.00	0.00
12626.00†	89.000	149.043	6511.57	6000.72	-5646.10	2253.01	1755888.84	14562837.92	40°05'54.287"N	80°35'13.494"W	6079.03	158.246	0.00	0.00	0.00
12726.00†	89.000	149.043	6513.32	6100.71	-5731.85	2304.44	1755940.25	14562752.21	40°05'53.437"N	80°35'12.837"W	6177.74	158.098	0.00	0.00	0.00
12826.00†	89.000	149.043	6515.06	6200.69	-5817.59	2355.87	1755991.66	14562666.50	40°05'52.587"N	80°35'12.181"W	6276.50	157.954	0.00	0.00	0.00
12926.00†	89.000	149.043	6516.81	6300.68	-5903.33	2407.31	1756043.07	14562580.80	40°05'51.738"N	80°35'11.524"W	6375.30	157.815	0.00	0.00	0.00
13026.00†	89.000	149.043	6518.55	6400.66	-5989.07	2458.74	1756094.48	14562495.09	40°05'50.888"N	80°35'10.867"W	6474.13	157.680	0.00	0.00	0.00
13126.00†	89.000	149.043	6520.30	6500.65	-6074.82	2510.17	1756145.90	14562409.38	40°05'50.038"N	80°35'10.210"W	6573.00	157.549	0.00	0.00	0.00
13226.00†	89.000	149.043	6522.04	6600.63	-6160.56	2561.60	1756197.31	14562323.67	40°05'49.189"N	80°35'09.554"W	6671.90	157.422	0.00	0.00	0.00
13326.00†	89.000	149.043	6523.79	6700.62	-6246.30	2613.03	1756248.72	14562237.96	40°05'48.339"N	80°35'08.897"W	6770.84	157.299	0.00	0.00	0.00
13426.00†	89.000	149.043	6525.53	6800.60	-6332.04	2664.46	1756300.13	14562152.25	40°05'47.489"N	80°35'08.240"W	6869.80	157.179	0.00	0.00	0.00
13458.54	89.000	149.043	6526.10 ²	6833.13	-6359.94	2681.20	1756316.86	14562124.36	40°05'47.213"N	80°35'08.027"W	6902.01	157.141	0.00	0.00	0.00

RECEIVED
Office of Oil and Gas

FEB 12 2016

WV Department of
Environmental Protection



Planned Wellpath Report

Glenn Didriksen OHI 6H PWP Ex-00

Page 7 of 7



REFERENCE WELLPATH IDENTIFICATION			
Operator	SOUTHWESTERN ENERGY	Slot	Slot #06
Area	Ohio County, WV	Well	Glenn Didriksen OHI 6H
Field	Ohio	Wellbore	Glenn Didriksen OHI 6H PWB
Facility	Glenn Didriksen OHI Pad 1		

TARGETS									
Name	MD [ft]	TVD [ft]	North [ft]	East [ft]	Grid East [US ft]	Grid North [US ft]	Latitude	Longitude	Shape
1) Glenn Didriksen OHI 6H LP Plat		6415.00	-901.78	-592.79	1753044.13	14567580.41	40°06'41.299"N	80°35'49.837"W	point
2) Glenn Didriksen OHI 6H BHL Plat	13458.54	6526.10	-6359.94	2681.20	1756316.86	14562124.36	40°05'47.213"N	80°35'08.027"W	point

RECEIVED
 Office of Oil and Gas
 FEB 12 2016
 WV Department of
 Environmental Protection