

SOUTHWESTERN ENERGY

Location: Ohio County, WV
 Field: Ohio
 Facility: Alice Edge OHI Pad A

Slot: Slot #210
 Well: Alice Edge OHI 210H
 Wellbore: Alice Edge OHI 210H PWB



Plot reference wellpath is Alice Edge OHI 210H PWB Ex-00	
The vertical depths are referenced to Rig on Slot #210 (RKB)	Grid System: NAD83 / Lambert West Virginia SP, Northern Zone (4201), US feet
Measured depths are referenced to Rig on Slot #210 (RKB)	North Reference: Grid north
Rig on Slot #210 (RKB) to Mean Sea Level: 1224 feet	Scale: True distance
Mean Sea Level to Mud line (At Slot: Slot #210): -1198 feet	Depths are in feet
Coordinates are in feet referenced to Slot	Created by: edslanger on 12/Mar/2015

Location Information						
Facility Name	Grid East (US ft)	Grid North (US ft)	Latitude	Longitude		
Alice Edge OHI Pad A	1703313.500	584454.300	40°05'59.339"N	80°33'57.970"W		
Slot	Local N (ft)	Local E (ft)	Grid East (US ft)	Grid North (US ft)	Latitude	Longitude
Slot #210	24.10	-14.30	1703299.200	584478.400	40°05'59.576"N	80°33'38.158"W
Rig on Slot #210 (RKB) to Mud line (At Slot: Slot #210)			26ft			
Mean Sea Level to Mud line (At Slot: Slot #210)			-1198ft			
Rig on Slot #210 (RKB) to Mean Sea Level			1224ft			

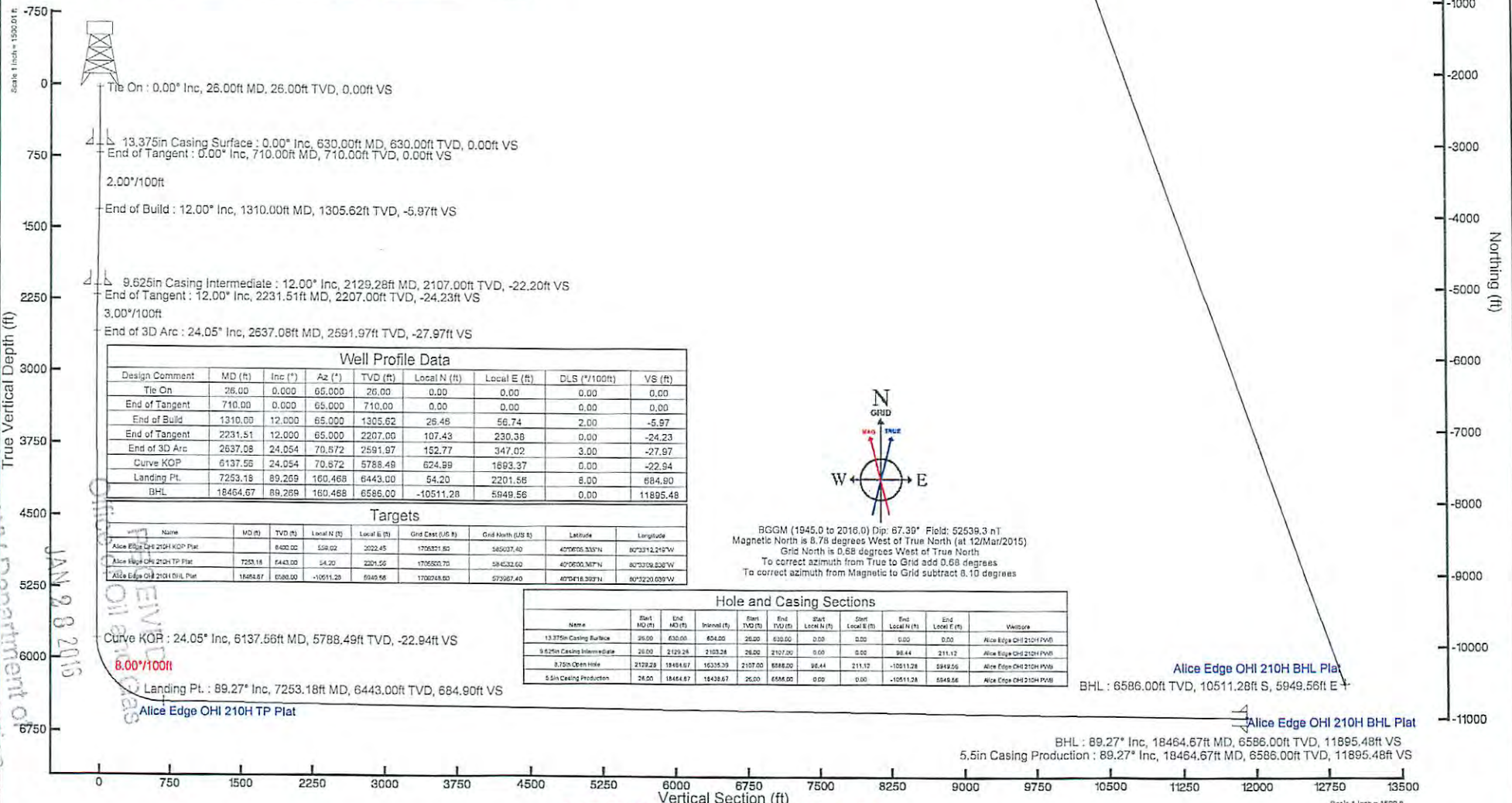
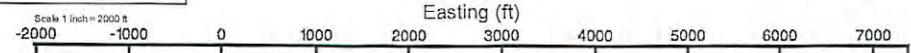

Curve KOP : 5788.49ft TVD, 624.99ft N, 1693.37ft E
 End of 3D Arc : 2591.97ft TVD, 152.77ft N, 347.02ft E
 End of Tangent : 2207.00ft TVD, 107.43ft N, 230.38ft E
 End of Build : 1305.62ft TVD, 26.46ft N, 56.74ft E
 End of Tangent : 710.00ft TVD, 0.00ft N, 0.00ft E
 Tie On : 26.00ft TVD, 0.00ft N, 0.00ft E

Well Profile Data							
Design Comment	MD (ft)	Inc (°)	Az (°)	TVD (ft)	Local N (ft)	Local E (ft)	DLS (°/100ft)
Tie On	26.00	0.000	65.000	26.00	0.00	0.00	0.00
End of Tangent	710.00	0.000	65.000	710.00	0.00	0.00	0.00
End of Build	1310.00	12.000	85.000	1305.62	26.46	56.74	2.00
End of Tangent	2231.51	12.000	65.000	2207.00	107.43	230.38	0.00
End of 3D Arc	2637.08	24.054	70.872	2591.97	152.77	347.02	3.00
Curve KOP	6137.56	24.054	70.872	5788.49	624.99	1693.37	0.00
Landing Pt.	7253.18	89.269	160.468	6443.00	54.20	2201.56	8.00
BHL	18464.67	89.269	160.468	6586.00	-10511.28	6949.56	0.00

Targets							
Name	MD (ft)	TVD (ft)	Local N (ft)	Local E (ft)	Grid East (US ft)	Grid North (US ft)	Latitude
Alice Edge OHI 210H KOP Plat	6400.00	508.02	2022.45	179831.80	585037.60	429705.3357N	80°39'12.2167W
Alice Edge OHI 210H TP Plat	7253.18	643.00	54.00	2201.56	1705500.70	594332.60	40°06'00.3877N
Alice Edge OHI 210H BHL Plat	18464.67	6586.00	-10511.28	6949.56	1703298.80	573267.40	40°04'18.3897N

Hole and Casing Sections										
Name	Start MD (ft)	End MD (ft)	Interval (ft)	Start TVD (ft)	End TVD (ft)	Start Local N (ft)	Start Local E (ft)	End Local N (ft)	End Local E (ft)	Wellbore
13.375in Casing Surface	39.00	630.00	654.00	26.00	630.00	0.00	0.00	0.00	0.00	Alice Edge OHI 210H PWB
9.625in Casing Intermediate	20.00	2129.24	2103.24	26.00	2107.00	0.00	0.00	98.44	211.12	Alice Edge OHI 210H PWB
8.75in Open Hole	2129.24	18464.67	16335.43	2107.00	6586.00	98.44	211.12	-10511.28	6949.56	Alice Edge OHI 210H PWB
5.5in Casing Production	26.00	18464.67	18438.67	26.00	6586.00	0.00	0.00	-10511.28	6949.56	Alice Edge OHI 210H PWB



BGGM (1945.0 to 2016.0) Dip: 87.39° Field: 52539.3 nT
 Magnetic North is 8.78 degrees West of True North (at 12/Mar/2015)
 Grid North is 0.68 degrees West of True North
 To correct azimuth from True to Grid add 0.68 degrees
 To correct azimuth from Magnetic to Grid subtract 8.10 degrees

Azimuth 160.47° with reference 0.00 N, 0.00 E

Scale 1 inch = 1500 ft

JAN 28 2015

Planned Wellpath Report

Alice Edge OHI 210H PWP Ex-00

Page 1 of 9



REFERENCE WELLPATH IDENTIFICATION			
Operator	SOUTHWESTERN ENERGY	Slot	Slot #210
Area	Ohio County, WV	Well	Alice Edge OHI 210H
Field	Ohio	Wellbore	Alice Edge OHI 210H PWB
Facility	Alice Edge OHI Pad A		

REPORT SETUP INFORMATION			
Projection System	NAD27 / Lambert West Virginia SP, Northern Zone (4701), US feet	Software System	WellArchitect® 4.0.1
North Reference	Grid	User	Edsaryar
Scale	0.999975	Report Generated	12/Mar/2015 at 18:37
Convergence at slot	0.68° West	Database/Source file	WellArchitectEasternDB/Alice_Edge_OHI_210H_PWB.xml

WELLPATH LOCATION						
	Local coordinates		Grid coordinates		Geographic coordinates	
	North[ft]	East[ft]	Easting[US ft]	Northing[US ft]	Latitude	Longitude
Slot Location	24.10	-14.30	1703299.20	584478.40	40°05'59.576"N	80°33'38.158"W
Facility Reference Pt			1703313.50	584454.30	40°05'59.339"N	80°33'37.970"W
Field Reference Pt			609601.22	0.00	38°23'48.753"N	84°21'09.765"W

WELLPATH DATUM			
Calculation method	Minimum curvature	Rig on Slot #210 (RKB) to Facility Vertical Datum	26.00ft
Horizontal Reference Pt	Slot	Rig on Slot #210 (RKB) to Mean Sea Level	1224.00ft
Vertical Reference Pt	Rig on Slot #210 (RKB)	Rig on Slot #210 (RKB) to Mud Line at Slot (Slot #210)	26.00ft
MD Reference Pt	Rig on Slot #210 (RKB)	Section Origin	N 0.00, E 0.00 ft
Field Vertical Reference	Mean Sea Level	Section Azimuth	160.47°

RECEIVED
 Office of Oil and Gas
 JAN 29 2015
 WV Department of
 Environmental Protection

Planned Wellpath Report

Alice Edge OHI 210H PWP Ex-00

Page 2 of 9



REFERENCE WELLPATH IDENTIFICATION

Operator	SOUTHWESTERN ENERGY	Slot	Slot #210
Area	Ohio County, WV	Well	Alice Edge OHI 210H
Field	Ohio	Wellbore	Alice Edge OHI 210H PWB
Facility	Alice Edge OHI Pad A		

WELLPATH DATA (193 stations) † = interpolated/extrapolated station

MD [ft]	Inclination [°]	Azimuth [°]	TVD [ft]	Vert Sect [ft]	North [ft]	East [ft]	Grid East [US ft]	Grid North [US ft]	Latitude	Longitude	Closure Dist [ft]	Closure Dir [°]	DLS [°/100ft]	Build Rate [°/100ft]	Turn Rate [°/100ft]
0.00†	0.000	65.000	0.00	0.00	0.00	0.00	1703299.20	584478.40	40°05'59.576"N	80°33'38.158"W	0.00	0.000	0.00	0.00	0.00
26.00	0.000	65.000	26.00	0.00	0.00	0.00	1703299.20	584478.40	40°05'59.576"N	80°33'38.158"W	0.00	0.000	0.00	0.00	0.00
126.00†	0.000	65.000	126.00	0.00	0.00	0.00	1703299.20	584478.40	40°05'59.576"N	80°33'38.158"W	0.00	0.000	0.00	0.00	0.00
226.00†	0.000	65.000	226.00	0.00	0.00	0.00	1703299.20	584478.40	40°05'59.576"N	80°33'38.158"W	0.00	0.000	0.00	0.00	0.00
326.00†	0.000	65.000	326.00	0.00	0.00	0.00	1703299.20	584478.40	40°05'59.576"N	80°33'38.158"W	0.00	0.000	0.00	0.00	0.00
426.00†	0.000	65.000	426.00	0.00	0.00	0.00	1703299.20	584478.40	40°05'59.576"N	80°33'38.158"W	0.00	0.000	0.00	0.00	0.00
526.00†	0.000	65.000	526.00	0.00	0.00	0.00	1703299.20	584478.40	40°05'59.576"N	80°33'38.158"W	0.00	0.000	0.00	0.00	0.00
626.00†	0.000	65.000	626.00	0.00	0.00	0.00	1703299.20	584478.40	40°05'59.576"N	80°33'38.158"W	0.00	0.000	0.00	0.00	0.00
710.00	0.000	65.000	710.00	0.00	0.00	0.00	1703299.20	584478.40	40°05'59.576"N	80°33'38.158"W	0.00	0.000	0.00	0.00	0.00
726.00†	0.320	65.000	726.00	0.00	0.02	0.04	1703299.24	584478.42	40°05'59.576"N	80°33'38.157"W	0.04	65.000	2.00	2.00	0.00
826.00†	2.320	65.000	825.97	-0.22	0.99	2.13	1703301.33	584479.39	40°05'59.586"N	80°33'38.131"W	2.35	65.000	2.00	2.00	0.00
926.00†	4.320	65.000	925.80	-0.78	3.44	7.38	1703306.58	584481.84	40°05'59.611"N	80°33'38.063"W	8.14	65.000	2.00	2.00	0.00
1026.00†	6.320	65.000	1025.36	-1.66	7.36	15.78	1703314.98	584485.76	40°05'59.650"N	80°33'37.956"W	17.41	65.000	2.00	2.00	0.00
1126.00†	8.320	65.000	1124.54	-2.87	12.74	27.33	1703326.53	584491.14	40°05'59.705"N	80°33'37.808"W	30.15	65.000	2.00	2.00	0.00
1226.00†	10.320	65.000	1223.21	-4.42	19.59	42.00	1703341.20	584497.99	40°05'59.774"N	80°33'37.620"W	46.34	65.000	2.00	2.00	0.00
1310.00	12.000	65.000	1305.62	-5.97	26.46	56.74	1703355.94	584504.86	40°05'59.844"N	80°33'37.432"W	62.60	65.000	2.00	2.00	0.00
1326.00†	12.000	65.000	1321.27	-6.28	27.86	59.75	1703358.95	584506.26	40°05'59.858"N	80°33'37.393"W	65.93	65.000	0.00	0.00	0.00
1426.00†	12.000	65.000	1419.09	-8.27	36.65	78.60	1703377.79	584515.05	40°05'59.947"N	80°33'37.152"W	86.72	65.000	0.00	0.00	0.00
1526.00†	12.000	65.000	1516.90	-10.25	45.44	97.44	1703396.64	584523.84	40°06'00.036"N	80°33'36.911"W	107.51	65.000	0.00	0.00	0.00
1626.00†	12.000	65.000	1614.72	-12.23	54.22	116.28	1703415.48	584532.62	40°06'00.125"N	80°33'36.670"W	128.30	65.000	0.00	0.00	0.00
1726.00†	12.000	65.000	1712.53	-14.21	63.01	135.12	1703434.32	584541.41	40°06'00.214"N	80°33'36.429"W	149.09	65.000	0.00	0.00	0.00
1826.00†	12.000	65.000	1810.35	-16.19	71.80	153.97	1703453.16	584550.19	40°06'00.303"N	80°33'36.188"W	169.88	65.000	0.00	0.00	0.00
1926.00†	12.000	65.000	1908.16	-18.18	80.58	172.81	1703472.01	584558.98	40°06'00.392"N	80°33'35.946"W	190.68	65.000	0.00	0.00	0.00
2026.00†	12.000	65.000	2005.98	-20.16	89.37	191.65	1703490.85	584567.77	40°06'00.481"N	80°33'35.705"W	211.47	65.000	0.00	0.00	0.00
2126.00†	12.000	65.000	2103.79	-22.14	98.16	210.50	1703509.69	584576.55	40°06'00.570"N	80°33'35.464"W	232.26	65.000	0.00	0.00	0.00
2226.00†	12.000	65.000	2201.61	-24.12	106.94	229.34	1703528.53	584585.34	40°06'00.659"N	80°33'35.223"W	253.05	65.000	0.00	0.00	0.00
2231.51	12.000	65.000	2207.00	-24.23	107.43	230.38	1703529.57	584585.82	40°06'00.664"N	80°33'35.210"W	254.20	65.000	0.00	0.00	0.00
2326.00†	14.792	67.122	2298.91	-25.87	116.27	250.40	1703549.59	584594.67	40°06'00.754"N	80°33'34.954"W	276.08	65.093	3.00	2.96	2.25
2426.00†	17.762	68.652	2394.89	-27.10	126.79	276.37	1703575.56	584605.18	40°06'00.861"N	80°33'34.621"W	304.07	65.356	3.00	2.97	1.53
2526.00†	20.740	69.755	2489.29	-27.81	138.47	307.20	1703606.39	584616.87	40°06'00.980"N	80°33'34.226"W	336.96	65.736	3.00	2.98	1.10

Section of

Planned Wellpath Report

Alice Edge OHI 210H PWP Ex-00

Page 3 of 9



REFERENCE WELLPATH IDENTIFICATION			
Operator	SOUTHWESTERN ENERGY		Slot #210
Area	Ohio County, WV		Alice Edge OHI 210H
Field	Ohio		Alice Edge OHI 210H PWB
Facility	Alice Edge OHI Pad A		

WELLPATH DATA (193 stations) † = interpolated/extrapolated station															
MD [ft]	Inclination [°]	Azimuth [°]	TVD [ft]	Vert Sect [ft]	North [ft]	East [ft]	Grid East [US ft]	Grid North [US ft]	Latitude	Longitude	Closure Dist [ft]	Closure Dir [°]	DLS [°/100ft]	Build Rate [°/100ft]	Turn Rate [°/100ft]
2626.00†	23.723	70.592	2581.84	-27.99	151.28	342.79	1703641.98	584629.68	40°06'01.111"N	80°33'33.770"W	374.69	66.187	3.00	2.98	0.84
2637.08	24.054	70.672	2591.97	-27.97	152.77	347.02	1703646.21	584631.17	40°06'01.126"N	80°33'33.716"W	379.16	66.239	3.00	2.99	0.73
2726.00†	24.054	70.672	2673.17	-27.84	164.77	381.22	1703680.41	584643.16	40°06'01.248"N	80°33'33.278"W	415.31	66.626	0.00	0.00	0.00
2826.00†	24.054	70.672	2764.49	-27.70	178.26	419.69	1703718.87	584656.65	40°06'01.386"N	80°33'32.785"W	455.97	66.987	0.00	0.00	0.00
2926.00†	24.054	70.672	2855.81	-27.56	191.75	458.15	1703757.34	584670.14	40°06'01.524"N	80°33'32.292"W	496.66	67.289	0.00	0.00	0.00
3026.00†	24.054	70.672	2947.12	-27.41	205.24	496.61	1703795.80	584683.63	40°06'01.662"N	80°33'31.799"W	537.35	67.546	0.00	0.00	0.00
3126.00†	24.054	70.672	3038.44	-27.27	218.73	535.07	1703834.26	584697.12	40°06'01.799"N	80°33'31.306"W	578.05	67.766	0.00	0.00	0.00
3226.00†	24.054	70.672	3129.75	-27.13	232.22	573.53	1703872.72	584710.61	40°06'01.937"N	80°33'30.813"W	618.76	67.957	0.00	0.00	0.00
3326.00†	24.054	70.672	3221.07	-26.98	245.71	612.00	1703911.18	584724.10	40°06'02.075"N	80°33'30.320"W	659.48	68.125	0.00	0.00	0.00
3426.00†	24.054	70.672	3312.39	-26.84	259.20	650.46	1703949.64	584737.59	40°06'02.213"N	80°33'29.828"W	700.20	68.273	0.00	0.00	0.00
3526.00†	24.054	70.672	3403.70	-26.69	272.69	688.92	1703988.10	584751.08	40°06'02.351"N	80°33'29.335"W	740.92	68.405	0.00	0.00	0.00
3626.00†	24.054	70.672	3495.02	-26.55	286.18	727.38	1704026.56	584764.57	40°06'02.488"N	80°33'28.842"W	781.65	68.523	0.00	0.00	0.00
3726.00†	24.054	70.672	3586.34	-26.41	299.67	765.84	1704065.02	584778.06	40°06'02.626"N	80°33'28.349"W	822.38	68.630	0.00	0.00	0.00
3826.00†	24.054	70.672	3677.65	-26.26	313.16	804.30	1704103.48	584791.55	40°06'02.764"N	80°33'27.856"W	863.12	68.726	0.00	0.00	0.00
3926.00†	24.054	70.672	3768.97	-26.12	326.65	842.77	1704141.94	584805.04	40°06'02.902"N	80°33'27.363"W	903.86	68.814	0.00	0.00	0.00
4026.00†	24.054	70.672	3860.29	-25.97	340.14	881.23	1704180.40	584818.53	40°06'03.039"N	80°33'26.870"W	944.59	68.894	0.00	0.00	0.00
4126.00†	24.054	70.672	3951.60	-25.83	353.63	919.69	1704218.86	584832.02	40°06'03.177"N	80°33'26.378"W	985.33	68.968	0.00	0.00	0.00
4226.00†	24.054	70.672	4042.92	-25.69	367.12	958.15	1704257.33	584845.51	40°06'03.315"N	80°33'25.885"W	1026.08	69.035	0.00	0.00	0.00
4326.00†	24.054	70.672	4134.24	-25.54	380.61	996.61	1704295.79	584859.00	40°06'03.453"N	80°33'25.392"W	1066.82	69.098	0.00	0.00	0.00
4426.00†	24.054	70.672	4225.55	-25.40	394.10	1035.08	1704334.25	584872.49	40°06'03.591"N	80°33'24.899"W	1107.56	69.156	0.00	0.00	0.00
4526.00†	24.054	70.672	4316.87	-25.26	407.59	1073.54	1704372.71	584885.98	40°06'03.728"N	80°33'24.406"W	1148.31	69.210	0.00	0.00	0.00
4626.00†	24.054	70.672	4408.19	-25.11	421.08	1112.00	1704411.17	584899.47	40°06'03.866"N	80°33'23.913"W	1189.05	69.260	0.00	0.00	0.00
4726.00†	24.054	70.672	4499.50	-24.97	434.57	1150.46	1704449.63	584912.96	40°06'04.004"N	80°33'23.420"W	1229.80	69.307	0.00	0.00	0.00
4826.00†	24.054	70.672	4590.82	-24.82	448.06	1188.92	1704488.09	584926.45	40°06'04.142"N	80°33'22.928"W	1270.55	69.350	0.00	0.00	0.00
4926.00†	24.054	70.672	4682.14	-24.68	461.55	1227.38	1704526.55	584939.94	40°06'04.279"N	80°33'22.435"W	1311.30	69.392	0.00	0.00	0.00
5026.00†	24.054	70.672	4773.45	-24.54	475.04	1265.85	1704565.01	584953.43	40°06'04.417"N	80°33'21.942"W	1352.05	69.430	0.00	0.00	0.00
5126.00†	24.054	70.672	4864.77	-24.39	488.53	1304.31	1704603.47	584966.92	40°06'04.555"N	80°33'21.449"W	1392.80	69.466	0.00	0.00	0.00
5226.00†	24.054	70.672	4956.08	-24.25	502.02	1342.77	1704641.93	584980.41	40°06'04.693"N	80°33'20.956"W	1433.55	69.501	0.00	0.00	0.00
5326.00†	24.054	70.672	5047.40	-24.11	515.51	1381.23	1704680.39	584993.90	40°06'04.831"N	80°33'20.463"W	1474.30	69.533	0.00	0.00	0.00
5426.00†	24.054	70.672	5138.72	-23.96	529.00	1419.69	1704718.86	585007.39	40°06'04.968"N	80°33'19.970"W	1515.05	69.564	0.00	0.00	0.00

Planned Wellpath Report

Alice Edge OHI 210H PWP Ex-00

Page 4 of 9



REFERENCE WELLPATH IDENTIFICATION

Operator	SOUTHWESTERN ENERGY	Slot	Slot #210
Area	Ohio County, WV	Well	Alice Edge OHI 210H
Field	Ohio	Wellbore	Alice Edge OHI 210H PWB
Facility	Alice Edge OHI Pad A		

WELLPATH DATA (193 stations) † = interpolated/extrapolated station

MD [ft]	Inclination [°]	Azimuth [°]	TVD [ft]	Vert Sect [ft]	North [ft]	East [ft]	Grid East [US ft]	Grid North [US ft]	Latitude	Longitude	Closure Dist [ft]	Closure Dir [°]	DLS [°/100ft]	Build Rate [°/100ft]	Turn Rate [°/100ft]
5526.00†	24.054	70.672	5230.03	-23.82	542.49	1458.16	1704757.32	585020.88	40°06'05.106"N	80°33'19.477"W	1555.80	69.593	0.00	0.00	0.00
5626.00†	24.054	70.672	5321.35	-23.67	555.98	1496.62	1704795.78	585034.37	40°06'05.244"N	80°33'18.985"W	1596.55	69.620	0.00	0.00	0.00
5726.00†	24.054	70.672	5412.67	-23.53	569.47	1535.08	1704834.24	585047.86	40°06'05.382"N	80°33'18.492"W	1637.30	69.647	0.00	0.00	0.00
5826.00†	24.054	70.672	5503.98	-23.39	582.96	1573.54	1704872.70	585061.35	40°06'05.519"N	80°33'17.999"W	1678.06	69.671	0.00	0.00	0.00
5926.00†	24.054	70.672	5595.30	-23.24	596.45	1612.00	1704911.16	585074.84	40°06'05.657"N	80°33'17.506"W	1718.81	69.695	0.00	0.00	0.00
6026.00†	24.054	70.672	5686.62	-23.10	609.94	1650.46	1704949.62	585088.32	40°06'05.795"N	80°33'17.013"W	1759.56	69.718	0.00	0.00	0.00
6126.00†	24.054	70.672	5777.93	-22.95	623.43	1688.93	1704988.08	585101.81	40°06'05.933"N	80°33'16.520"W	1800.32	69.739	0.00	0.00	0.00
6137.56	24.054	70.672	5788.49	-22.94	624.99	1693.37	1704992.53	585103.37	40°06'05.949"N	80°33'16.463"W	1805.03	69.742	0.00	0.00	0.00
6226.00†	25.000	87.617	5869.05	-17.36	631.74	1729.10	1705028.25	585110.12	40°06'06.019"N	80°33'16.005"W	1840.89	69.930	8.00	1.07	19.16
6326.00†	28.122	104.162	5958.61	1.98	626.85	1773.13	1705072.29	585105.23	40°06'05.976"N	80°33'15.437"W	1880.67	70.530	8.00	3.12	16.54
6426.00†	32.816	116.992	6044.87	34.77	608.75	1820.21	1705119.36	585087.13	40°06'05.803"N	80°33'14.829"W	1919.30	71.508	8.00	4.69	12.83
6526.00†	38.508	126.671	6126.14	80.37	577.81	1869.40	1705168.55	585056.20	40°06'05.503"N	80°33'14.191"W	1956.66	72.824	8.00	5.69	9.68
6626.00†	44.813	134.098	6200.86	137.91	534.63	1919.76	1705218.91	585013.01	40°06'05.082"N	80°33'13.537"W	1992.81	74.438	8.00	6.31	7.43
6726.00†	51.502	140.001	6267.57	206.25	480.04	1970.30	1705269.45	584958.42	40°06'04.548"N	80°33'12.878"W	2027.94	76.307	8.00	6.69	5.90
6826.00†	58.437	144.880	6324.95	284.08	415.11	2020.05	1705319.19	584893.50	40°06'03.912"N	80°33'12.228"W	2062.26	78.388	8.00	6.93	4.88
6926.00†	65.531	149.075	6371.91	369.86	341.10	2068.02	1705367.17	584819.49	40°06'03.187"N	80°33'11.600"W	2095.96	80.634	8.00	7.09	4.19
7026.00†	72.728	152.817	6407.53	461.95	259.46	2113.29	1705412.44	584737.85	40°06'02.385"N	80°33'11.005"W	2129.16	83.001	8.00	7.20	3.74
7126.00†	79.989	156.275	6431.10	558.53	171.76	2154.98	1705454.13	584650.16	40°06'01.524"N	80°33'10.455"W	2161.82	85.443	8.00	7.26	3.46
7226.00†	87.284	159.581	6442.18	657.74	79.73	2192.28	1705491.42	584558.13	40°06'00.618"N	80°33'09.961"W	2193.73	87.917	8.00	7.30	3.31
7253.18	89.269	160.468	6443.00 [†]	684.90	54.20	2201.56	1705500.70	584532.60	40°06'00.367"N	80°33'09.838"W	2202.23	88.590	8.00	7.30	3.26
7326.00†	89.269	160.468	6443.93	757.72	-14.42	2225.90	1705525.04	584463.98	40°05'59.692"N	80°33'09.515"W	2225.95	90.371	0.00	0.00	0.00
7426.00†	89.269	160.468	6445.20	857.71	-108.66	2259.33	1705558.47	584369.74	40°05'58.765"N	80°33'09.070"W	2261.95	92.754	0.00	0.00	0.00
7526.00†	89.269	160.468	6446.48	957.70	-202.90	2292.76	1705591.90	584275.50	40°05'57.837"N	80°33'08.626"W	2301.72	95.057	0.00	0.00	0.00
7626.00†	89.269	160.468	6447.76	1057.69	-297.14	2326.19	1705625.33	584181.27	40°05'56.910"N	80°33'08.181"W	2345.09	97.279	0.00	0.00	0.00
7726.00†	89.269	160.468	6449.03	1157.68	-391.38	2359.62	1705658.76	584087.03	40°05'55.982"N	80°33'07.737"W	2391.86	99.418	0.00	0.00	0.00
7826.00†	89.269	160.468	6450.31	1257.67	-485.61	2393.05	1705692.19	583992.80	40°05'55.055"N	80°33'07.293"W	2441.83	101.471	0.00	0.00	0.00
7926.00†	89.269	160.468	6451.58	1357.67	-579.85	2426.48	1705725.62	583898.56	40°05'54.128"N	80°33'06.848"W	2494.81	103.440	0.00	0.00	0.00
8026.00†	89.269	160.468	6452.86	1457.66	-674.09	2459.91	1705759.05	583804.33	40°05'53.200"N	80°33'06.404"W	2550.60	105.325	0.00	0.00	0.00
8126.00†	89.269	160.468	6454.13	1557.65	-768.33	2493.34	1705792.48	583710.09	40°05'52.273"N	80°33'05.960"W	2609.04	107.127	0.00	0.00	0.00
8226.00†	89.269	160.468	6455.41	1657.64	-862.57	2526.77	1705825.91	583615.86	40°05'51.346"N	80°33'05.515"W	2669.95	108.848	0.00	0.00	0.00

Section of
 1930's
 as

Planned Wellpath Report

Alice Edge OHI 210H PWP Ex-00

Page 5 of 9



REFERENCE WELLPATH IDENTIFICATION			
Operator	SOUTHWESTERN ENERGY		Slot #210
Area	Ohio County, WV		Well
Field	Ohio		Alice Edge OHI 210H
Facility	Alice Edge OHI Pad A		Wellbore
			Alice Edge OHI 210H PWB

WELLPATH DATA (193 stations) † = interpolated/extrapolated station															
MD [ft]	Inclination [°]	Azimuth [°]	TVD [ft]	Vert Sect [ft]	North [ft]	East [ft]	Grid East [US ft]	Grid North [US ft]	Latitude	Longitude	Closure Dist [ft]	Closure Dir [°]	DLS [°/100ft]	Build Rate [°/100ft]	Turn Rate [°/100ft]
8326.00†	89.269	160.468	6456.68	1757.63	-956.80	2560.20	1705859.33	583521.62	40°05'50.418"N	80°33'05.071"W	2733.15	110.492	0.00	0.00	0.00
8426.00†	89.269	160.468	6457.96	1857.63	-1051.04	2593.63	1705892.76	583427.39	40°05'49.491"N	80°33'04.627"W	2798.50	112.060	0.00	0.00	0.00
8526.00†	89.269	160.468	6459.23	1957.62	-1145.28	2627.06	1705926.19	583333.15	40°05'48.564"N	80°33'04.182"W	2865.86	113.555	0.00	0.00	0.00
8626.00†	89.269	160.468	6460.51	2057.61	-1239.52	2660.49	1705959.62	583238.91	40°05'47.636"N	80°33'03.738"W	2935.07	114.981	0.00	0.00	0.00
8726.00†	89.269	160.468	6461.79	2157.60	-1333.76	2693.92	1705993.05	583144.68	40°05'46.709"N	80°33'03.294"W	3006.02	116.340	0.00	0.00	0.00
8826.00†	89.269	160.468	6463.06	2257.59	-1428.00	2727.35	1706026.48	583050.44	40°05'45.781"N	80°33'02.850"W	3078.58	117.636	0.00	0.00	0.00
8926.00†	89.269	160.468	6464.34	2357.59	-1522.23	2760.78	1706059.91	582956.21	40°05'44.854"N	80°33'02.405"W	3152.64	118.871	0.00	0.00	0.00
9026.00†	89.269	160.468	6465.61	2457.58	-1616.47	2794.21	1706093.34	582861.97	40°05'43.927"N	80°33'01.961"W	3228.10	120.050	0.00	0.00	0.00
9126.00†	89.269	160.468	6466.89	2557.57	-1710.71	2827.64	1706126.77	582767.74	40°05'42.999"N	80°33'01.517"W	3304.86	121.174	0.00	0.00	0.00
9226.00†	89.269	160.468	6468.16	2657.56	-1804.95	2861.07	1706160.20	582673.50	40°05'42.072"N	80°33'01.072"W	3382.84	122.246	0.00	0.00	0.00
9326.00†	89.269	160.468	6469.44	2757.55	-1899.19	2894.50	1706193.63	582579.27	40°05'41.145"N	80°33'00.628"W	3461.94	123.270	0.00	0.00	0.00
9426.00†	89.269	160.468	6470.71	2857.54	-1993.42	2927.93	1706227.05	582485.03	40°05'40.217"N	80°33'00.184"W	3542.11	124.248	0.00	0.00	0.00
9526.00†	89.269	160.468	6471.99	2957.54	-2087.66	2961.36	1706260.48	582390.80	40°05'39.290"N	80°32'59.739"W	3623.26	125.183	0.00	0.00	0.00
9626.00†	89.269	160.468	6473.26	3057.53	-2181.90	2994.79	1706293.91	582296.56	40°05'38.363"N	80°32'59.295"W	3705.33	126.076	0.00	0.00	0.00
9726.00†	89.269	160.468	6474.54	3157.52	-2276.14	3028.22	1706327.34	582202.32	40°05'37.435"N	80°32'58.851"W	3788.26	126.930	0.00	0.00	0.00
9826.00†	89.269	160.468	6475.82	3257.51	-2370.38	3061.65	1706360.77	582108.09	40°05'36.508"N	80°32'58.407"W	3872.00	127.748	0.00	0.00	0.00
9926.00†	89.269	160.468	6477.09	3357.50	-2464.61	3095.08	1706394.20	582013.85	40°05'35.580"N	80°32'57.962"W	3956.50	128.530	0.00	0.00	0.00
10026.00†	89.269	160.468	6478.37	3457.50	-2558.85	3128.51	1706427.63	581919.62	40°05'34.653"N	80°32'57.518"W	4041.70	129.280	0.00	0.00	0.00
10126.00†	89.269	160.468	6479.64	3557.49	-2653.09	3161.94	1706461.06	581825.38	40°05'33.726"N	80°32'57.074"W	4127.56	129.999	0.00	0.00	0.00
10226.00†	89.269	160.468	6480.92	3657.48	-2747.33	3195.37	1706494.49	581731.15	40°05'32.798"N	80°32'56.630"W	4214.05	130.688	0.00	0.00	0.00
10326.00†	89.269	160.468	6482.19	3757.47	-2841.57	3228.80	1706527.92	581636.91	40°05'31.871"N	80°32'56.185"W	4301.12	131.350	0.00	0.00	0.00
10426.00†	89.269	160.468	6483.47	3857.46	-2935.80	3262.23	1706561.35	581542.68	40°05'30.944"N	80°32'55.741"W	4388.75	131.985	0.00	0.00	0.00
10526.00†	89.269	160.468	6484.74	3957.45	-3030.04	3295.66	1706594.78	581448.44	40°05'30.016"N	80°32'55.297"W	4476.89	132.596	0.00	0.00	0.00
10626.00†	89.269	160.468	6486.02	4057.45	-3124.28	3329.09	1706628.20	581354.20	40°05'29.089"N	80°32'54.852"W	4565.52	133.182	0.00	0.00	0.00
10726.00†	89.269	160.468	6487.30	4157.44	-3218.52	3362.52	1706661.63	581259.97	40°05'28.161"N	80°32'54.408"W	4654.61	133.746	0.00	0.00	0.00
10826.00†	89.269	160.468	6488.57	4257.43	-3312.76	3395.95	1706695.06	581165.73	40°05'27.234"N	80°32'53.964"W	4744.14	134.289	0.00	0.00	0.00
10926.00†	89.269	160.468	6489.85	4357.42	-3406.99	3429.38	1706728.49	581071.50	40°05'26.307"N	80°32'53.520"W	4834.08	134.812	0.00	0.00	0.00
11026.00†	89.269	160.468	6491.12	4457.41	-3501.23	3462.81	1706761.92	580977.26	40°05'25.379"N	80°32'53.076"W	4924.40	135.316	0.00	0.00	0.00
11126.00†	89.269	160.468	6492.40	4557.41	-3595.47	3496.24	1706795.35	580883.03	40°05'24.452"N	80°32'52.631"W	5015.09	135.802	0.00	0.00	0.00
11226.00†	89.269	160.468	6493.67	4657.40	-3689.71	3529.67	1706828.78	580788.79	40°05'23.525"N	80°32'52.187"W	5106.13	136.270	0.00	0.00	0.00

Planned Wellpath Report

Alice Edge OHI 210H PWP Ex-00

Page 6 of 9



REFERENCE WELLPATH IDENTIFICATION

Operator	SOUTHWESTERN ENERGY	Slot	Slot #210
Area	Ohio County, WV	Well	Alice Edge OHI 210H
Field	Ohio	Wellbore	Alice Edge OHI 210H PWB
Facility	Alice Edge OHI Pad A		

WELLPATH DATA (193 stations) † = interpolated/extrapolated station

MD [ft]	Inclination [°]	Azimuth [°]	TVD [ft]	Vert Sect [ft]	North [ft]	East [ft]	Grid East [US ft]	Grid North [US ft]	Latitude	Longitude	Closure Dist [ft]	Closure Dir [°]	DLS [°/100ft]	Build Rate [°/100ft]	Turn Rate [°/100ft]
11326.00†	89.269	160.468	6494.95	4757.39	-3783.95	3563.10	1706862.21	580694.56	40°05'22.597"N	80°32'51.743"W	5197.50	136.722	0.00	0.00	0.00
11426.00†	89.269	160.468	6496.22	4857.38	-3878.18	3596.53	1706895.64	580600.32	40°05'21.670"N	80°32'51.299"W	5289.17	137.158	0.00	0.00	0.00
11526.00†	89.269	160.468	6497.50	4957.37	-3972.42	3629.96	1706929.07	580506.09	40°05'20.742"N	80°32'50.854"W	5381.15	137.579	0.00	0.00	0.00
11626.00†	89.269	160.468	6498.77	5057.37	-4066.66	3663.39	1706962.50	580411.85	40°05'19.815"N	80°32'50.410"W	5473.41	137.986	0.00	0.00	0.00
11726.00†	89.269	160.468	6500.05	5157.36	-4160.90	3696.82	1706995.92	580317.61	40°05'18.888"N	80°32'49.966"W	5565.93	138.380	0.00	0.00	0.00
11826.00†	89.269	160.468	6501.33	5257.35	-4255.14	3730.25	1707029.35	580223.38	40°05'17.960"N	80°32'49.522"W	5658.71	138.761	0.00	0.00	0.00
11926.00†	89.269	160.468	6502.60	5357.34	-4349.37	3763.68	1707062.78	580129.14	40°05'17.033"N	80°32'49.078"W	5751.73	139.129	0.00	0.00	0.00
12026.00†	89.269	160.468	6503.88	5457.33	-4443.61	3797.11	1707096.21	580034.91	40°05'16.106"N	80°32'48.633"W	5844.98	139.486	0.00	0.00	0.00
12126.00†	89.269	160.468	6505.15	5557.32	-4537.85	3830.54	1707129.64	579940.67	40°05'15.178"N	80°32'48.189"W	5938.45	139.831	0.00	0.00	0.00
12226.00†	89.269	160.468	6506.43	5657.32	-4632.09	3863.97	1707163.07	579846.44	40°05'14.251"N	80°32'47.745"W	6032.13	140.166	0.00	0.00	0.00
12326.00†	89.269	160.468	6507.70	5757.31	-4726.33	3897.40	1707196.50	579752.20	40°05'13.323"N	80°32'47.301"W	6126.00	140.490	0.00	0.00	0.00
12426.00†	89.269	160.468	6508.98	5857.30	-4820.56	3930.83	1707229.93	579657.97	40°05'12.396"N	80°32'46.857"W	6220.07	140.805	0.00	0.00	0.00
12526.00†	89.269	160.468	6510.25	5957.29	-4914.80	3964.26	1707263.36	579563.73	40°05'11.469"N	80°32'46.412"W	6314.32	141.110	0.00	0.00	0.00
12626.00†	89.269	160.468	6511.53	6057.28	-5009.04	3997.69	1707296.79	579469.50	40°05'10.541"N	80°32'45.968"W	6408.75	141.407	0.00	0.00	0.00
12726.00†	89.269	160.468	6512.80	6157.28	-5103.28	4031.12	1707330.22	579375.26	40°05'09.614"N	80°32'45.524"W	6503.34	141.694	0.00	0.00	0.00
12826.00†	89.269	160.468	6514.08	6257.27	-5197.52	4064.55	1707363.64	579281.02	40°05'08.686"N	80°32'45.080"W	6598.09	141.974	0.00	0.00	0.00
12926.00†	89.269	160.468	6515.36	6357.26	-5291.75	4097.98	1707397.07	579186.79	40°05'07.759"N	80°32'44.636"W	6692.99	142.245	0.00	0.00	0.00
13026.00†	89.269	160.468	6516.63	6457.25	-5385.99	4131.41	1707430.50	579092.55	40°05'06.832"N	80°32'44.191"W	6788.04	142.509	0.00	0.00	0.00
13126.00†	89.269	160.468	6517.91	6557.24	-5480.23	4164.84	1707463.93	578998.32	40°05'05.904"N	80°32'43.747"W	6883.23	142.766	0.00	0.00	0.00
13226.00†	89.269	160.468	6519.18	6657.24	-5574.47	4198.27	1707497.36	578904.08	40°05'04.977"N	80°32'43.303"W	6978.55	143.016	0.00	0.00	0.00
13326.00†	89.269	160.468	6520.46	6757.23	-5668.71	4231.70	1707530.79	578809.85	40°05'04.050"N	80°32'42.859"W	7074.01	143.259	0.00	0.00	0.00
13426.00†	89.269	160.468	6521.73	6857.22	-5762.94	4265.13	1707564.22	578715.61	40°05'03.122"N	80°32'42.415"W	7169.58	143.495	0.00	0.00	0.00
13526.00†	89.269	160.468	6523.01	6957.21	-5857.18	4298.56	1707597.65	578621.38	40°05'02.195"N	80°32'41.971"W	7265.28	143.725	0.00	0.00	0.00
13626.00†	89.269	160.468	6524.28	7057.20	-5951.42	4331.99	1707631.08	578527.14	40°05'01.267"N	80°32'41.526"W	7361.09	143.949	0.00	0.00	0.00
13726.00†	89.269	160.468	6525.56	7157.19	-6045.66	4365.42	1707664.51	578432.90	40°05'00.340"N	80°32'41.082"W	7457.01	144.168	0.00	0.00	0.00
13826.00†	89.269	160.468	6526.83	7257.19	-6139.90	4398.85	1707697.94	578338.67	40°04'59.413"N	80°32'40.638"W	7553.03	144.381	0.00	0.00	0.00
13926.00†	89.269	160.468	6528.11	7357.18	-6234.14	4432.28	1707731.36	578244.43	40°04'58.485"N	80°32'40.194"W	7649.16	144.588	0.00	0.00	0.00
14026.00†	89.269	160.468	6529.39	7457.17	-6328.37	4465.71	1707764.79	578150.20	40°04'57.558"N	80°32'39.750"W	7745.38	144.791	0.00	0.00	0.00
14126.00†	89.269	160.468	6530.66	7557.16	-6422.61	4499.14	1707798.22	578055.96	40°04'56.630"N	80°32'39.306"W	7841.70	144.988	0.00	0.00	0.00
14226.00†	89.269	160.468	6531.94	7657.15	-6516.85	4532.57	1707831.65	577961.73	40°04'55.703"N	80°32'38.862"W	7938.11	145.181	0.00	0.00	0.00

Department of Environmental Protection
 March 9, 2015
 Gas

Planned Wellpath Report

Alice Edge OHI 210H PWP Ex-00

Page 7 of 9



REFERENCE WELLPATH IDENTIFICATION			
Operator	SOUTHWESTERN ENERGY		Slot #210
Area	Ohio County, WV		Well Alice Edge OHI 210H
Field	Ohio		Wellbore Alice Edge OHI 210H PWB
Facility	Alice Edge OHI Pad A		

WELLPATH DATA (193 stations) † = interpolated/extrapolated station															
MD [ft]	Inclination [°]	Azimuth [°]	TVD [ft]	Vert Sect [ft]	North [ft]	East [ft]	Grid East [US ft]	Grid North [US ft]	Latitude	Longitude	Closure Dist [ft]	Closure Dir [°]	DLS [°/100ft]	Build Rate [°/100ft]	Turn Rate [°/100ft]
14326.00†	89.269	160.468	6533.21	7757.15	-6611.09	4566.00	1707865.08	577867.49	40°04'54.776"N	80°32'38.418"W	8034.60	145.369	0.00	0.00	0.00
14426.00†	89.269	160.468	6534.49	7857.14	-6705.33	4599.43	1707898.51	577773.26	40°04'53.848"N	80°32'37.973"W	8131.19	145.552	0.00	0.00	0.00
14526.00†	89.269	160.468	6535.76	7957.13	-6799.56	4632.86	1707931.94	577679.02	40°04'52.921"N	80°32'37.529"W	8227.85	145.732	0.00	0.00	0.00
14626.00†	89.269	160.468	6537.04	8057.12	-6893.80	4666.29	1707965.37	577584.79	40°04'51.993"N	80°32'37.085"W	8324.59	145.907	0.00	0.00	0.00
14726.00†	89.269	160.468	6538.31	8157.11	-6988.04	4699.72	1707998.80	577490.55	40°04'51.066"N	80°32'36.641"W	8421.41	146.078	0.00	0.00	0.00
14826.00†	89.269	160.468	6539.59	8257.11	-7082.28	4733.15	1708032.23	577396.31	40°04'50.139"N	80°32'36.197"W	8518.30	146.245	0.00	0.00	0.00
14926.00†	89.269	160.468	6540.87	8357.10	-7176.52	4766.58	1708065.66	577302.08	40°04'49.211"N	80°32'35.753"W	8615.26	146.408	0.00	0.00	0.00
15026.00†	89.269	160.468	6542.14	8457.09	-7270.75	4800.01	1708099.08	577207.84	40°04'48.284"N	80°32'35.309"W	8712.29	146.568	0.00	0.00	0.00
15126.00†	89.269	160.468	6543.42	8557.08	-7364.99	4833.44	1708132.51	577113.61	40°04'47.356"N	80°32'34.865"W	8809.39	146.724	0.00	0.00	0.00
15226.00†	89.269	160.468	6544.69	8657.07	-7459.23	4866.87	1708165.94	577019.37	40°04'46.429"N	80°32'34.421"W	8906.55	146.877	0.00	0.00	0.00
15326.00†	89.269	160.468	6545.97	8757.06	-7553.47	4900.30	1708199.37	576925.14	40°04'45.502"N	80°32'33.976"W	9003.77	147.027	0.00	0.00	0.00
15426.00†	89.269	160.468	6547.24	8857.06	-7647.71	4933.73	1708232.80	576830.90	40°04'44.574"N	80°32'33.532"W	9101.05	147.173	0.00	0.00	0.00
15526.00†	89.269	160.468	6548.52	8957.05	-7741.94	4967.16	1708266.23	576736.67	40°04'43.647"N	80°32'33.088"W	9198.39	147.316	0.00	0.00	0.00
15626.00†	89.269	160.468	6549.79	9057.04	-7836.18	5000.59	1708299.66	576642.43	40°04'42.719"N	80°32'32.644"W	9295.79	147.456	0.00	0.00	0.00
15726.00†	89.269	160.468	6551.07	9157.03	-7930.42	5034.02	1708333.09	576548.20	40°04'41.792"N	80°32'32.200"W	9393.24	147.594	0.00	0.00	0.00
15826.00†	89.269	160.468	6552.34	9257.02	-8024.66	5067.45	1708366.52	576453.96	40°04'40.865"N	80°32'31.756"W	9490.74	147.728	0.00	0.00	0.00
15926.00†	89.269	160.468	6553.62	9357.02	-8118.90	5100.88	1708399.95	576359.72	40°04'39.937"N	80°32'31.312"W	9588.30	147.860	0.00	0.00	0.00
16026.00†	89.269	160.468	6554.90	9457.01	-8213.13	5134.31	1708433.38	576265.49	40°04'39.010"N	80°32'30.868"W	9685.91	147.989	0.00	0.00	0.00
16126.00†	89.269	160.468	6556.17	9557.00	-8307.37	5167.74	1708466.80	576171.25	40°04'38.082"N	80°32'30.424"W	9783.56	148.116	0.00	0.00	0.00
16226.00†	89.269	160.468	6557.45	9656.99	-8401.61	5201.17	1708500.23	576077.02	40°04'37.155"N	80°32'29.980"W	9881.26	148.240	0.00	0.00	0.00
16326.00†	89.269	160.468	6558.72	9756.98	-8495.85	5234.60	1708533.66	575982.78	40°04'36.228"N	80°32'29.536"W	9979.00	148.361	0.00	0.00	0.00
16426.00†	89.269	160.468	6560.00	9856.98	-8590.09	5268.03	1708567.09	575888.55	40°04'35.300"N	80°32'29.092"W	10076.79	148.480	0.00	0.00	0.00
16526.00†	89.269	160.468	6561.27	9956.97	-8684.32	5301.46	1708600.52	575794.31	40°04'34.373"N	80°32'28.648"W	10174.63	148.597	0.00	0.00	0.00
16626.00†	89.269	160.468	6562.55	10056.96	-8778.56	5334.89	1708633.95	575700.08	40°04'33.445"N	80°32'28.203"W	10272.50	148.712	0.00	0.00	0.00
16726.00†	89.269	160.468	6563.82	10156.95	-8872.80	5368.32	1708667.38	575605.84	40°04'32.518"N	80°32'27.759"W	10370.41	148.825	0.00	0.00	0.00
16826.00†	89.269	160.468	6565.10	10256.94	-8967.04	5401.75	1708700.81	575511.60	40°04'31.591"N	80°32'27.315"W	10468.37	148.935	0.00	0.00	0.00
16926.00†	89.269	160.468	6566.37	10356.93	-9061.28	5435.19	1708734.24	575417.37	40°04'30.663"N	80°32'26.871"W	10566.36	149.044	0.00	0.00	0.00
17026.00†	89.269	160.468	6567.65	10456.93	-9155.51	5468.62	1708767.67	575323.13	40°04'29.736"N	80°32'26.427"W	10664.39	149.150	0.00	0.00	0.00
17126.00†	89.269	160.468	6568.93	10556.92	-9249.75	5502.05	1708801.10	575228.90	40°04'28.808"N	80°32'25.983"W	10762.45	149.254	0.00	0.00	0.00
17226.00†	89.269	160.468	6570.20	10656.91	-9343.99	5535.48	1708834.53	575134.66	40°04'27.881"N	80°32'25.539"W	10860.55	149.357	0.00	0.00	0.00

Direction
 of
 Well
 Path
 is
 as
 shown
 on
 this
 map

Planned Wellpath Report

Alice Edge OHI 210H PWP Ex-00

Page 8 of 9



REFERENCE WELLPATH IDENTIFICATION

Operator	SOUTHWESTERN ENERGY	Slot	Slot #210
Area	Ohio County, WV	Well	Alice Edge OHI 210H
Field	Ohio	Wellbore	Alice Edge OHI 210H PWB
Facility	Alice Edge OHI Pad A		

WELLPATH DATA (193 stations) † = interpolated/extrapolated station

MD [ft]	Inclination [°]	Azimuth [°]	TVD [ft]	Vert Sect [ft]	North [ft]	East [ft]	Grid East [US ft]	Grid North [US ft]	Latitude	Longitude	Closure Dist [ft]	Closure Dir [°]	DLS [°/100ft]	Build Rate [°/100ft]	Turn Rate [°/100ft]
17326.00†	89.269	160.468	6571.48	10756.90	-9438.23	5568.91	1708867.95	575040.43	40°04'26.954"N	80°32'25.095"W	10958.69	149.458	0.00	0.00	0.00
17426.00†	89.269	160.468	6572.75	10856.89	-9532.47	5602.34	1708901.38	574946.19	40°04'26.026"N	80°32'24.651"W	11056.86	149.557	0.00	0.00	0.00
17526.00†	89.269	160.468	6574.03	10956.89	-9626.70	5635.77	1708934.81	574851.96	40°04'25.099"N	80°32'24.207"W	11155.06	149.654	0.00	0.00	0.00
17626.00†	89.269	160.468	6575.30	11056.88	-9720.94	5669.20	1708968.24	574757.72	40°04'24.171"N	80°32'23.763"W	11253.29	149.750	0.00	0.00	0.00
17726.00†	89.269	160.468	6576.58	11156.87	-9815.18	5702.63	1709001.67	574663.49	40°04'23.244"N	80°32'23.319"W	11351.55	149.843	0.00	0.00	0.00
17826.00†	89.269	160.468	6577.85	11256.86	-9909.42	5736.06	1709035.10	574569.25	40°04'22.316"N	80°32'22.875"W	11449.84	149.936	0.00	0.00	0.00
17926.00†	89.269	160.468	6579.13	11356.85	-10003.66	5769.49	1709068.53	574475.01	40°04'21.389"N	80°32'22.431"W	11548.16	150.026	0.00	0.00	0.00
18026.00†	89.269	160.468	6580.40	11456.84	-10097.89	5802.92	1709101.96	574380.78	40°04'20.462"N	80°32'21.987"W	11646.51	150.115	0.00	0.00	0.00
18126.00†	89.269	160.468	6581.68	11556.84	-10192.13	5836.35	1709135.39	574286.54	40°04'19.534"N	80°32'21.543"W	11744.89	150.203	0.00	0.00	0.00
18226.00†	89.269	160.468	6582.96	11656.83	-10286.37	5869.78	1709168.82	574192.31	40°04'18.607"N	80°32'21.099"W	11843.30	150.289	0.00	0.00	0.00
18326.00†	89.269	160.468	6584.23	11756.82	-10380.61	5903.21	1709202.25	574098.07	40°04'17.679"N	80°32'20.655"W	11941.73	150.374	0.00	0.00	0.00
18426.00†	89.269	160.468	6585.51	11856.81	-10474.85	5936.64	1709235.67	574003.84	40°04'16.752"N	80°32'20.211"W	12040.18	150.458	0.00	0.00	0.00
18464.67	89.269	160.468	6586.00 ²	11895.48	-10511.28	5949.56	1709248.60	573967.40	40°04'16.393"N	80°32'20.039"W	12078.26	150.489	0.00	0.00	0.00

HOLE & CASING SECTIONS - Ref Wellbore: Alice Edge OHI 210H PWB Ref Wellpath: Alice Edge OHI 210H PWP Ex-00

String/Diameter	Start MD [ft]	End MD [ft]	Interval [ft]	Start TVD [ft]	End TVD [ft]	Start N/S [ft]	Start E/W [ft]	End N/S [ft]	End E/W [ft]
13.375in Casing Surface	26.00	630.00	604.00	26.00	630.00	0.00	0.00	0.00	0.00
9.625in Casing Intermediate	26.00	2129.28	2103.28	26.00	2107.00	0.00	0.00	98.44	211.12
8.75in Open Hole	2129.28	18464.67	16335.39	2107.00	6586.00	98.44	211.12	-10511.28	5949.56
5.5in Casing Production	26.00	18464.67	18438.67	26.00	6586.00	0.00	0.00	-10511.28	5949.56

RECEIVED
 Office of Oil and Gas
 JAN 28 2015
 WV Department of Environmental Protection

Planned Wellpath Report

Alice Edge OHI 210H PWP Ex-00

Page 9 of 9



REFERENCE WELLPATH IDENTIFICATION			
Operator	SOUTHWESTERN ENERGY	Slot	Slot #210
Area	Ohio County, WV	Well	Alice Edge OHI 210H
Field	Ohio	Wellbore	Alice Edge OHI 210H PWB
Facility	Alice Edge OHI Pad A		

TARGETS									
Name	MD [ft]	TVD [ft]	North [ft]	East [ft]	Grid East [US ft]	Grid North [US ft]	Latitude	Longitude	Shape
Alice Edge OHI 210H KOP Plat		6400.00	559.02	2022.45	1705321.60	585037.40	40°06'05.335"N	80°33'12.219"W	point
1) Alice Edge OHI 210H TP Plat	7253.18	6443.00	54.20	2201.56	1705500.70	584532.60	40°06'00.367"N	80°33'09.838"W	point
2) Alice Edge OHI 210H BHL Plat	18464.67	6586.00	-10511.28	5949.56	1709248.60	573967.40	40°04'16.393"N	80°32'20.039"W	point

SURVEY PROGRAM - Ref Wellbore: Alice Edge OHI 210H PWB Ref Wellpath: Alice Edge OHI 210H PWP Ex-00				
Start MD [ft]	End MD [ft]	Positional Uncertainty Model	Log Name/Comment	Wellbore
26.00	600.00	Generic gyro - northseeking (Standard)		Alice Edge OHI 210H PWB
600.00	6000.00	NaviTrak (MagCorr)		Alice Edge OHI 210H PWB
6000.00	18464.67	NaviTrak (AT Curve Short Spaced)		Alice Edge OHI 210H PWB

RECEIVED
 Office of Oil and Gas
 JAN 28 2015
 WV Department of
 Environmental Protection