

Location: Ohio County, WV
Field: Ohio
Facility: Alice Edge OHI Pad A

Slot: Slot #206
Well: Alice Edge OHI 206H
Wellbore: Alice Edge OHI 206H PWB

Plot reference wellpath is Alice Edge OHI 206H PWB Rev-E.0	
True vertical depths are referenced to Rocket Rig 40 (RKB)	Grid System: NAD83 / UTM Zone 17 North, US feet
Measured depths are referenced to Rocket Rig 40 (RKB)	North Reference: Grid north
Rocket Rig 40 (RKB) to Mean Sea Level: 1225.2 feet	Scale: True distance
Mean Sea Level to Mud line (At Slot: Slot #206): -1199.2 feet	Depths are in feet
Coordinates are in feet referenced to Slot	Created by: edsaryar on 29/Apr/2015

Location Information						
Facility Name		Grid East (US ft)	Grid North (US ft)	Latitude	Longitude	
Alice Edge OHI Pad A		1763332.250	14563424.920	40°05'58.737"N	80°33'37.638"W	
Slot	Local N (ft)	Local E (ft)	Grid East (US ft)	Grid North (US ft)	Latitude	Longitude
Slot #206	-11.95	7.89	1763340.140	14563412.960	40°05'58.618"N	80°33'37.537"W
Rocket Rig 40 (RKB) to Mud line (At Slot: Slot #206)						26ft
Mean Sea Level to Mud line (At Slot: Slot #206)						-1199.2ft
Rocket Rig 40 (RKB) to Mean Sea Level						1225.2ft

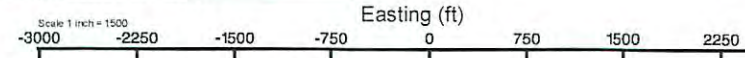

MS Gyro <17-1/2"> (100'-636') : 100.00ft TVD, 0.06ft S, 0.55ft E
 MS Gyro (Orientation) <12-1/4"> (685') : 684.98ft TVD, 0.94ft N, 3.58ft E
 APS EM <12-1/4"> (685')(798'-2075') : 797.98ft TVD, 0.43ft N, 2.96ft E
 APS EM <8-3/4"> (2075')(2188'-5521') : 2175.54ft TVD, 55.55ft S, 167.60ft W
 BHI AT Curve <8-1/2"> (5521')(5591'-14556') : 5545.27ft TVD, 230.40ft S, 601.34ft W

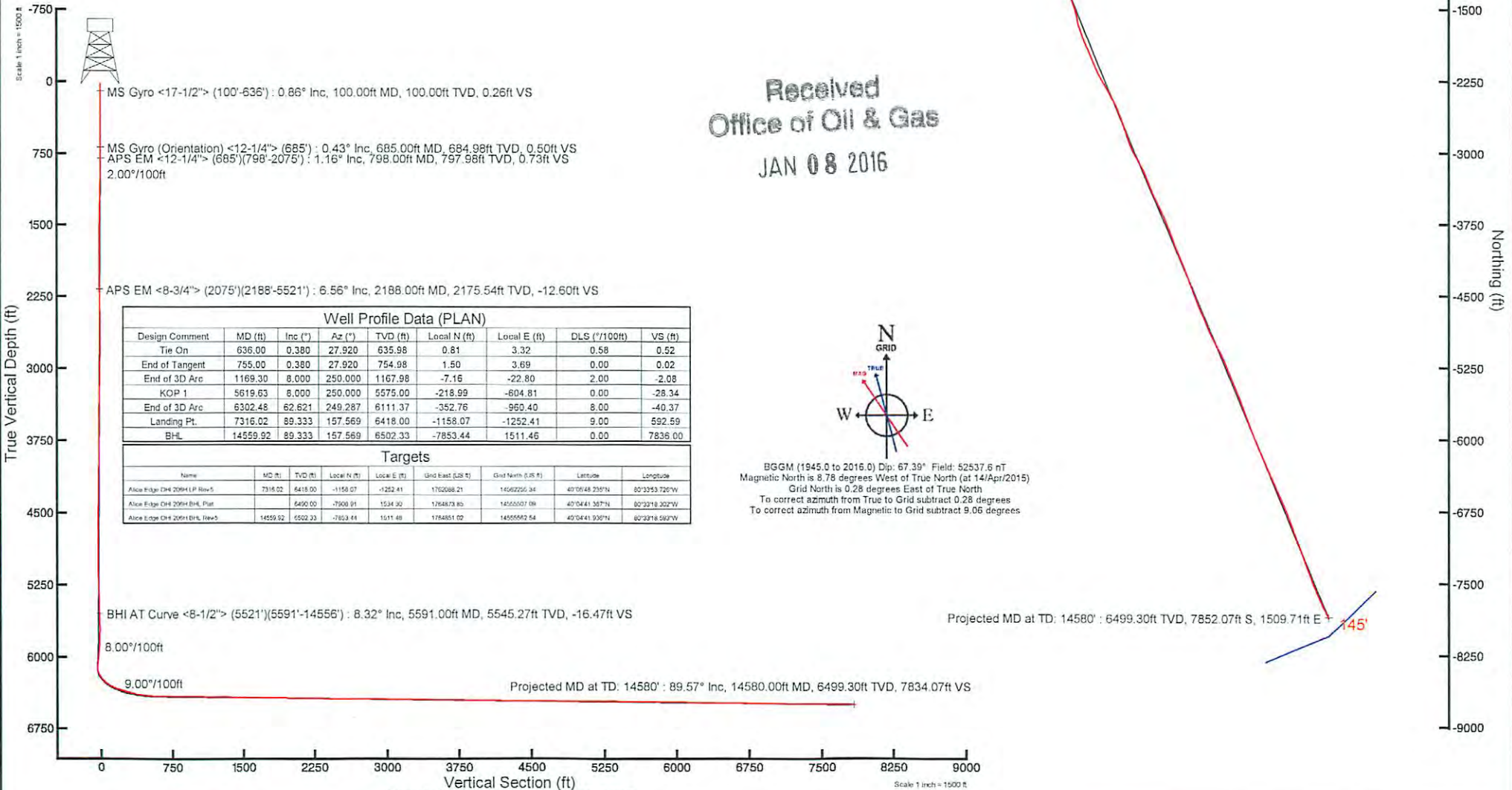

Received
Office of Oil & Gas
JAN 08 2016

Well Profile Data (PLAN)								
Design Comment	MD (ft)	Inc (°)	Az (°)	TVD (ft)	Local N (ft)	Local E (ft)	DLS (°/100ft)	VS (ft)
Tie On	636.00	0.380	27.920	635.98	0.81	3.32	0.58	0.52
End of Tangent	755.00	0.380	27.920	754.98	1.50	3.69	0.00	0.02
End of 3D Arc	1169.30	8.000	250.000	1167.98	-7.16	-22.80	2.00	-2.08
KOP 1	5619.63	8.000	250.000	5575.00	-218.99	-604.81	0.00	-28.34
End of 3D Arc	6302.48	62.621	249.287	6111.37	-352.76	-960.40	8.00	-40.37
Landing Pt.	7316.02	89.333	157.569	6418.00	-1158.07	-1252.41	9.00	592.59
BHL	14559.92	89.333	157.569	6502.33	-7853.44	1511.46	0.00	7836.00

Targets								
Name	MD (ft)	TVD (ft)	Local N (ft)	Local E (ft)	Grid East (US ft)	Grid North (US ft)	Latitude	Longitude
Alice Edge OHI 206H LP Rev 5	7316.02	6418.00	-1158.07	-1252.41	1762088.21	14562225.34	40°05'48.235"N	80°33'53.720"W
Alice Edge OHI 206H BHL Plat	6490.00	-7500.91	1534.90	12648.73	14565507.09	40°04'41.367"N	80°32'18.302"W	
Alice Edge OHI 206H BHL Rev 5	14559.92	6502.33	-7853.44	1511.46	1764851.62	14565592.54	40°04'41.930"N	80°32'18.582"W

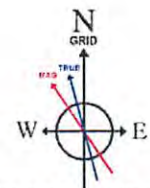

BGGM (1945.0 to 2016.0) Dip: 67.39° Field: 52537.6 nT
 Magnetic North is 8.78 degrees West of True North (at 14/Apr/2015)
 Grid North is 0.28 degrees East of True North
 To correct azimuth from True to Grid subtract 0.28 degrees
 To correct azimuth from Magnetic to Grid subtract 9.06 degrees

Alice Edge OHI 206H EOW Survey Report

OPENWORKS DATA TRANSFER REPORT

Report Date: 29/Apr/2015
 Report Type: Openworks Directional Data Transfer Report
 Software System: WellArchitect(R)
 Contractor: Baker Hughes
 Operator: SOUTHWESTERN ENERGY
 Area: Ohio County, WV
 Field: Ohio
 Structure: Alice Edge OHI Pad A
 Slot: Slot #206
 Well: Alice Edge OHI 206H
 Wellbore: Alice Edge OHI 206H AWB
 Wellpath: Alice Edge OHI 206H AWP Proj: 14580'
 Unique Well Identifier:
 Wellpath Date Created: 04/02/2015
 Wellpath Last Revised:
 Well Surface Location X Co-ordinate: 1763340.140
 Well Surface Location Y Co-ordinate: 14563412.960
 KB Elevation: n/a
 KB Elevation Units: ft
 Wellhead Elevation Type: n/a
 Local Grid Orientation: grid
 Grid Convergence: n/a
 Local Grid Units: ft
 True Vertical Depth Reference: Rocket Rig 40 (RKB)
 Position Uncertainty Confidence: n/a

MD feet	DEVIATION deg	AZIMUTH deg	TVD feet	NORTH feet	EAST feet	DOGLEG deg/100ft
0.00	0.00	95.75	0.00	0.00	0.00	0.00
26.00	0.00	95.75	26.00	0.00	0.00	0.00
100.00	0.86	95.75	100.00	-0.06	0.55	1.16
200.00	0.42	88.78	199.99	-0.12	1.67	0.45
300.00	0.44	86.54	299.99	-0.09	2.42	0.03
400.00	0.22	14.74	399.99	0.12	2.85	0.43
500.00	0.19	43.54	499.99	0.42	3.01	0.11
600.00	0.18	42.28	599.99	0.66	3.23	0.01
636.00	0.38	27.92	635.98	0.81	3.32	0.58
685.00	0.43	94.38	684.98	0.94	3.58	0.91
798.00	1.16	245.69	797.98	0.43	2.96	1.37
890.00	3.25	255.82	889.90	-0.59	-0.41	2.30
983.00	5.72	259.09	982.61	-2.11	-7.52	2.67
1076.00	8.10	257.67	1074.93	-4.39	-18.47	2.57
1169.00	8.20	256.93	1166.99	-7.29	-31.34	0.16
1262.00	8.60	255.13	1258.99	-10.57	-44.52	0.51
1354.00	8.32	256.36	1349.99	-13.91	-57.63	0.36
1447.00	8.64	256.23	1441.98	-17.16	-70.96	0.34
1540.00	8.96	253.31	1533.88	-20.90	-84.68	0.59
1633.00	7.94	247.91	1625.87	-25.40	-97.57	1.39
1726.00	7.88	246.12	1717.99	-30.39	-109.35	0.27
1818.00	8.56	249.00	1809.04	-35.40	-121.51	0.86
1911.00	9.28	250.10	1900.92	-40.43	-135.02	0.80
2004.00	7.77	246.08	1992.89	-45.53	-147.82	1.74
2075.00	6.82	243.05	2063.31	-49.39	-155.96	1.44
2188.00	6.56	241.10	2175.54	-55.55	-167.60	0.31
2281.00	6.17	233.51	2267.97	-61.09	-176.27	1.00
2373.00	5.78	231.26	2359.47	-66.93	-183.85	0.49
2466.00	5.89	234.98	2451.99	-72.60	-191.41	0.42
2559.00	8.00	249.48	2544.31	-77.61	-201.38	2.95
2652.00	8.19	249.20	2636.38	-82.23	-213.64	0.21
2745.00	7.55	244.89	2728.51	-87.17	-225.36	0.94
2837.00	7.94	254.70	2819.67	-91.41	-236.97	1.50

Received
 Office of Oil & Gas
 JAN 08 2016

Alice Edge OHI 206H EOW Survey Report

2930.00	8.13	255.43	2911.76	-94.76	-249.53	0.23
3023.00	7.63	252.20	3003.88	-98.30	-261.77	0.72
3116.00	8.41	255.97	3095.97	-101.84	-274.25	1.01
3208.00	9.11	257.79	3186.90	-105.01	-287.89	0.82
3301.00	8.49	255.43	3278.80	-108.30	-301.73	0.77
3394.00	8.19	257.49	3370.82	-111.46	-314.84	0.46
3487.00	7.83	252.83	3462.91	-114.76	-327.36	0.80
3580.00	7.70	249.70	3555.06	-118.79	-339.26	0.48
3672.00	7.38	244.33	3646.27	-123.49	-350.37	0.84
3765.00	8.18	250.90	3738.41	-128.24	-362.00	1.28
3858.00	8.51	251.85	3830.43	-132.55	-374.79	0.38
3951.00	8.33	250.61	3922.42	-136.93	-387.69	0.27
4043.00	7.36	251.60	4013.56	-141.01	-399.56	1.06
4136.00	8.40	255.89	4105.68	-144.54	-411.80	1.28
4229.00	8.24	252.22	4197.70	-148.23	-424.74	0.60
4322.00	7.47	246.84	4289.83	-152.65	-436.64	1.14
4414.00	8.38	254.30	4380.96	-156.81	-448.60	1.49
4507.00	9.49	256.53	4472.83	-160.43	-462.58	1.25
4600.00	9.24	251.59	4564.59	-164.58	-477.12	0.90
4692.00	8.02	252.15	4655.54	-168.88	-490.23	1.33
4785.00	7.52	250.52	4747.69	-172.89	-502.15	0.59
4878.00	7.09	242.75	4839.94	-177.55	-512.99	1.16
4971.00	8.88	249.13	4932.03	-182.74	-524.80	2.14
5063.00	10.03	244.07	5022.78	-188.77	-538.64	1.54
5156.00	9.83	237.85	5114.39	-196.54	-552.64	1.17
5248.00	8.66	234.76	5205.20	-204.71	-564.95	1.38
5341.00	7.79	235.58	5297.24	-212.32	-575.87	0.94
5434.00	6.22	235.46	5389.54	-218.73	-585.22	1.69
5521.00	7.43	235.89	5475.92	-224.56	-593.76	1.39
5591.00	8.32	229.27	5545.27	-230.40	-601.34	1.81
5636.00	9.17	232.04	5589.74	-234.73	-606.64	2.11
5683.00	11.37	240.04	5635.99	-239.35	-613.60	5.57
5729.00	14.51	245.90	5680.82	-243.97	-622.80	7.39
5775.00	17.44	248.40	5725.04	-248.86	-634.47	6.54
5822.00	21.28	250.91	5769.37	-254.25	-649.08	8.36
5868.00	25.22	251.67	5811.63	-260.06	-666.28	8.59
5915.00	29.79	252.68	5853.30	-266.69	-686.94	9.77
5961.00	34.26	253.88	5892.29	-273.69	-710.30	9.81
6007.00	38.57	254.71	5929.30	-281.07	-736.59	9.43
6053.00	42.37	254.68	5964.29	-288.95	-765.38	8.26
6100.00	46.46	253.67	5997.86	-297.93	-797.01	8.83
6146.00	51.26	252.00	6028.11	-308.17	-830.10	10.79
6193.00	55.73	251.53	6056.06	-319.99	-865.97	9.54
6239.00	60.11	251.08	6080.49	-332.48	-902.88	9.56
6285.00	63.42	249.73	6102.25	-346.08	-941.05	7.65
6332.00	65.51	246.58	6122.51	-361.86	-980.40	7.51
6378.00	67.66	241.93	6140.80	-380.21	-1018.40	10.39
6424.00	68.33	238.24	6158.04	-401.47	-1055.35	7.58
6471.00	67.75	233.35	6175.63	-425.96	-1091.39	9.73
6517.00	65.94	229.03	6193.72	-452.45	-1124.34	9.49
6564.00	64.26	224.20	6213.52	-481.72	-1155.32	9.98
6610.00	64.79	220.05	6233.31	-512.51	-1183.17	8.23
6656.00	65.79	217.10	6252.54	-545.18	-1209.21	6.22
6703.00	67.00	213.21	6271.37	-580.38	-1234.00	8.01
6749.00	68.94	208.33	6288.63	-617.01	-1255.80	10.70
6795.00	70.41	203.18	6304.62	-655.85	-1274.52	10.97
6842.00	72.98	197.11	6319.39	-697.72	-1289.86	13.42
6888.00	73.93	192.79	6332.50	-740.31	-1301.23	9.24
6934.00	74.04	188.06	6345.19	-783.78	-1309.23	9.89
6981.00	74.86	185.44	6357.79	-828.74	-1314.55	5.65
7027.00	76.45	182.60	6369.19	-873.19	-1317.67	6.91
7074.00	77.63	178.31	6379.74	-918.98	-1318.03	9.24
7120.00	78.92	173.98	6389.09	-963.91	-1315.00	9.63

Received
Office of Oil & Gas

JAN 08 2016

03/04/2016

Alice Edge OHI 206H EOW Survey Report

7167.00	80.44	170.14	6397.51	-1009.69	-1308.61	8.66
7213.00	83.71	166.70	6403.86	-1054.31	-1299.46	10.27
7259.00	85.60	162.58	6408.14	-1098.46	-1287.33	9.82
7306.00	87.94	159.59	6410.79	-1142.85	-1272.12	8.07
7352.00	89.60	158.91	6411.78	-1185.85	-1255.82	3.90
7445.00	88.37	152.32	6413.43	-1270.49	-1217.46	7.21
7538.00	89.26	155.33	6415.35	-1353.93	-1176.45	3.37
7631.00	89.29	160.14	6416.53	-1439.96	-1141.22	5.17
7723.00	89.32	164.53	6417.65	-1527.60	-1113.32	4.77
7816.00	88.74	168.01	6419.22	-1617.91	-1091.25	3.79
7909.00	88.98	162.07	6421.07	-1707.70	-1067.26	6.39
8002.00	89.14	158.72	6422.60	-1795.29	-1036.06	3.61
8095.00	89.08	155.38	6424.04	-1880.90	-999.81	3.59
8187.00	89.08	157.05	6425.52	-1965.07	-962.71	1.81
8280.00	89.08	157.86	6427.01	-2050.95	-927.06	0.87
8373.00	89.08	154.58	6428.51	-2136.04	-889.57	3.53
8466.00	89.11	151.43	6429.98	-2218.88	-847.36	3.39
8558.00	89.05	150.15	6431.45	-2299.17	-802.47	1.39
8652.00	89.05	150.74	6433.01	-2380.93	-756.11	0.63
8745.00	89.08	151.51	6434.53	-2462.36	-711.21	0.83
8837.00	89.08	158.62	6436.01	-2545.72	-672.45	7.73
8930.00	88.98	159.29	6437.58	-2632.50	-639.06	0.73
9023.00	89.72	161.92	6438.64	-2720.21	-608.18	2.94
9116.00	89.51	162.59	6439.26	-2808.78	-579.84	0.75
9208.00	89.45	159.80	6440.10	-2895.86	-550.19	3.03
9301.00	89.57	153.54	6440.90	-2981.21	-513.38	6.73
9394.00	89.63	151.62	6441.55	-3063.75	-470.55	2.07
9487.00	89.63	150.65	6442.15	-3145.20	-425.66	1.04
9579.00	89.48	158.08	6442.86	-3228.08	-385.89	8.08
9672.00	89.60	160.30	6443.61	-3315.01	-352.85	2.39
9765.00	89.54	158.42	6444.31	-3402.03	-320.07	2.02
9858.00	89.45	153.39	6445.13	-3486.90	-282.11	5.41
9951.00	89.48	154.92	6445.99	-3570.59	-241.58	1.65
10043.00	89.38	156.65	6446.91	-3654.49	-203.84	1.88
10136.00	89.23	158.31	6448.04	-3740.38	-168.23	1.79
10229.00	89.17	158.96	6449.34	-3826.98	-134.35	0.70
10322.00	89.14	161.40	6450.71	-3914.46	-102.82	2.62
10415.00	89.17	158.79	6452.08	-4001.89	-71.17	2.81
10507.00	89.23	156.49	6453.36	-4086.96	-36.17	2.50
10600.00	89.20	158.93	6454.64	-4172.99	-0.91	2.62
10693.00	89.26	160.96	6455.89	-4260.34	30.98	2.18
10786.00	89.17	159.86	6457.16	-4347.95	62.16	1.19
10879.00	89.26	159.42	6458.44	-4435.13	94.51	0.48
10971.00	89.20	160.42	6459.67	-4521.53	126.10	1.09
11064.00	89.51	157.51	6460.72	-4608.31	159.47	3.15
11157.00	89.63	156.55	6461.42	-4693.94	195.76	1.04
11250.00	89.54	158.17	6462.09	-4779.77	231.56	1.74
11342.00	89.60	157.00	6462.78	-4864.81	266.64	1.27
11435.00	89.48	153.34	6463.53	-4949.20	305.69	3.94
11528.00	89.51	151.44	6464.35	-5031.60	348.78	2.04
11621.00	89.48	153.32	6465.17	-5113.99	391.89	2.02
11714.00	89.66	157.37	6465.87	-5198.50	430.68	4.36
11806.00	89.54	158.51	6466.51	-5283.76	465.23	1.25
11899.00	89.60	157.09	6467.21	-5369.86	500.37	1.53
11992.00	89.51	157.25	6467.93	-5455.57	536.45	0.20
12085.00	89.54	157.89	6468.70	-5541.53	571.94	0.69
12177.00	89.57	159.99	6469.42	-5627.38	604.99	2.28
12270.00	89.54	159.12	6470.14	-5714.52	637.48	0.94
12363.00	89.05	159.60	6471.28	-5801.54	670.26	0.74
12456.00	89.14	160.04	6472.75	-5888.82	702.33	0.48
12549.00	89.05	158.32	6474.22	-5975.73	735.38	1.85
12641.00	89.08	157.26	6475.72	-6060.90	770.16	1.15
12734.00	89.05	156.70	6477.24	-6146.48	806.52	0.60

Received
Office of Oil & Gas

JAN 08 2016

03/04/2016

Alice Edge OHI 206H EOW Survey Report

12827.00	89.08	156.65	6478.76	-6231.87	843.34	0.06
12920.00	89.11	156.40	6480.23	-6317.16	880.38	0.27
13013.00	89.05	155.99	6481.72	-6402.23	917.91	0.45
13105.00	89.02	155.45	6483.27	-6486.08	955.74	0.59
13198.00	89.02	155.86	6484.86	-6570.80	994.07	0.44
13291.00	89.08	156.14	6486.40	-6655.75	1031.89	0.31
13384.00	89.05	158.35	6487.92	-6741.50	1067.85	2.38
13477.00	89.32	160.01	6489.24	-6828.41	1100.90	1.81
13569.00	89.11	159.58	6490.50	-6914.74	1132.68	0.52
13662.00	89.05	159.69	6492.00	-7001.92	1165.04	0.13
13755.00	89.54	158.24	6493.14	-7088.71	1198.41	1.65
13848.00	89.57	160.28	6493.86	-7175.68	1231.34	2.19
13941.00	89.57	159.89	6494.56	-7263.11	1263.02	0.42
14033.00	89.66	159.52	6495.18	-7349.40	1294.93	0.41
14126.00	89.57	159.62	6495.80	-7436.55	1327.39	0.14
14219.00	89.57	158.21	6496.50	-7523.32	1360.85	1.52
14311.00	89.57	157.00	6497.19	-7608.37	1395.90	1.32
14404.00	89.54	154.87	6497.91	-7693.28	1433.82	2.29
14497.00	89.54	154.47	6498.66	-7777.34	1473.60	0.43
14556.00	89.57	154.07	6499.12	-7830.49	1499.22	0.68
14580.00	89.57	154.07	6499.30	-7852.07	1509.71	0.00

Received
Office of Oil & Gas

JAN 08 2016



Actual Wellpath Report

Alice Edge OHI 206H AWP Proj: 14580'
Page 1 of 8



REFERENCE WELLPATH IDENTIFICATION

Operator	SOUTHWESTERN ENERGY	Slot	Slot #206
Area	Ohio County, WV	Well	Alice Edge OHI 206H
Field	Ohio	Wellbore	Alice Edge OHI 206H AWB
Facility	Alice Edge OHI Pad A		

REPORT SETUP INFORMATION

Projection System	NAD83 / UTM Zone 17 North, US feet	Software System	WellArchitect® 4.0.1
North Reference	Grid	User	Edsaryar
Scale	0.999617	Report Generated	29/Apr/2015 at 09:29
Convergence at slot	0.28° East	Database/Source file	WellArchitectEasternDB/Alice_Edge_OHI_206H_AWB.xml

WELLPATH LOCATION

	Local coordinates		Grid coordinates		Geographic coordinates	
	North[ft]	East[ft]	Easting[US ft]	Northing[US ft]	Latitude	Longitude
Slot Location	-11.96	7.89	1763340.14	14563412.96	40°05'59.618"N	80°33'37.537"W
Facility Reference Pt			1763332.25	14563424.92	40°05'59.737"N	80°33'37.638"W
Field Reference Pt			0.00	0.00	0°00'00.000"	85°29'19.478"W

WELLPATH DATUM

Calculation method	Minimum curvature	Rocket Rig 40 (RKB) to Facility Vertical Datum	1225.20ft
Horizontal Reference Pt	Slot	Rocket Rig 40 (RKB) to Mean Sea Level	1225.20ft
Vertical Reference Pt	Rocket Rig 40 (RKB)	Rocket Rig 40 (RKB) to Mud Line at Slot (Slot #206)	26.00ft
MD Reference Pt	Rocket Rig 40 (RKB)	Section Origin	N 0.00, E 0.00 ft
Field Vertical Reference	Mean Sea Level	Section Azimuth	157.57°

Received
 Office of Oil & Gas
 JAN 08 2016



Actual Wellpath Report

Alice Edge OHI 206H AWP Proj: 14580'
Page 2 of 8



REFERENCE WELLPATH IDENTIFICATION			
Operator	SOUTHWESTERN ENERGY	Slot	Slot #206
Area	Ohio County, WV	Well	Alice Edge OHI 206H
Field	Ohio	Wellbore	Alice Edge OHI 206H AWB
Facility	Alice Edge OHI Pad A		

Received
 Office of Oil & Gas
 JAN 08 2016

WELLPATH DATA (180 stations) † = interpolated/extrapolated station															
MD [ft]	Inclination [°]	Azimuth [°]	TVD [ft]	Vert Sect [ft]	North [ft]	East [ft]	Grid East [US ft]	Grid North [US ft]	Latitude	Longitude	Closure Dist [ft]	Closure Dir [°]	DLS [°/100ft]	Build Rate [°/100ft]	Turn Rate [°/100ft]
0.00†	0.000	95.750	0.00	0.00	0.00	0.00	1763340.14	14563412.96	40°05'59.618"N	80°33'37.537"W	0.00	0.000	0.00	0.00	0.00
26.00	0.000	95.750	26.00	0.00	0.00	0.00	1763340.14	14563412.96	40°05'59.618"N	80°33'37.537"W	0.00	0.000	0.00	0.00	0.00
100.00	0.860	95.750	100.00	0.26	-0.06	0.55	1763340.69	14563412.90	40°05'59.618"N	80°33'37.530"W	0.56	95.750	1.16	1.16	0.00
200.00	0.420	88.780	199.99	0.75	-0.12	1.67	1763341.81	14563412.84	40°05'59.617"N	80°33'37.516"W	1.67	94.224	0.45	-0.44	-6.97
300.00	0.440	86.540	299.99	1.01	-0.09	2.42	1763342.55	14563412.87	40°05'59.617"N	80°33'37.506"W	2.42	92.182	0.03	0.02	-2.24
400.00	0.220	14.740	399.99	0.98	0.12	2.85	1763342.99	14563413.08	40°05'59.619"N	80°33'37.501"W	2.85	87.651	0.43	-0.22	-71.80
500.00	0.190	43.540	499.99	0.76	0.42	3.01	1763343.15	14563413.38	40°05'59.622"N	80°33'37.498"W	3.04	82.008	0.11	-0.03	28.80
600.00	0.180	42.280	599.99	0.62	0.66	3.23	1763343.37	14563413.62	40°05'59.625"N	80°33'37.496"W	3.30	78.469	0.01	-0.01	-1.26
636.00	0.380	27.920	635.98	0.52	0.81	3.32	1763343.46	14563413.77	40°05'59.626"N	80°33'37.494"W	3.42	76.365	0.58	0.56	-39.89
685.00	0.430	94.380	684.98	0.50	0.94	3.58	1763343.72	14563413.90	40°05'59.627"N	80°33'37.491"W	3.70	75.364	0.91	0.10	135.63
798.00	1.160	245.690	797.98	0.73	0.43	2.96	1763343.10	14563413.39	40°05'59.623"N	80°33'37.499"W	3.00	81.696	1.37	0.65	133.90
890.00	3.250	255.820	889.90	0.39	-0.59	-0.41	1763339.73	14563412.37	40°05'59.613"N	80°33'37.543"W	0.72	215.024	2.30	2.27	11.01
983.00	5.720	259.090	982.61	-0.92	-2.11	-7.52	1763332.62	14563410.85	40°05'59.598"N	80°33'37.634"W	7.81	254.308	2.67	2.66	3.52
1076.00	8.100	257.670	1074.93	-2.99	-4.39	-18.47	1763321.67	14563408.57	40°05'59.576"N	80°33'37.775"W	18.99	256.634	2.57	2.56	-1.53
1169.00	8.200	256.930	1166.99	-5.22	-7.29	-31.34	1763308.82	14563405.67	40°05'59.548"N	80°33'37.941"W	32.17	256.906	0.16	0.11	-0.80
1262.00	8.600	255.130	1258.99	-7.21	-10.57	-44.52	1763295.64	14563402.39	40°05'59.516"N	80°33'38.111"W	45.75	256.640	0.51	0.43	-1.94
1354.00	8.320	256.360	1349.99	-9.13	-13.91	-57.63	1763282.53	14563399.06	40°05'59.484"N	80°33'38.280"W	59.29	256.433	0.36	-0.30	1.34
1447.00	8.640	256.230	1441.98	-11.21	-17.16	-70.96	1763269.21	14563395.81	40°05'59.452"N	80°33'38.451"W	73.00	256.407	0.34	0.34	-0.14
1540.00	8.960	253.310	1533.88	-12.99	-20.90	-84.68	1763255.49	14563392.07	40°05'59.416"N	80°33'38.628"W	87.22	256.136	0.59	0.34	-3.14
1633.00	7.940	247.910	1625.87	-13.75	-25.40	-97.57	1763242.61	14563387.57	40°05'59.372"N	80°33'38.794"W	100.82	255.411	1.39	-1.10	-5.81
1726.00	7.880	246.120	1717.99	-13.63	-30.39	-109.35	1763230.83	14563382.58	40°05'59.323"N	80°33'38.946"W	113.49	254.468	0.27	-0.06	-1.92
1818.00	8.560	249.000	1809.04	-13.64	-35.40	-121.51	1763218.68	14563377.58	40°05'59.275"N	80°33'39.103"W	126.56	253.758	0.86	0.74	3.13
1911.00	9.280	250.100	1900.92	-14.15	-40.43	-135.02	1763205.17	14563372.54	40°05'59.225"N	80°33'39.277"W	140.94	253.330	0.80	0.77	1.18
2004.00	7.770	246.080	1992.89	-14.31	-45.53	-147.82	1763192.38	14563367.44	40°05'59.176"N	80°33'39.442"W	154.67	252.879	1.74	-1.62	-4.32
2075.00	6.820	243.050	2063.31	-13.86	-49.39	-155.96	1763184.24	14563363.59	40°05'59.138"N	80°33'39.547"W	163.60	252.428	1.44	-1.34	-4.27
2188.00	6.560	241.100	2175.54	-12.60	-55.55	-167.60	1763172.61	14563357.43	40°05'59.078"N	80°33'39.697"W	176.56	251.662	0.31	-0.23	-1.73
2281.00	6.170	233.510	2267.97	-10.79	-61.09	-176.27	1763163.94	14563351.89	40°05'59.023"N	80°33'39.809"W	186.55	250.885	1.00	-0.42	-8.16
2373.00	5.780	231.260	2359.47	-8.28	-66.93	-183.85	1763156.36	14563346.06	40°05'58.966"N	80°33'39.907"W	195.66	249.997	0.49	-0.42	-2.45
2466.00	5.890	234.980	2451.99	-5.93	-72.60	-191.41	1763148.80	14563340.39	40°05'58.910"N	80°33'40.005"W	204.72	249.230	0.42	0.12	4.00
2559.00	8.000	249.480	2544.31	-5.10	-77.61	-201.38	1763138.83	14563335.38	40°05'58.861"N	80°33'40.134"W	215.82	248.925	2.93	2.27	15.59



Actual Wellpath Report

Alice Edge OHI 206H AWP Proj: 14580'
Page 3 of 8



REFERENCE WELLPATH IDENTIFICATION			
Operator	SOUTHWESTERN ENERGY	Slot	Slot #206
Area	Ohio County, WV	Well	Alice Edge OHI 206H
Field	Ohio	Wellbore	Alice Edge OHI 206H AWB
Facility	Alice Edge OHI Pad A		

Received
Office of Oil & Gas
JAN 08 2016

WELLPATH DATA (180 stations)															
MD [ft]	Inclination [°]	Azimuth [°]	TVD [ft]	Vert Sect [ft]	North [ft]	East [ft]	Grid East [US ft]	Grid North [US ft]	Latitude	Longitude	Closure Dist [ft]	Closure Dir [°]	DLS [°/100ft]	Build Rate [°/100ft]	Turn Rate [°/100ft]
2652.00	8.190	249.200	2636.38	-5.51	-82.23	-213.64	1763126.58	14563330.77	40°05'58.816"N	80°33'40.292"W	228.92	248.949	0.21	0.20	-0.30
2745.00	7.550	244.890	2728.51	-5.41	-87.17	-225.36	1763114.86	14563325.82	40°05'58.768"N	80°33'40.443"W	241.63	248.853	0.94	-0.69	-4.63
2837.00	7.940	254.700	2819.67	-5.92	-91.41	-236.97	1763103.27	14563321.58	40°05'58.727"N	80°33'40.592"W	253.99	248.905	1.50	0.42	10.66
2930.00	8.130	255.430	2911.76	-7.61	-94.76	-249.53	1763090.71	14563318.23	40°05'58.694"N	80°33'40.754"W	266.91	249.205	0.23	0.20	0.78
3023.00	7.630	252.200	3003.88	-9.01	-98.30	-261.77	1763078.47	14563314.69	40°05'58.660"N	80°33'40.912"W	279.62	249.417	0.72	-0.54	-3.47
3116.00	8.410	255.970	3095.97	-10.50	-101.84	-274.25	1763066.00	14563311.16	40°05'58.625"N	80°33'41.073"W	292.54	249.628	1.01	0.84	4.05
3208.00	9.110	257.790	3186.90	-12.78	-105.01	-287.89	1763052.36	14563307.99	40°05'58.595"N	80°33'41.248"W	306.45	249.960	0.82	0.76	1.98
3301.00	8.490	255.430	3278.80	-15.02	-108.30	-301.73	1763038.52	14563304.71	40°05'58.563"N	80°33'41.427"W	320.58	250.256	0.77	-0.67	-2.54
3394.00	8.190	257.490	3370.82	-17.10	-111.46	-314.84	1763025.42	14563301.55	40°05'58.532"N	80°33'41.596"W	333.99	250.506	0.46	-0.32	2.22
3487.00	7.830	252.830	3462.91	-18.83	-114.76	-327.36	1763012.90	14563298.24	40°05'58.500"N	80°33'41.757"W	346.90	250.681	0.80	-0.39	-5.01
3580.00	7.700	249.700	3555.06	-19.64	-118.79	-339.26	1763001.01	14563294.21	40°05'58.461"N	80°33'41.910"W	359.46	250.702	0.48	-0.14	-3.37
3672.00	7.380	244.330	3646.27	-19.53	-123.49	-350.37	1762989.91	14563289.52	40°05'58.415"N	80°33'42.054"W	371.49	250.584	0.84	-0.35	-5.84
3765.00	8.180	250.900	3738.41	-19.58	-128.24	-362.00	1762978.28	14563284.76	40°05'58.369"N	80°33'42.204"W	384.05	250.492	1.28	0.86	7.06
3858.00	8.510	251.850	3830.43	-20.48	-132.55	-374.79	1762965.49	14563280.46	40°05'58.327"N	80°33'42.368"W	397.54	250.523	0.38	0.35	1.02
3951.00	8.330	250.610	3922.42	-21.35	-136.93	-387.69	1762952.60	14563276.08	40°05'58.284"N	80°33'42.535"W	411.16	250.546	0.27	-0.19	-1.33
4043.00	7.360	251.600	4013.56	-22.12	-141.01	-399.56	1762940.73	14563272.01	40°05'58.244"N	80°33'42.688"W	423.71	250.562	1.06	-1.05	1.08
4136.00	8.400	255.890	4105.68	-23.52	-144.54	-411.80	1762928.49	14563268.47	40°05'58.210"N	80°33'42.846"W	436.43	250.659	1.28	1.12	4.61
4229.00	8.240	252.220	4197.70	-25.04	-148.23	-424.74	1762915.57	14563264.78	40°05'58.174"N	80°33'43.012"W	449.86	250.761	0.60	-0.17	-3.95
4322.00	7.470	246.840	4289.83	-25.50	-152.65	-436.64	1762903.67	14563260.37	40°05'58.131"N	80°33'43.166"W	462.56	250.731	1.14	-0.83	-5.78
4414.00	8.380	254.300	4380.96	-26.21	-156.81	-448.60	1762891.72	14563256.21	40°05'58.091"N	80°33'43.320"W	475.21	250.732	1.49	0.99	8.11
4507.00	9.490	256.530	4472.83	-28.20	-160.43	-462.58	1762877.74	14563252.59	40°05'58.056"N	80°33'43.500"W	489.61	250.872	1.25	1.19	2.40
4600.00	9.240	251.590	4564.59	-29.92	-164.58	-477.12	1762863.21	14563248.45	40°05'58.015"N	80°33'43.687"W	504.70	250.969	0.90	-0.27	-5.31
4692.00	8.020	252.150	4655.54	-30.95	-168.88	-490.23	1762850.10	14563244.15	40°05'57.973"N	80°33'43.856"W	518.51	250.992	1.33	-1.33	0.61
4785.00	7.520	250.520	4747.69	-31.78	-172.89	-502.15	1762838.19	14563240.13	40°05'57.934"N	80°33'44.010"W	531.08	251.001	0.59	-0.54	-1.75
4878.00	7.090	242.750	4839.94	-31.61	-177.55	-512.99	1762827.35	14563235.48	40°05'57.889"N	80°33'44.150"W	542.84	250.909	1.16	-0.46	-8.35
4971.00	8.880	249.130	4932.03	-31.33	-182.74	-524.80	1762815.55	14563230.29	40°05'57.838"N	80°33'44.302"W	555.70	250.802	2.14	1.92	6.86
5063.00	10.030	244.070	5022.78	-31.03	-188.77	-538.64	1762801.71	14563224.26	40°05'57.779"N	80°33'44.480"W	570.76	250.686	1.54	1.25	-5.50
5156.00	9.830	237.850	5114.39	-29.20	-196.54	-552.64	1762787.71	14563216.50	40°05'57.703"N	80°33'44.661"W	586.55	250.423	1.17	-0.22	-6.69
5248.00	8.660	234.760	5205.20	-26.33	-204.71	-564.95	1762775.41	14563208.33	40°05'57.623"N	80°33'44.820"W	600.89	250.082	1.38	-1.27	-3.36
5341.00	7.790	235.580	5297.24	-23.47	-212.32	-575.87	1762764.49	14563200.73	40°05'57.548"N	80°33'44.961"W	613.76	249.762	0.94	-0.94	0.88



Actual Wellpath Report

Alice Edge OHI 206H AWP Proj: 14580'
Page 4 of 8



REFERENCE WELLPATH IDENTIFICATION Received			
Operator	SOUTHWESTERN ENERGY	Office of Oil & Gas	Slot #206
Area	Ohio County, WV		Well Alice Edge OHI 206H
Field	Ohio	JAN 08 2016	Wellbore Alice Edge OHI 206H AWB
Facility	Alice Edge OHI Pad A		

WELLPATH DATA (180 stations)															
MD [ft]	Inclination [°]	Azimuth [°]	TVD [ft]	Vert Sect [ft]	North [ft]	East [ft]	Grid East [US ft]	Grid North [US ft]	Latitude	Longitude	Closure Dist [ft]	Closure Dir [°]	DLS [°/100ft]	Build Rate [°/100ft]	Turn Rate [°/100ft]
5434.00	6.220	235.460	5389.54	-21.11	-218.73	-585.22	1762755.15	14563194.31	40°05'57.485"N	80°33'45.082"W	624.76	249.506	1.69	-1.69	-0.13
5521.00	7.430	235.890	5475.92	-18.98	-224.56	-593.76	1762746.61	14563188.48	40°05'57.428"N	80°33'45.192"W	634.80	249.283	1.39	1.39	0.49
5591.00	8.320	229.270	5545.27	-16.47	-230.40	-601.34	1762739.03	14563182.64	40°05'57.371"N	80°33'45.290"W	643.97	249.036	1.81	1.27	-9.46
5636.00	9.170	232.040	5589.74	-14.49	-234.73	-606.64	1762733.74	14563178.32	40°05'57.328"N	80°33'45.358"W	650.47	248.846	2.11	1.89	6.16
5683.00	11.370	240.040	5635.99	-12.88	-239.35	-613.60	1762726.77	14563173.70	40°05'57.283"N	80°33'45.448"W	658.64	248.690	5.57	4.68	17.02
5729.00	14.510	245.900	5680.82	-12.12	-243.97	-622.80	1762717.58	14563169.08	40°05'57.238"N	80°33'45.567"W	668.88	248.608	7.39	6.83	12.74
5775.00	17.440	248.400	5725.04	-12.05	-248.86	-634.47	1762705.92	14563164.19	40°05'57.190"N	80°33'45.717"W	681.53	248.583	6.54	6.37	5.43
5822.00	21.280	250.910	5769.37	-12.65	-254.25	-649.08	1762691.31	14563158.81	40°05'57.138"N	80°33'45.906"W	697.10	248.610	8.36	8.17	5.34
5868.00	25.220	251.670	5811.63	-13.83	-260.06	-666.28	1762674.12	14563153.00	40°05'57.081"N	80°33'46.127"W	715.24	248.678	8.59	8.57	1.65
5915.00	29.790	252.680	5853.30	-15.59	-266.69	-686.94	1762653.46	14563146.37	40°05'57.016"N	80°33'46.394"W	736.89	248.782	9.77	9.72	2.15
5961.00	34.260	253.880	5892.29	-18.03	-273.69	-710.30	1762630.11	14563139.37	40°05'56.948"N	80°33'46.695"W	761.21	248.928	9.81	9.72	2.61
6007.00	38.570	254.710	5929.30	-21.24	-281.07	-736.59	1762603.84	14563132.00	40°05'56.877"N	80°33'47.034"W	788.39	249.114	9.43	9.37	1.80
6053.00	42.370	254.680	5964.29	-24.94	-288.95	-765.38	1762575.06	14563124.12	40°05'56.800"N	80°33'47.405"W	818.10	249.317	8.26	8.26	-0.07
6100.00	46.460	253.670	5997.86	-28.71	-297.93	-797.01	1762543.43	14563115.15	40°05'56.713"N	80°33'47.812"W	850.88	249.504	8.83	8.70	-2.15
6146.00	51.260	252.000	6028.11	-31.87	-308.17	-830.10	1762510.36	14563104.91	40°05'56.613"N	80°33'48.239"W	885.45	249.633	10.79	10.43	-3.63
6193.00	55.730	251.530	6056.06	-34.63	-319.99	-865.97	1762474.51	14563093.09	40°05'56.498"N	80°33'48.701"W	923.20	249.720	9.54	9.51	-1.00
6239.00	60.110	251.080	6080.49	-37.17	-332.48	-902.88	1762437.61	14563080.61	40°05'56.377"N	80°33'49.177"W	962.15	249.784	9.56	9.52	-0.98
6285.00	63.420	249.730	6102.25	-39.16	-346.08	-941.05	1762399.46	14563067.01	40°05'56.244"N	80°33'49.669"W	1002.67	249.809	7.65	7.20	-2.93
6332.00	65.510	246.580	6122.51	-39.59	-361.86	-980.40	1762360.12	14563051.23	40°05'56.090"N	80°33'50.176"W	1045.05	249.741	7.51	4.45	-6.70
6378.00	67.660	241.930	6140.80	-37.13	-380.21	-1018.40	1762322.13	14563032.90	40°05'55.911"N	80°33'50.666"W	1087.06	249.528	10.39	4.67	-10.11
6424.00	68.330	238.240	6158.04	-31.58	-401.47	-1055.35	1762285.19	14563011.64	40°05'55.702"N	80°33'51.143"W	1129.14	249.172	7.58	1.46	-8.02
6471.00	67.750	233.350	6175.63	-22.69	-425.96	-1091.39	1762249.17	14562987.16	40°05'55.462"N	80°33'51.608"W	1171.57	248.680	9.73	-1.23	-10.40
6517.00	65.940	229.030	6193.72	-10.77	-452.45	-1124.34	1762216.23	14562960.68	40°05'55.202"N	80°33'52.034"W	1211.97	248.079	9.49	-3.93	-9.39
6564.00	64.260	224.200	6213.52	4.45	-481.72	-1155.32	1762185.26	14562931.43	40°05'54.914"N	80°33'52.434"W	1251.73	247.366	9.98	-3.57	-10.28
6610.00	64.790	220.050	6233.31	22.29	-512.51	-1183.17	1762157.43	14562900.65	40°05'54.611"N	80°33'52.795"W	1289.40	246.579	8.23	1.15	-9.02
6656.00	65.790	217.100	6252.54	42.55	-545.18	-1209.21	1762131.39	14562867.99	40°05'54.290"N	80°33'53.132"W	1326.43	245.732	6.22	2.17	-6.41
6703.00	67.000	213.210	6271.37	65.64	-580.38	-1234.00	1762106.61	14562832.80	40°05'53.943"N	80°33'53.453"W	1363.67	244.811	8.01	2.57	-8.28
6749.00	68.940	208.330	6288.63	91.18	-617.01	-1255.80	1762084.83	14562796.19	40°05'53.582"N	80°33'53.736"W	1399.19	243.834	10.70	4.22	-10.61
6795.00	70.410	203.180	6304.62	119.93	-655.85	-1274.52	1762066.11	14562757.36	40°05'53.199"N	80°33'53.979"W	1433.37	242.770	10.97	3.20	-11.20
6842.00	72.980	197.110	6319.39	152.78	-697.72	-1289.86	1762050.77	14562715.51	40°05'52.786"N	80°33'54.179"W	1466.48	241.590	13.42	5.47	-12.91

Received

Office of Oil & Gas

JAN 08 2016

REFERENCE WELLPATH IDENTIFICATION			
Operator	SOUTHWESTERN ENERGY	Slot	Slot #206
Area	Ohio County, WV	Well	Alice Edge OHI 206H
Field	Ohio	Wellbore	Alice Edge OHI 206H AWB
Facility	Alice Edge OHI Pad A		

WELLPATH DATA (180 stations)

MD [ft]	Inclination [°]	Azimuth [°]	TVD [ft]	Vert Sect [ft]	North [ft]	East [ft]	Grid East [US ft]	Grid North [US ft]	Latitude	Longitude	Closure Dist [ft]	Closure Dir [°]	DLS [°/100ft]	Build Rate [°/100ft]	Turn Rate [°/100ft]
6888.00	73.930	192.790	6332.50	187.81	-740.31	-1301.23	1762039.41	14562672.93	40°05'52.366"N	80°33'54.328"W	1497.09	240.363	9.24	2.07	-9.39
6934.00	74.040	188.060	6345.19	224.94	-783.78	-1309.23	1762031.41	14562629.48	40°05'51.937"N	80°33'54.434"W	1525.91	239.093	9.89	0.24	-10.28
6981.00	74.860	185.440	6357.79	264.47	-828.74	-1314.55	1762026.10	14562584.54	40°05'51.493"N	80°33'54.505"W	1553.98	237.771	5.65	1.74	-5.57
7027.00	76.450	182.600	6369.19	304.37	-873.19	-1317.67	1762022.98	14562540.10	40°05'51.053"N	80°33'54.548"W	1580.73	236.468	6.91	3.46	-6.17
7074.00	77.630	178.310	6379.74	346.56	-918.98	-1318.03	1762022.62	14562494.33	40°05'50.601"N	80°33'54.556"W	1606.77	235.114	9.24	2.51	-9.13
7120.00	78.920	173.980	6389.09	389.24	-963.91	-1315.00	1762025.65	14562449.42	40°05'50.157"N	80°33'54.520"W	1630.44	233.758	9.63	2.80	-9.41
7167.00	80.440	170.140	6397.51	434.00	-1009.69	-1308.61	1762032.04	14562403.66	40°05'49.704"N	80°33'54.440"W	1652.86	232.347	8.66	3.23	-8.17
7213.00	83.710	166.700	6403.86	478.74	-1054.31	-1299.46	1762041.18	14562359.05	40°05'49.263"N	80°33'54.325"W	1673.37	230.946	10.27	7.11	-7.48
7259.00	85.600	162.580	6408.14	524.18	-1098.46	-1287.33	1762053.31	14562314.92	40°05'48.826"N	80°33'54.172"W	1692.29	229.526	9.82	4.11	-8.96
7306.00	87.940	159.590	6410.79	571.00	-1142.85	-1272.12	1762068.51	14562270.55	40°05'48.387"N	80°33'53.979"W	1710.08	228.064	8.07	4.98	-6.36
7352.00	89.600	158.910	6411.78	616.97	-1185.85	-1255.82	1762084.80	14562227.57	40°05'47.961"N	80°33'53.772"W	1727.23	226.642	3.90	3.61	-1.48
7445.00	88.370	152.320	6413.43	709.85	-1270.49	-1217.46	1762123.15	14562142.96	40°05'47.122"N	80°33'53.284"W	1759.65	223.779	7.21	-1.32	-7.09
7538.00	89.260	155.330	6415.35	802.62	-1353.93	-1176.45	1762164.14	14562059.55	40°05'46.296"N	80°33'52.761"W	1793.64	220.988	3.37	0.96	3.24
7631.00	89.290	160.140	6416.53	895.58	-1439.96	-1141.22	1762199.36	14561973.55	40°05'45.444"N	80°33'52.313"W	1837.36	218.398	5.17	0.03	5.17
7723.00	89.320	164.530	6417.65	987.24	-1527.60	-1113.32	1762227.25	14561885.95	40°05'44.577"N	80°33'51.960"W	1890.24	216.085	4.77	0.03	4.77
7816.00	88.740	168.010	6419.22	1079.14	-1617.91	-1091.25	1762249.31	14561795.67	40°05'43.683"N	80°33'51.682"W	1951.53	213.999	3.79	-0.62	3.74
7909.00	88.980	162.070	6421.07	1171.29	-1707.70	-1067.26	1762273.29	14561705.92	40°05'42.795"N	80°33'51.379"W	2013.77	212.004	6.39	0.26	-6.39
8002.00	89.140	158.720	6422.60	1264.15	-1795.29	-1036.06	1762304.48	14561618.37	40°05'41.928"N	80°33'50.983"W	2072.79	209.989	3.61	0.17	-3.60
8095.00	89.080	155.380	6424.04	1357.12	-1880.90	-999.81	1762340.72	14561532.78	40°05'41.080"N	80°33'50.522"W	2130.12	207.993	3.59	-0.06	-3.59
8187.00	89.080	157.050	6425.52	1449.08	-1965.07	-962.71	1762377.80	14561448.64	40°05'40.246"N	80°33'50.050"W	2188.22	206.101	1.81	0.00	1.82
8280.00	89.080	157.860	6427.01	1542.07	-2050.95	-927.06	1762413.44	14561362.79	40°05'39.396"N	80°33'49.596"W	2250.74	204.324	0.87	0.00	0.87
8373.00	89.080	154.580	6428.51	1635.02	-2136.04	-889.57	1762450.92	14561277.75	40°05'38.553"N	80°33'49.119"W	2313.87	202.610	3.53	0.00	-3.53
8466.00	89.110	151.430	6429.98	1727.70	-2218.88	-847.36	1762493.10	14561194.93	40°05'37.733"N	80°33'48.581"W	2375.18	200.901	3.39	0.03	-3.39
8558.00	89.050	150.150	6431.45	1819.04	-2299.17	-802.47	1762537.98	14561114.67	40°05'36.937"N	80°33'48.009"W	2435.19	199.240	1.39	-0.07	-1.39
8652.00	89.050	150.740	6433.01	1912.31	-2380.93	-756.11	1762584.32	14561032.95	40°05'36.127"N	80°33'47.417"W	2498.11	197.618	0.63	0.00	0.63
8745.00	89.080	151.510	6434.53	2004.70	-2462.36	-711.21	1762629.20	14560951.55	40°05'35.320"N	80°33'46.845"W	2563.01	196.110	0.83	0.03	0.83
8837.00	89.080	158.620	6436.01	2096.55	-2545.72	-672.45	1762667.95	14560868.22	40°05'34.494"N	80°33'46.351"W	2633.03	194.797	7.73	0.00	7.73
8930.00	88.980	159.290	6437.58	2189.50	-2632.50	-639.06	1762701.32	14560781.47	40°05'33.635"N	80°33'45.927"W	2708.96	193.645	0.73	-0.11	0.72
9023.00	89.720	161.920	6438.64	2282.36	-2720.21	-608.18	1762732.19	14560693.80	40°05'32.767"N	80°33'45.536"W	2787.37	192.603	2.94	0.80	2.83
9116.00	89.510	162.590	6439.26	2375.05	-2808.78	-579.84	1762760.52	14560605.26	40°05'31.890"N	80°33'45.176"W	2868.01	191.664	0.75	-0.23	0.72



Actual Wellpath Report

Alice Edge OHI 206H AWP Proj: 14580'
Page 6 of 8



REFERENCE WELLPATH IDENTIFICATION			
Operator	SOUTHWESTERN ENERGY	Slot	Slot #206
Area	Ohio County, WV	Well	Alice Edge OHI 206H
Field	Ohio	Wellbore	Alice Edge OHI 206H AWB
Facility	Alice Edge OHI Pad A		

Received
Office of Oil & Gas
JAN 08 2016

WELLPATH DATA (180 stations)															
MD [ft]	Inclination [°]	Azimuth [°]	TVD [ft]	Vert Sect [ft]	North [ft]	East [ft]	Grid East [US ft]	Grid North [US ft]	Latitude	Longitude	Closure Dist [ft]	Closure Dir [°]	DLS [°/100ft]	Build Rate [°/100ft]	Turn Rate [°/100ft]
9208.00	89.450	159.800	6440.10	2466.85	-2895.86	-550.19	1762790.16	14560518.22	40°05'31.028"N	80°33'44.800"W	2947.66	190.757	3.03	-0.07	-3.03
9301.00	89.570	153.540	6440.90	2559.79	-2981.21	-513.38	1762826.96	14560432.90	40°05'30.183"N	80°33'44.332"W	3025.09	189.771	6.73	0.13	-6.73
9394.00	89.630	151.620	6441.55	2652.43	-3063.75	-470.55	1762869.77	14560350.38	40°05'29.365"N	80°33'43.786"W	3099.68	188.732	2.07	0.06	-2.06
9487.00	89.630	150.650	6442.15	2744.84	-3145.20	-425.66	1762914.65	14560268.97	40°05'28.558"N	80°33'43.214"W	3173.87	187.707	1.04	0.00	-1.04
9579.00	89.480	158.080	6442.86	2836.63	-3228.08	-385.89	1762954.40	14560186.12	40°05'27.737"N	80°33'42.707"W	3251.06	186.817	8.08	-0.16	8.08
9672.00	89.600	160.300	6443.61	2929.58	-3315.01	-352.85	1762987.43	14560099.23	40°05'26.877"N	80°33'42.288"W	3333.73	186.076	2.39	0.13	2.39
9765.00	89.540	158.420	6444.31	3022.53	-3402.03	-320.07	1763020.19	14560012.24	40°05'26.015"N	80°33'41.872"W	3417.05	185.375	2.02	-0.06	-2.02
9858.00	89.450	153.390	6445.13	3115.46	-3486.90	-282.11	1763058.13	14559927.41	40°05'25.175"N	80°33'41.389"W	3498.29	184.626	5.41	-0.10	-5.41
9951.00	89.480	154.920	6445.99	3208.29	-3570.59	-241.58	1763098.66	14559843.75	40°05'24.345"N	80°33'40.872"W	3578.75	183.871	1.65	0.03	1.65
10043.00	89.380	156.650	6446.91	3300.23	-3654.49	-203.84	1763136.37	14559759.88	40°05'23.515"N	80°33'40.392"W	3660.17	183.193	1.88	-0.11	1.88
10136.00	89.230	158.310	6448.04	3393.22	-3740.38	-168.23	1763171.98	14559674.01	40°05'22.664"N	80°33'39.939"W	3744.17	182.575	1.79	-0.16	1.78
10229.00	89.170	158.960	6449.34	3486.20	-3826.98	-134.35	1763205.84	14559587.45	40°05'21.807"N	80°33'39.509"W	3829.34	182.011	0.70	-0.06	0.70
10322.00	89.140	161.400	6450.71	3579.08	-3914.46	-102.82	1763237.36	14559500.01	40°05'20.941"N	80°33'39.109"W	3915.81	181.505	2.62	-0.03	2.62
10415.00	89.170	158.790	6452.08	3671.98	-4001.89	-71.17	1763269.00	14559412.61	40°05'20.075"N	80°33'38.707"W	4002.52	181.019	2.81	0.03	-2.81
10507.00	89.230	156.490	6453.36	3763.96	-4086.96	-36.17	1763303.98	14559327.58	40°05'19.233"N	80°33'38.262"W	4087.12	180.507	2.50	0.07	-2.50
10600.00	89.200	158.930	6454.64	3856.94	-4172.99	-0.91	1763339.24	14559241.57	40°05'18.381"N	80°33'37.814"W	4172.99	180.012	2.62	-0.03	2.62
10693.00	89.260	160.960	6455.89	3949.85	-4260.34	30.98	1763371.11	14559154.26	40°05'17.516"N	80°33'37.409"W	4260.45	179.583	2.18	0.06	2.18
10786.00	89.170	159.860	6457.16	4042.73	-4347.95	62.16	1763402.28	14559066.69	40°05'16.649"N	80°33'37.014"W	4348.39	179.181	1.19	-0.10	-1.18
10879.00	89.260	159.420	6458.44	4135.66	-4435.13	94.51	1763434.62	14558979.54	40°05'15.786"N	80°33'36.603"W	4436.14	178.779	0.48	0.10	-0.47
10971.00	89.200	160.420	6459.67	4227.57	-4521.53	126.10	1763466.19	14558893.17	40°05'14.930"N	80°33'36.202"W	4523.29	178.403	1.09	-0.07	1.09
11064.00	89.510	157.510	6460.72	4320.53	-4608.31	159.47	1763499.55	14558806.42	40°05'14.071"N	80°33'35.778"W	4611.07	178.018	3.15	0.33	-3.13
11157.00	89.630	156.550	6461.42	4413.52	-4693.94	195.76	1763535.83	14558720.83	40°05'13.223"N	80°33'35.317"W	4698.02	177.612	1.04	0.13	-1.03
11250.00	89.540	158.170	6462.09	4506.51	-4779.77	231.56	1763571.61	14558635.03	40°05'12.373"N	80°33'34.862"W	4785.37	177.226	1.74	-0.10	1.74
11342.00	89.600	157.000	6462.78	4598.51	-4864.81	266.64	1763606.68	14558550.02	40°05'11.531"N	80°33'34.416"W	4872.11	176.863	1.27	0.07	-1.27
11435.00	89.480	153.340	6463.53	4691.41	-4949.20	305.69	1763645.71	14558465.67	40°05'10.695"N	80°33'33.919"W	4958.63	176.466	3.94	-0.13	-3.94
11528.00	89.510	151.440	6464.35	4784.02	-5031.60	348.78	1763688.79	14558383.30	40°05'09.879"N	80°33'33.370"W	5043.67	176.035	2.04	0.03	-2.04
11621.00	89.480	153.320	6465.17	4876.63	-5113.99	391.89	1763731.88	14558300.93	40°05'09.063"N	80°33'32.820"W	5128.99	175.618	2.02	-0.03	2.02
11714.00	89.660	157.370	6465.87	4969.54	-5198.50	430.68	1763770.66	14558216.46	40°05'08.226"N	80°33'32.327"W	5216.31	175.264	4.36	0.19	4.35
11806.00	89.540	158.510	6466.51	5061.53	-5283.76	465.23	1763805.19	14558131.24	40°05'07.381"N	80°33'31.888"W	5304.20	174.968	1.25	-0.13	1.24
11899.00	89.600	157.090	6467.21	5154.53	-5369.86	500.37	1763840.32	14558045.17	40°05'06.529"N	80°33'31.441"W	5393.12	174.676	1.53	0.06	-1.53



Actual Wellpath Report

Alice Edge OHI 206H AWP Proj: 14580'
Page 7 of 8



REFERENCE WELLPATH IDENTIFICATION				
Operator	SOUTHWESTERN ENERGY		Slot	Slot #206
Area	Ohio County, WV		Well	Alice Edge OHI 206H
Field	Ohio		Wellbore	Alice Edge OHI 206H AWB
Facility	Alice Edge OHI Pad A			

WELLPATH DATA (180 stations)															
MD [ft]	Inclination [°]	Azimuth [°]	TVD [ft]	Vert Sect [ft]	North [ft]	East [ft]	Grid East [US ft]	Grid North [US ft]	Latitude	Longitude	Closure Dist [ft]	Closure Dir [°]	DLS [°/100ft]	Build Rate [°/100ft]	Turn Rate [°/100ft]
11992.00	89.510	157.250	6467.93	5247.52	-5455.57	536.45	1763876.39	14557959.49	40°05'05.680"N	80°33'30.982"W	5481.88	174.384	0.20	-0.10	0.17
12085.00	89.540	157.890	6468.70	5340.52	-5541.53	571.94	1763911.86	14557873.56	40°05'04.829"N	80°33'30.531"W	5570.97	174.107	0.69	0.03	0.69
12177.00	89.570	159.990	6469.42	5432.48	-5627.38	604.99	1763944.90	14557787.75	40°05'03.979"N	80°33'30.111"W	5659.81	173.864	2.28	0.03	2.28
12270.00	89.540	159.120	6470.14	5525.43	-5714.52	637.48	1763977.37	14557700.64	40°05'03.116"N	80°33'29.699"W	5749.96	173.635	0.94	-0.03	-0.94
12363.00	89.050	159.600	6471.28	5618.37	-5801.54	670.26	1764010.14	14557613.65	40°05'02.255"N	80°33'29.283"W	5840.13	173.410	0.74	-0.53	0.52
12456.00	89.140	160.040	6472.75	5711.29	-5888.82	702.33	1764042.20	14557526.41	40°05'01.390"N	80°33'28.876"W	5930.55	173.199	0.48	0.10	0.47
12549.00	89.050	158.320	6474.22	5804.24	-5975.73	735.38	1764075.24	14557439.53	40°05'00.530"N	80°33'28.456"W	6020.81	172.984	1.85	-0.10	-1.85
12641.00	89.080	157.260	6475.72	5896.22	-6060.90	770.16	1764110.00	14557354.40	40°04'59.687"N	80°33'28.014"W	6109.63	172.758	1.15	0.03	-1.15
12734.00	89.050	156.700	6477.24	5989.20	-6146.48	806.52	1764146.35	14557268.85	40°04'58.839"N	80°33'27.552"W	6199.17	172.525	0.60	-0.03	-0.60
12827.00	89.080	156.650	6478.76	6082.18	-6231.87	843.34	1764183.15	14557183.49	40°04'57.994"N	80°33'27.084"W	6288.67	172.293	0.06	0.03	-0.05
12920.00	89.110	156.400	6480.23	6175.15	-6317.16	880.38	1764220.18	14557098.23	40°04'57.149"N	80°33'26.613"W	6378.21	172.066	0.27	0.03	-0.27
13013.00	89.050	155.990	6481.72	6268.12	-6402.23	917.91	1764257.70	14557013.19	40°04'56.306"N	80°33'26.135"W	6467.70	171.841	0.45	-0.06	-0.44
13105.00	89.020	155.450	6483.27	6360.05	-6486.08	955.74	1764295.51	14556929.37	40°04'55.476"N	80°33'25.654"W	6556.12	171.618	0.59	-0.03	-0.59
13198.00	89.020	155.860	6484.86	6452.99	-6570.80	994.07	1764333.82	14556844.69	40°04'54.637"N	80°33'25.166"W	6645.57	171.397	0.44	0.00	0.44
13291.00	89.080	156.140	6486.40	6545.94	-6655.75	1031.89	1764371.63	14556759.77	40°04'53.795"N	80°33'24.685"W	6735.27	171.187	0.31	0.06	0.30
13384.00	89.050	158.350	6487.92	6638.92	-6741.50	1067.85	1764407.58	14556674.06	40°04'52.946"N	80°33'24.228"W	6825.55	170.999	2.38	-0.03	2.38
13477.00	89.320	160.010	6489.24	6731.87	-6828.41	1100.90	1764440.62	14556587.18	40°04'52.086"N	80°33'23.808"W	6916.59	170.841	1.81	0.29	1.78
13569.00	89.110	159.580	6490.50	6823.79	-6914.74	1132.68	1764472.38	14556500.88	40°04'51.231"N	80°33'23.405"W	7006.90	170.697	0.52	-0.23	-0.47
13662.00	89.050	159.690	6492.00	6916.72	-7001.92	1165.04	1764504.73	14556413.74	40°04'50.368"N	80°33'22.994"W	7098.18	170.553	0.13	-0.06	0.12
13755.00	89.540	158.240	6493.14	7009.68	-7088.71	1198.41	1764538.09	14556326.98	40°04'49.509"N	80°33'22.571"W	7189.30	170.404	1.65	0.53	-1.56
13848.00	89.570	160.280	6493.86	7102.63	-7175.68	1231.34	1764571.01	14556240.04	40°04'48.648"N	80°33'22.153"W	7280.56	170.263	2.19	0.03	2.19
13941.00	89.570	159.890	6494.56	7195.54	-7263.11	1263.02	1764602.68	14556152.64	40°04'47.782"N	80°33'21.751"W	7372.11	170.135	0.42	0.00	-0.42
14033.00	89.660	159.520	6495.18	7287.48	-7349.40	1294.93	1764634.57	14556066.39	40°04'46.928"N	80°33'21.346"W	7462.61	170.007	0.41	0.10	-0.40
14126.00	89.570	159.620	6495.80	7380.42	-7436.55	1327.39	1764667.02	14555979.27	40°04'46.065"N	80°33'20.934"W	7554.08	169.880	0.14	-0.10	0.11
14219.00	89.570	158.210	6496.50	7473.39	-7523.32	1360.85	1764700.46	14555892.54	40°04'45.206"N	80°33'20.509"W	7645.40	169.747	1.52	0.00	-1.52
14311.00	89.570	157.000	6497.19	7565.38	-7608.37	1395.90	1764735.50	14555807.51	40°04'44.364"N	80°33'20.063"W	7735.36	169.604	1.32	0.00	-1.32
14404.00	89.540	154.870	6497.91	7658.34	-7693.28	1433.82	1764773.41	14555722.64	40°04'43.523"N	80°33'19.581"W	7825.75	169.443	2.29	-0.03	-2.29
14497.00	89.540	154.470	6498.66	7751.21	-7777.34	1473.60	1764813.18	14555638.61	40°04'42.690"N	80°33'19.075"W	7915.71	169.271	0.43	0.00	-0.43
14556.00	89.570	154.070	6499.12	7810.11	-7830.49	1499.22	1764838.78	14555585.49	40°04'42.164"N	80°33'18.749"W	7972.71	169.161	0.68	0.05	-0.68
14580.00	89.570	154.070	6499.30	7834.07	-7852.07	1509.71	1764849.27	14555563.91	40°04'41.950"N	80°33'18.615"W	7995.89	169.117	0.00	0.00	0.00



Actual Wellpath Report

Alice Edge OHI 206H AWP Proj: 14580'
Page 8 of 8



REFERENCE WELLPATH IDENTIFICATION			
Operator	SOUTHWESTERN ENERGY	Slot	Slot #206
Area	Ohio County, WV	Well	Alice Edge OHI 206H
Field	Ohio	Wellbore	Alice Edge OHI 206H AWB
Facility	Alice Edge OHI Pad A		

TARGETS									
Name	MD [ft]	TVD [ft]	North [ft]	East [ft]	Grid East [US ft]	Grid North [US ft]	Latitude	Longitude	Shape
Alice Edge OHI 206H LP Rev-5		6418.00	-1158.07	-1252.41	1762088.21	14562255.34	40°05'48.235"N	80°33'53.726"W	point
Alice Edge OHI 206H BHL Plat		6490.00	-7908.91	1534.30	1764873.85	14555507.09	40°04'41.387"N	80°33'18.302"W	point
Alice Edge OHI 206H BHL Rev-5		6502.33	-7853.44	1511.46	1764851.02	14555562.54	40°04'41.936"N	80°33'18.593"W	point

WELLPATH COMPOSITION - Ref Wellbore: Alice Edge OHI 206H AWB Ref Wellpath: Alice Edge OHI 206H AWP Proj: 14580'				
Start MD [ft]	End MD [ft]	Positional Uncertainty Model	Log Name/Comment	Wellbore
26.00	636.00	Generic gyro - northseeking (Standard)	01_MS Gyro <17-1/2"> (100'-636')	Alice Edge OHI 206H AWB
636.00	685.00	Generic gyro - northseeking (Standard)	02_MS Gyro Orient <12-1/4"> (685')	Alice Edge OHI 206H AWB
685.00	2075.00	NaviTrak (MagCorr)	03_APS EM <12-1/4"> (685')(798'-2075')	Alice Edge OHI 206H AWB
2075.00	5521.00	NaviTrak (MagCorr)	04_APS EM <8-3/4"> (2075')(2188'-5521')	Alice Edge OHI 206H AWB
5521.00	14556.00	NaviTrak (MagCorr)	05_BHI AT Curve <8-1/2"> (5521')(5591'-14556')	Alice Edge OHI 206H AWB
14556.00	14580.00	Blind Drilling (std)	Projection to bit	Alice Edge OHI 206H AWB

Received
Office of Oil & Gas
 JAN 08 2016