

THRASHER AS-DRILLED

THE THRASHER GROUP, INC.
600 WHITE OAKS BLVD.
BRIDGEPORT, WV 26330
PHONE 304-624-4108

TRACT	SURFACE OWNER (S) / ROYALTY OWNER (R)	TAX PARCEL	ACRES	LEASE NO.
1	ALICE MAE EDGE	3-L11-23	103.0	1-292390-000
2	LYNN & YVONNE REUSSER	3-L11-21	70.90	47-000579-000
3	LYNN & YVONNE REUSSER	3-L11-20	103.80	47-000579-000
4	MICHAEL & MELISSA J VARGO	3-L11-10	134.94	01-324194-000
5	MICHAEL & MELISSA J VARGO	3-L11-10.7	1.22	01-324194-000
6	DAVID J MILLER	3-L11-8	26.89	01-265403-000
7	ROBERT J & TONYA L LEMASTERS	3-L11E-24	0.321	47-001958-000
8	ROBERT J & TONYA L LEMASTERS	3-L11E-24.1	0.321	47-001958-000
9	HOWARD G & DONA E TAYLOR	3-L11E-21	39.15	47-000079-000
10	FAYE J TAGGART	3-L11-3	66.00	47-0000193-000
11	TIM R & L L REED	3-L11-2.6	22.423	01-325754-000
12	JOHN L SMITH II & JOAN MARIE SMITH	3-LB-41	4.486	734034-000
13	WILLIAM F & NINA JUNE STRAUB	3-L11-1.3	24.50	01-383489-000
14	STEVE & SHARON K VARGO	3-LB-29	58.50	01-384424-000
15	JOHN L & JOAN MARIE SMITH	3-L7-48	120.58	01-385509-000
16	MICHELLE BONHAM	3-LB-24.1	6.00	01-313753-000
17	MICHELLE BONHAM	3-LB-24.10	4.00	01-313741-000
18	COREY M SOBOTA	3-LB-24	24.24	01-268384-000
19	DANIEL MCKEE	3-LB-24.8	9.26	01-329244-000
20	JOSEPH F BIPPUS SR ETAL	3-LB-1.3	96.046	01-385.04-000
21	BETTY JANE MEYERS	3-L7-8.3	22.084	01-385504-000
22	BETTY JANE MEYERS	3-L7-6.1	2.91	01-385504-000

GRID NORTH
UTM, NAD83 DATUM, ZONE 17, US FT

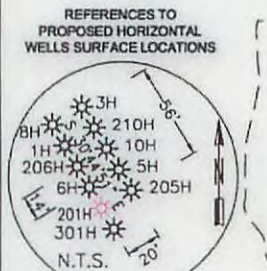
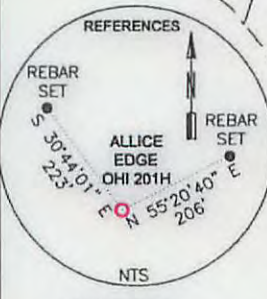

AS-DRILLED SURFACE HOLE LOCATION (SHL): UTM (NAD83, ZONE 17, METERS): NORTHING: 4,438,947.520 EASTING: 537,467.805
AS-DRILLED LANDING POINT LOCATION (LPL): UTM (NAD83, ZONE 17, METERS): NORTHING: 4,439,089.837 EASTING: 537,403.955
AS-DRILLED BOTTOM HOLE LOCATION (BHL): UTM (NAD83, ZONE 17, METERS): NORTHING: 4,441,755.916 EASTING: 536,186.648

I, THE UNDERSIGNED, HEREBY CERTIFY THAT THIS PLAT IS CORRECT TO THE BEST OF MY KNOWLEDGE AND BELIEF AND SHOWS ALL THE INFORMATION REQUIRED BY LAW AND REGULATIONS ISSUED AND PRESCRIBED BY THE DEPARTMENT OF ENVIRONMENTAL PROTECTION.
P.S. 2270 *[Signature]* 1/26/16

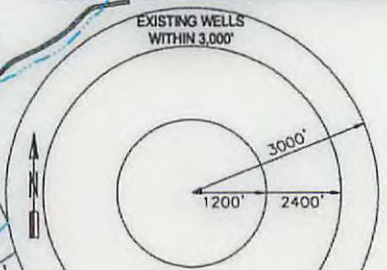

- NOTES ON SURVEY**
- COORDINATES SYSTEM IS UTM, NAD 83 DATUM, ZONE 17, U.S. FOOT AND WELL COORDINATES ESTABLISHED USING SURVEY GRADE GPS.
 - SURFACE AND ROYALTY OWNER INFORMATION AND THEIR BOUNDARIES SHOWN HEREON WERE PLOTTED FROM DEEDS AND/OR TAX PARCEL MAPS PROVIDED BY CLIENT AND FIELD LOCATIONS.
 - THIS PLAT DOES NOT REPRESENT A BOUNDARY SURVEY OF THE PARCELS SHOWN HEREON.
 - NO DWELLINGS AND BUILDINGS WITHIN 625 FEET OF PROPOSED CENTER OF PAD.
 - NO WATER WELLS OR DEVELOPED SPRINGS WITHIN 250 FEET OF PROPOSED WELL.
 - NO PERENNIAL STREAMS, LAKES, PONDS, RESERVOIRS OR WETLANDS WITHIN 100 FEET OF THE LIMITS OF DISTURBANCE.
 - NO NATURALLY PRODUCING TROUT STREAM WITHIN 300 FEET OF LIMITS OF DISTURBANCE.

SWN PRODUCTION COMPANY, LLC
"ALICE EDGE OHI 201H"
SURFACE HOLE
ELEV: 1199.4' (AS-DRILLED)

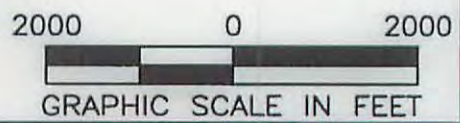

COMPANY: **SWN** Production Company, LLC

(+) DENOTES LOCATION OF WELL ON UNITED STATES TOPOGRAPHIC MAPS
WVDEP
OFFICE OF OIL & GAS
601 57TH STREET
CHARLESTON, WV 25034

MINIMUM DEGREE OF ACCURACY: 1/200
PROVEN SURVEY SOURCE OF GRADE GPS ELEVATION: (NAVD 88, US FT)

ALICE EDGE
OPERATOR'S WELL #: OHI 201H
API WELL #: 47 STATE 069 COUNTY 00181 PERMIT

WELL TYPE: OIL WASTE DISPOSAL PRODUCTION DEEP GAS LIQUID INJECTION STORAGE SHALLOW

WATERSHED: UPPER OHIO SOUTH ELEVATION: 1199.4
DISTRICT: LIBERTY COUNTY: OHIO QUADRANGLE: VALLEY GROVE
SURFACE OWNER: ALICE MAE EDGE ACREAGE: 103±
OIL & GAS ROYALTY OWNER: ALICE MAE EDGE ACREAGE: 969.538±

DRILL DRILL DEEPER REDRILL FRACTURE OR STIMULATE PLUG OFF OLD FORMATION PERFORATE NEW FORMATION
CONVERT PLUG & ABANDON CLEAN OUT & REPLUG OTHER CHANGE (SPECIFY)

TARGET FORMATION: MARCELLUS ESTIMATED DEPTH: 6,410 TO 18,275 TD

WELL OPERATOR: SWN PRODUCTION COMPANY, LLC DESIGNATED AGENT: DEE SOUTHALL
ADDRESS: P.O. BOX 1300 ADDRESS: P.O. BOX 1300
CITY: JANE LEW STATE: WV ZIP CODE: 26378 CITY: JANE LEW STATE: WV ZIP CODE: 26378

LEGEND: ○ PROPOSED SURFACE HOLE / BOTTOM HOLE ⊗ EXISTING / PRODUCING WELLHEAD ⊗ ABANDONED WELL ⊗ PLUGGED & ABANDONED WELL ⊗ CUT CONDUCTOR	REVISIONS:	DATE: 01-26-2016
--- LEASE BOUNDARY --- DESIGN DHP --- AS-DRILLED DHP --- ABANDONED DHP		DRAWN BY: E.LYLTLE SCALE: 1" = 2000' DRAWING NO: 030-2725 WELL LOCATION PLAT