

NOTE:  
NO WATER WELLS WERE FOUND WITHIN 250' OF THE CENTER OF WELL PAD.  
NO DWELLINGS WERE FOUND WITHIN 825' OF THE CENTER OF THE WELL PAD.

LESSOR	PARCEL	ACREAGE	LEASE NUMBER
A MICHAEL D. & MELISSA JEAN VARGO	L11-10.7	1.22 ACRES	01-324194-000
B SHARON L. EDGE	L11-9	1.78 ACRES	47-000321-000
C ROBERT J. & TORIA L. LEMASTERS	L11E-24	0.321 ACRES	47-001858-000
D ROBERT J. & TORIA L. LEMASTERS	L11E-24.1	0.321 ACRES	47-001858-000
E ROBERT J. & TORIA L. LEMASTERS	L11E-24.2	0.317 ACRES	47-002570-000
F GERALD C. BIRD & KYLEA J. SIMPKS	L11-2	9.50 ACRES	01-325791-000
G TIM B. & L.L. REED	L11-2.6	72.423 ACRES	01-325754-000
H JAMES C. & CHANDRA D. CARRINGTON	L8-24.5	4.00 ACRES	01-329128-000
I MICHELLE BOHMAN	L8-24.1	4.00 ACRES	01-313753-000
J MICHELLE BOHMAN	L8-24.10	4.00 ACRES	01-313741-000
K JOHN F. & SANTA SCHUTZ	L8-24.5	2.00 ACRES	01-327243-000
L DANIEL MOORE	L8-24.8	9.26 ACRES	01-329244-000
M JOSEPH F. BIPPUS, Sr	L8-1.4	1.45 ACRES	UNLEASED
N BETTY JANE MYERS	L7-8.1	2.81 ACRES	01-385504-000
O W.V. DEPARTMENT OF TRANSPORTATION	ROAD	N/A	47-000072-000

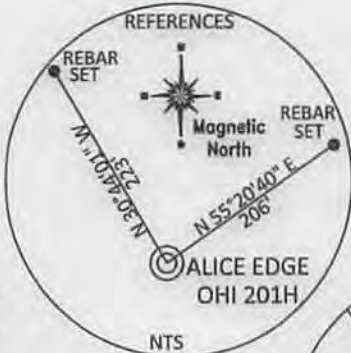
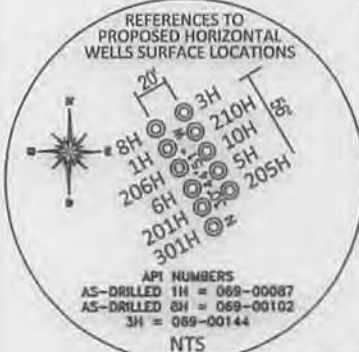

TOP HOLE (UTM NAD 83)	N) 4438929.9	E) 537471.5
BOTTOM HOLE (UTM NAD 83)	N) 4442125.8	E) 535836.9

REFERENCE NOTES  
Boundaries as shown taken from deeds, tax maps and field locations. A full boundary survey is not expressed nor implied. All bearings are based on true north. Ownership taken from public records OHIO County, West Virginia JUNE 2013  
State Plane Coordinates & NAD 83 Lat/Long by differential submeter mapping grade GPS  
Drafted by: EAM

FILE #: CHE 036

DRAWING #: 2370

SCALE: PLAT: 1" = 2000'  
TRK MARK: 1" = 2000'

MINIMUM DEGREE OF ACCURACY: 1/200

PROVEN SOURCE OF ELEVATION: SUBMETER MAPPING GRADE GPS

I, THE UNDERSIGNED, HEREBY CERTIFY THAT THIS PLAT IS CORRECT TO THE BEST OF MY KNOWLEDGE AND BELIEF AND SHOWS ALL THE INFORMATION REQUIRED BY LAW AND THE REGULATIONS ISSUED AND PRESCRIBED BY THE DEPARTMENT OF ENVIRONMENTAL PROTECTION.

Signed:

L.L.S. #2124 : Ernest J. Benchek III



(+) DENOTES LOCATION OF WELL ON UNITED STATES TOPOGRAPHIC MAPS WVDEP  
OFFICE OF OIL & GAS  
601 57TH STREET  
CHARLESTON, WV 25304

DATE: SEPTEMBER 29, 2014

OPERATOR'S WELL #: ALICE EDGE OHI 201H

API WELL #: 47 69 00181H6A  
STATE COUNTY PERMIT

Well Type:  Oil  Waste Diposal  Production  Deep  
 Gas  Liquid Injection  Storage  Shallow

WATERSHED: UPPER OHIO SOUTH ELEVATION: 1,198'

COUNTY/DISTRICT: OHIO / LIBERTY QUADRANGLE: VALLEY GROVE & BETHANY, WV

SURFACE OWNER: ALICE MAE EDGE ACREAGE: 103 +/-

OIL & GAS ROYALTY OWNER: ALICE MAE EDGE ACREAGE: 965.052 +/-

LEASE NUMBERS: \_\_\_\_\_

DRILL  CONVERT  DRILL DEEPER  REDRILL  FRACTURE OR STIMULATE   
PLUG OFF FORMATION  PERFORATE NEW FORMATION  PLUG & ABANDON   
CLEAN OUT & REPLUG  OTHER CHANGE  (SPECIFY): \_\_\_\_\_

TARGET FORMATION: MARCELLUS ESTIMATED DEPTH: TVD: 6,410' TMD: 19,275'

WELL OPERATOR: CHESAPEAKE APPALACHIA, LLC. DESIGNATED AGENT: ERIC B. GILLESPIE

ADDRESS: PO BOX 18496 ADDRESS: PO BOX 6070

CITY: OKLAHOMA CITY STATE: OK ZIP CODE: 73154-0496 CITY: CHARLESTON STATE: WV 10/10/2014 362

WELL: ALICE EDGE OHI 201H  
QUAD: VALLEY GROVE, WV & BETHANY, WV

4706900181

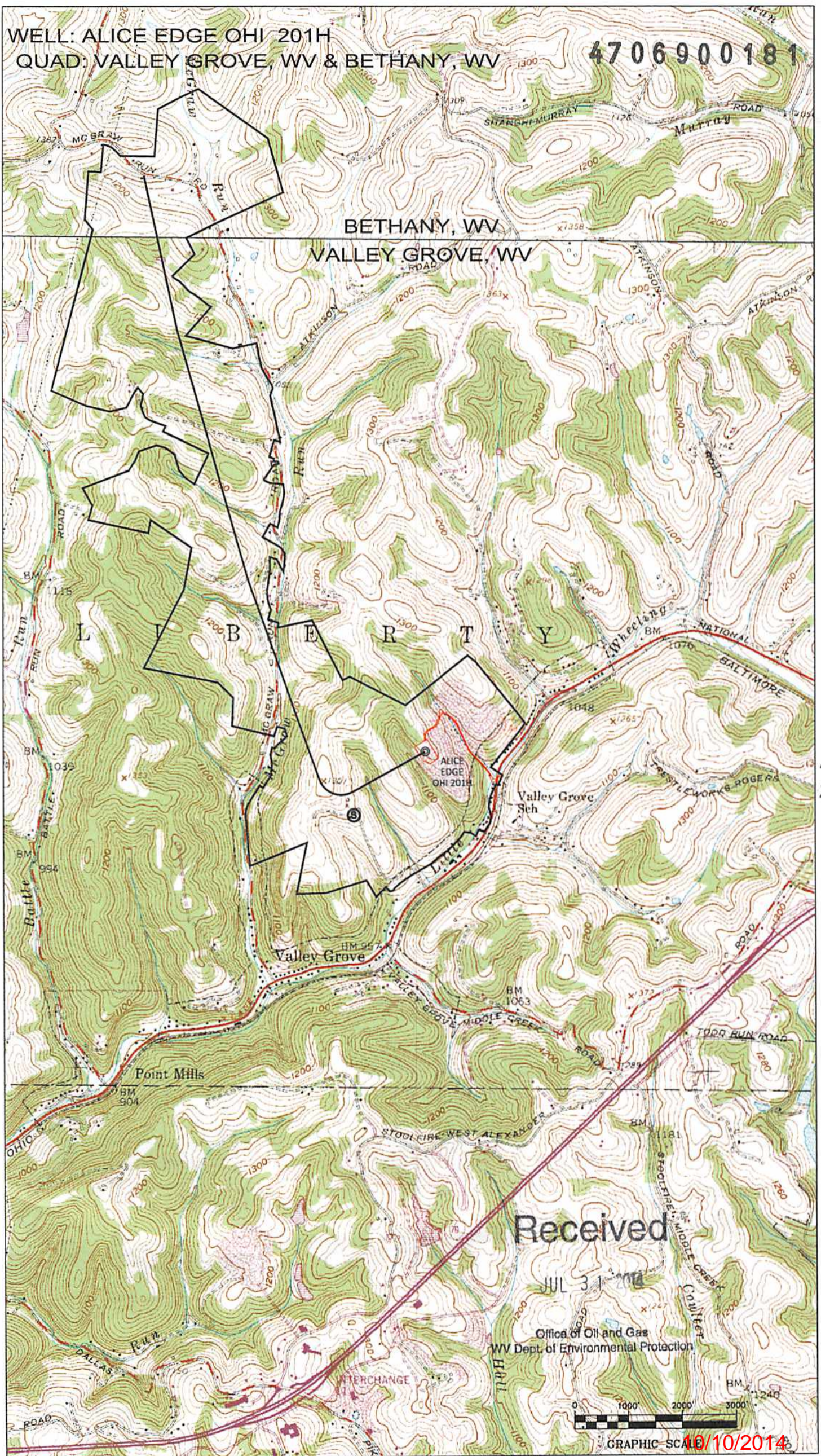

WPN  
7-23-14

Received

JUL 31 2014

Office of Oil and Gas  
WV Dept. of Environmental Protection

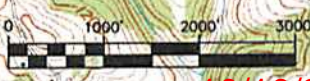

GRAPHIC SCALE 10/10/2014