

THRASHER

THE THRASHER GROUP, INC.
600 WHITE OAKS BLVD.
BRIDGEPORT, WV 26330
PHONE 304-624-4108

NOTES ON SURVEY

1. COORDINATES SYSTEM IS UTM, NAD 83 DATUM, ZONE 17, U.S. FOOT AND WELL COORDINATES ESTABLISHED USING SURVEY GRADE GPS.
2. SURFACE AND ROYALTY OWNER INFORMATION AND THEIR BOUNDARIES SHOWN HEREON WERE PLOTTED FROM DEEDS AND/OR TAX PARCEL MAPS PROVIDED BY CLIENT AND FIELD LOCATIONS.
3. THIS PLAT DOES NOT REPRESENT A BOUNDARY SURVEY OF THE PARCELS SHOWN HEREON.
4. NO DWELLINGS AND BUILDINGS WITHIN 625 FEET OF PROPOSED OF CENTER OF PAD.
5. NO WATER WELLS OR DEVELOPED SPRINGS WITHIN 250 FEET OF PROPOSED WELL.
6. NO PERENNIAL STREAMS, LAKES, PONDS, RESERVOIRS OR WETLANDS WITHIN 100 FEET OF THE LIMITS OF DISTURBANCE.
7. NO NATURALLY PRODUCING TROUT STREAM WITHIN 300 FEET OF LIMITS OF DISTURBANCE.

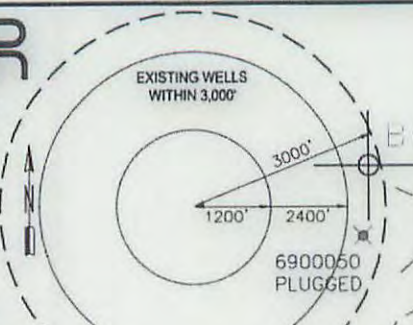

SURFACE OWNER (S) / ROYALTY OWNER (R)	TAX PARCEL	ACRES	LEASE NO.
1 ALICE MAE EDGE	3-L11-23	103.0	1-292590-000
2 ALICE MAE EDGE	3-L11-24	112.94	1-292590-000
3 BRUCE J KIGER	3-L11-25	40.436	1-304360-000
4 EDWARD G & JOAN GROUX	3-L11-27	113.0	
5 J & F CHAMBERS HOLDING	3-L11-26.5	20.2	47-000606-000
6 J & F CHAMBERS HOLDING	3-L11-26	194.84	47-000606-000
7 RICHARD L & R. L. ASHTON	3-LB-32.1	20.141	1-384429-000
8 ROBERT A & MARY ASHTON	3-LB-32.2	23.722	1-384430-000
9 BERNARD S & C. D. GAUS	3-LB-30.4	3.630	1-284428-000

AS-DRILLED

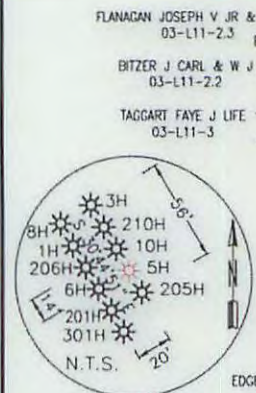

REFERENCES TO PROPOSED HORIZONTAL WELLS SURFACE LOCATIONS

AS-DRILLED SURFACE HOLE LOCATION (SHL): UTM (NAD83, ZONE 17, METERS): NORTHING: 4,438,936.564 EASTING: 537,474.593
AS-DRILLED LANDING POINT LOCATION (LPL): UTM (NAD83, ZONE 17, METERS): NORTHING: 4,439,279.653 EASTING: 537,706.239
AS-DRILLED BOTTOM HOLE LOCATION (BHL): UTM (NAD83, ZONE 17, METERS): NORTHING: 4,441,229.161 EASTING: 536,778.413

I, THE UNDERSIGNED, HEREBY CERTIFY THAT THIS PLAT IS CORRECT TO THE BEST OF MY KNOWLEDGE AND BELIEF AND SHOWS ALL THE INFORMATION REQUIRED BY LAW AND REGULATIONS ISSUED AND PRESCRIBED BY THE DEPARTMENT OF ENVIRONMENTAL PROTECTION.

P.S. 2270 *M.S. Wolf* 1/1/16

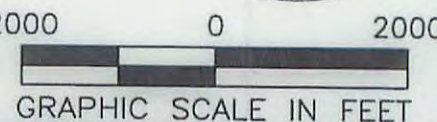
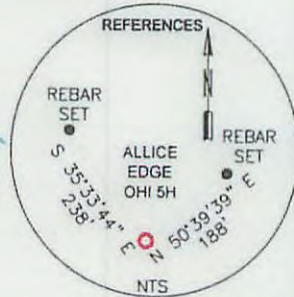
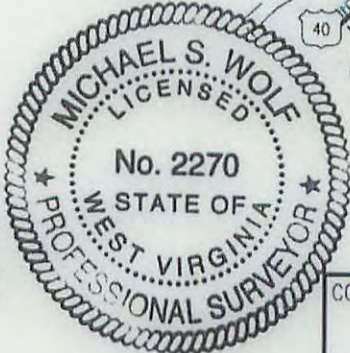

(+) DENOTES LOCATION OF WELL ON UNITED STATES TOPOGRAPHIC MAPS WVDEP OFFICE OF OIL & GAS 601 57TH STREET CHARLESTON, WV 25034	MINIMUM DEGREE OF ACCURACY: 1/200 PROVEN SURVEY SOURCE OF GRADE GPS ELEVATION: (NAVD 88, US FT)	COMPANY: SWN Production Company, LLC SWN Production Company™
	OPERATOR'S WELL #: ALICE EDGE OHI 5H API WELL #: 47 STATE 069 COUNTY 00178 PERMIT	WELL TYPE: OIL WASTE DISPOSAL PRODUCTION DEEP GAS <input checked="" type="checkbox"/> LIQUID INJECTION STORAGE SHALLOW <input checked="" type="checkbox"/> WATERSHED: UPPER OHIO SOUTH DISTRICT: LIBERTY COUNTY: OHIO SURFACE OWNER: ALICE MAE EDGE OIL & GAS ROYALTY OWNER: ALICE MAE EDGE DRILL <input checked="" type="checkbox"/> DRILL DEEPER REDRILL FRACTURE OR STIMULATE <input checked="" type="checkbox"/> PLUG OFF OLD FORMATION PERFORATE NEW FORMATION CONVERT PLUG & ABANDON CLEAN OUT & REPLUG OTHER CHANGE (SPECIFY)
WELL OPERATOR: SWN PRODUCTION COMPANY, LLC ADDRESS: P.O. BOX 1300 CITY: JANE LEW STATE: WV ZIP CODE: 26378	DESIGNATED AGENT: DEE SOUTHALL ADDRESS: P.O. BOX 1300 CITY: JANE LEW STATE: WV ZIP CODE: 26378	ESTIMATED DEPTH: 6,410 TVD 15,209 TMD DATE: 01-11-2016 DRAWN BY: KJP SCALE: 1" = 2000' DRAWING NO: 030-2725 WELL LOCATION PLAT

03/04/2016