



320 O'Bryan Lane • Van Buren, AR 72956  
Office: 479.474.7916 • Fax: 479.474.2450  
Surveying • handa-inc.com

LINE	BEARING	DISTANCE	DESCRIPTION	MONUMENT
L1	N 28°48'20" E	1235'	SHL TO LANDMARK	PARCEL CORNER
L2	S 61°10'01" E	1918'	SHL TO LANDMARK	PARCEL CORNER
L3	S 72°51'37" W	24.49'	SHL TO REF. PNT.	CHARLES FRYE OHI 3H WELL HEAD (069-00079)
L4	S 50°43'21" E	13.51'	SHL TO REF. PNT.	CHARLES FRYE OHI 10H WELL HEAD (069-00091)

LINE	BEARING	DISTANCE	CURVE LENGTH	DESCRIPTION
L5	S 09°40'10" W	1808.32'		SHL TO LP
L6	S 34°15'51" E	4680.72'		LP TO BHL

Latitude: 40°05'00"

Longitude: 80°32'30"

**NOTES ON SURVEY**

- COORDINATE SYSTEM IS UTM, NAD 83 DATUM, ZONE 17, U.S. FOOT AND WELL COORDINATES ESTABLISHED USING SURVEY GRADE GPS.
- SURFACE AND ROYALTY OWNER INFORMATION AND THEIR BOUNDARIES SHOWN HEREON WERE PLOTTED FROM DEEDS AND/OR TAX PARCEL MAPS PROVIDED BY CLIENT AND/OR FIELD LOCATIONS.
- THIS PLAT DOES NOT REPRESENT A BOUNDARY SURVEY OF THE PARCELS SHOWN HEREON.
- NO OCCUPIED DWELLINGS AND AGRICULTURE BUILDINGS GREATER THAN 2500 SQ FT. WITHIN 625 FEET OF PROPOSED OF CENTER OF PAD.
- NO WATER WELLS OR DEVELOPED SPRINGS WITHIN 250 FEET OF PROPOSED WELL.
- NO PERENNIAL STREAMS, LAKES, FONDS, OR RESERVOIRS WITHIN 100 FEET OF THE LIMITS OF DISTURBANCE.
- NO NATURALLY PRODUCING TROUT STREAM WITHIN 300 FEET OF LIMITS OF DISTURBANCE.
- NO GROUND INTAKE OR PUBLIC WATER SUPPLY WITHIN 1000 FEET OF WELL PAD, LIMITS OF DISTURBANCE, E & S CONTROLS OR PUBLIC WATER SUPPLY.

TRACT	SURFACE OWNER (S) / ROYALTY OWNER (R)	TAX PARCEL	ACRES
1	CHARLES FRYE & DOROTHY FRYE (S) DOROTHY V FRYE (R)	06-T14-01	105.00
2	ZACHARY ALLAN MEYER (S) ZACHARY MEYER & JENNIFER MEYER (R)	06-T14-02	91.58
3	ROBERT F LEECH (S) ROBERT F LEECH & DEBORAH A LEECH (R)	06-T14-04	5.62
4	ROBERT F LEECH (S) ROBERT F LEECH & DEBORAH A LEECH (R)	06-T14-04.1	7.10
5	JUSTUS LUZADER JR, LIFE ESTATE (S) JUSTUS LUZADER JR (R)	06-T14-11	57.513
6	CHRISTY M BOPP (S/R)	06-T14-10	54.866

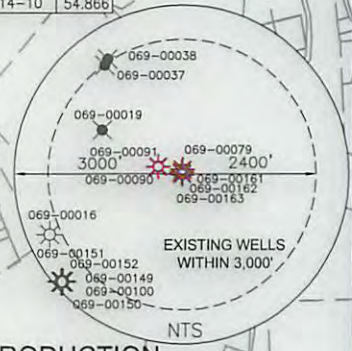
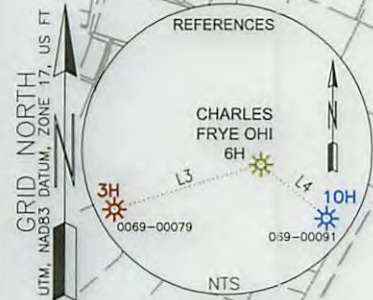

SURFACE HOLE LOCATION (SHL):	
GEOGRAPHIC (NAD83):	LATITUDE: 40.053144°
	LONGITUDE: -80.577062°
UTM (NAD83, ZONE 17, FEET):	NORTHING: 14,546,366.538
	EASTING: 1,758,769.222
UTM (NAD83, ZONE 17, METERS):	NORTHING: 4,433,741.389
	EASTING: 536,073.931
LANDING POINT LOCATION (LPL):	
GEOGRAPHIC (NAD83):	LATITUDE: 40.048253°
	LONGITUDE: -80.578177°
UTM (NAD83, ZONE 17, FEET):	NORTHING: 14,544,583.908
	EASTING: 1,758,465.492
UTM (NAD83, ZONE 17, METERS):	NORTHING: 4,433,198.042
	EASTING: 535,981.354
BOTTOM HOLE LOCATION (BHL):	
GEOGRAPHIC (NAD83):	LATITUDE: 40.037595°
	LONGITUDE: -80.568828°
UTM (NAD83, ZONE 17, FEET):	NORTHING: 14,540,715.528
	EASTING: 1,761,100.792
UTM (NAD83, ZONE 17, METERS):	NORTHING: 4,432,018.957
	EASTING: 536,784.595

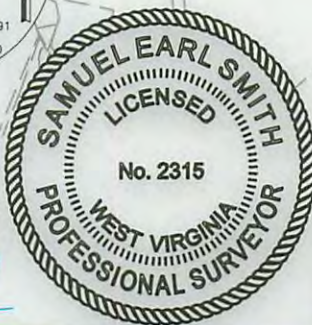
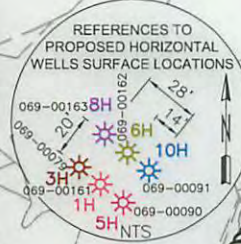

I, THE UNDERSIGNED, HEREBY CERTIFY THAT THIS PLAT IS CORRECT TO THE BEST OF MY KNOWLEDGE AND BELIEF AND SHOWS ALL THE INFORMATION REQUIRED BY LAW AND REGULATIONS ISSUED AND PRESCRIBED BY THE DEPARTMENT OF ENVIRONMENTAL PROTECTION.

P.S. 2315 *Samuel Earl Smith*



(+) DENOTES LOCATION OF WELL ON UNITED STATES TOPOGRAPHIC MAPS  
WVDEP  
OFFICE OF OIL & GAS  
601 57TH STREET  
CHARLESTON, WV 25034

MINIMUM DEGREE OF ACCURACY: 1/200  
PROVEN SURVEY SOURCE OF GRADE GPS ELEVATION: (NAVD 88, US FT)

COMPANY: **SWN** Production Company, LLC **SWN** Production Company™

CHARLES FRYE OHI  
OPERATOR'S WELL #: 6H  
API WELL #: 47 69 00162H6A  
STATE COUNTY PERMIT

WELL TYPE: OIL  WASTE DISPOSAL  PRODUCTION  DEEP  GAS  LIQUID INJECTION  STORAGE  SHALLOW

WATERSHED: MIDDLE WHEELING CREEK ELEVATION: 1267.5'

DISTRICT: TRIDELPHIA COUNTY: OHIO QUADRANGLE: VALLEY GROVE

SURFACE OWNER: CHARLES FRYE & DOROTHY FRYE ACREAGE: ±105.00

OIL & GAS ROYALTY OWNER: DOROTHY V FRYE ACREAGE: ±105.00

DRILL  DRILL DEEPER  REDRILL  FRACTURE OR STIMULATE  PLUG OFF OLD FORMATION  PERFORATE NEW FORMATION

CONVERT  PLUG & ABANDON  CLEAN OUT & REPLUG  OTHER CHANGE  (SPECIFY) AS-DRILLED

TARGET FORMATION: MARCELLUS ESTIMATED DEPTH: 6,586' IVD 12,628' TMD

WELL OPERATOR: SWN PRODUCTION COMPANY, LLC DESIGNATED AGENT: DEE SOUTHALL  
ADDRESS: P.O. BOX 1300 ADDRESS: P.O. BOX 1300  
CITY: JANE LEW STATE: WV ZIP CODE: 26378 CITY: JANE LEW STATE: WV ZIP CODE: 26378

LEGEND:	REVISIONS:	DATE:
○ PROPOSED SURFACE HOLE / BOTTOM HOLE		08-25-2015
⊙ EXISTING / PRODUCING WELLHEAD	--- LEASE BOUNDARY	
⊘ ABANDONED WELL	--- 500' DHP BUFFER	
⊙ PLUGGED & ABANDONED WELL	--- MARCELLUS DHP	
△ CUT CONDUCTOR	--- ABANDONED PATH	
		DRAWN BY: S. HUTSON
		SCALE: 1" = 2000'
		DRAWING NO: 59060
		WELL LOCATION PLAT