



320 O'Bryan Lane • Van Buren, AR 72956  
Office: 479.474.7916 • Fax: 479.474.2450  
Surveying • handa-inc.com

LINE	BEARING	DISTANCE	DESCRIPTION	MONUMENT
L1	N 28°59'07" E	1255'	SHL TO LANDMARK	PARCEL CORNER
L2	S 61°45'26" E	1922'	SHL TO LANDMARK	PARCEL CORNER
L3	N 51°36'06" W	13.29'	SHL TO REF. PNT.	CHARLES FRYE OHI 3H WELL HEAD (069-00079)
L4	N 73°33'31" E	24.44'	SHL TO REF. PNT.	CHARLES FRYE OHI 10H WELL HEAD (069-00091)

LINE	BEARING	DISTANCE	CURVE LENGTH	DESCRIPTION
L5	S 84°39'07" W	938.25'		SHL TO LP
L6	N 29°50'51" W	4860.09'		LP TO BHL

Latitude: 40°05'00"

Longitude: 80°32'30"

**NOTES ON SURVEY**

- COORDINATE SYSTEM IS UTM, NAD 83 DATUM, ZONE 17, U.S. FOOT AND WELL COORDINATES ESTABLISHED USING SURVEY GRADE GPS.
- SURFACE AND ROYALTY OWNER INFORMATION AND THEIR BOUNDARIES SHOWN HEREON WERE PLOTTED FROM DEEDS AND/OR TAX PARCEL MAPS PROVIDED BY CLIENT AND/OR FIELD LOCATIONS.
- THIS PLAT DOES NOT REPRESENT A BOUNDARY SURVEY OF THE PARCELS SHOWN HEREON.
- NO OCCUPIED DWELLINGS AND AGRICULTURE BUILDINGS GREATER THAN 2500 SQ FT. WITHIN 625 FEET OF PROPOSED CF CENTER OF PAD.
- NO WATER WELLS OR DEVELOPED SPRINGS WITHIN 250 FEET OF PROPOSED WELL.
- NO PERENNIAL STREAMS, LAKES, PONDS, OR RESERVOIRS WITHIN 100 FEET OF THE LIMITS OF DISTURBANCE.
- NO NATURALLY PRODUCING TROUT STREAM WITHIN 300 FEET OF LIMITS OF DISTURBANCE.
- NO GROUND INTAKE OR PUBLIC WATER SUPPLY WITHIN 1000 FEET OF WELL PAD, LIMITS OF DISTURBANCE, E & S CONTROLS OR PUBLIC WATER SUPPLY.

TRACT	SURFACE OWNER (S) / ROYALTY OWNER (R)	TAX PARCEL	ACRES
1	CHARLES FRYE & DOROTHY FRYE (S) DOROTHY V FRYE (R)	06-T14-01	105.00
2	KIMINETH W CRAIG & LINDA CRAIG (S/R)	06-T8-53	57.89
3	REBECCA A JACK (S) LOIS J JACK (R)	06-T8-47	65.13
4	BEVERLY E KNIERIM (S) LOIS J JACK (R)	06-T8-47.8	1.00
5	JONATHAN P DUGGAN (S) JONATHAN P DUGGAN & JAMES P DUGGAN (R)	06-T8-46	73.95
6	OHIO COUNTY DEVELOPMENT (S) THE OHIO COUNTY DEVELOPMENT AUTHORITY (R)	06-T8-64	0.19
7	BERT LLC (S) THE OHIO COUNTY DEVELOPMENT AUTHORITY (R)	06-T8-46.11	3.94
8	OHIO COUNTY DEVELOPMENT (S) THE OHIO COUNTY DEVELOPMENT AUTHORITY (R)	06-T8-45.6	0.57
9	BETH ANN STEPHEN ET AL (S) VICTORIA T SEAMON (R)	06-T8-44	1.42

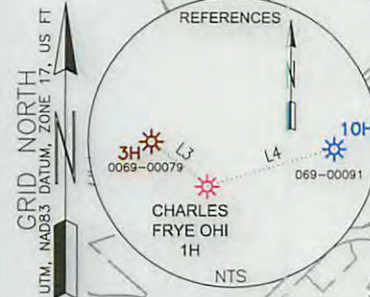

SURFACE HOLE LOCATION (SHL):	
GEOGRAPHIC (NAD83):	LATITUDE: 40.053102°
	LONGITUDE: -80.577108°
UTM (NAD83, ZONE 17, FEET):	NORTHING: 14,546,351.068
	EASTING: 1,758,756.236
UTM (NAD83, ZONE 17, METERS):	NORTHING: 4,433,736.673
	EASTING: 536,069.973
LANDING POINT LOCATION (LPL)	
GEOGRAPHIC (NAD83):	LATITUDE: 40.052874°
	LONGITUDE: -80.580448°
UTM (NAD83, ZONE 17, FEET):	NORTHING: 14,546,263.618
	EASTING: 1,757,822.066
UTM (NAD83, ZONE 17, METERS):	NORTHING: 4,433,710.018
	EASTING: 535,785.237
BOTTOM HOLE LOCATION (BHL):	
GEOGRAPHIC (NAD83):	LATITUDE: 40.064481°
	LONGITUDE: -80.589022°
UTM (NAD83, ZONE 17, FEET):	NORTHING: 14,550,479.028
	EASTING: 1,755,403.226
UTM (NAD83, ZONE 17, METERS):	NORTHING: 4,434,994.878
	EASTING: 535,047.974

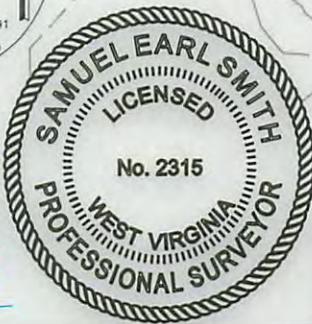
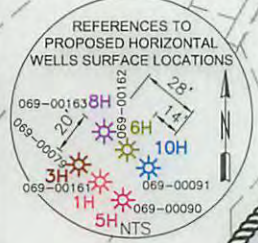

I, THE UNDERSIGNED, HEREBY CERTIFY THAT THIS PLAT IS CORRECT TO THE BEST OF MY KNOWLEDGE AND BELIEF AND SHOWS ALL THE INFORMATION REQUIRED BY LAW AND REGULATIONS ISSUED AND PRESCRIBED BY THE DEPARTMENT OF ENVIRONMENTAL PROTECTION.

P.S. 2315

*Samuel Earl Smith*

COMPANY: **SWN** Production Company, LLC

(+) DENOTES LOCATION OF WELL ON UNITED STATES TOPOGRAPHIC MAPS WVDEP OFFICE OF OIL & GAS 601 57TH STREET CHARLESTON, WV 25034	MINIMUM DEGREE OF ACCURACY: 1/200 PROVEN SOURCE OF ELEVATION: SURVEY GRADE GPS (NAVD 88, US FT)	COMPANY: CHARLES FRYE OHI OPERATOR'S WELL #: 1H API WELL #: 47 STATE 69 COUNTY 00161H6A PERMIT
---	--	--

WELL TYPE: OIL  WASTE DISPOSAL  PRODUCTION  DEEP  GAS  LIQUID INJECTION  STORAGE  SHALLOW

WATERSHED: MIDDLE WHEELING CREEK ELEVATION: 1267.5'

DISTRICT: TRIDELPHIA COUNTY: OHIO QUADRANGLE: VALLEY GROVE

SURFACE OWNER: CHARLES FRYE & DOROTHY FRYE ACREAGE: ±105.00

OIL & GAS ROYALTY OWNER: DOROTHY V FRYE ACREAGE: ±105.00

DRILL  DRILL DEEPER  REDRILL  FRACTURE OR STIMULATE  PLUG OFF OLD FORMATION  PERFORATE NEW FORMATION

CONVERT  PLUG & ABANDON  CLEAN OUT & REPLUG  OTHER CHANGE  (SPECIFY) AS-DRILLED

TARGET FORMATION: MARCELLUS ESTIMATED DEPTH: 6,432' 10/09/2015

WELL OPERATOR: SWN PRODUCTION COMPANY, LLC	DESIGNATED AGENT: DEE SOUTHALL
ADDRESS: P.O. BOX 1300	ADDRESS: P.O. BOX 1300
CITY: JANE LEW STATE: WV ZIP CODE: 26378	CITY: JANE LEW STATE: WV ZIP CODE: 26378

LEGEND:	REVISIONS:	DATE:
<ul style="list-style-type: none"> <li>○ PROPOSED SURFACE HOLE / BOTTOM HOLE</li> <li>⊙ EXISTING / PRODUCING WELLHEAD</li> <li>⊗ ABANDONED WELL</li> <li>⊗ PLUGGED &amp; ABANDONED WELL</li> <li>△ CUT CONDUCTOR</li> </ul>	<ul style="list-style-type: none"> <li>--- LEASE BOUNDARY</li> <li>--- 500' DHP BUFFER</li> <li>- MAR 1 &gt; - MARCELLUS DHP</li> <li>--- ABANDONED PATH</li> </ul>	08-25-2015 DRAWN BY: S. HUTSON SCALE: 1" = 200' DRAWING NO: 59059 WELL LOCATION PLAT