

REFERENCE LINES
RL #1
S 71°37'52" W 1325'

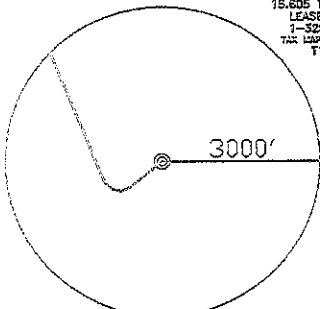

<p>TOP HOLE (NAD 83) N) 563750.0 E) 1679842.4 LAT.) 40°02'35.6" LONG.) 80°31'51.7" DEC. LAT.) 40.043210 DEC. LONG.) 80.531027</p>	<p>TOP HOLE (NAD 27) N) 563712.9 E) 1711278.6 LAT.) 40°02'35.3" LONG.) 80°31'52.4" DEC. LAT.) 40.043136 DEC. LONG.) 80.531233</p>
<p>TOP HOLE (NAD 83) N) 562869.0 E) 1678772.7 LAT.) 40°02'28.7" LONG.) 80°32'05.3" DEC. LAT.) 40.040758 DEC. LONG.) 80.534811</p>	<p>TOP HOLE (NAD 27) N) 562832.0 E) 1710208.9 LAT.) 40°02'28.5" LONG.) 80°32'06.1" DEC. LAT.) 40.040584 DEC. LONG.) 80.535017</p>
<p>TOP HOLE (NAD 83) N) 563352.4 E) 1678564.8 LAT.) 40°02'31.3" LONG.) 80°32'07.8" DEC. LAT.) 40.042024 DEC. LONG.) 80.535501</p>	<p>TOP HOLE (NAD 27) N) 563295.3 E) 1710019.0 LAT.) 40°02'31.0" LONG.) 80°32'08.5" DEC. LAT.) 40.041950 DEC. LONG.) 80.535708</p>
<p>BOTTOM HOLE (NAD 83) N) 572434.8 E) 1674893.6 LAT.) 40°04'00.8" LONG.) 80°32'56.8" DEC. LAT.) 40.066892 DEC. LONG.) 80.549063</p>	<p>BOTTOM HOLE (NAD 27) N) 572397.6 E) 1706328.0 LAT.) 40°04'00.5" LONG.) 80°32'57.3" DEC. LAT.) 40.066818 DEC. LONG.) 80.549269</p>

TOP HOLE (UTM 83)
N) 4432658.5
E) 540006.2
BOTTOM HOLE (UTM 83)
N) 4435279.0
E) 538454.3

REFERENCE NOTES
Boundaries as shown taken from deeds, tax maps and field locations. A full boundary survey is not expressed nor implied. All bearings are based on true north. Ownership taken from public records Ohio County, West Virginia MARCH 2011
State Plane Coordinates & NAD 83 Lat/Long by differential submeter mapping grade GPS
Drafted by: E.A.M.

FILE #: CHE 034
DRAWING #: 1853
SCALE: 1"=2000'
MINIMUM DEGREE OF ACCURACY: 1/200
PROVEN SOURCE SUBMETER MAPPING OF ELEVATION: GRADE GPS

(I, THE UNDERSIGNED, HEREBY CERTIFY THAT THIS PLAT IS CORRECT TO THE BEST OF MY KNOWLEDGE AND BELIEF AND SHOWS ALL THE INFORMATION REQUIRED BY LAW AND THE REGULATIONS ISSUED AND PRESCRIBED BY THE DEPARTMENT OF ENVIRONMENTAL PROTECTION.
Signed: *[Signature]*
L.L.S. #2124 : Ernest J. Benchek III

DATE: DECEMBER 06, 2011
OPERATOR'S WELL #: ROY FERRELL DHI 1H
API WELL #: 47 69 00111H
STATE COUNTY PERMIT

(+) DENOTES LOCATION OF WELL ON UNITED STATES TOPOGRAPHIC MAPS
WVDEP
OFFICE OF OIL & GAS
601 57TH STREET
CHARLESTON, WV 25304
Well Type: Oil Waste Disposal Production Deep
 Gas Liquid Injection Storage Shallow
WATERSHED: UPPER OHIO SOUTH
COUNTY/DISTRICT: DHID/TRIADDELPHIA
SURFACE OWNER: ROY E. FERRELL
OIL & GAS ROYALTY OWNER: ROY E. FERRELL
LEASE NUMBERS:
DRILL CONVERT DRILL DEEPER REDRILL FRACTURE OR STIMULATE
PLUG OFF FORMATION PERFORATE NEW FORMATION PLUG & ABANDON
CLEAN OUT & REPLUG OTHER CHANGE (SPECIFY):
TARGET FORMATION: MARCELLUS
WELL OPERATOR: CHESAPEAKE APPALACHIA, LLC.
ADDRESS: PO BOX 18496
CITY: OKLAHOMA CITY STATE: OK ZIP CODE: 73154-0496
ESTIMATED DEPTH: TVD: 6,665' TMD: 16,991'
DESIGNATED AGENT: ERIC B. GILLESPIE
ADDRESS: PO Box 6070
CITY: CHARLESTON STATE: WV ZIP CODE: 25301
DATE: DECEMBER 06, 2011
OPERATOR'S WELL #: ROY FERRELL DHI 1H
API WELL #: 47 69 00111H
STATE COUNTY PERMIT
ELEVATION: 1,210'
QUADRANGLE: VALLEY GROVE WV.
ACREAGE: 202.31 +/-
ACREAGE: 798.681 +/-

SURFACE HOLE DEC. LAT. 40.066892
SURVEYED LAT. 40° 02' 35.6"

69-00111

