

Latitude 38° 20'

TOPO. LOCATIONS

No. 2
No. 1

Longitude 80° 55'

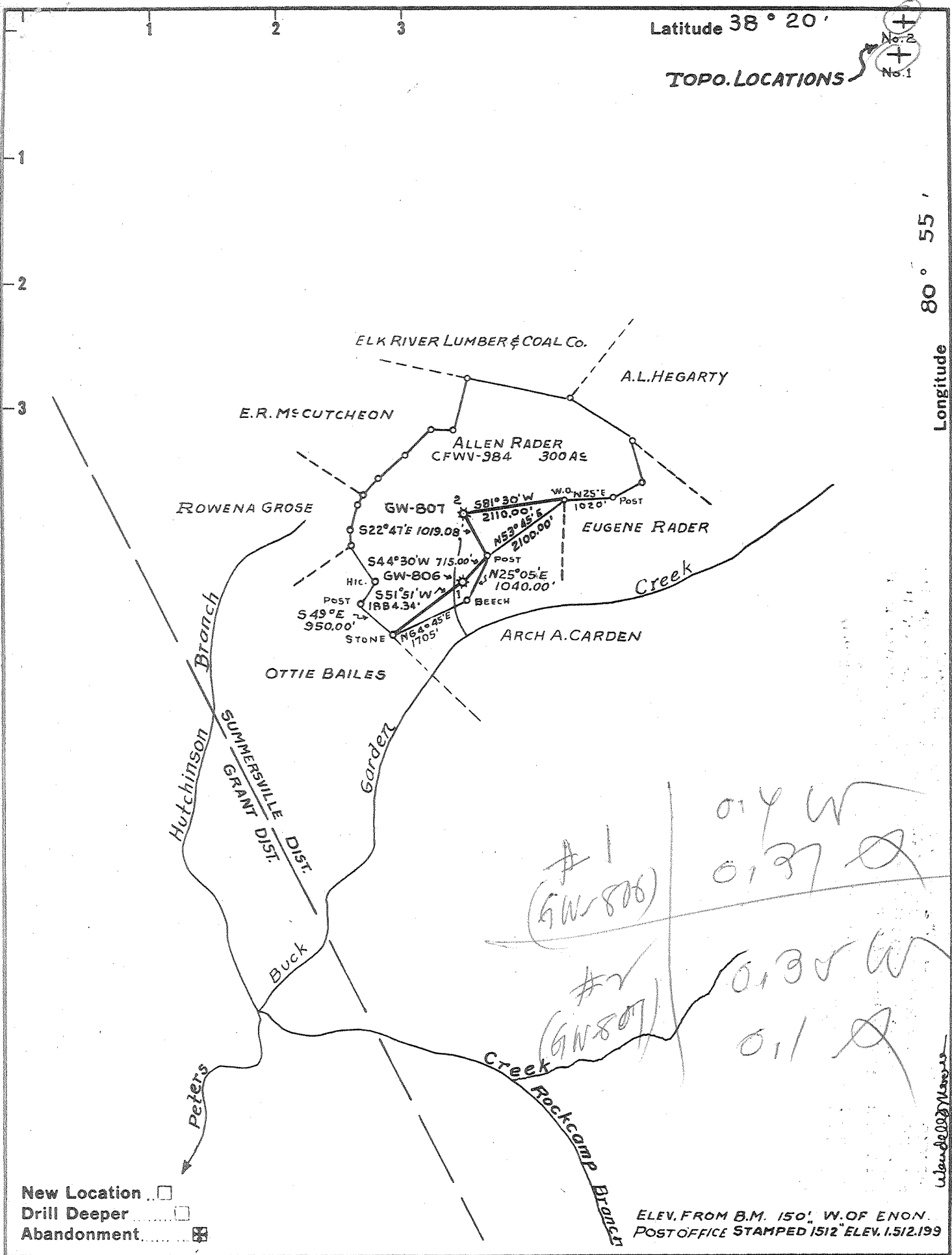

New Location

Drill Deeper

Abandonment

ELEV. FROM B.M. 150' W. OF ENON.
POST OFFICE STAMPED 1512' ELEV. 1.512.193

Company CITIES SERVICE OIL COMPANY JUL 27 1964

Address BOX 873 CHARLESTON W.VA.

Farm ALLEN RADER

Tract _____ Acres 300 Lease No. CFWV-984

Well (Farm) No. 1 & 2 Serial No. GW-806 #1
GW-807 #2

Elevation (Spirit Level) No. 1 1436.66' No. 2 1486.22'

Quadrangle SUMMERSVILLE 9

County NICHOLAS District SUMMERSVILLE

Engineer W. Andrew Messer

Engineer's Registration No. 2113

File No. _____ Drawing No. _____

Date JULY 15 1964 Scale 1" = 2640'

STATE OF WEST VIRGINIA
DEPARTMENT OF MINES
OIL AND GAS DIVISION
CHARLESTON

WELL LOCATION MAP
FILE NO. NIC-#23 + 24 A

+ Denotes location of well on United States Topographic Maps, scale 1 to 62,500 latitude and longitude lines being represented by border lines as shown.

- Denotes one inch spaces on border line of original tracing.

ALLEN RADER NOS. 1 (GW-806) & 2 (GW-807) - CITIES SERVICE OIL CO - NIC-23-24 A

Amherstville District, Nicholas County, W. Va. 2112

by *Ernest A. ...* - *Houston, N 35 1/2 B -*

on branch of Buck Garden Creek.

10" casing, 26'; 8" casing, 565'; pulled ruined 8" casing, 601';
6-5/8" casing, 1627'.

Water from the surface to 601'. *3,000 M. ...*

| | Top. | Bottom. |
|---|------|---------|
| Coal | 80 | 85 |
| Hard sand | 130 | 145 |
| Hard sand | 230 | 255 |
| Little Dunkard Sand | 345 | 380 |
| Big Dunkard Sand | 450 | 485 |
| Water, 575' | | |
| Gas Sand | 680 | 710 |
| First Salt Sand (1 bailer water at 920') | 895 | 945 |
| Second Salt Sand (gas, 1192'; water, 1220') | 1185 | 1240 |
| Red rock, slate and shells | 1240 | 1320 |
| Sandy lime | 1320 | 1400 |
| Slate | 1400 | 1525 |
| Lime | 1525 | 1580 |
| Pencil Gave | 1580 | 1618 |
| Big Lime | 1618 | 1866 |
| Big Injun Sand | 1866 | 1886 |
| Slate | 1886 | 1940 |
| Berea Grit | 1940 | 1980 |
| Slate and shells | 1980 | 2295 |
| Gritty lime | 2295 | 2325 |
| Slate and shells, to bottom | 2325 | 2756 |