

Latitude 38° 20'

TOPO. LOCATIONS

No. 2  
No. 1

Longitude 80° 55'

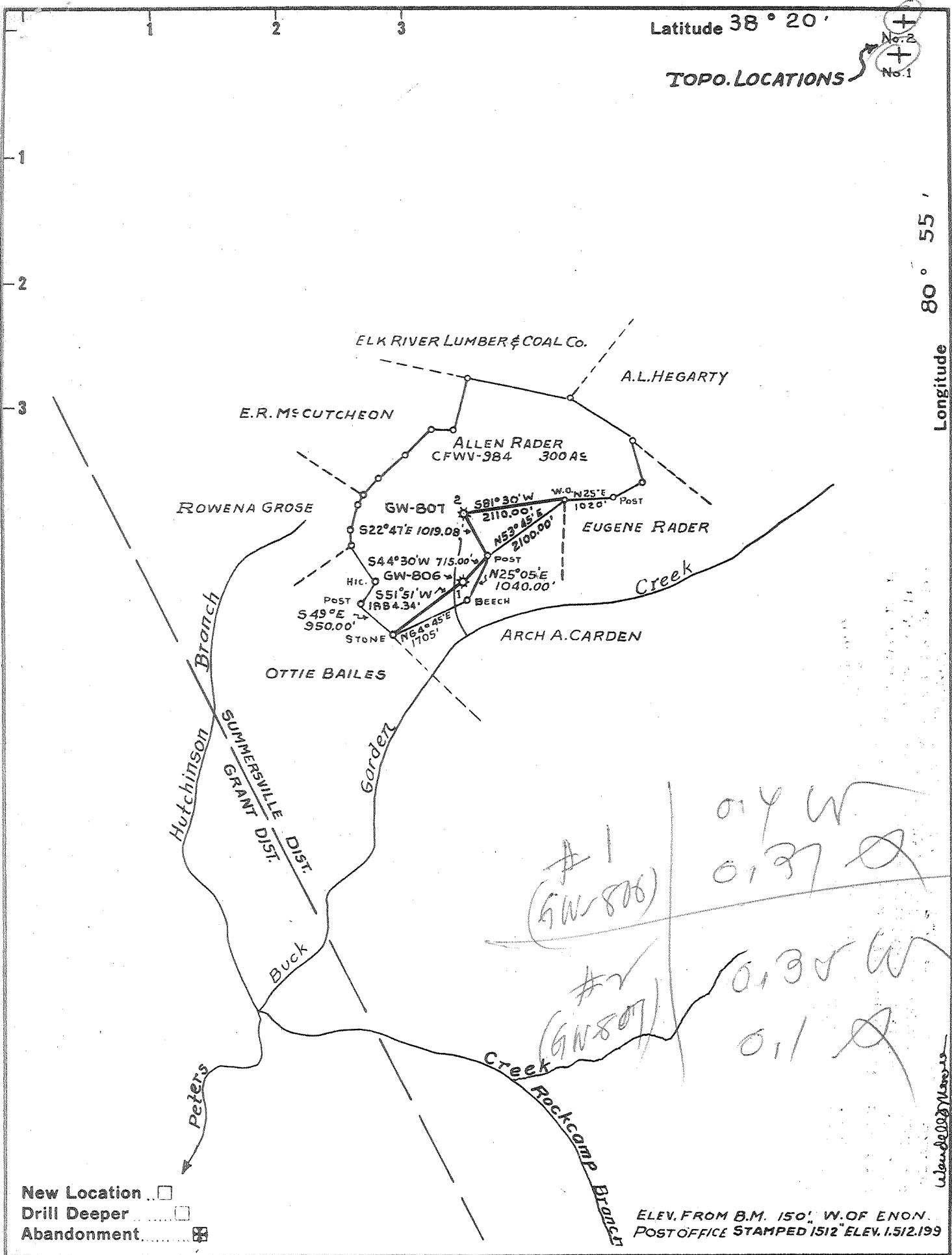

Handwritten notes on the map:

- #1 (GW-806) 0.14 W 0.37
- #2 (GW-807) 0.35 W 0.1

Company CITIES SERVICE OIL COMPANY JUL 27 1964

Address BOX 873 CHARLESTON W.VA.

Farm ALLEN RADER

Tract \_\_\_\_\_ Acres 300 Lease No. CFWV-984

Well (Farm) No. 1 & 2 Serial No. GW-806 #1  
GW-807 #2

Elevation (Spirit Level) No. 1 1436.66' No. 2 1486.22'

Quadrangle SUMMERSVILLE 9

County NICHOLAS District SUMMERSVILLE

Engineer Wendell S. Mease

Engineer's Registration No. 2113

File No. \_\_\_\_\_ Drawing No. \_\_\_\_\_

Date JULY 15 1964 Scale 1" = 2640'

STATE OF WEST VIRGINIA  
DEPARTMENT OF MINES  
OIL AND GAS DIVISION  
CHARLESTON

WELL LOCATION MAP  
FILE NO. NIC-#23 + 24 A

+ Denotes location of well on United States Topographic Maps, scale 1 to 62,500 latitude and longitude lines being represented by border lines as shown.

- Denotes one inch spaces on border line of original tracing.

ALLEN RADER NOS. 1 (GW-806) & 2 (GW-807) - CITIES SERVICE OIL CO - NIC-23-24 A

*Summersville* District, Nicholas County, W. Va.

by *Ernest Gil Rader* - *Station #500' B*  
 On branch of Buck Garden Creek. *1,500 M - possible salt sand*

	Top.	Bottom.
Conductor	0	13
Slate and shells	13	60
Hard lime	60	100
Hard sand	100	125
White slate	125	140
Hard lime	140	150
Hard sand	150	200
Black slate	200	240
Hard lime	240	280
Hard sand (water at 333')	280	355
Black slate	335	350
Hard lime	350	364
Slate and shells	364	402
Hard sand	402	498
Dark slate	498	504
Dark sand	504	522
Dark slate	522	527
White sand	527	568
Slate and shells	568	586
Limestone	586	650
White slate	650	668
Gritty lime	668	712
Slate and shells	712	745
White slate	745	790
Hard lime	790	850
White slate	850	876
Limestone	876	894
Pink rock	894	922
Black slate	922	980
Slate, lime and shells	980	1050
White slate and shells	1050	1064
Limestone	1064	1085
Slate	1085	1100
Hard sand, to bottom	1100	1128