

NEW GAULEY COAL CORPORATION LEASE 18,821.835 OF 29,809 ACRES±

WELL NO. TNG 20

NOTES

LEASE BOUNDARY DOES NOT APPEAR WITHIN THE SCOPE OF THIS PLAT.

OWNERSHIP INFORMATION TAKEN FROM PUBLIC RECORDS OF NICHOLAS COUNTY, WV IN JANUARY, 2009.

WELL LAT./LONG. ESTABLISHED BY DIFFERENTIAL SUBFOOT MAPPING GRADE GPS.

LONGITUDE 80°37'30"

8,555'

SURVEYED LAT. 38° 16' 05.5"

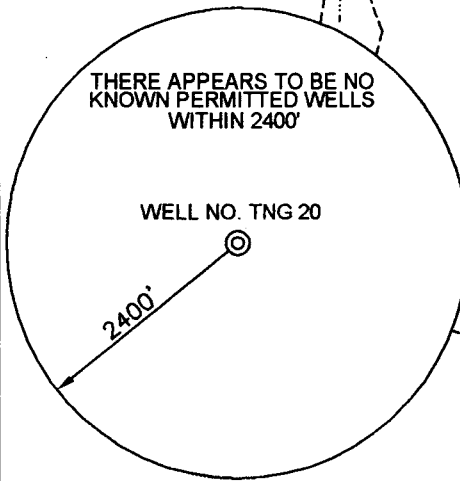
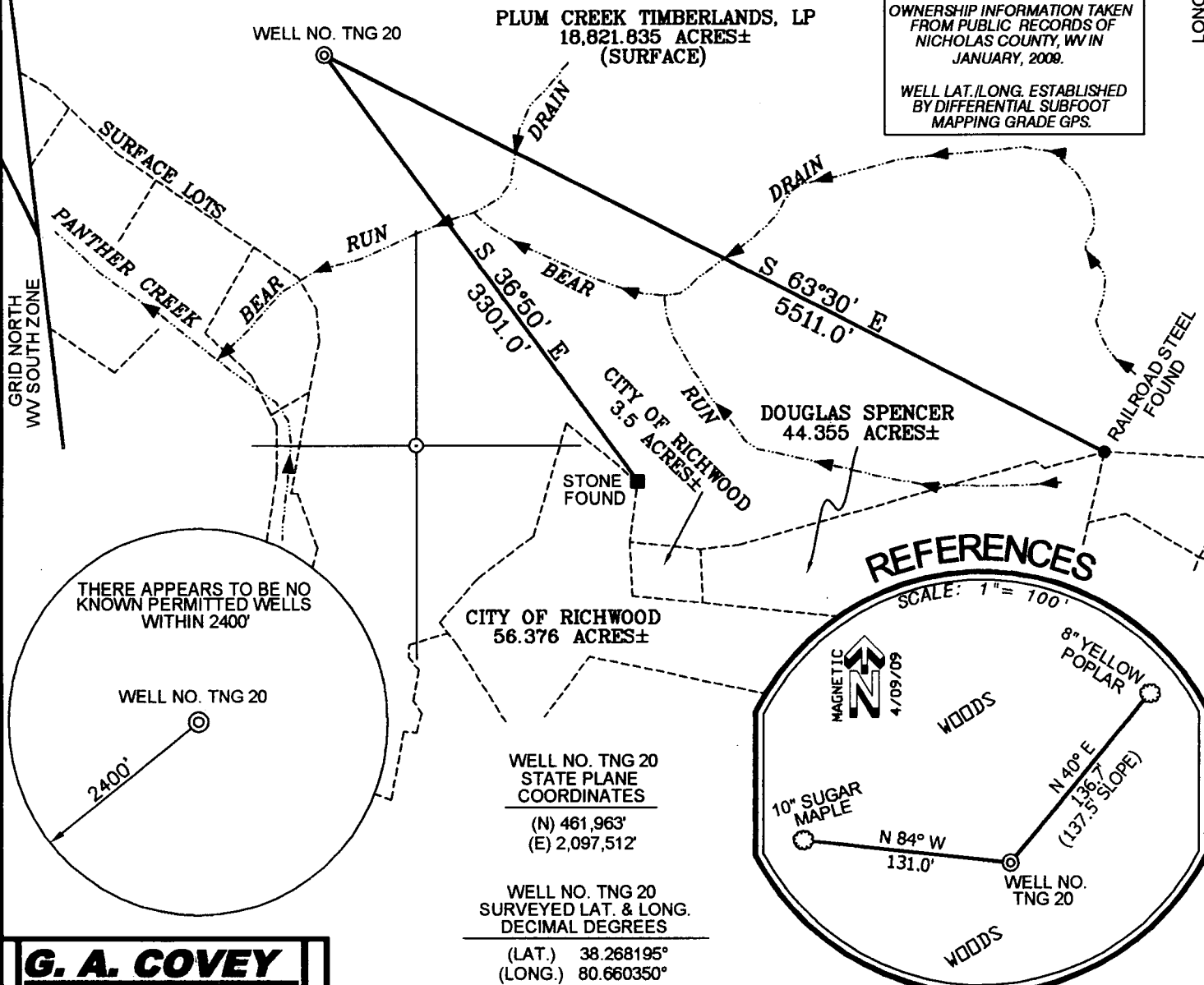

REFERENCES

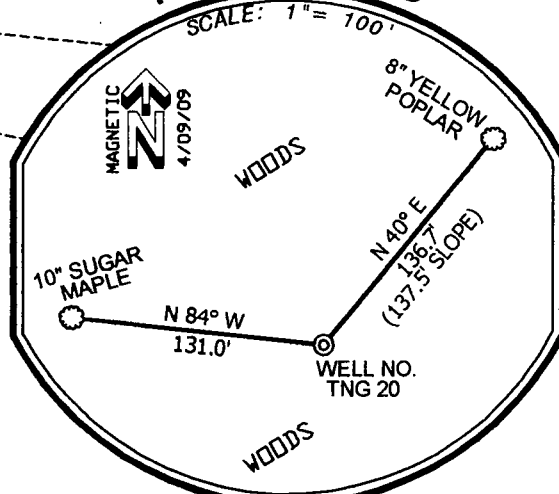

G. A. COVEY
ENGINEERING

WELL NO. TNG 20
STATE PLANE COORDINATES
(N) 461,963'
(E) 2,097,512'

WELL NO. TNG 20
SURVEYED LAT. & LONG.
DECIMAL DEGREES
(LAT.) 38.268195°
(LONG.) 80.660350°

(+) DENOTES LOCATION ON UNITED STATES TOPOGRAPHIC MAPS.

I THE UNDERSIGNED, HEREBY CERTIFY THAT THIS PLAT IS CORRECT TO THE BEST OF MY KNOWLEDGE AND BELIEF AND SHOWS ALL THE INFORMATION REQUIRED BY LAW AND THE REGULATIONS ISSUED AND PRESCRIBED BY THE DEPARTMENT OF ENVIRONMENTAL PROTECTION.

P.S. 2140 *Justin R. Meadows*

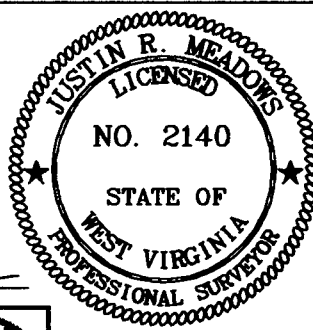

DATE APRIL 15 20 09

OPERATORS WELL NO. TNG 20

API WELL NO. 47-067-00938

STATE COUNTY PERMIT

MINIMUM DEGREE OF ACCURACY 1/2500

FILE NO. 29042 (50-36)

SCALE 1" = 1000'

PROVEN SOURCE OF ELEVATION DGPS (SUBFOOT MAPPING GRADE)

STATE OF WEST VIRGINIA
DIVISION OF ENVIRONMENTAL PROTECTION
OFFICE OF OIL AND GAS



WELL TYPE: OIL GAS LIQUID INJECTION WASTE DISPOSAL IF "GAS" PRODUCTION STORAGE DEEP SHALLOW

LOCATION: ELEVATION 2,385' WATERSHED GAULEY RIVER

DISTRICT KENTUCKY COUNTY NICHOLAS QUADRANGLE CRAIGSVILLE 7.5'

SURFACE OWNER PLUM CREEK TIMBERLANDS, LP. ACREAGE 18,821.835±

ROYALTY OWNER NEW GAULEY COAL CORPORATION LEASE ACREAGE 18,821.835 OF 29,809±

PROPOSED WORK: LEASE NO. _____

DRILL CONVERT DRILL DEEPER REDRILL FRACTURE OR STIMULATE PLUG OFF OLD FORMATION PERFORATE NEW FORMATION PLUG AND ABANDON CLEAN OUT AND REPLUG OTHER _____

PHYSICAL CHANGE IN WELL (SPECIFY) _____ TARGET FORMATION DEVONIAN SHALE

ESTIMATED DEPTH 7,245'

WELL OPERATOR TRIANA ENERGY, LLC. DESIGNATED AGENT RAY PRUDNICK, JR.

ADDRESS 900 VIRGINIA STREET EAST, SUITE 400 CHARLESTON, WV 25301 ADDRESS 900 VIRGINIA STREET EAST, SUITE 400 CHARLESTON, WV 25301

COUNTY NAME

PERMIT



west virginia department of environmental protection

Office of Oil and Gas
601 57th Street SE
Charleston, WV 25304
(304) 926-0450
(304) 926-0452 fax

Earl Ray Tomblin, Governor
Randy C. Huffman, Cabinet Secretary
www.dep.wv.gov

November 18, 2011

FINAL INSPECTION REPORT

New Well Permit Cancelled

TRIANA ENERGY, LLC,

The FINAL INSPECTION REPORT for the CANCELLED permit, API Well Number: 47-6700938, issued to TRIANA ENERGY, LLC, and listed below has been received in this office. The permit has been cancelled as of 11/4/2011.

James Martin
Chief

Operator: TRIANA ENERGY, LLC
Operator's Well No: TRIANA NEW GAULEY 20
Farm Name: PLUM CREEK TIMBERLANDS LI
API Well Number: 47-6700938
Date Issued: 11/03/2009

Date Cancelled: 11/04/2011

Promoting a healthy environment.

INSPECTORS PERMIT SUMMARY FORM

GPS YES [] NO []

DATE STARTED/LOCATION: _____ OPERATOR: TRIANA ENERGY, LLC
 DRILLING COMMENCED: _____ FARM: PLUM CREEK TIMBERLANDS LP
 TO DATE: _____ DEPTHS: _____ Well No: TRIANA NEW GAULEY 20
 WATER DEPTHS: _____ COAL DEPTHS _____

QUESTIONS FOR THIS REPORT ARE IN ACCORDANCE OF WV CODE 22-6-30 AND REGULATIONS 35CSR 4-12.1 AND 35CSR 4-16 AND THE GENERAL WATER POLLUTION CONTROL PERMIT.

POINTS ARE TO BE GIVEN UP TO MAXIMUM AS SHOWN BASED ON PERFORMANCE.

1. DID OPERATOR GIVE PROPER NOTICE TO INSPECTOR BEFORE THE FOLLOWING:
 - A. CONSTRUCTION YES [] NO [] (2_PTS) (4_PTS) _____
 - B. DRILLING YES [] NO [] (2_PTS)
2. WAS THE TIMBER CUT, STACKED, AND BRUSH USED FOR SEDIMENT BARRIERS BEFORE DIRT WORK STARTED? YES [] NO [] (2_PTS) (4_PTS) _____
3. ARE ALL LOCATION AND/OR ROAD BANKS BEING SLOPED? YES [] NO [] (4_PTS) (4_PTS) _____
4. CONSTRUCTIONS:
WERE THE FOLLOWING SEDIMENT CONTROL STRUCTURES PROPERLY INSTALLED/MAINTAINED?
 - A. ROAD DITCHES (1)_ (2)_ (3)_ (4)_ (PTS) B. CROSS DRAINS (1)_ (2)_ (3)_ (4)_ (5)_ (PTS)
 - C. CULVERTS (1)_ (2)_ (3)_ (4)_ (5)_ (PTS) D. CREEK CROSSINGS (1)_ (2)_ (3)_ (PTS)
 - E. DIVERSION DITCHES (1)_ (2)_ (3)_ (PTS) F. BARRIERS (1)_ (2)_ (3)_ (PTS)
 - G. TEMPORARY SEEDING YES [] NO [] (10_PTS)

POINTS AVAILABLE FOR QUESTION 4: (33_PTS) _____

5. HAS TOP SOIL (IF ANY) BEEN STOCKED PILED? YES [] NO [] (2_PTS) (2_PTS) _____
6. IS THE PIT PROPERLY INSTALLED AND MAINTAINED? YES [] NO [] (9_PTS) (9_PTS) _____
7. RECLAMATION:
 - A. ROADWAY (1)_ (2)_ (3)_ (PTS) B. LOCATION (1)_ (2)_ (3)_ (PTS)
 - C. PITS (1)_ (2)_ (3)_ (PTS) D. PIPELINES (1)_ (2)_ (3)_ (PTS)
 - E. TANK DIKES (1)_ (2)_ (3)_ (PTS) F. API INSTALLED YES [] NO [] (3_PTS)
 - G. ADEQUATE SEEDING MATERIALS (1)_ (2)_ (3)_ (PTS)
 - H. WAS SEED BED ADEQUATE (1)_ (2)_ (3)_ (PTS)

POINTS AVAILABLE FOR QUESTION 7: (24_PTS) _____

8. WAS RECLAMATION COMPLETED WITHIN:
6 MTHS OF TD 6_PTS ONLY; 4 MTHS OF TD 12_PTS ONLY; 2 MTHS OF TD 19_PTS ONLY;

POINTS AVAILABLE FOR QUESTION 8: (19_PTS) _____

RECEIVED

Office of Oil & Gas

TOTAL MAXIMUM POSSIBLE SCORE OF _____

TOTAL RECLAMATION SCORE: _____

11/4/11

NOV 04 2011

DATE RELEASED

WV Department of Environmental Protection

INSPECTOR'S SIGNATURE

RECORD INSPECTIONS TO THIS WELL ON PAGE 2

CANCEL



west virginia department of environmental protection

Office of Oil and Gas
601 57th Street SE
Charleston, WV 25304
(304) 926-0450
(304) 926-0452 fax

Joe Manchin III, Governor
Randy C. Huffman, Cabinet Secretary
www.wvdep.org

November 03, 2009

WELL WORK PERMIT

New Well

This permit, API Well Number: 47-6700938, issued to TRIANA ENERGY, LLC, is evidence of permission granted to perform the specified well work at the location described on the attached pages and located on the attached plat, subject to the provisions of Chapter 22 of the West Virginia Code of 1931, as amended, and all rules and regulations promulgated thereunder, and to all conditions and provisions outlined in the pages attached hereto. Notification shall be given by the operator to the Oil and Gas Inspector at least 24 hours prior to the construction of roads, locations, and/or pits for any permitted work. In addition, the well operator shall notify the same inspector 24 hours before any actual well work is commenced and prior to running and cementing casing. Spills or emergency discharges must be promptly reported by the operator to 1-800-642-3074 and to the Oil and Gas inspector.

Please be advised that form WR-35, well operators report of well work, is to be submitted to this office within 90 days of completion of drilling, as should form WR-34 Discharge Monitoring Report within 30 days of discharge of pits, if applicable. Failure to abide by all statutory and regulatory provisions governing all duties and operations hereunder may result in suspension or revocation of this permit and, in addition, may result in civil and/or criminal penalties being imposed upon the operators.

Per 35CSR-4-5.2.g this permit will expire in two (2) years from the issue date unless permitted well work is commenced. If there are any questions, please feel free to contact me at (304) 926-0499 ext. 1654.

James Martin
Chief

Operator's Well No: TRIANA NEW GAULEY 20
Farm Name: PLUM CREEK TIMBERLANDS LI
API Well Number: 47-6700938
Permit Type: New Well
Date Issued: 11/03/2009

Promoting a healthy environment.

STATE OF WEST VIRGINIA
DEPARTMENT OF ENVIRONMENTAL PROTECTION, OFFICE OF OIL AND GAS
WELL WORK PERMIT APPLICATION

1) Well Operator **TRIANA ENERGY, LLC** Operator ID 67 **Nicholas** County **Kentucky** District **Craigsville** Quad **312**

2) Operator's Well Number: **TRIANA NEW GAULEY #20** 3) Elevation: **2,385' GL**

4) Well Type: (a) Oil or Gas
 (b) If Gas: Production / Underground Storage
 Deep / Shallow

5) Proposed Target Formation(s): **Devonian Shale**

6) Proposed Total Depth: **7,245 feet KB**

7) Approximate fresh water strata depths: **426'**

8) Approximate salt water depths: **3,173'**

9) Approximate coal seam depths: **423,449,620,668,1183,1238,1303,1338,1359**

10) Does land contain coal seams tributary to active mine? **YES**

11) Describe proposed well work **Drill, log and complete (hydraulic fracture) a vertical gas well.**

12) CASING AND TUBING PROGRAM

TYPE	SPECIFICATIONS			FOOTAGE INTERVALS		CEMENT
	Size	Grade	Weight per ft	For Drilling	Left in Well	Fill-up (Cu. Ft.)
Conductor	13-3/8"	LS	37.0	30'	30'	Grout
Fresh Water	9-5/8"	LS	32.30	1,410'	1,410'	CTS
Coal						
Intermediate	7"	LS	23.0	3,225'	3,225'	@ 1,310'
Production	4-1/2"	M-65	10.5	7,235'	7,235'	*300 ft. above shallowest completion objective
Tubing	2-3/8"	J-55	4.6	Will be set 50 ft. above bottom of production casing		
Liner						

Handwritten signature and date: 4/30/09

* Will be determined after logging well.

Packers: Kind N/A
 002164 Sizes: N/A
 650 Depths Set:: N/A

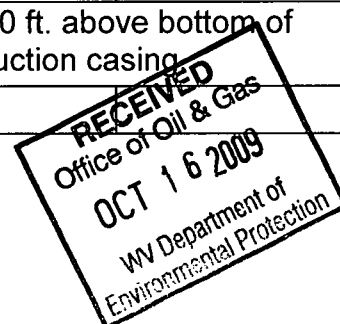

1) Date: April 29, 2009

2) Operator's Well Number
TRIANA NEW GAULEY #20

3) API Well No.: 47 - 067 - 00938
State County Permit

**STATE OF WEST VIRGINIA - BUREAU OF ENVIRONMENT
DEPARTMENT OF ENVIRONMENTAL PROTECTION, OFFICE OF OIL AND GAS
NOTICE AND APPLICATION FOR A WELL WORK PERMIT**

4) Surface Owner(s) to be served:
(a) Name Plum Creek Timberlands
Address P.O. Box 1109
Lewisburg, WV 24901-4109

5) (a) Coal Operator
Name White Buck Coal Company
Address P.O. Box 180
Leivasy, WV 26676

(b) Name
Address

(b) Coal Owner(s) with Declaration
Name WPP, LLC (NRP, LP)
Address 5260 Irwin Road
Huntington, WV 25705

(c) Name
Address

Name
Address

6) Inspector Terry Urban
Address P.O. Box 1207
Clendenin, WV 25045

(c) Coal Lessee with Declaration
Name Green Valley Coal Company
Address P.O. Box 190
Leivasy, WV 26676

Telephone 304-549-5915

TO THE PERSONS NAMED ABOVE TAKE NOTICE THAT:

- Included is the lease or leases or other continuing contract or contracts by which I hold the right to extract oil and gas
- OR**
- Included is the information required by Chapter 22, Article 6, Section 8(d) of the Code of West Virginia (see page 2)

I certify that as required under Chapter 22-6 of the West Virginia Code I have served copies of this notice and application, a location plat, and accompanying documents pages 1 through 3 on the above named parties by:

- Personal Service (Affidavit attached)
- Certified Mail (Postmarked postal receipt attached)
- Publication (Notice of Publication attached)

I have read and understand Chapter 22-6 and 35 CSR 4, and I agree to the terms and conditions of any permit issued under this application.

I certify under penalty of law that I have personally examined and am familiar with the information submitted on this application form and all attachments, and that based on my inquiry of those individuals immediately responsible for obtaining the information, I believe that the information is true, accurate and complete.

I am aware that there are significant penalties for submitting false information, including the possibility of fine and imprisonment.

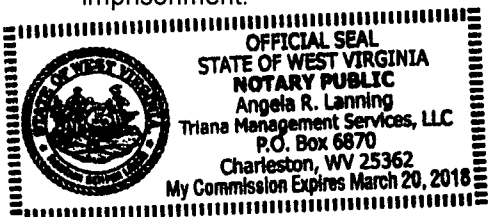
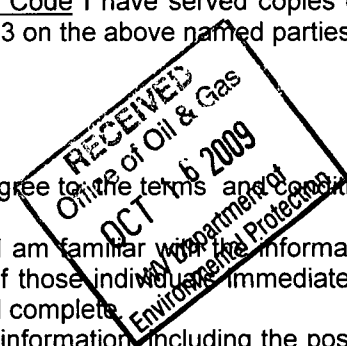

Well Operator **TRIANA ENERGY, LLC**
By: **Ray Prudnick, Jr.**
Its: **Vice President, Operations**
Address **900 Virginia Street, East, Suite 400
Charleston, West Virginia 25301**
Telephone **(304) 380-0113**

Subscribed and sworn before me this 29th day of April, 2009
Angela R. Lanning Notary Public

My Commission Expires March 20, 2018

Form WW-2A-1
(8/02)

Operator's Well Number TRIANA NEW GAULEY #20

INFORMATION SUPPLIED UNDER WEST VIRGINIA CODE
Chapter 22, Article 6, Section 8(d)
IN LIEU OF FILING LEASE(S) AND OTHER CONTINUING CONTRACT(S)

Under the oath required to make the verification on page 1 of this Notice and Application, I depose and say that I am the person who signed the Notice and Application for the Applicant, and that –

- (1) the tract of land is the same tract described in this Application, partly or wholly depicted in the accompanying plat, and described in the Construction and Reclamation Plan;
- (2) the parties and recordation data (if recorded) for lease(s) or other continuing contract(s) by which the Applicant claims the right to extract, produce or market the oil or gas are as follows:

Grantor, lessor, etc.	Grantee, lessee, etc.	Royalty	Book/Page
New Gauley Coal Corporation	J.W. Kinzer	1/8	Unrecorded

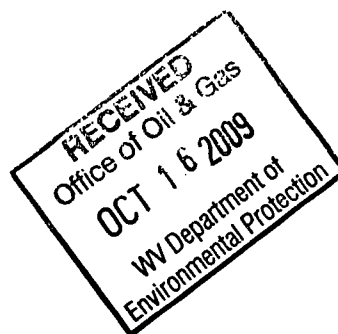

Well Operator: TRIANA ENERGY, LLC
 By: *Ray Brundish, Jr.*
 Its: Vice President of Operations

6
67-00938

BOOK 6770 368

MEMORANDUM OF OIL AND GAS LEASE

97

This Memorandum of Oil and Gas Lease made and entered into this 1ST day of MAY, 2009, by and between **NEW GAULEY COAL CORPORATION** (a West Virginia corporation), Post Office Box 2827, Huntington, WV 25727, herein called "Lessor", and **J. W. KINZER**, Post Office Box 155, Allen, KY 41601, herein called "Lessee".

WITNESSETH

WHEREAS, Lessor and Lessee have entered into an Oil and Gas Lease dated May 1, 2000, and wish to give notice to all parties of same.

NOW THEREFORE, be it known that under and by virtue of the terms, obligations and conditions of said Lease, Lessor, for good and valuable consideration, has granted, demised, leased and let unto Lessee, for oil and gas purposes only, certain properties, or interest in same, situate in Greenbrier and Nicholas Counties, West Virginia, and being more particularly shown on the map titled, "Exhibit A Map to Accompany Oil and Gas Lease between New Gauley Coal Corporation, Lessor and J. W. Kinzer, Lessee", which is attached hereto and made a part hereof.

Said oil and gas lease is for a primary term of one (1) year with the option of extending same for an additional period of time, but not beyond twelve (12) years, provided Lessee is in compliance with all terms, obligations, and conditions of same.

The leased premises has been leased to Lessee upon certain terms, obligations and conditions more fully set forth in said oil and gas lease and which certain terms, obligations and conditions are hereby incorporated by reference as if completely set forth herein.

In witness whereof, this Memorandum of Oil and Gas Lease has been duly executed by Lessor and Lessee as of the day and year first above written.

JW Kinzer Drilling Co
PO Box 155
Allen KY 41601-0155

JUN 19 12 52 PM '00

LESSOR:

NEW GAULEY COAL CORPORATION,
a West Virginia corporation

By: [Signature]
Its: President

RECEIVED
Office of Oil & Gas
OCT 16 2009
Department of
Environmental Protection

LESSEE:

J. W. KINZER

By: [Signature]

Exhibit - B

West Virginia Department of Environmental Protection
Office of Oil and Gas

NOTICE TO SURFACE OWNERS

The well operator named below is preparing to file for a permit from the state to drill a new well. Before a well work permit can be filed with the Chief of the Office of Oil and Gas, the well operator is required to have given notice of the right to request water well or spring analytical testing. This notice shall be given to the owners or occupants of land which have a water well or spring being utilized for human consumption, domestic animals, or other general use and which is located within 1000 feet of the proposed well site.

With this form, the operator is giving you notice of your right to request analytical testing. The operator is required to sample and analyze the water wells or springs of all owners or occupants who request it. Therefore, if you wish to have your water well or spring tested, contact the operator named below.

All sampling shall be completed prior to drilling. Within thirty (30) days of the receipt of such sample analyses the operator shall submit the results to the Chief of the Office of Oil and Gas and to the owners or occupants who may have requested them.

If no water well or spring is located within 1000 feet, the Chief may require the operator to sample and analyze water from a water well or spring within 2000 feet of the proposed well site.

Be advised, you have the right to sample and analyze any water supply at your own expense.

The laboratory used by the operator to analyze the samples will be approved by the Chief. The operator named below has decided to use the following laboratory to analyze the water samples:

Contractor Name REIC Labs – Beckley, WV
 Well operator's private laboratory

Well Operator Triana Energy, LLC
Address 900 Virginia Street, East – Suite 400
Charleston, WV 25301
Telephone 304-380-0100

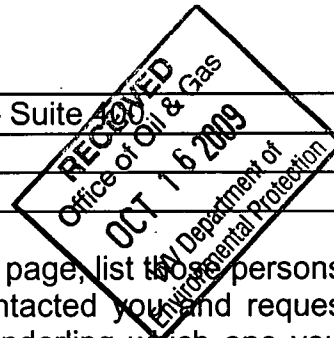

FOR OPERATOR'S USE ONLY: Below, or on an attached page, list those persons which were given this notice. Place an asterisk beside the one(s) that contacted you and requested sampling and analyses. If there were no requests made, indicate by underling which one you have selected to sample and analyze. If there are no water wells or springs within 1000 feet of the proposed site please indicate such.

none within 1,000'

STATE OF WEST VIRGINIA
DIVISION OF ENVIRONMENTAL PROTECTION, OFFICE OF OIL AND GAS
CONSTRUCTION AND RECLAMATION PLAN AND SITE REGISTRATION APPLICATION FORM
GENERAL PERMIT FOR OIL AND GAS PIT WASTE DISCHARGE

Operator Name Triana Energy, LLC OP Code _____

Watershed Gauley River Quadrangle Craigsville

Elevation 2,385' County Nicholas District Kentucky

Description of anticipated Pit Waste: Drill Water, Frac Blow Back, & Various Formation Cuttings

Will a synthetic liner be used in the pit? Yes

Proposed Disposal Method For Treated Pit Wastes:

- Land Application
- Underground Injection (UIC Permit Number _____)
- Reuse (at API Number _____)
- Off Site Disposal (Supply form WW-9 for disposal location)
- Other (Explain _____)

Proposed Work For Which Pit Will Be Used:

- Drilling
- Swabbing
- Workover
- Plugging
- Other (Explain _____)

I certify that I understand and agree to the terms and conditions of the GENERAL WATER POLLUTION PERMIT issued on December 31, 1999, by the Office of Oil and Gas of the West Virginia Division of Environmental Protection. I understand that the provisions of the permit are enforceable by law. Violations of any term or condition of the general permit and/or other applicable law or regulation can lead to enforcement action.

I certify under penalty of law that I have personally examined and am familiar with the information submitted on this application form and all attachments thereto and that, based on my inquiry of those individuals immediately responsible for obtaining the information, I believe that the information is true, accurate, and complete. I am aware that there are significant penalties for submitting false information, including the possibility of fine or imprisonment.

Company Official Signature *Ray Prudnick, Jr.*

Company Official (Typed Name) Ray Prudnick, Jr.

Company Official Title Vice President - Operations

Subscribed and sworn before me this 29th day of April, 2009

Angela R. Lanning Notary Public

My commission expires March 20, 2018

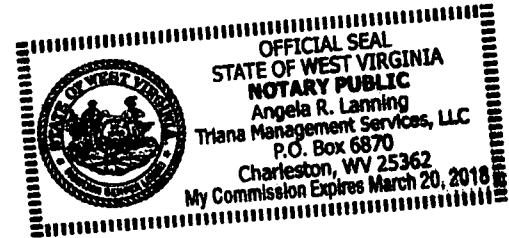
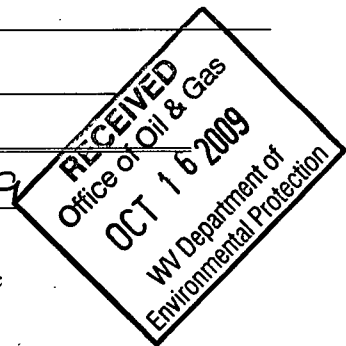

TNG #20

LEGEND

- Property Boundary
- Road
- Existing Fence
- Planned Fence
- Stream
- Open Ditch
- Rock
- North
- Buildings
- Water wells
- Drill site

- Diversion
- Spring
- Wet Spot
- Drain Pipe with size in inches
- Waterway
- Cross Drain
- Artificial Filter Strip
- Pit: cut walls
- Pit: compacted fill walls
- Area for Land Application of Pit Waste

Proposed Revegetation Treatment: Acres Disturbed +/- 2.75 Prevegetation pH _____

Lime 3 Tons/acre or to correct to pH 6.5

Fertilizer (10-20-20 or equivalent) 1/3 Ton lbs/acre (500 lbs minimum)

Mulch Hay @ 2 Tons/acre

Seed Mixtures

Area I		Area II	
Seed Type	lbs/acre	Seed Type	lbs/acre
KY-31	40	Orchard Grass	15
Alsike Clover	5	Alsike Clover	5
Annual Rye	15		

Attach:

Drawing(s) of road, location, pit and proposed area for land application.

Photocopied section of involved 7.5' topographic sheet.

Plan Approved by: *[Signature]*

Comments: Taylor Run Rd left to 2nd location

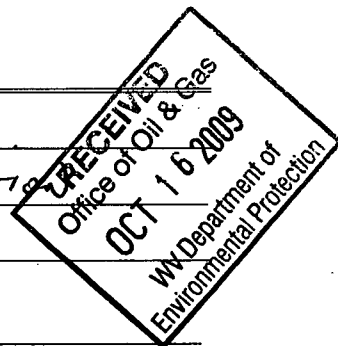

Title: Inspector Orlie Coas

Date: 4-30-09

Field Reviewed? Yes No

NEW GAULEY COAL CORP. LEASE WELL: TNG #20

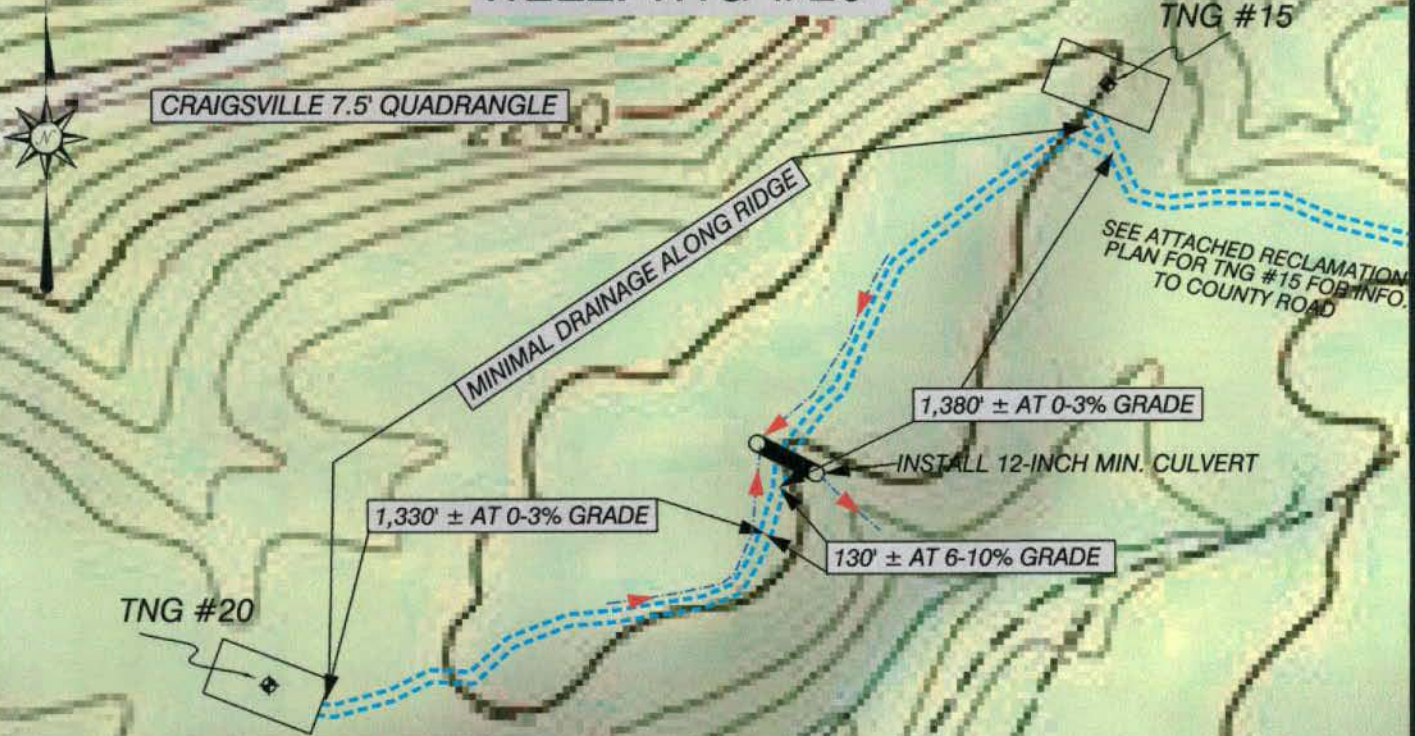

DETAIL SKETCH

TNG #20

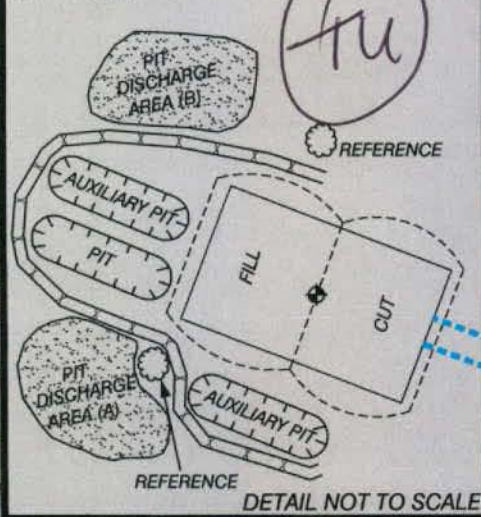

SCALE: 1-INCH = 500-FEET



ALL ROADS SHOWN HEREON ARE EXISTING UNLESS OTHERWISE NOTED AND SHALL BE MAINTAINED IN ACCORDANCE WITH WV DEP OIL AND GAS BMP MANUAL. ENTRANCES AT COUNTY AND STATE ROADS SHALL BE MAINTAINED IN ACCORDANCE WITH WV DOT REGULATIONS. SEPARATE PERMITS MAY BE REQUIRED BY THE D.O.T.

SEDIMENT BASINS AND APPROPRIATE EROSION CONTROL BARRIERS ARE TO BE CONSTRUCTED AT ALL CULVERT AND CROSS DRAIN INLETS AND OUTLETS AS REQUIRED IN THE WV DEP OIL AND GAS BMP MANUAL. FIELD CONDITIONS (ROCK OUTCROPS AND BEDROCK) MAY PROHIBIT INLET TRAPS BEING INSTALLED. WHEN THESE CONDITIONS EXIST ADDITIONAL EROSION CONTROL MEASURES SHALL BE EVALUATED AND UTILIZED AS NEEDED.

EARTHWORK CONTRACTORS ARE RESPONSIBLE FOR NOTIFICATION TO THE OPERATOR AND INSPECTOR PRIOR TO ANY DEVIATION FROM THIS PLAN.

TEMPORARY SEED AND MULCH ALL SLOPES AFTER CONSTRUCTION OF LOCATION.



G.A. COVEY ENGINEERING

P.O. BOX 185
SUTTON, WEST VIRGINIA 26601
PHONE: (304) 364 - 4100
FAX: (304) 364 - 5100

WWW.COVEYENGINEERING.COM

NEW GAULEY COAL CORP. LEASE WELL: TNG #15



TNG #15
(SEE DETAIL SKETCH)

780' ± AT 0-6% GRADE

PLUM CREEK
TIMBERLANDS, LP

150' ± AT 5-10% GRADE

620' ± AT 5-10% GRADE

MINIMAL DRAINAGE
ALONG RIDGE

2100' ± AT 0-6% GRADE

TNG #18

210' ± AT 10-15% GRADE

BEGIN NEW
CONSTRUCTION

EXISTING ACCESS ROAD

2220' ± AT 5-10% GRADE

MATCH
LINE 14'

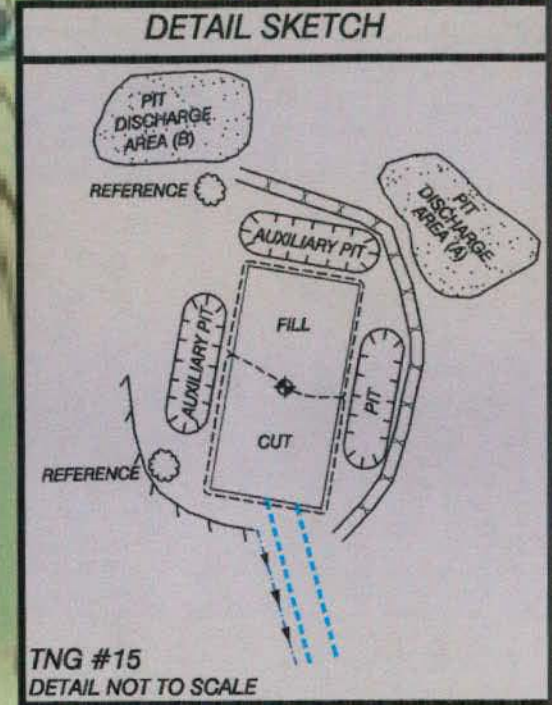

ALL ROADS SHOWN HEREON ARE EXISTING UNLESS OTHERWISE NOTED AND SHALL BE MAINTAINED IN ACCORDANCE WITH WV DEP OIL AND GAS BMP MANUAL ENTRANCES AT COUNTY AND STATE ROADS SHALL BE MAINTAINED IN ACCORDANCE WITH WV DOT REGULATIONS SEPARATE PERMITS MAY BE REQUIRED BY THE D.O.T.

SEDIMENT BASINS AND APPROPRIATE EROSION CONTROL BARRIERS ARE TO BE CONSTRUCTED AT ALL CULVERT AND CROSS DRAIN INLETS AND OUTLETS AS REQUIRED IN THE WV DEP OIL AND GAS BMP MANUAL FIELD CONDITIONS (ROCK OUTCROPS AND BEDROCK) MAY PROHIBIT INLET TRAPS BEING INSTALLED. WHEN THESE CONDITIONS EXIST ADDITIONAL EROSION CONTROL MEASURES SHALL BE EVALUATED AND UTILIZED AS NEEDED.

EARTHWORK CONTRACTORS ARE RESPONSIBLE FOR NOTIFICATION TO THE OPERATOR AND INSPECTOR PRIOR TO ANY DEVIATION FROM THIS PLAN.

TEMPORARY SEED AND MULCH ALL SLOPES AFTER CONSTRUCTION OF LOCATION.

SCALE: 1-INCH = 600-FEET



G.A. COVEY ENGINEERING

P.O. BOX 185
SUTTON, WEST VIRGINIA 26601
PHONE: (304) 364-4100
FAX: (304) 364-5100

WWW.COVEYENGINEERING.COM

67-00938

67-00938

NEW GAULEY COAL CORP. LEASE WELL: TNG #15



PLUM CREEK
TIMBERLANDS, LP

PLUM CREEK
TIMBERLANDS, LP

DOUGLAS WILSON

TIMOTHY SPENCER

LLOYD SPENCER

MATCH LINE *A*

390' ± AT 0-6% GRADE

2590' ± AT 5-10% GRADE

EXISTING ACCESS ROAD

TAYLOR RUN

810' ± AT 0-6% GRADE

470' ± AT 5-10% GRADE

MATCH LINE *B*

ALL ROADS SHOWN HEREON ARE EXISTING UNLESS OTHERWISE NOTED AND SHALL BE MAINTAINED IN ACCORDANCE WITH WV DEP OIL AND GAS BMP MANUAL. ENTRANCES AT COUNTY AND STATE ROADS SHALL BE MAINTAINED IN ACCORDANCE WITH WV DOT REGULATIONS. SEPARATE PERMITS MAY BE REQUIRED BY THE D.O.T.

SEDIMENT BASINS AND APPROPRIATE EROSION CONTROL BARRIERS ARE TO BE CONSTRUCTED AT ALL CULVERT AND CROSS DRAIN INLETS AND OUTLETS AS REQUIRED IN THE WV DEP OIL AND GAS BMP MANUAL. FIELD CONDITIONS (ROCK OUTCROPS AND BEDROCK) MAY PROHIBIT INLET TRAPS BEING INSTALLED. WHEN THESE CONDITIONS EXIST ADDITIONAL EROSION CONTROL MEASURES SHALL BE EVALUATED AND UTILIZED AS NEEDED.

EARTHWORK CONTRACTORS ARE RESPONSIBLE FOR NOTIFICATION TO THE OPERATOR AND INSPECTOR PRIOR TO ANY DEVIATION FROM THIS PLAN.

TEMPORARY SEED AND MULCH ALL SLOPES AFTER CONSTRUCTION OF LOCATION.

ALL CULVERTS SHOWN HEREON ARE EXISTING 15-INCH UNLESS OTHERWISE NOTED.

SCALE: 1-INCH = 600-FEET



G. A. COVEY ENGINEERING

P.O. BOX 185
SUTTON, WEST VIRGINIA 26601
PHONE: (304) 364 - 4100
FAX: (304) 364 - 5100

WWW.COVEYENGINEERING.COM

NEW GAULEY COAL CORP. LEASE WELL: TNG #15



ALL ROADS SHOWN HEREON ARE EXISTING UNLESS OTHERWISE NOTED AND SHALL BE MAINTAINED IN ACCORDANCE WITH WV DEP OIL AND GAS BMP MANUAL. ENTRANCES AT COUNTY AND STATE ROADS SHALL BE MAINTAINED IN ACCORDANCE WITH WV DOT REGULATIONS. SEPARATE PERMITS MAY BE REQUIRED BY THE D.O.T.

SEDIMENT BASINS AND APPROPRIATE EROSION CONTROL BARRIERS ARE TO BE CONSTRUCTED AT ALL CULVERT AND CROSS DRAIN INLETS AND OUTLETS AS REQUIRED IN THE WV DEP OIL AND GAS BMP MANUAL. FIELD CONDITIONS (ROCK OUTCROPS AND BEDROCK) MAY PROHIBIT INLET TRAPS BEING INSTALLED. WHEN THESE CONDITIONS EXIST ADDITIONAL EROSION CONTROL MEASURES SHALL BE EVALUATED AND UTILIZED AS NEEDED.

EARTHWORK CONTRACTORS ARE RESPONSIBLE FOR NOTIFICATION TO THE OPERATOR AND INSPECTOR PRIOR TO ANY DEVIATION FROM THIS PLAN.

TEMPORARY SEED AND MULCH ALL SLOPES AFTER CONSTRUCTION OF LOCATION.

PLUM CREEK
TIMBERLANDS, LP

J. CAUDLE, JR.

SAUL SPENCER

PENNINGTON

TO TNG #9
& CO. RT. 39/15

TO TNG #2R

SCALE: 1-INCH = 600-FEET



G.A. COVEY ENGINEERING

P.O. BOX 185
SUTTON, WEST VIRGINIA 26601
PHONE: (304) 364 - 4100
FAX: (304) 364 - 5100

WWW.COVEYENGINEERING.COM

SEE ATTACHED RECLAMATION PLAN FOR TNG #2R & TNG #9 FOR INFORMATION FROM THIS POINT TO COUNTY ROUTE 39/15



NEW GAULEY COAL CORP. LEASE WELL: TNG # 2R & 9

NETTIE 7.5 QUADRANGLE

RICHWOOD 7.5 QUADRANGLE

TNG #9
SEE DETAIL SKETCH

PLUM CREEK TIMBERLANDS, LP
(SURFACE)

TO TNG #15

2900' ± AT 0-3% GRADE

(CULVERTS AND OTHER
DRAINAGE STRUCTURES
ALREADY IN PLACE)

200' ± AT 5-10% GRADE

TNG #2R
SEE DETAIL SKETCH

350' ± AT 5-10% GRADE

600' ± AT 0-3% GRADE

1400' ± AT 2-6% GRADE

480' ± AT 15-20% GRADE

550' ± AT 5-10% GRADE

SCALE: 1-INCH = 500-FEET



ALL ROADS SHOWN HEREON ARE EXISTING UNLESS OTHERWISE NOTED AND SHALL BE MAINTAINED IN ACCORDANCE WITH WV DEP OIL AND GAS BMP MANUAL. ENTRANCES AT COUNTY AND STATE ROADS SHALL BE MAINTAINED IN ACCORDANCE WITH WV DOT REGULATIONS. SEPARATE PERMITS MAY BE REQUIRED BY THE D.O.T.

SEDIMENT BASINS AND APPROPRIATE EROSION CONTROL BARRIERS ARE TO BE CONSTRUCTED AT ALL CULVERT AND CROSS-DRAIN INLETS AND OUTLETS AS REQUIRED IN THE WV DEP OIL AND GAS BMP MANUAL. FIELD CONDITIONS (ROCK OUTCROPS AND BEDROCK) MAY PROHIBIT INLET TRAPS BEING INSTALLED. WHEN THESE CONDITIONS EXIST ADDITIONAL EROSION CONTROL MEASURES SHALL BE EVALUATED AND UTILIZED AS NEEDED.

EARTHWORK CONTRACTORS ARE RESPONSIBLE FOR NOTIFICATION TO THE OPERATOR AND INSPECTOR PRIOR TO ANY DEVIATION FROM THIS PLAN.

TEMPORARY SEED AND MULCH ALL SLOPES AFTER CONSTRUCTION OF LOCATION.

ALL CULVERTS SHOWN HEREON ARE EXISTING 15-INCH UNLESS OTHERWISE NOTED.

THERE APPEAR TO BE NO LEASE/SURFACE BOUNDARY LINES IN THE IMMEDIATE VICINITY OF THE ACCESS ROAD OR PROPOSED LOCATION.

G.A. COVEY ENGINEERING

SUTTON, WEST VIRGINIA 26601
PHONE: (304) 364-4100
FAX: (304) 364-5100

P.O. BOX 5584
1296 ROBERT C. BYRD DRIVE
BECKLEY, WEST VIRGINIA 25801
PHONE: (304) 258-2003
FAX: (304) 929-3494

WWW.COVEYENGINEERING.COM



67-00938

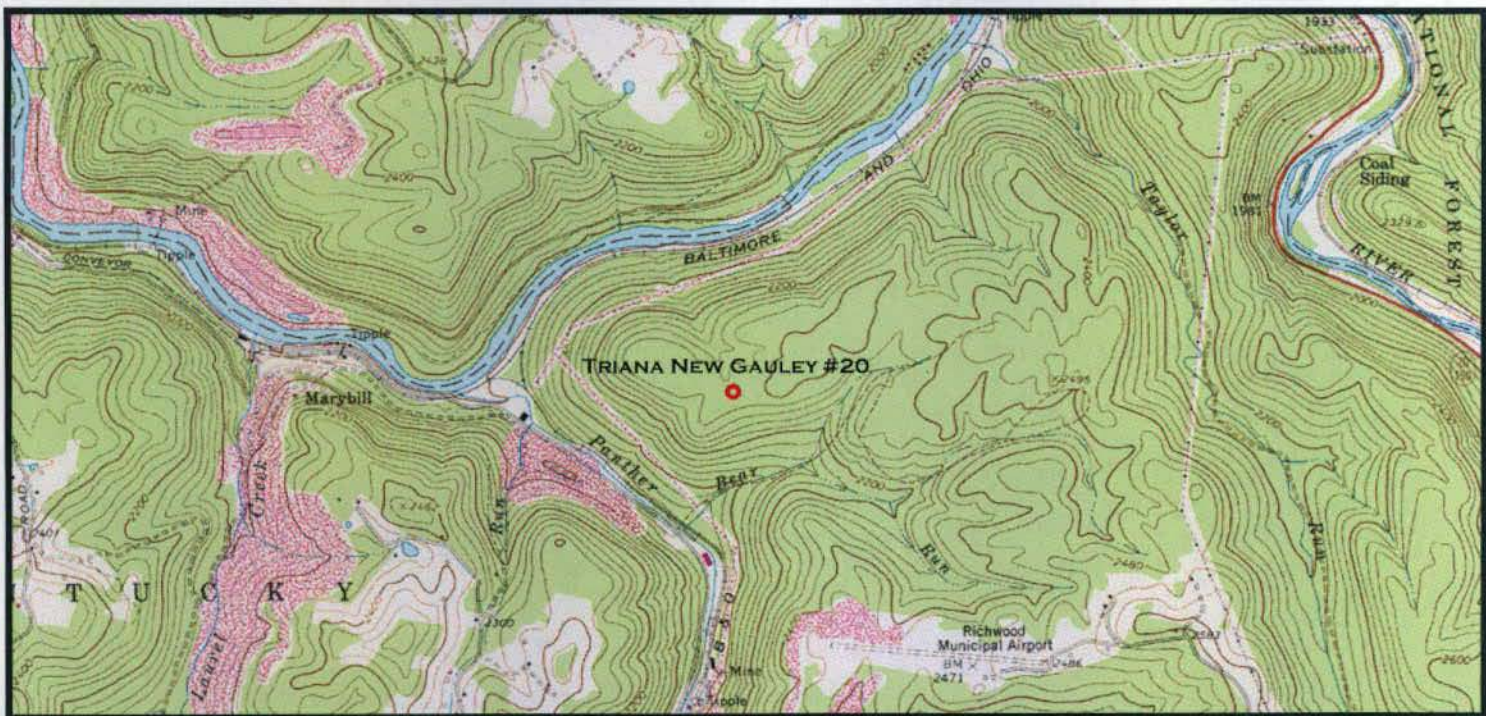

1" = 2,000'

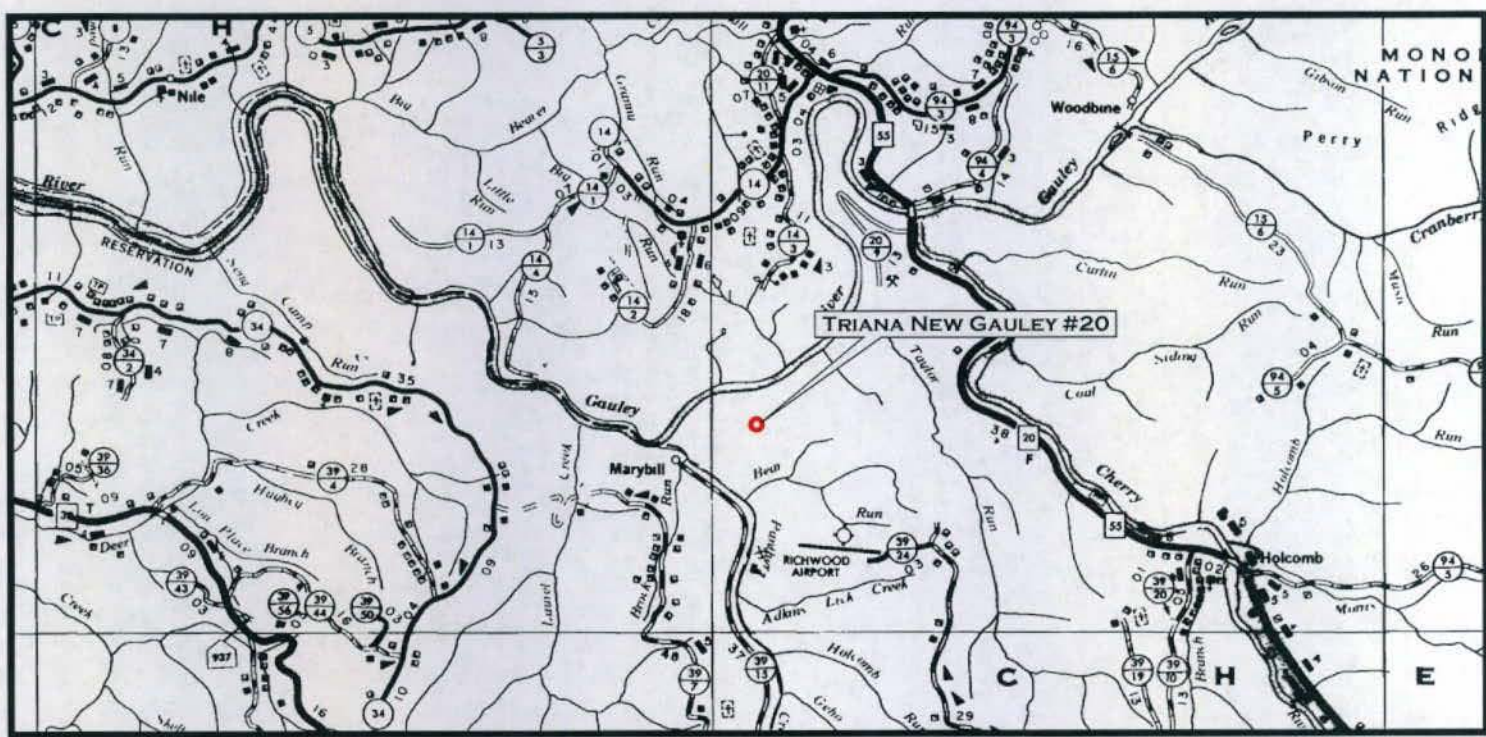

1" = 1 MILE



TRIANA NEW GAULEY #20
 NICHOLAS COUNTY, WV
 KENTUCKY DISTRICT
 CRAIGSVILLE QUAD

900 VIRGINIA STREET EAST, SUITE 400
 CHARLESTON, WV 25301
 304-380-0100

7008 2810 0000 2266 4466

U.S. Postal Service™ **CERTIFIED MAIL™ RECEIPT**
(Domestic Mail Only; No Insurance Coverage Provided)

TNG #28

For delivery information, visit our website at www.usps.com

LEVASY WV 26676

OFFICIAL USE

Postage	\$ 1.34
Certified Fee	\$2.70
Return Receipt Fee (Endorsement Required)	\$2.20
Restricted Delivery Fee (Endorsement Required)	\$0.00
Total Postage & Fees	\$ 6.24

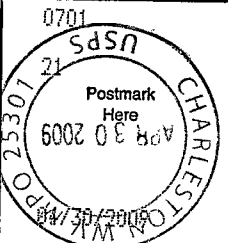

Sent To: Green Valley Coal Company
 Street, Apt. No., or PO Box No.: P. O. Box 190
 City, State, ZIP+4: Leivasy, WV 26676

PS Form 3800, August 2006 See Reverse for Instructions

7008 2810 0000 2266 4475

U.S. Postal Service™ **CERTIFIED MAIL™ RECEIPT**
(Domestic Mail Only; No Insurance Coverage Provided)

TNG #28

For delivery information, visit our website at www.usps.com

LEVASY WV 26676

OFFICIAL USE

Postage	\$ 1.34
Certified Fee	\$2.70
Return Receipt Fee (Endorsement Required)	\$2.20
Restricted Delivery Fee (Endorsement Required)	\$0.00
Total Postage & Fees	\$ 6.24

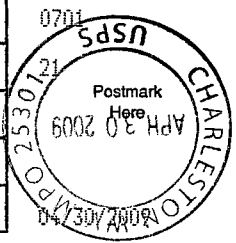

Sent To: White Buck Coal Company
 Street, Apt. No., or PO Box No.: P. O. Box 180
 City, State, ZIP+4: Leivasy, WV 26676

PS Form 3800, August 2006 See Reverse for Instructions

7008 2810 0000 2266 4457

U.S. Postal Service™ **CERTIFIED MAIL™ RECEIPT**
(Domestic Mail Only; No Insurance Coverage Provided)

TNG #20

For delivery information, visit our website at www.usps.com

LEWISBURG WV 24901

OFFICIAL USE

Postage	\$ 1.34
Certified Fee	\$2.70
Return Receipt Fee (Endorsement Required)	\$2.20
Restricted Delivery Fee (Endorsement Required)	\$0.00
Total Postage & Fees	\$ 6.24

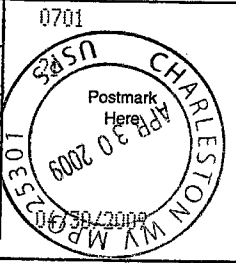

Sent To: Plum Creek Timberlands, LP
 Street, Apt. No., or PO Box No.: P. O. Box 1109
 City, State, ZIP+4: Lewisburg, WV 24901-4109

PS Form 3800, August 2006 See Reverse for Instructions

7008 2810 0000 2266 4445

U.S. Postal Service™ **CERTIFIED MAIL™ RECEIPT**
(Domestic Mail Only; No Insurance Coverage Provided)

TNG #20

For delivery information, visit our website at www.usps.com

HUNTINGTON WV 25705

OFFICIAL USE

Postage	\$ 1.34
Certified Fee	\$2.70
Return Receipt Fee (Endorsement Required)	\$2.20
Restricted Delivery Fee (Endorsement Required)	\$0.00
Total Postage & Fees	\$ 6.24

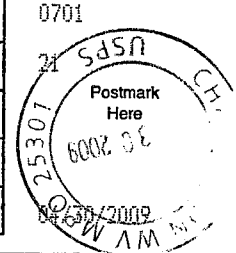

Sent To: WPP, LLC (NRP, LP)
 Street, Apt. No., or PO Box No.: 5260 Irwin Road
 City, State, ZIP+4: Huntington, WV 25705

PS Form 3800, August 2006 See Reverse for Instructions

RECEIVED
 Office of Oil & Gas
 OCT 16 2009
 WV Department of
 Environmental Protection

Craigsville



Operator: TRIANA ENERGY, LLC

API: 6700938

WELL No: TRIANA NEW GAULEY 20

Reviewed by: Za Date: 10-24-09

15 Day End of Comment: 11/3

CHECKLIST FOR FILING A PERMIT

New Well

- WW-2B
- Inspector signature on WW-2B
- WW-2A (Notarized)
- Certified Mail Receipts, Waivers, or Affidavits of Personal Service
- Surface Owner Waiver
- Coal Owner / Lessee / Operator Waiver
- WW-2A-1 (Signed) Showing Book/Page Number and Royalty Percentage
- WW-2B-1 (Names, addresses, and spot on topographical map listed as water testing)
- WW-9 (Page 1 & 2) (Notarized)
- Inspector Signature on WW-9
- Reclamation plan
- Topographic Map of location of well
- Mylar Plat (Signed and Sealed) (Surface owner on plat matches WW-2A)
- Bond
- Company is Registered with the SOS
- Worker's Compensation / Unemployment Insurance account is OK
- \$650.00 check (\$550.00 if no pit)