

Latitude 39 45

2:713
2:91W

Longitude 80 20

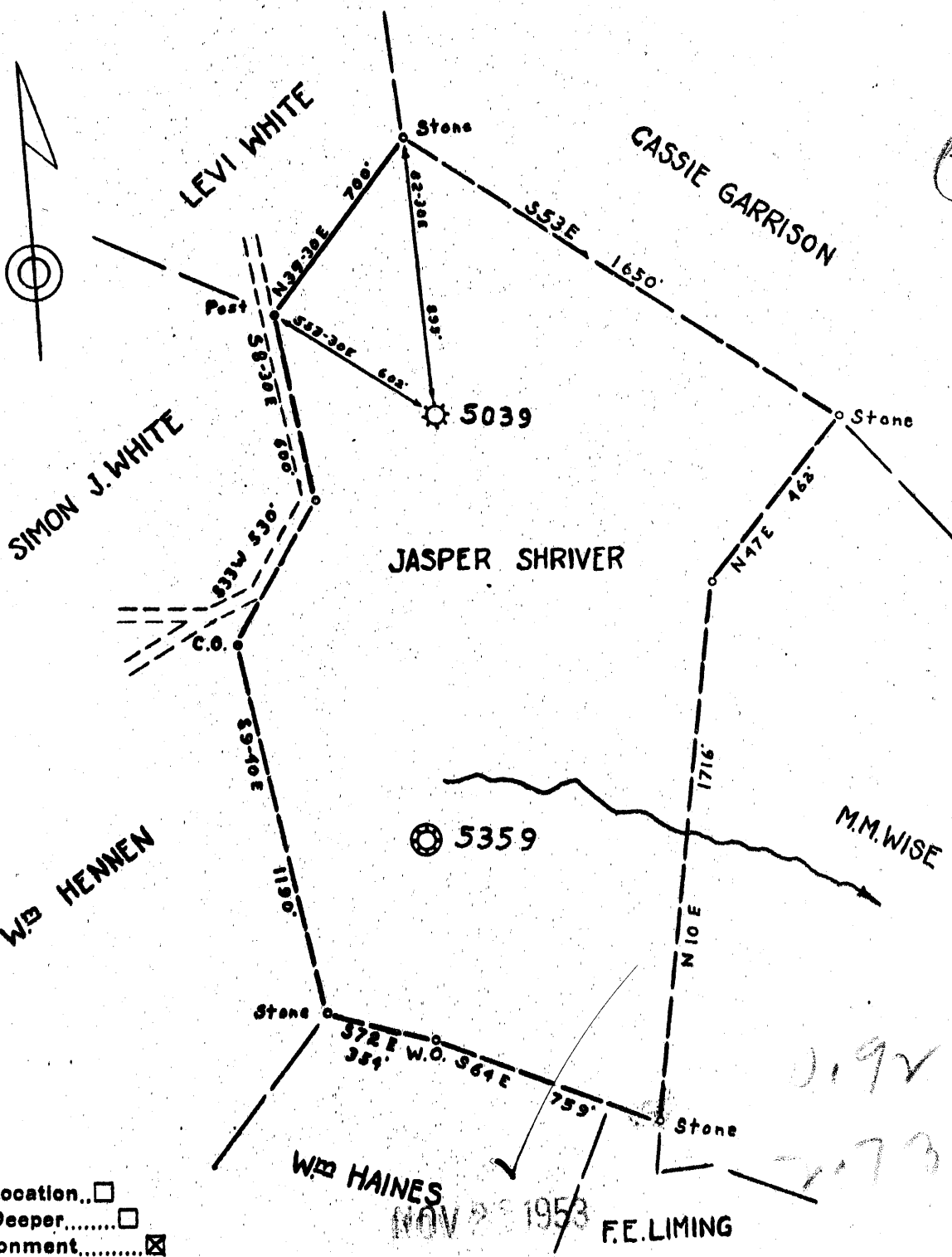

New Location...
 Drill Deeper.....
 Abandonment.....

NOV 28 1953

F.E. LIMING

Company EQUITABLE GAS CO. W.VA. DIV.

Address PITTSBURGH, PA.

Farm JASPER SHRIVER

Tract _____ Acres 74 Lease No. 6963

Well (Farm) No. _____ Serial No. 5039

Elevation (Spirit Level) 1414'

Quadrangle MANNINGTON NE 12

County MONONGALIA District BATTELLE

Engineer James J. Shippin

Engineer's Registration No. 1084

File No. _____ Drawing No. _____

Date OCT. 5 1953 Scale 1" = 500'

STATE OF WEST VIRGINIA
 DEPARTMENT OF MINES
 OIL AND GAS DIVISION
 CHARLESTON

WELL LOCATION MAP

FILE NO. MON-578-A

+ Denotes location of well on United States Topographic Maps, scale 1 to 62,500, latitude and longitude lines being represented by border lines as shown.

- Denotes one inch spaces on border line of original tracing.

RDPT

JASPER SHRIVER W. 5039 - EQUITABLE GAS CO., W.VA. DIV. - MON-578-A



STATE OF WEST VIRGINIA
DEPARTMENT OF MINES
OIL AND GAS DIVISION

676

Permit No. 578-A

Oil or Gas Well **GAS**
(KIND)

Company Equitable Gas Company-West Va Div.
 Address Clarkburg, West Va.
 Farm Jasper Shriver Acres 7 1/2
 Location (waters) Hannington N/E. 1-3
 Well No. 3039 Eley 1414'
 District Battelle County Monongalia
 The surface of tract is owned in fee by Earnest Bell
 Address Burton, W. Va.
 Mineral rights are owned by Earnest Bell
 Address Burton, West Va.
 Drilling commenced February 22, 1913
 Drilling completed April 4, 1913
 Date Shot From To
 With
 Open Flow /10ths Water in Inch
 /10ths Merc. in Inch
 Volume Cu. Ft.
 Rock Pressure lbs. hrs.
 Oil bbls., 1st 24 hrs.
 Fresh water feet feet
 Salt water feet feet

Casing and Tubing	Used in Drilling	Left in Well	Packers
Size			Kind of Packer
16			
13			
10	<u>3 1/2"</u>	<u>3 1/2"</u>	Size of
8 1/4	<u>1665'</u>	<u>1665'</u>	
6 3/4	<u>2060'</u>	<u>2060'</u>	Depth set
5 3/16	<u>2380'</u>	<u>2380'</u>	
3			Perf. top
2			Perf. bottom
Liners Used			Perf. top
			Perf. bottom

CASING CEMENTED _____ SIZE _____ No. Ft. _____ Date _____
 COAL WAS ENCOUNTERED AT 1152 FEET 96 INCHES
 _____ FEET _____ INCHES FEET _____ INCHES
 _____ FEET _____ INCHES FEET _____ INCHES

Formation	Color	Hard or Soft	Top	Bottom	Oil, Gas or Water	Depth Found	Remarks
Un-recorded			0	1152			
Pgh. Coal	Black	Soft	1152	1160			
Lime	Light	Hard	1160	1200			
Slate			1200	1335			
Sand	Light	Hard	1335	1360			
Slate	Dark	Soft	1360	1425			
Red Rock	Red	Hard	1425	1460			
Sand	Dark	"	1460	1480			
Slate	"	"	1480	1552			
Little Dunkard	Light	"	1552	1620			
Slate&shells			1620	1825			
Gas Sand	Light	Soft	1825	1920			
Slate	Dark	"	1920	1950			
1st. Salt Sand			1950	2055			
Slate	Dark		2055	2150			
2nd. Salt Sand	Light	Hard	2150	2170			
Lime			2170	2220			
Red Rock			2220	2300			
Lime			2300	2315			
Slate			2315	2335			
Little Lime			2335	2345			
Pencil Cave			2345	2350			
Big Lime			2350	2421			
Big Injun	Dark	Hard	2421	2655	Gas	2421-2432'	
Slate&shells	"	Hard&Soft	2655	2754			
Berea	"	Hard	2754	2772			
Slate&shells	Light	Hard&Soft	2772	2971			
Quartz Sand	Dark	Hard	2971	3001			
Slate	Light	Soft	3001	3015			
Lime	Dark	Hard	3015	3030			
Slate&shells	Light	Soft&Hard	3030	3108			
50 Ft. Sand	Dark		3108	3148	Gas	3110-3144'	
Slate	White		3148	3154			
Total Depth.....				3154			

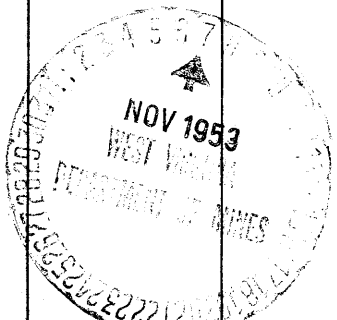

Formation	Color	Hard or Soft	Top	Bottom	Oil, Gas or Water	Depth Found	Remarks

Date **December 14, 1944**, 19

APPROVED **EQUITABLE GAS COMPANY-WEST VA DIV.**, Owner

By *W. G. Masten*
(Title)



Sec.	lbs.	9-1-2"	12-2-35"
30	70	8	1/2 min 4
1 Min.	110	14	1 " 7
2 "	170	24	2 " 8
5 "	225	48	3 " 11
10 "	245	80	4 " 13
20 "	255	95	5 " 15
30 "		60 min. 100	10 " 25 25 " 35 60 " 62

Rock Pressure 305-15 hrs. " in
 Taken Apr. 4-1913. 19
 By

June 1918 - 2.8 W2 " 253000 ^{102-48 hrs.}

WELL TUBED AND PACKED *Sept 6* 1922

VIZ: - 151 ft. 3022 ft. 2 tubing old.
 1-5 7/8 X 5" Hook Wall Packer O.W.S.
 1-3 X 2" swedge nipple
 1-2" P.L. Collar Nipple
 Retained

FIRST PRESSURE TEST IN	TUBING	REMARKS
30 Sec. 34	lbs.	
1 Min. 54	"	
2 " 86	"	
5 " 170	"	
10 " 260	"	
20 " 340	"	
30 " 395	"	
Rock Pressure	" in	0731 5001 0471 0281 0441 2581 0205 0241
Taken <i>Sept. 6-1922</i>	19	
By		

MATERIAL FOR THIS WELL RECEIVED FROM FOLLOWING SOURCES:

1-Wood Rig well no. 2467
 1 Set Rig Drums. " " "
 Woodwork conductor & rails Stock
 637 ft. Lumber 20-22 Sea Mt. 127.54 J. W. Shiner
 1 Partial set timbers 10-22 J. W. Shiner
 June 29-1922 Drilling Rig W.O. 1678
 949.5 ft. Lumber new 38-9 p.u.m. Balt. 360.05 C. Bell
 1 Partial set rig timbers 65.00 C. J. Calkins
 5044 ft. of 2" tubing