

Latitude 39 45'

Longitude 80 00'

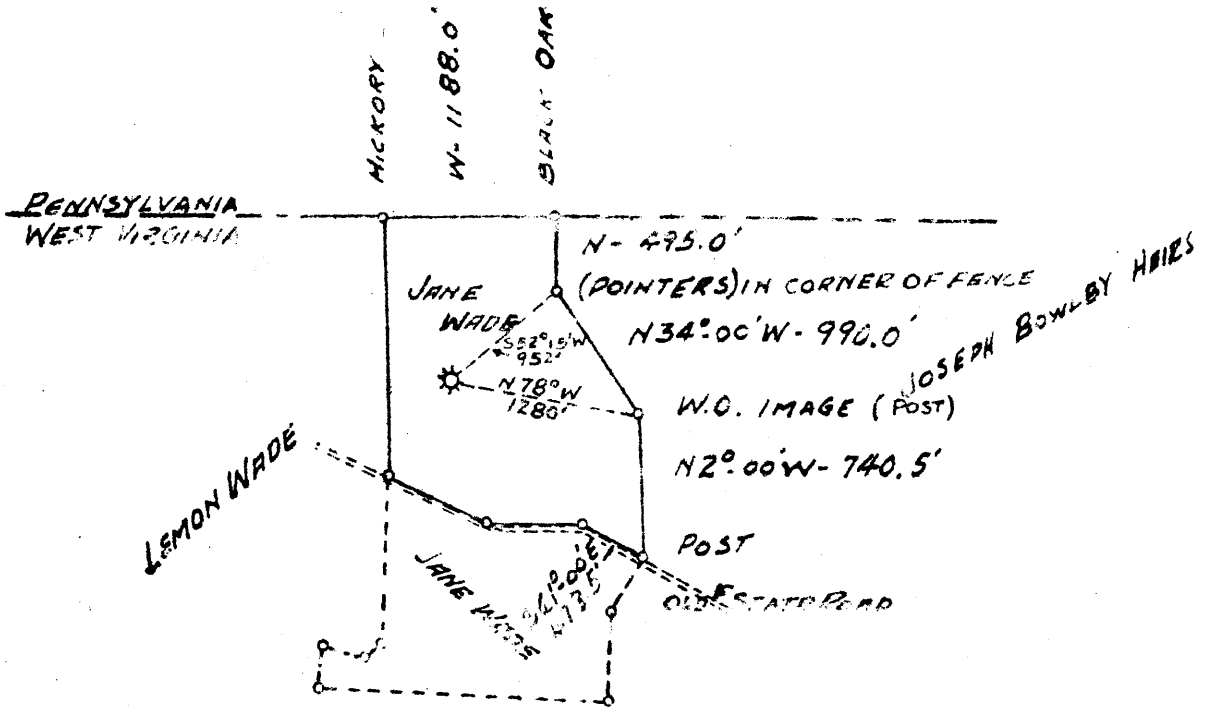

+ 2.37S
1.94W

2.37S
1.95W

1256.62
1056.00
1056.00
1056.00

New Location
Drill Deeper
Abandonment

Company FRANK S. ULLOM
 Address WAYNESBURG, PA.
 Farm SARAH JANE WADE
 Tract _____ Acres 60 Lease No. 572
 Well (Farm) No. 1 Serial No. 570
 Elevation (Spirit Level) 1256.62
 Quadrangle BLACKSVILLE - N-E
 County MONONGALIA District CASS
 Engineer B.B. COUK
 Engineer's Registration No. 4274 - PA.
 File No. _____ Drawing No. _____
 Date 1-18-43 Scale 1" = 1320

STATE OF WEST VIRGINIA
DEPARTMENT OF MINES
OIL AND GAS DIVISION
CHARLESTON

WELL LOCATION MAP
FILE NO. MON-354-A

+ Denotes location of well on United States Topographic Maps, scale 1 to 62,500, latitude and longitude lines being represented by border lines as shown.

- Denotes one inch spaces on border line of original tracing.



517

STATE OF WEST VIRGINIA
DEPARTMENT OF MINES
OIL AND GAS DIVISION

WELL RECORD

Permit No. 304 X

Oil or Gas Well Gas

(KIND)

Company Frank S. Ullom
 Address Raynesburg, Pa.
 Farm Sarah Jane Wade Acres 60
 Location (waters) Wades Run
 Well No. One (1) Elev 1256.62
 District Cass County Monongalia
 The surface of tract is owned in fee by Emma Goodrich
 Address Mt. Morris, Pa.
 Mineral rights are owned by _____
 Address _____
 Drilling commenced Approximately 1915
 Drilling completed " " "
 Date Shot No Record From _____ To _____
 With _____
 Open Flow /10ths Water in No Record Inch
 /10ths Merc. in _____ Inch
 Volume No Record Cu. Ft.
 Rock Pressure No Record lbs. _____ hrs.
 Oil None bbls., 1st 24 hrs.
 Fresh water No Record feet _____ feet
 Salt water No Record feet _____ feet

Casing and Tubing	Used in Drilling	Left in Well	Packers
Size			Kind of Packer
16			<u>Wall Disc</u>
13			Size of <u>2"x5 3/8"</u>
10	<u>456</u>	<u>None</u>	Depth set
8 3/4	<u>1163</u>	"	Perf. top
6 5/8	<u>1471</u>	"	Perf. bottom
5 3/16	<u>1752</u>	<u>1752</u>	Perf. top
3			Perf. bottom
2	<u>1814</u>	<u>1814</u>	
Liners Used			

CASING CEMENTED _____ SIZE _____ No. Ft. _____ Date _____
 COAL WAS ENCOUNTERED BT AT 356 FEET 60est. INCHES
436 FEET 60est. INCHES FEET INCHES
 FEET INCHES FEET INCHES

Formation	Color	Hard or Soft	Top	Bottom	Oil, Gas or Water	Depth Found	Remarks
Mapletown Coal			351	356			
Pittsburgh Coal			431	436			
Big Injun			1745	1871			
1st Gas Pay				1824			
2nd Gas Pay				1829			
3rd Gas Pay				1836			
Total Depth				1871			

Please note that the original well record stated that the bottom of the Mapletown Coal and the Pittsburgh Coal were encountered at 356 and at 436. The top of these two coals was calculated to occur at approximately 351' and 431. These approximate coal depths were calculated from nearby wells.