

Scale 1" = 400'

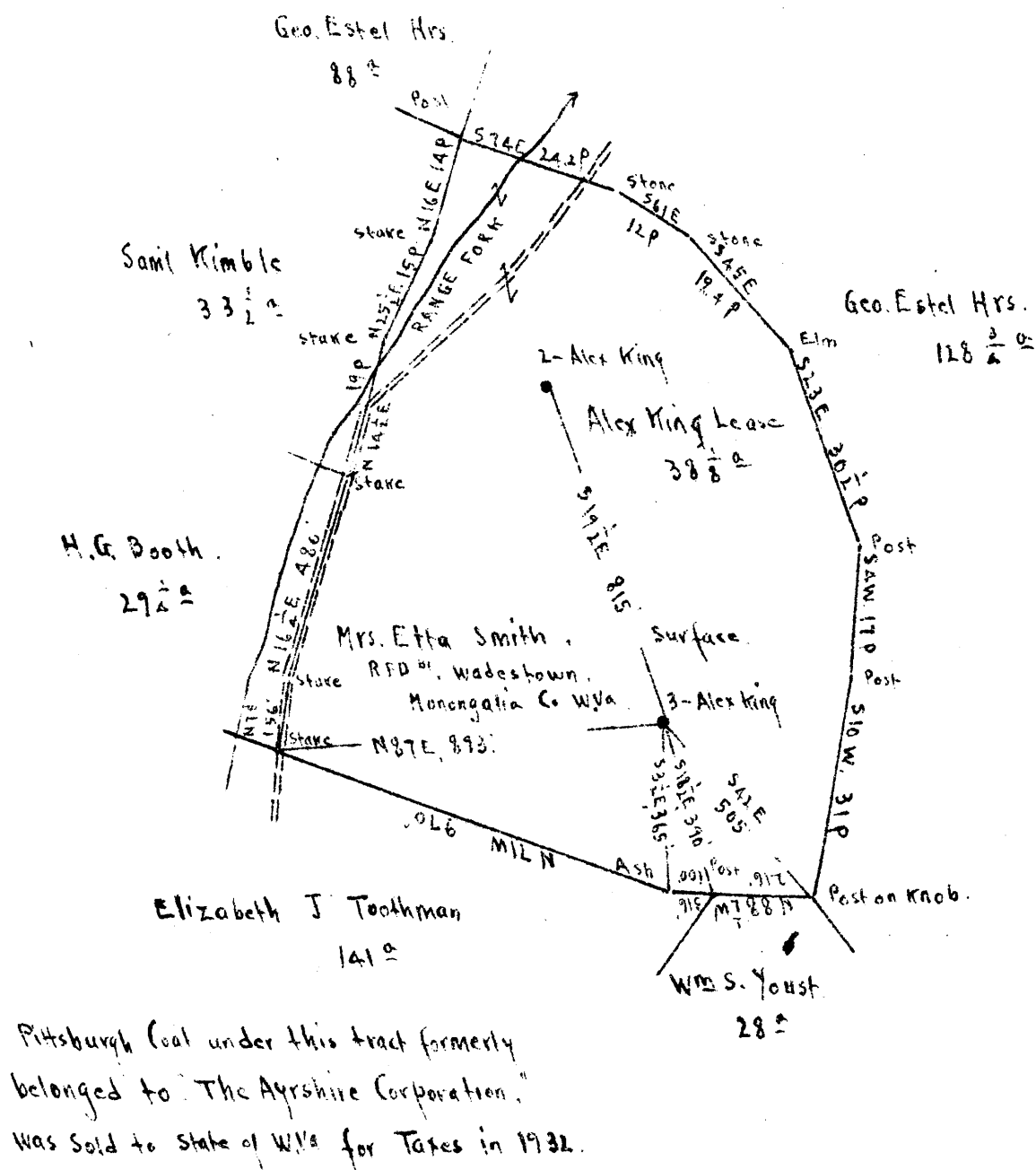

Pittsburgh Coal under this tract formerly belonged to "The Ayrshire Corporation." Was sold to state of WVA for Taxes in 1932.

2.07S  
0.52W

0.15 / W  
2.11

- New Location
- Drill Deeper
- Abandonment

✓ SEP 18 1945

Company	Rad Supply Co.
Address	Salem WVA
Farm	Alex King
Tract	Acres 38 1/3 Lease No.
Well (Farm) No.	3 Serial No.
Elevation (Spirit Level)	Flow 1373.75 Ground 1371.75
Quadrangle	Mannington
County	Monongalia - District Battelle
Engineer	E.C. Tabler
Engineer's Registration No.	
File No.	Drawing No.
Date	June 26 <sup>th</sup> 1945 Scale 1" = 400'

STATE OF WEST VIRGINIA  
DEPARTMENT OF MINES  
OIL AND GAS DIVISION  
CHARLESTON

**WELL LOCATION MAP**  
FILE NO. MON-320-A

+ Denotes location of well on United States Topographic Maps, scale 1 to 62,500, latitude and longitude lines being represented by border lines as shown.

- Denotes one inch spaces on border line of original tracing.

STATE OF WEST VIRGINIA  
DEPARTMENT OF MINES  
OIL AND GAS DIVISION

376

WELL RECORD

Permit No. Mon-320 A

Oil or Gas Well  
(Kind)

Company Read Supply Company  
Address 184 East Main St., Salem, W. Va.  
Farm Alex King Acres 38 1/8

Location (waters).....  
Well No. 3 Elev. 1373.75'  
District Battelle County Monongalia

The surface of tract is owned in fee by Mrs. Etta Smith  
R.F.D.#1 Address Wadestown, W. Va.

Mineral rights are owned by Sold to State of W. Va.  
for Taxes in 1932. Address.....

Drilling commenced.....

Drilling completed.....

Date shot 3/13/13-2/12/27 Depth of shot.....

Open Flow /10ths Water in..... Inch

/10ths Merc. in..... Inch

Volume..... Cu. Ft.

Rock Pressure..... lbs..... hrs.

Oil..... bbls., 1st 24 hrs.

Fresh water..... feet..... feet

Salt water..... feet..... feet

Casing and Tubing	Used in Drilling	Left in Well	Packers
Size			
16			Kind of Packer
13			
10	258'	258'	Size of
8 1/4	1568'	1568'	
6 5/8	2440'	2440'	Depth set
5 3/16	2610'	2610'	
3			Perf. top
2			Perf. bottom
Liners Used			Perf. top
4 1/2" x 4" F.J.	235' 2"	235' 2"	Perf. bottom

CASING CEMENTED No SIZE..... No. Ft..... Date

COAL WAS ENCOUNTERED AT 1185 FEET..... INCHES

1085 FEET..... INCHES 830 FEET..... INCHES

..... FEET..... INCHES..... FEET..... INCHES

Formation	Color	Hard or Soft	Top	Bottom	Oil, Gas or Water	Depth Found	Remarks
Conductor				16'			
<del>Big</del> Sand			780'	830			280 clay plug + feet with case to surface 810 cement
Fairview Coal	250		830				866 clay ← 1065 cement
Mapletown Coal	100		1085				← 1121 clay ← 1221 to 1165 cement
Pittsburgh Coal			1185				← Bridge 12457 feet with clay 1221
Murphy Sand			1295				
Little Dunkard			1515	1535			← Plug 1587
Big Dunkard			1700	1725			← Bridge 1755
Sand			1753	1827			← Plug - 1847
Gas Sand			1870	1944			
Salt Sand			2090	2186			← Bridge 2216
Little Lime			2392	2400			
Pencil Cave			2400	2406			← Plug - 2463
Big Lime			2406	2483			
Big Injun Sand			2483	2640			← Bridge 2670 Rounder casing
Water				2560	Water		
Fifty Foot Sand			3097	3185			← Clay 3077 + Plug 306
Campbell Run Sand		✓	3347	3395			
Oil and water				3349	Oil & Water		
Gordon Sand			3403	3422			

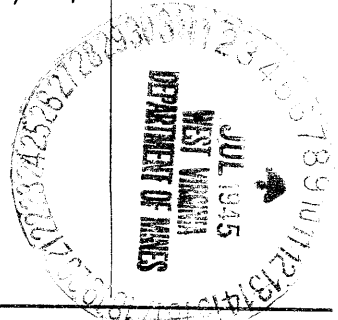

Formation	Color	Hard or Soft	Top	Bottom	Oil, Gas or Water	Depth Found	Remarks
Fourth Sand			3441'				
Oil				3443'	Oil		
Total Depth				3456			

Date.....**July 6**....., 19.. **45**

APPROVED.....**RAAD SUPPLY COMPANY**....., Owner

By.....*J. M. Raad*.....  
 Manager, Owner  
 (Title)