

2  
3

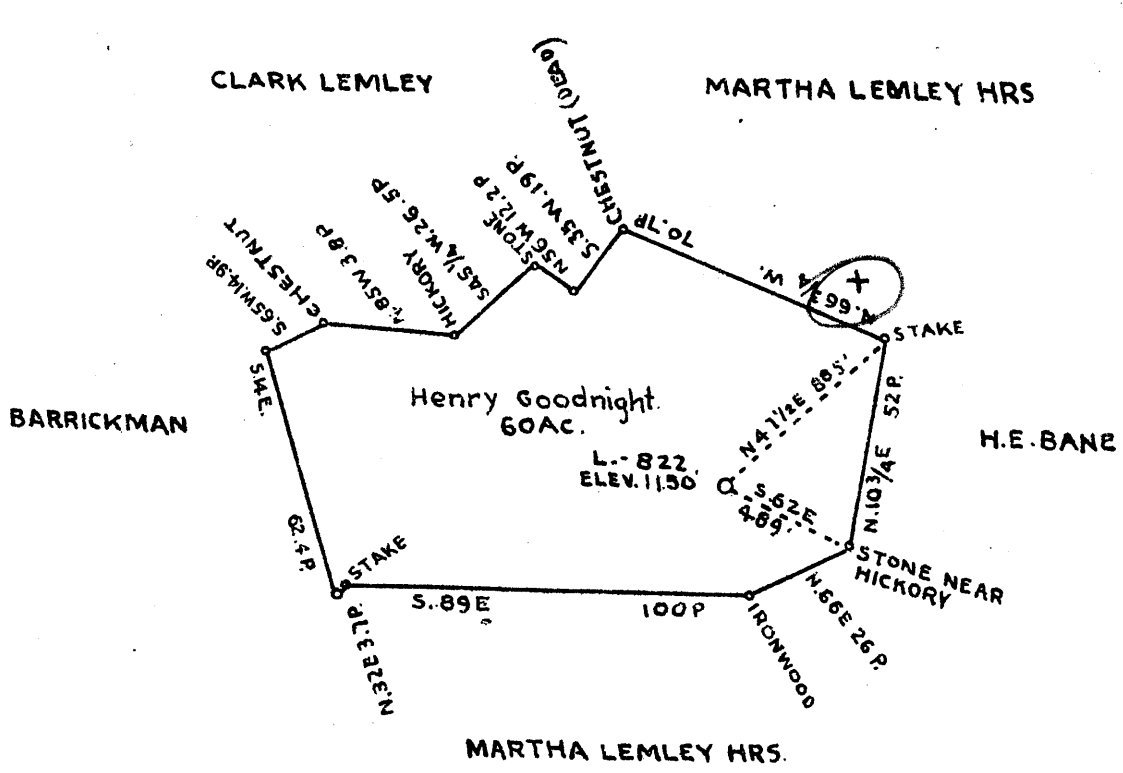

4.53 S  
3.00 W

3.07 W

4.6 A

COAL OWNED BY IRA A. DAVIS, BEVERLEY HILL, FAIRMONT W.VA

NEW LOCATION

DRILL DEEPER

ABANDONMENT

✓ JUL - 3 1945

COMPANY THE MANUFACTURERS LIGHT AND HEAT CO.

ADDRESS 800 UNION TRUST BUILDING PITTSBURGH PA.

FARM HENRY GOODNIGHT

TRACT                      ACRES 60 LEASE NO. 2911

WELL (FARM) NO. 1 SERIAL NO. L-822

ELEVATION (SPIRIT LEVEL) 1150'

QUADRANGLE MANNINGTON N.W. 1/4 **NC**

COUNTY MONONGALIA DISTRICT BATTELLE

ENGINEER J. L. Mervin

ENGINEER'S REGISTRATION NO.                     

FILE NO.                      DRAWING NO. Y-11-142

DATE MAY - 25 - 1945 SCALE 1" = 800'

STATE OF WEST VIRGINIA

DEPARTMENT OF MINES

OIL AND GAS DIVISION

CHARLESTON

WELL LOCATION MAP

FILE NO. MON-316-A

DETERMINED BY THE U.S. GEOLOGICAL SURVEY ON UNITED STATES TOPOGRAPHIC MAPS ACCORDING TO THE METHOD OF LATITUDE AND LONGITUDE AND BEING REPRESENTED BY BORDER LINES AND POINTS.

PLEASE USE ONE INCH SPACES ON BORDER LINES AND POINTS.

HENRY GOODNIGHT NO. 1 (L-822) - M. L. & H. Co. - MON-316-A

LATITUDE 39°42'30"

80°22'30"

LONGITUDE

7.5'  
+  
70167

7.5 OGIS topo location

7.5' loc	<u>1.60 S</u>	15' loc	<u>4.48 S</u>
	<u>0.75 W</u>	(calc.)	<u>2.97 W</u>

#42 on 1912 Co Rpt

Company \_\_\_\_\_

Farm \_\_\_\_\_

Quad Hundred (Wangle NC)

County Monongalia

District Battelle

WELL LOCATION MAP

File No. 061-70167

H. BARRACKMAN NO. 1 (822) WELL.

Battelle District, Monongalia County, W. Va.  
 By The Manufacturers Light & Heat Co., 800 Union Trust Bldg.,  
 Pittsburgh, Pa.

Abandoned under permit Mon-.....-A.

On 80 acres.

Elevation, 1150' L.

Surface owned by Ira A. Davis, Beverly Hills, Fairmont, W. Va., and  
 minerals by The Manufacturers Light & Heat Co., 800 Union Trust  
 Bldg., Pittsburgh, Pa.

Drilling commenced Sept. 25, 1905; completed Nov. 22, 1905.

Rock pressure, 875 lbs.

10" casing, 330' (pulled); 8 $\frac{1}{2}$ " , 1346'; 6 $\frac{5}{8}$ " , 2151'; 4" tubing, 2190'.

Packer, 4 x 6 $\frac{1}{2}$ , set at 2190'.

Coal was encountered at 570-573, 825-830, and 920-925'.

Gas well. Abandonment reported to Dept. of Mines May 28, 1945.

Record to RCT from Mrs. Griffith Sept. 18, 1945. Old File No. 370.

31-  
~~4386~~  
 No. ?

	Top.	Bottom.
Bluff Sand	550	- 570
Waynesburg Coal	570	- 573
Sand	610	- 650
Mapletown (Sewickley) Coal	825	- 830
Pittsburgh Coal	920	- 925
Sand	1080	- 1090
Little Dunkard Sand	1315	- 1360
Big Dunkard Sand	1425	- 1500
Gas Sand	1555	- 1680
Salt Sand	1735	- 1800
Salvation Sand (little gas)	1915	- 2000
Red rock	2010	- 2070
Red rock	2120	- 2125
Pencil Cave	2140	- 2145
Big Lime	2145	- 2207
Big Injun Sand (gas, 2217 and 2231')	2207	- 2432
50-Foot Sand	2880	- 2952
Gordon Stray Sand	2980	- 2992
Red rock	3010	- 3013
Gordon Sand	3013	- 3035
Sand	3066	- 3106
4th Sand (gas, 3166')	3164	- 3181
5th Sand	3206	- 3211
Bayard Sand (gas, 3324')	3324	- 3329
Total depth		3476