

LATITUDE 39° 45' 00"

LONGITUDE 80° 07' 30"

LONGITUDE

75'

7.5 OGIS topo location

7.5' loc	<u>2.355</u>	15' loc	<u>2.355</u>
	<u>0.970</u>	(calc.)	<u>3.190</u>

Company _____

Farm _____

Quad Blacksville (Bullene)

County Monongahela

District Clay

WELL LOCATION MAP

File No. 061-127A

177

70077

was 061-70074

LATITUDE 39° 45' 00"

80° 07' 30"

LONGITUDE

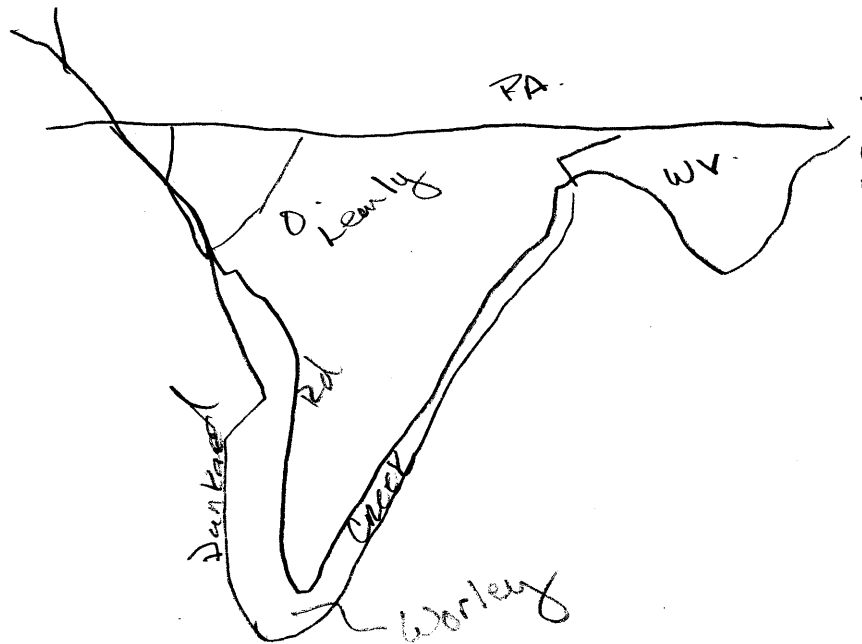

7'5 OGIS topo location

7.5' loc _____ 15' loc _____
 _____ (calc.) _____

Company _____

Farm _____

Quad Blacksville

County Monongalia

District Clay

WELL LOCATION MAP

File No. GW-70074

127A

Upper Arizona

Lower Arizona

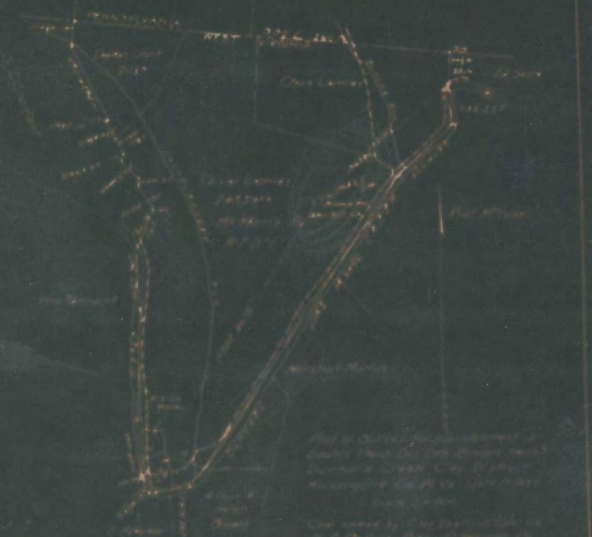

This is a detailed topographic map of the Grand Canyon region, showing the Colorado River and its tributaries. The map is oriented with North at the top.

Key features include the Colorado River, the Grand Canyon, and various towns and landmarks. The map is divided into 'Upper Arizona' and 'Lower Arizona'.

Major tributaries shown include the Paria Plateau and the Kaibab Plateau. Towns such as Flagstaff, Sedona, and Phoenix are marked.

The map includes numerous contour lines and elevation markers.

Clay District, Monongalia County, W. Va.
 Located on Dunkard Creek, within sight of Penna. line,
 near Worley P. O., Clay District.

Elevation, 950'.

Oil well.

Authority, W. Va. Geol. Survey, Vol. I, p. 234.

Blacksville Quadrangle.

Record from U. S. Geological Survey, April 8, 1939.

	Thickness.	Depth.
Conductor		12
Bluff Sand (Waynesburg)		115
Mount Morris Coal (Waynesburg)		180
Mapletown Coal (Sewickley)		440
Pittsburgh Coal		520
Slate and shells	145 -	665
Sand, gray	120 -	785
Red and blue cave	65 -	850
Slate and shells	45 -	895
Coal	2 -	897
Sand, dark	13 -	910
Slate and shells	85 -	995
Sand, white, Little Dunkard (Mahoning)	30 -	1025
Slate	65 -	1090
Coal, Upper Freeport	2 -	1092
Slate and shells	53 -	1145
Sand, white, Big Dunkard (2nd Cow Run)	15 -	1160
Slate and shells	30 -	1190
Coal, Upper Kittanning	3 -	1193
Slate and shells	72 -	1265
Sand, gray	40 -	1305
Slate and shells	35 -	1340
Sand, gray	20 -	1360
Coal (Clarion or Brookville)	2 -	1362
Slate	8 -	1370
Salt Sand (water at 1390')	180 -	1550
Slate and shells	20 -	1570
Red rock	105 -	1675
Slate and shells	40 -	1715
Limestone	45 -	1760
Unrecorded	80 -	1840
Big Injun Sand (water & Oil at 1888')	125 -	1965
Slate	5 -	1970
Sand, gray	20 -	1990
Slate	55 -	2045
Sand, gray	35 -	2080
Slate	70 -	2150
Sand	100 -	2250
Slate and shells	30 -	2280
Sand, dark	12 -	2292
Slate and shells	88 -	2380
Sand, white	30 -	2410
Slate and shells	15 -	2425
Sand, white, (Gantz)	27 -	2452
Slate and shells	(14) (RWS) 16 -	2468
Sand, gray	14 -	2482
Slate) 50-Ft. Sand	5 -	2487
Sand, white)	23 -	2510

(OVER)

MON-127-A

A. W. BROWN HEIRS NO. WELL (Continued).

	Thickness.	Depth.
Red rock	5	- 2515
Slate and shells	7	- 2522
Sand, gray	15	- 2537
Slate and shells	20	- 2557
Sand, white	5	- 2562
Red rock	5	- 2567
Sand, brown	11	- 2578
Red rock	47	- 2625
Sand, red	12	- 2637
Slate and shells	103	- 2740
Sand, gray (Fourth or Flat Run)	13	- 2753
Slate and shells	42	- 2795
Sand, Fifth, McDonald (strong gas at 2816')	35	- 2830
Total depth		2830

Clay District, Monongalia County, W. Va.
 South Penn Oil Co., Chamber of Commerce Bldg., Pittsburgh, Pa.
 On 275 acres, surface and mineral rights owned by Oliver Lemley,
 Pentress, W. Va.

Elevation, 952.69' L.

10" casing, 551' 6" (pulled); 8 $\frac{1}{2}$ ", 1414' 4"; 6-5/8", 1601';
 5-3/16", 1941' 11".

Coal was encountered at 440-446 and 520-528'.

504' 1" of 4" liner used.

Abandonment reported to Dept. of Mines July 23, 1935.

Salt water at 1390 and 1888'.

Oil well.

	Top.	Bottom.
Mapletown Coal	440	446
Pittsburgh Coal	520	528
Slate and shells	528	665
Sand, gray	665	785
Red and blue core	785	850
Slate and shells	850	895
Coal (?)	895	897
Sand, dark	897	910
Slate and shells	910	995
Little Dunkard Sand	995	1025
Slate	1025	1090
Coal (?)	1090	1092
Slate and shells	1092	1145
Big Dunkard Sand	1145	1160
Slate and shells	1160	1190
Coal (?)	1190	1193
Slate and shells	1193	1265
Sand, gray	1265	1305
Slate and shells	1305	1340
Sand, gray	1340	1360
Coal (?)	1360	1362
Slate	1362	1370
Salt Sand (water at 1390')	1370	1550
Slate and shells	1550	1570
Red rock	1570	1675
Slate and shells	1675	1715
Lime	1715	1760
Big Lime Sand (water and oil, 1888')	1840	1965
Slate	1965	1970
Sand, gray	1970	1990
Slate	1990	2045
Sand, gray	2045	2080
Slate	2080	2150
Sand	2150	2250
Slate and shells	2250	2280
Sand, dark	2280	2292
Slate and shells	2292	2380
Sand, white (50-Ft.?)	2380	2410
Slate and shells	2410	2425
Sand, white	2425	2452
Slate and shells	2452	2468
Sand, gray	2468	2482
Slate	2482	2487
Sand, white	2487	2510

(OVER)

MON-127-A

BROWN HEIRS NO. 1 WELL (Continued).

	Top.	Bottom.
Red rock	2510	- 2515
Slate and shells	2515	- 2522
Sand, gray	2522	- 2537
Slate and shells	2537	- 2557
Sand, white	2557	- 2562
Red rock	2562	- 2567
Sand, brown	2567	- 2578
Red rock	2578	- 2625
Sand, red	2625	- 2637
Red rock	2637	- 2690
Slate and shells	2690	- 2740
Sand, gray	2740	- 2753
Slate and shells	2753	- 2795
Sand (gas, 2816')	2795	- 2830
Total depth		2830
DRILLED DEEPER:		2948½
First pay	2933	
Total depth		2948½

Clay District, Monongalia County, W. Va.

By J. H. McDermott Oil Co.; succeeded by Consolidation Oil & Gas Co.

On east side of Duckard Creek, 0.4 mi. N. of Worley.

Completed, June 26, 1930.

Elevation, 939' L.

Conductor, 16"; 1 1/2" casing, 19"; 10", 525'; 8 1/2", gauge 1210';

6-5/8", 1730' (left in); 5-3/16", 1955' (left in), on hook
wall packer.

4-331. oil well.

	Top.	Bottom.
Sand and gravel	0	25
Sand, Huff (Waynesburg)	80	160
Coal, Mapletown (Sawickley)	410	415
Coal, Pittsburgh	500	515
Sand	840	900
Sand, Big Duckard	1025	1075
Gas Sand	1200	1270
Sand, First Salt	1300	1380
Sand, Second Salt	1390	1520
Little Lime	1680	1690
Pencil Cave	1690	1700
Big Lime	1700	1750
Sand, Big Injun (oil show, 1875')	1750	1965
Sand, Squaw	2030	2065
Sand, Fifty-foot	2360	2500
Sand, Thirty-foot	2510	2540
Sand, Gordon Stray	2650	2670
Sandy shells	2700	2730
Sand, Bayard (oil, 2915-2918')	2912	2925
Total depth		2930

Oil

WELL RECORD

61-30127

The J. H. McDermott Oil

COMPANY

Record of Well No. 1 on Oliver Lemley Farm 60 Acres
Mooreville Field Clay District Monongalia County W. Va. State
 Rig Commenced 19 Completed 19
 Drilling Commenced April 7th. Completed June 26th.
 Cost Per Foot 19 Contractor H. B. Hall, and E. A. Cross. Address 1920
 Drillers Names H. B. Hall, and E. A. Cross.

CONDUCTOR AND CASING USED IN DRILLING

Conductor 13 inch 10 inch 8 1-4 inch 6 5-8 inch 5 3-16 inch 4 inch 3 inch 2 inch
16 19ft. 525 1210 1730 1955

CONDUCTOR AND CASING LEFT IN WELL

Conductor 13 inch 10 inch 8 3-4 inch 6 5-8 inch 5 3-16 inch 4 inch 3 inch 2 inch
1730 1955 On Hook Wall Parker,

Formation	Top	Bottom	Thickness	Formation	Top	Bottom	Thickness
GRAVEL OR QUICK SAND	25ft.	25ft.		FORMATION SQUAW	2130	<u>2165</u> 2065	35
FIRST WATER				BEREA			
BLUFF SAND	80	160	80	GANTZ			
NATIVE COAL				FIFTY FOOT	2360	2500	140
WBG. COAL				THIRTY FOOT	2510	2540	30
MAPEL COAL	410	415	5	GORDON STRAY	2650	2670	20
PGH. COAL	500	515	15	GORDON SANDY shells	2700	2730	30
MURPHY SAND				FOURTH			
LITTLE DKRD.	840	900	60	FIFTH			
BIG DKRD.	1025	1075	50	BAYARD	2912	2925	13
GAS SAND	1200	1250	50	Oil	2915	2918	
FIRST SALT SAND	1300	1380	80	ELIZABETH			
SECOND SALT SAND	1390	1520					
LITTLE LIME	1660	1690	30	TOTAL DEPTH	2930		
PENCIL CAVE	1690	1700	10				
BIG LIME	1700	1750	50				
BIG INJUN	1750	1965					
Show oil	1875						

Gas Test Open
 Minute Test
 Oil Production 4 bbls.

Well Tubed with Tubing Packer Set in Ft. working bbl. Sand, Top of Packer, Perforation at, Air Hole
 Well Tubed with Tubing

SHOT RECORD

Date	Amount	Size of Shell	Top	Bottom	Oil on Shot	Results
June 30/20	10 qts.	3 1/2 x 5'	2913	2918	150ft.	2 to 4bbls.

REMARKS: 489ft. 4 1/2" liner in hole, 246ft. in bottom section, 243ft. top section, steel shoes on bottom, 7" long, 6" C. D., 1" D. female ball top, 7" long 6" C. D., 4 1/2" I. D. Bottom top section, male shoe, 8 1/2" long, 6" C. D., 4 1/2" I. D. Top Ball 7" long, 6" C. D., 4 1/2" I. D. 12fts Bottom section, 11fts top section. Hole reduced 2901 top of liner 2410.

WEST VIRGINIA DEPARTMENT OF MINES

OIL AND GAS DIVISION

PRELIMINARY DATA SHEET NO. 1

File No. _____ Well No. 1

SOUTH WERN OIL Company of Chamber of Commerce Bldg.
Pittsburgh, Pa. on the Brown Heirs Farm
 containing 222 acres. Location _____

Clay District, in Monongalia County, West Virginia

The surface of the above tract is owned in fee by Oliver Lanley
 of Pantress, W. Va. address, and the mineral rights are owned by
Oliver Lanley of Pantress, W. Va.

The oil and gas privileges are held under lease by the above named company, and this well is drilled under permit
 No. _____ issued by the West Virginia Department of Mines, Oil and Gas Division

Elevation of surface at top of well. 552.00' Depth
Barometric.

The number of feet of the different sized casings used in the well.

	feet	also, depth	also, Wood casing.
<u>1001' 2"</u> ^{Full}	feet <u>10"</u>	also, depth <u>1941' 11"</u>	feet <u>8-8/16"</u> steel cas.
<u>1436' 4"</u>	feet <u>8-1/4"</u>	also, depth _____	feet _____ steel cas.
<u>1801</u>	feet <u>8-8/8"</u>	also, depth _____	feet _____ steel cas.

_____ packer of _____ also, set at _____

_____ packer of _____ also, set at _____

_____ in casing perforated at _____ feet to _____ feet.

_____ in casing perforated at _____ feet to _____ feet.

Coal was encountered at 440 feet, thick near 72 inches, and at 550

feet; thickness 24 inches; and at _____ feet; thickness _____ inches.

Liners were used as follows: (Give details) _____

504' 2" 4" Liner

July 28, 1928.

Date.

Approved [Signature] **SOUTH WERN OIL COMPANY**, Operator.

SOUTH FURN OIL

Company
Chamber of Commerce Bldg.
Pittsburgh, Pa. Address

COMPLETION DATA SHEET

NO. 2

Well No. 1

Pore Brown Hoira.

FORMATION RECORD

Name	Color	Character	Oil, Gas or Water	Top	Bottom	Thickness	Total Depth	Remarks
Hopletown Coal				660	666			
Pittsburgh Coal				680	688			
Slate & Shells				688	695			
Sand, - gray				695	705			
Red & Blue Goss				705	800			
Slate & Shells				800	805			
Coal (?)				805	807			
Sand, - dark				807	810			
Slate & Shells				810	895			
L. Dunbar Sand				895	1005			
Slate				1005	1090			
Coal (?)				1090	1095			
Slate & Shells				1095	1145			
Big Dunbar Sand				1145	1160			
Slate & Shells				1160	1190			
Coal (?)				1190	1195			
Slate, - shells				1195	1205			
Sand, - gray				1205	1208			
Slate, - shells				1208	1240			
Sand, - gray				1240	1260			
Coal (?)				1260	1265			
Slate				1265	1270			
Salt Sand			**	1270	1280			** Water 1280
Slate - Shells				1280	1270			
Red Rock				1270	1275			
Slate - Shells				1275	1275			
Lime				1275	1280			
Big Injan				1280	1285			
		Water & Oil		1285				
Slate				1285	1270			
Sand - Gray				1270	1290			
Slate				1290	2045			
Sand - gray				2045	2020			
Slate				2020	2150			
Sand				2150	2200			
Slate - shells				2200	2200			
Sand - dark				2200	2200			
Slate - shells				2200	2200			
Sand - white (80 lb.?)				2200	2410			
Slate & shells				2410	2425			
Sand - white				2425	2425			
Slate - shells				2425	2425			
Sand - gray				2425	2425			

Cont'd.

shot
Well was not shot at _____ feet; well was shot at _____ feet.

Salt
Fresh water at _____ feet; fresh water at _____ feet.

producing
Well was _____ both _____
dry

Date _____ Approved _____ Operator _____

Notes: Formation names must be noted as indicated above and all log-calls and oil and gas finds must be recorded under the geological name in the district as well as any local names commonly used in the district for each stratum.

SOUTH FISH OIL

Company

NO. OF GAS WELLS OIL

COMPLETION DATA SHEET

NO. 2

Address

FORMATION RECORD

Well No. 1

Name SOUTH FISH

Zone	Color	Character	Oil Base or Water	Top	Bottom	Thickness	Total Depth	Remarks
SOUTH FISH								
Slate				2420	2427			
Sand - white				2427	2432			
Red Rock				2432	2435			
Slate - shells				2435	2438			
Sand - gray				2438	2447			
Slate - shells				2447	2452			
Sand - white				2452	2457			
Red Rock				2457	2470			
Sand - brown				2470	2485			
Red Rock				2485	2497			
Sand - red				2497	2500			
Red rock				2500	2505			
Slate - shells				2505	2510			
Sand - gray				2510	2515			
Slate & shells				2515	2520			
Sand			Gas	2520	2525			
Total Depth							2525	
Drilled deeper			Let Run	2525		2415' 4"		
Total Depth							2525'	4"

When Well was set shut at _____ Date well was shut at _____

Depth Fresh water at 1270' _____ Date Fresh water at 1270' _____

producing
Well was _____

July 25, 1926.

Approved By *[Signature]*
SOUTH FISH OIL COMPANY

