

LATITUDE 39°42'30"

090W

150

80°21'30"

LONGITUDE

75'

*[Faint, illegible text, likely bleed-through from the reverse side of the page]*

### 7.5 OGIS topo location

7.5' loc	<u>0.515</u>	15' loc	<u>3.395</u>
	<u>0.90W</u>	(calc.)	<u>3.12W</u>

Company \_\_\_\_\_

Farm \_\_\_\_\_

Quad Blacksuille (Blacksuille NW)

County Monongahela

District Clay

### WELL LOCATION MAP

File No. 061-122A  
061-30122

Plot of the Proposed ~~SECTION~~ of Well No. 2-222 of the  
**CARBONATE NATURAL GAS COMPANY** of Pittsburgh, Penn., on  
 the E. E. Sims Tract, consisting of 20 Acres,  
 Located in Step Dist. Roanoke County,  
 West Virginia, Roanoke S. E. Quadrangle.  
 Date 1922-1922 Date 1922 Elevation 1000 Feet. Lease No. 111

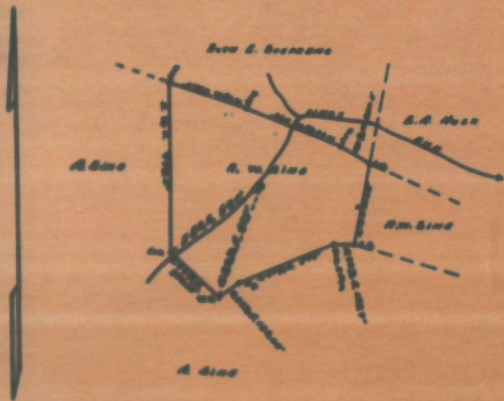

I, the undersigned, hereby certify that this map is correct and shows all the information to the best of my knowledge and belief, required by the oil and gas section of the Mining Laws of West Virginia.

State of West Virginia \_\_\_\_\_  
 County of Roanoke \_\_\_\_\_ } S.S.

Engineer.

Clay District, Monongalia County, W. Va.  
Carnegie Natural Gas Co., 962 Frick Bldg. Annex, Pittsburgh, Pa.  
On 50 acres, surface and mineral rights owned by R. W. Sine,

Route 2, Fairview, W. Va.

Drilled before June, 1929.

Elevation, 1158' B.

10" casing, 620'; 8 $\frac{1}{4}$ " 788' 3"; 6-5/8", 2066'; 5-3/16", 3046';

Hook wall packer, 6-5/8 x 5-3/16, set at 3046'.

Coal was encountered at 445-448, 720-726, and 815-821'.

Abandonment reported to Dept. of Mines June 19, 1935.

Well was shot at 3090-3095'.

Fresh water at 1475'; salt water at 1687'.

	Top.	Bottom.
Fairview Coal (Waynesburg)	445	- 448
Mapletown Coal	720	- 726
Pittsburgh Coal	815	- 821
Little Dunkard Sand	1165	- 1185
Big Dunkard Sand	1315	- 1355
2nd Big Dunkard Sand (water, 1475')	1470	- 1495
Gas Sand	1550	- 1595
1st Salt Sand	1613	- 1653
2nd Salt Sand (water, 1687')	1674	- 1826
Little Lime	2034	- 2042
Pencil Cave	2042	- 2048
Big Lime	2048	- 2095
Big Injun Sand (gas, 2118-2120'; gas, 2135')	2095	- 2325
Gantz Sand	2485	- 2530
50-Ft. Sand	2723	- 2845
30-Ft. Sand	2852	- 2905
Gordon Stray Sand	2965	- 2982
Gordon Sand	3028	- 3054
Fourth Sand (oil, 3090-3095')	3083	- 3131
Fifth Sand (gas, 3175')	3173	- 3187
Sand (gas, 3299')	3298	- 3301
Total depth		3315

05-122-A

122A

Clay District, Monongalia County, W. Va.

By Carnegie Natural Gas Co., 962 Frick Bldg. Annex, Pittsburgh, Pa.

On 50 acres, surface and mineral rights owned by R. W. Sine,  
Route 2, Fairview, W. Va.

Drilled before June, 1929.

Elevation, 1158' B.

10" casing, 620'; 8 $\frac{1}{4}$ " 788' 3"; 6-5/8", 2066'; 5-3/16", 3046'.

Hook wall packer, 6-5/8 x 5-3/16, set at 3046'.

Coal was encountered at 445-448, 720-726, and 815-821'.

Abandonment reported to Dept. of Mines June 19, 1935.

Well was not shot.

Fresh water at 1475'; salt water at 1687'.

Gas well.

	Top.	Bottom.	Thickness.
Fairview (Waynesburg) Coal	445	- 448	3
Mapletown (Sewickley) Coal	720	- 726	6
Pittsburgh Coal	815	- 821	6
Little Dunkard Sand	1165	- 1185	20
Big Dunkard Sand	1315	- 1355	40
2nd Big Dunkard Sand (water, 1475')	1470	- 1495	25
Gas Sand	1550	- 1595	45
1st Salt Sand	1613	- 1653	40
2nd Salt Sand (water, 1687')	1674	- 1826	152
Little Lime	2034	- 2042	8
Pencil Cave	2042	- 2048	6
Big Lime	2048	- 2095	47
Big Injun Sand (gas, 2118-2120' & 2135')	2095	- 2325	230
Gantz Sand	2485	- 2530	45
50-Ft. Sand	2723	- 2845	122
30-Ft. Sand	2852	- 2905	53
Gordon Stray Sand	2965	- 2982	17
Gordon Sand	3028	- 3054	26
Fourth Sand (oil, 3090-3095')	3083	- 3131	48
Fifth Sand (gas, 3175')	3173	- 3187	14
Sand (gas, 3299')	3298	- 3301	3
Total depth			3315

## WEST VIRGINIA DEPARTMENT OF MINES

## Oil and Gas Section

## PRELIMINARY DATA SHEET NO. 1

Issue (20-2211-22)

File No. \_\_\_\_\_ Well No. 100

CARNegie NATURAL GAS Company of 500 WEST WILKES AVENUE

PITTSBURGH, Pa. on date E. W. 2122 Perm

containing 25 acres Location

BLAIR District in WASHINGTON County West Virginia

The surface of the above tract is owned in fee by E. W. 2122

of No. 24, JEFFERSON, W. Va. address, and the mineral rights are owned by

E. W. 2122 of No. 24, JEFFERSON, W. Va.

The oil and gas privileges are held under lease by the above named company, and this well is drilled under permit No. \_\_\_\_\_ issued by the West Virginia Department of Mines, Oil and Gas Section,

ENTRANCE NUMBER 1000, 1000, \_\_\_\_\_

Elevation of surface at top of well, \_\_\_\_\_ 2122 Station

This number of feet of the different sized casings used in the well.

\_\_\_\_\_ feet \_\_\_\_\_ also Wood casing

200 feet 1 1/2" also, top 2048 feet 2-3/8" also top

700 feet 3/4" also, top \_\_\_\_\_ feet \_\_\_\_\_ also top

2000 feet 2-3/8" also, top \_\_\_\_\_ feet \_\_\_\_\_ also top

Block Wall \_\_\_\_\_ packer of 2-3/8" &amp; 2-3/8" also, set at 2048

\_\_\_\_\_ packer of \_\_\_\_\_ also, set at \_\_\_\_\_

\_\_\_\_\_ in casing perforated at \_\_\_\_\_ feet to \_\_\_\_\_ feet

\_\_\_\_\_ in casing perforated at \_\_\_\_\_ feet to \_\_\_\_\_ feet

Steel was encountered at 500 feet, thickness 25 inches, and at 700

feet, thickness 25 inches, and at 800 feet, thickness 25 inches

Edwards were used as follows: (Give details) \_\_\_\_\_

\_\_\_\_\_

\_\_\_\_\_

\_\_\_\_\_

Date June 20, 1922

Approved \_\_\_\_\_

CARNegie NATURAL GAS COMPANY \_\_\_\_\_

By \_\_\_\_\_

CARBIDE NATURAL GAS Company  
 902 Frick Building Annex, Address  
 PITTSBURGH, Pa.

COMPLETION DATA SHEET  
 NO. 2  
 FORMATION RECORD

Lease 44661 - Well No. 202

Name	Color	Character	Oil, Gas or Water	Top	Bottom	Thickness	Total Depth	Remarks
Fairview Coal				648	648	0		
Mapleton "				780	780	0		620' - 10'
Pittsburgh "				818	821	0		770' 0 1/2'
Little Dunkard				1108	1108	00		
Big "				2818	2820	02		
End "			Water 1475.	1470	1480	10		
Gas Sand				1680	1680	00		
1st Salt Sand				1618	1620	02		
End " "			Water 1687.	1674	1684	10		
Little Lane				2084	2085	01		
Pennell Cove				2048	2048	00		
Big Lane				2040	2040	00		
Big Injan			Gas 2110- 2120. Gas - 2120.	2088	2088	00		2040' - 0 1/2'
Gas				2420	2420	00		
Fifty Foot				2720	2720	00		
Thirty Foot				2820	2820	00		
Gordon Strag				3020	3020	00		
Gordon				3020	3020	00		200' 0 1/2'
Fourth			Oil 3020 - 3030.	3020	3020	00		
Fifth			Gas - 3170.	3170	3170	00		
Sand			Gas - 3200.	3200	3200	00		

6-17-31

Well was drilled at \_\_\_\_\_ 2020 - 2020 \_\_\_\_\_ feet, well was drilled at \_\_\_\_\_ feet

First water at \_\_\_\_\_ 1470 feet, salt water at \_\_\_\_\_ 1480 feet

Well was producing \_\_\_\_\_ bbls. per day

June 18, 1931 \_\_\_\_\_ Approved CARBIDE NATURAL GAS COMPANY

