

LATITUDE 39°42'30"

0.15W

ES/0

75'

15' 00"

LONGITUDE

7'5 OGIS topo location

| | | | |
|----------|--------------|---------|--------------|
| 7.5' loc | <u>0.435</u> | 15' loc | <u>3.315</u> |
| | <u>0.15W</u> | (calc.) | <u>0.15W</u> |

Company _____

Farm _____

Quad Wadestown (Mannington NE)

County Monongahela

District Clay

WELL LOCATION MAP

File No. 061-118A

WELLS NO 387, 389, 390 & 391
 HOPE CONSTRUCTION & REFINING CO.
 PHILIP SHUMAN
 CLAY District MONONGALIA County W. Va.

of the
 Clarkburg, W. Va. on the
 Farm consisting of 87 Acres
 County W. Va.

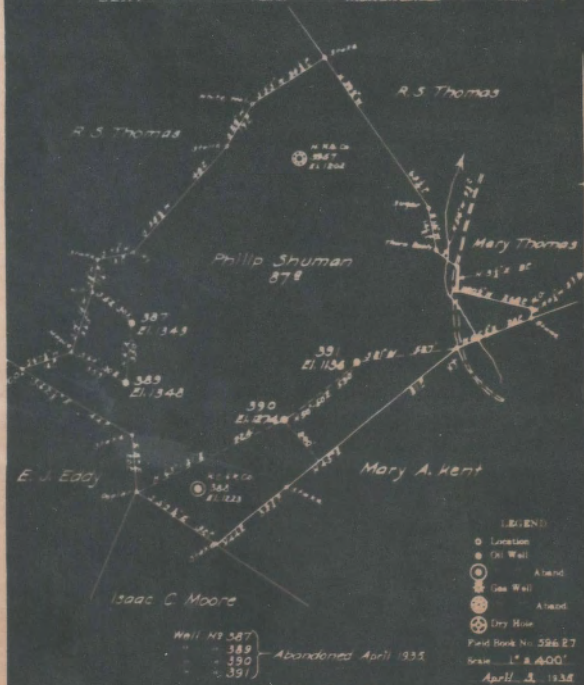

ENGINEERS CERTIFICATE

I, the undersigned, hereby certify that this map is correct and shows all the information to the best of my knowledge and belief, required by the oil and gas section of the mining laws of West Virginia.

Clay District, Monongalia County, W. Va.

By Hope Cons. & Ref. Co., 445 W. Main St., Clarksburg, W. Va.

On 87 acres, surface owned by Wm. Shuman, Blacksville, W. Va.

Elevation, 1348' L.

8 1/4" casing, 1562'; 6-5/8", 2290'; 2" tubing, 2410'.

Coal, was encountered at 494-496, 610-?, 675-679, and 930-935, and 1023-1032'.

Abandonment reported to Dept. of Mines May 17, 1935.

Well was shot at 2390-2395'.

Fresh water at 930 and 1024'; salt water at 1912-1917 and 1982'.

Oil well; now exhausted to extent that it is no longer commercially productive.

MON-118-A

| | Top. | Bottom. | Thickness. |
|---|------|---------|------------|
| Native coal | 494 | - 496 | 2 |
| Coal | 610 | - ...? | |
| Coal | 675 | - 679 | 4 |
| Mapletown (Sewickley) Coal (water, 930') | 930 | - 935 | 5 |
| Pittsburgh Coal (water, 1024') | 1023 | - 1032 | 9 |
| Little Dunkard Sand | 1352 | - 1379 | 27 |
| Big Dunkard Sand | 1504 | - 1616 | 112 |
| Gas Sand | 1650 | - 1705 | 55 |
| First Salt Sand | 1785 | - 1865 | 80 |
| Second Salt Sand (water, 1912-1917 and 1982') | 1890 | - 2052 | 162 |
| Maxton Sand | 2190 | - 2200 | 10 |
| Little Lime | 2224 | - 2234 | 10 |
| Pencil Cave | 2234 | - 2261 | 27 |
| Big Lime | 2261 | - 2322 | 61 |
| Big Injan Sand (oil, 2392') | 2322 | | |
| Total depth | | | 2410 |

Farm _____

WELL LOCATION MAP

File No. 061-118A

Quad Wadestown (Mannington NE)

County Monongahela

District Clay

WEST VIRGINIA DEPARTMENT OF MINES

OIL AND GAS DIVISION

PRELIMINARY DATA SHEET NO. 1

File No. _____ Well No. 209

High Construction & Refining Service Company of 408 East Main St.

Clarksburg, W. Va. on the Phillip Shuman Farm

containing 87 acres. Location

Clay Township, Minnehaha County, West Virginia

The surface of the above tract is owned in fee by Mr. Shuman

of Martinsburg, W. Va. address, and the mineral rights are owned by

_____ of _____

The oil and gas privileges are held under lease by the above named company, and this well is drilled under permit

No. _____ issued by the West Virginia Department of Mines, Oil and Gas Division

Elevation of surface at top of well 1240 Feet
Above _____

The number of feet of the different sized casings used in the well.

_____ feet _____ dia. Wood casing.

1240 feet 8 1/2" dia. exp. 2000 feet 6-5/8" steel exp.

2420 feet 8" dia. exp. _____ feet _____ steel exp.

_____ feet _____ dia. exp. _____ feet _____ steel exp.

_____ galcher of _____ dia. oil at _____

_____ galcher of _____ dia. oil at _____

_____ in casing perforated at _____ feet to _____ feet

_____ in casing perforated at _____ feet to _____ feet

Cool was encountered at 400-500-550-600 feet, thickness 2-3 inches, and at 1000

feet thickness 100" inches and at _____ feet thickness _____ inches.

_____ items were used as follows: (Give details)

May 17, 1929

Date

Approved: High Construction & Refining Service Co. _____

5-15-31

| Zone | Color | Thickness | SP. Grav. or Water | Por. | Perme. | Yield Point (psi) | Remarks |
|---------------------|-------|-----------|--------------------|------|--------|-------------------|------------|
| Shaly Sand | | | | 40% | 40% | 2' | |
| Sand | | | | 40% | 7 | | |
| Sand | | | | 40% | 40% | 4' | |
| Shaly Sand | | | | 40% | 40% | 2' | |
| Pittsburgh Sand | | | | 100% | 100% | 2' | |
| Little Richard Sand | | | | 100% | 100% | 20' | |
| Big Richard Sand | | | | 100% | 100% | 100' | 100' - 20' |
| Sea Sand | | | | 100% | 170% | 20' | |
| First Salt Sand | | | | 170% | 100% | 20' | |
| Second Salt Sand | | | | 100% | 200% | 100' | |
| Mass Sand | | | | 200% | 200% | 20' | |
| Little Line | | | | 200% | 200% | 20' | |
| Small Gray | | | | 200% | 200% | 20' | |
| Big Line | | | | 200% | 200% | 20' | 100' - 20' |
| Big Inlet Sand | | | | 200% | | 200' | 100' - 20' |

Well was first shut at _____ Date well was shut at 2000-2000 _____

Well was producing until _____ Date well was shut at 1952-1957 - 1958 _____

Well was producing until _____ Date well was shut at _____

Approved: Steen Construction & Drilling Company
 Date: May 17, 1958

118

**AFFIDAVIT IN TRIPLICATE TO TIME AND MANNER OF
PLUGGING AND FILLING WELL.**
Approved by Governor S. B. COMPTON & Secretary of the State
WEST VIRGINIA DEPARTMENT OF MINES
OIL AND GAS DIVISION

| | |
|---|---|
| Is well operations in this vicinity, | Deep Construction & Refining Co., Inc. |
| <small>has increased or decreased</small> | <small>name of well operator</small> |
| Coal County, | Clarksburg, W. Va., |
| <small>name of well operator</small> | <small>name of well operator</small> |
| Belmont, | July 28th, 1935 |
| <small>name of well operator</small> | <small>month and year</small> |
| <small>name</small> | Shay |
| <small>name of well operator</small> | <small>WELL AND LOCATION</small> |
| <small>name</small> | Monongalia |
| <small>name of well operator</small> | <small>County</small> |
| <small>name</small> | Well No. 200 |
| <small>name of well operator</small> | <small>WELL NO.</small> |
| <small>name</small> | Phillip Shuman |
| <small>name of well operator</small> | <small>Name</small> |

AFFIDAVIT

STATE OF WEST VIRGINIA,)
 County of Monongalia) ss.

John F. Shuman and Arthur B. Steel
 being first duly sworn according to law depose and say that they are experienced in the work of plugging and filling oil and gas wells and were employed by Deep Construction & Refining Co., Inc., well operator, and participated in the work of plugging and filling the above well, that said work was commenced on the 28th day of July 1935, at Clarksburg, W. Va., and that the well was plugged and filled in the following manner:

Manner in which well was plugged: Drilled 2" tubing, installed hole at 225' Filled with 2" to 2 1/2" heavy 2 1/2" steel pipe, and lead ball. Then put in cement plug, capable to hold 2 1/2" casing 225-230 and 2 1/2", and pulled and lowered 2 1/2" to hole, capable to allow 2" pipe at 225' cement of hole casing. Filled hole with clay from 225' to 230', heavy 2" steel pipe and put in cement plug, capable to hold 2" casing. Drilled case at 225'-230'-230'-230' and at 230'.

Manner by which well was plugged: Drilled 2 1/2" tubing, steel case 225' to 230' capable of 2" casing. Filled hole at 230' and filled with clay to 230'. Drilled casing steel from 230' to 230' filled with clay to 230' cemented casing steel from 230' to 230' Filled with clay to 230' cemented casing steel from 230' to 230' Filled hole to surface with clay.

The 2 1/2" pipe was pulled in course of dismantling the upper coal seam.

Description of cement: Started cement cement also 2" x 2" x 2 1/2" of which extends above the ground, with the following description:

[Deep Construction & Refining Co. Well No. 200]

and that the work of plugging and filling said well was completed on the 28th day of July 1935.

And further:

John F. Shuman
Arthur B. Steel