

LATITUDE 39°42'30"

7 1/2
0.265
0.89w



80°02'00"

LONGITUDE

7'5 OGIS topo location

7.5' loc	<u>0.265</u>	15' loc	<u>3.145</u>
	<u>0.89w</u>	(calc.)	<u>0.89w</u>

Located from OGS

Company Pittsburgh-WV Gas

Farm Jasper Shiner 5359

Quad Wadestown (Marion, W. Va.)

County Monongahela

District Battelle

WELL LOCATION MAP

File No. 061-101A

PITTSBURGH, B. PA. 15106 Name of PITTSBURGH, PA.
COUNTY JAYKE DISTRICT 26
TOWNSHIP MARSHALL SECTION 25
RANGE 14 MERIDIAN 14
DATE 1958

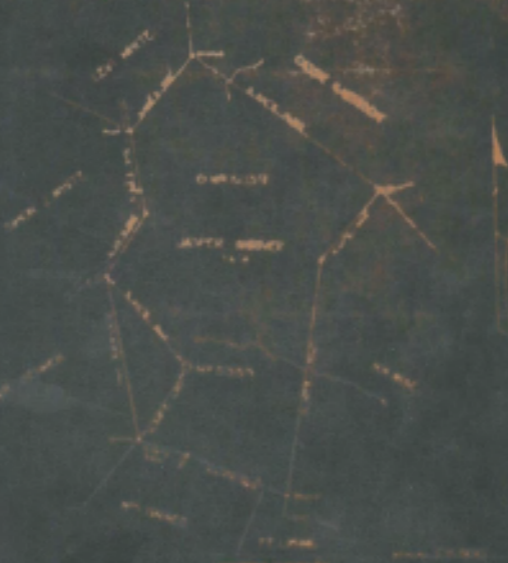

This map was prepared by the Surveyor General of the State of Pennsylvania, and is subject to the provisions of the laws of this State relating to the Surveyor General's office.

Surveyed and returned to the Surveyor General of the State of Pennsylvania, this 14th day of May, 1958.

James H. [Signature]
 Surveyor General

W. H. [Signature]
 Surveyor

149

Battelle District, Monongalia County, W. Va.

By Arthur Mackey, Marietta, Ohio.

On 74 acres, surface and mineral rights owned by Ernest Bell,
Wadestown, W. Va.

Elevation, 1302 V. A.

8 1/2" casing, 1458'; 6-5/8", 1960'; 5-3/16", 2275'.

Abandonment reported to Dept. of Mines Jan. 14, 1935.

578-A 7

	Top.	Bottom.	Thickness.
Pittsburgh Coal	1036	- 1044	8
Second Salt Sand (water, 1925-1935')	1915	- 1998	83
Big Injun Sand (gas, 2350')	2320	- 2505	185
Thirty-foot Sand (gas, 3044-3068')	3032	- 3087	55
Total depth		3492	

Farm Jasper Shriver 5359

Quad Wadestown (Marion, Va. NC)

County Monongahela

District Battelle

WELL LOCATION MAP

File No. 061-101A

WEST VIRGINIA DEPARTMENT OF MINES

CELESTIAL GAS DIVISION

PRELIMINARY DATA SHEET NO. 1

Dr. No. Arthur Mackel Company of Warrenton Ohio on the Asper Shiver Form
 containing 14 acres. Located Patton Marion County, West Virginia
 The surface of the above tract is owned by Barnes Bell
Madestown W. Va. address, and the mineral rights are owned by
Barnes Bell of Madestown W. Va.

The oil and gas privileges are held under lease by the above named company, and this well is drilled under grant
Not approved No. 1 issued by the West Virginia Department of Mines, Oil and Gas Division

Depth 210
 Elevation of surface on top of well, 1022 1/2 feet

The number of feet of the different sized casing in the well.

feet	in.	Wood casing
<u>1258</u>	<u>8"</u>	feet
<u>1960</u>	<u>6 3/8"</u>	feet
<u>2275</u>	<u>5 1/2"</u>	feet

_____ feet _____ in. _____
 _____ feet _____ in. _____
 _____ feet _____ in. _____
 _____ feet _____ in. _____

Cool was encountered at _____ feet, thickness _____ inches, and at _____
 feet, thickness _____ inches, and at _____ feet, thickness _____ inches.

Liners were used as follows: (Give details)

1-16-37

January 10 1937
 Date Arthur Mackel

Arthur J. [unclear] Company
 Maunten, Okla. address

COMPLETION DATA SHEET
 NO. 2
 FORMATION RECORD

Well No. _____

Name	Color	Character	Oil, Gas or Water	Top	Bottom	Thickness	Total Depth	Remarks
Quartzite				1136	1101	35 ft		1450 - 8 1/2
Coal				1015	1000	15		1465 - 6 7/8
Sandstone			under	1125	1155			
Red Sandstone				730	725	5		2275 - 5 1/2
Shale			gas	535				
Shale			gas	302	317	15 ft		
Shale			gas	319	308			
						Total Depth		
						3192 ft.		

see 14-31

Well was shut at _____ daily well was shut at _____ day
 First water at _____ daily first water at _____ day
 Well was _____ day

Arthur J. [unclear]

101

**AFFIDAVIT IN TRIPLICATE TO TIME AND MANNER OF
PLUGGING AND FILLING WELL**

(REVISED BY GEORGE S. ARTHUR & CHARLES AS OF THE CODE)

**WEST VIRGINIA DEPARTMENT OF MINES
OIL AND GAS DIVISION**

Name	Arthur Insley
OIL OPERATOR OR OWNER	NAME OF WELL OPERATOR
ADDRESS	Martins, Ohio
OIL OPERATOR OR OWNER	March 10, 1935
ADDRESS	WELL AND LOCATION
OIL OPERATOR OR OWNER	Martins District
ADDRESS	Harrison County
OIL OPERATOR OR OWNER	Well No. 1000
ADDRESS	Super Surface Farm

AFFIDAVIT TO BE MADE IN TRIPLICATE, ONE COPY TO BE KEPT BY OPERATOR, ONE BY THE DEPARTMENT, ONE COPY TO BE RETURNED BY THE FIELD OFFICER AND THE THIRD COPY SENT BY REGISTERED MAIL TO BE KEPT BY OIL AND GAS OPERATOR UNDER NAME OF WELL OPERATOR'S ADDRESS.

AFFIDAVIT

STATE OF WEST VIRGINIA,
County of Harrison) ss:

S. Johnson and
being first duly sworn according to law depose and say that they are experienced in the work of plugging
and filling oil and gas wells and were employed by Arthur Insley, well operator,
and participated in the work of plugging and filling the above well, that said work was commenced on the
10th day of March, 1935, and that the well was plugged and filled in
the following manner:

Water in which sand was plugged:

Sole filled from bottom, 2000, to 2020 with red clay, wood plug to 2020,
cement to 2011, casing three-foot sand.

Filled with red clay to 2020, wood plug to 2020, cement to 2020.

Filled with red clay to 2020.

Permanent bridge set at 2020, filled with red clay to 2020, wood plug to 2020.

Filled with clay to 2020, cement to 2020.

Permanent bridge set at 2020, filled with clay to 2020, wood plug to 2020,
cement to 2020.

Water in which sand was plugged:

Set permanent bridge at 2020, cement to 2010. Clay to 200, cement to 200,
Clay to 200, cement to 200. Clay to surface, and casing covered.

(Test pipe was not placed in hole, under instructions of Mr. Smith, of
the Department of Mines.)

Description of cement: According to Rule 16, 1931 regulations.

AND SAID DEPOSITORS SAY AS IS AFFIDAVIT IS SUBMITTED WITH THE PROVISIONS OF GEORGE S. ARTHUR & CHARLES AS OF THE CODE

and that the work of plugging and filling said well was completed on the 10th day of March,

1935.

And further deposes with us:

C. Johnson