

FILE #: NEE14
 DRAWING #: 2865
 SCALE: PLAT: 1" = 2000'
 TICK MARK: 1" = 2000'

MINIMUM DEGREE OF ACCURACY: 1/200

PROVEN SOURCE: SUBMETER MAPPING
 OF ELEVATION: GRADE GPS

I, THE UNDERSIGNED, HEREBY CERTIFY THAT THIS PLAT IS CORRECT TO THE BEST OF MY KNOWLEDGE AND BELIEF AND SHOWS ALL THE INFORMATION REQUIRED BY LAW AND THE REGULATIONS ISSUED AND PRESCRIBED BY THE DEPARTMENT OF ENVIRONMENTAL PROTECTION.

Signed: *[Signature]*

L.L.S. #2124 : Ernest J. Benchek III

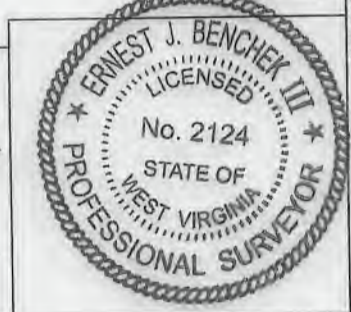

(+) DENOTES LOCATION OF WELL ON UNITED STATES TOPOGRAPHIC MAPS WYDEP
 OFFICE OF OIL & GAS
 601 57TH STREET
 CHARLESTON, WV 25304

Well Type: Oil Waste Diposal Production Deep
 Gas Liquid Injection Storage Shallow

WATERSHED: DUNKARD CREEK
 COUNTY/DISTRICT: MONONGALIA / CLAY
 SURFACE OWNER: BLAKE R. & PRESTON H. BOGCESS
 OIL & GAS ROYALTY OWNER: BLAKE R. & PRESTON H. BOGCESS 'et al'
 LEASE NUMBERS:

DRILL CONVERT DRILL DEEPER REDRILL FRACTURE OR STIMULATE
 PLUG OFF FORMATION PERFORATE NEW FORMATION PLUG & ABANDON
 CLEAN OUT & REPLUG OTHER CHANGE (SPECIFY):

TARGET FORMATION: MARCELLUS
 WELL OPERATOR: NORTHEAST NATURAL ENERGY LLC
 ADDRESS: 707 VIRGINIA STREET EAST, SUITE 1200
 CITY: CHARLESTON STATE: WV ZIP CODE: 25301

DATE: September 26, 2018
 OPERATOR'S WELL #: BOGCESS NO. 9H
 API WELL #: 47 61 47-061-01303
 STATE COUNTY PERMIT

PROPOSED ELEVATION: 1,265.4'
 QUADRANGLE: OSAGE, WV
 ACREAGE: 389.96 +/-
 ACREAGE: 1176.38 +/-

ESTIMATED DEPTH: TVD: 8,074' TMD: 20,081'
 DESIGNATED AGENT: JOHN ADAMS
 ADDRESS: 707 VIRGINIA STREET EAST, SUITE 1200
 CITY: CHARLESTON STATE: WV ZIP CODE: 25301

BOGGESS 9H EXISTING GAS WELLS September 26, 2018

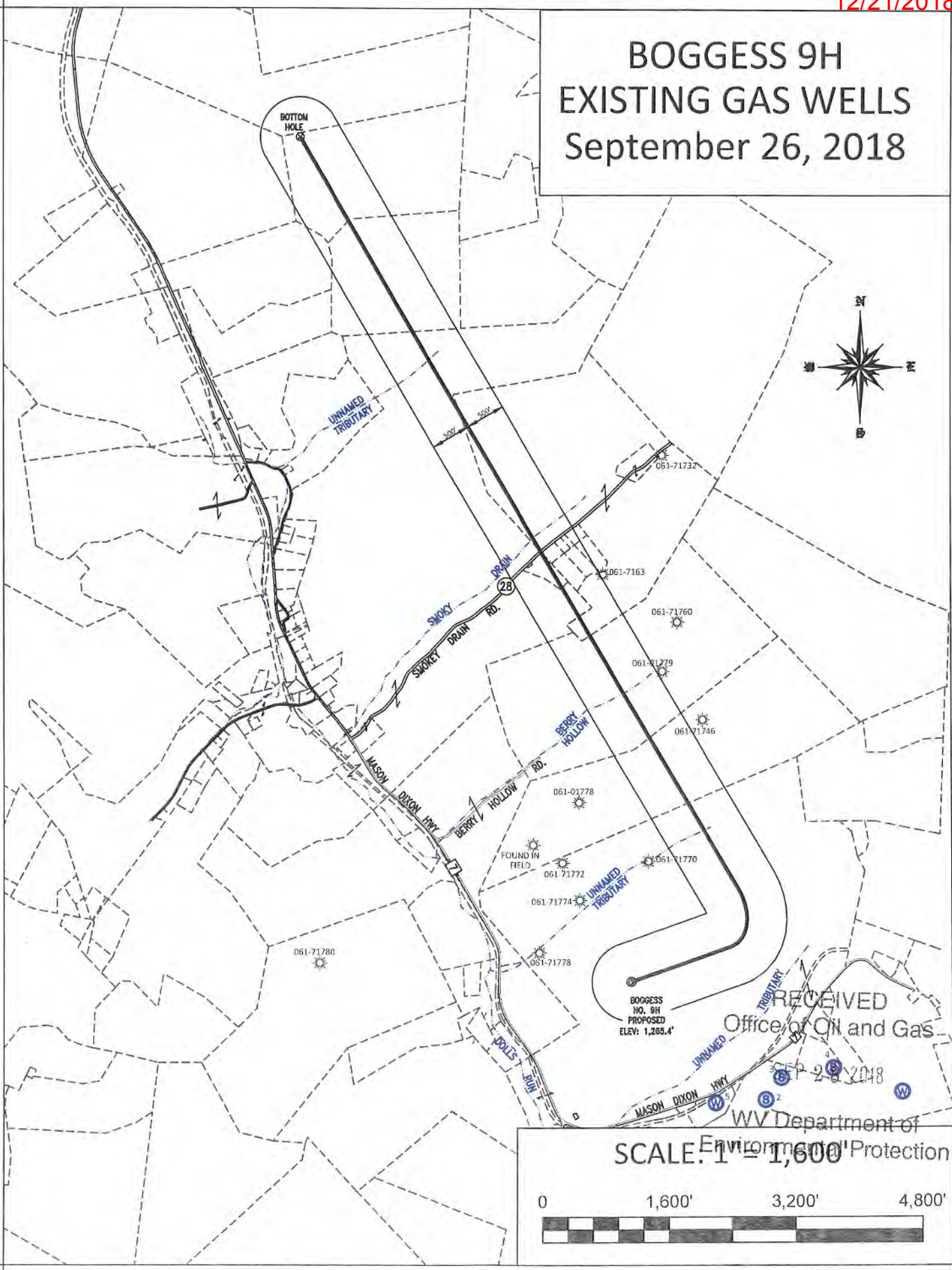

SCALE: 1" = 1,600'

