

12/21/2018

NOTE:
NO WATER WELLS WERE FOUND WITHIN 250' OF THE CENTER OF WELL PAD.
NO DWELLINGS WERE FOUND WITHIN 625' OF THE CENTER OF WELL PAD.

TOP HOLE (UTM NAD 83)
N) 4391546.9
E) 577773.3
BOTTOM HOLE (UTM NAD 83)
N) 4394248.8
E) 576133.4

REFERENCE NOTES
Boundaries on shown taken from deeds, tax maps and field locations. A full boundary survey is not represented here. In bearings are based on true north. Ownership taken from public records MONONGALIA County, West Virginia 2018
State Plane Coordinates & NAD 83 Lat/Long by differential submeter mapping grade GPS provided by EAM

FILE #: NEE14
DRAWING #: 2864
SCALE: PLAT: 1" = 2000'
TICK MARK: 1" = 2000'
MINIMUM DEGREE OF ACCURACY: 1/200
PROVEN SOURCE OF ELEVATION: SUBMETER MAPPING GRADE GPS

I, THE UNDERSIGNED, HEREBY CERTIFY THAT THIS PLAT IS CORRECT TO THE BEST OF MY KNOWLEDGE AND BELIEF AND SHOWS ALL THE INFORMATION REQUIRED BY LAW AND THE REGULATIONS ISSUED AND PRESCRIBED BY THE DEPARTMENT OF ENVIRONMENTAL PROTECTION.
Signed: *[Signature]*
L.L.S. #2124 Ernest J. Benchek III

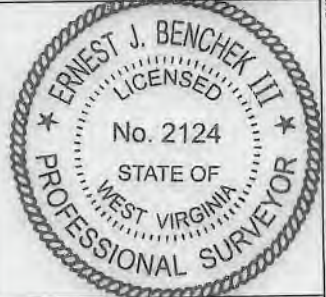

(+) DENOTES LOCATION OF WELL ON UNITED STATES TOPOGRAPHIC MAPS WYDEP
OFFICE OF OIL & GAS
601 57TH STREET
CHARLESTON, WV 25304
Well Type: Oil Waste Disposal Production Deep
 Gas Liquid Injection Storage Shallow
WATERSHED: DUNKARD CREEK
COUNTY/DISTRICT: MONONGALIA / CLAY
SURFACE OWNER: BLAKE R. & PRESTON H. BOGESS
OIL & GAS ROYALTY OWNER: BLAKE R. & PRESTON H. BOGESS 'et al'
LEASE NUMBERS:

DATE: September 26, 2018
OPERATOR'S WELL #: BOGESS NO. 5H
API WELL #: 47 61 47-061-01802
STATE COUNTY PERMIT
PROPOSED ELEVATION: 1,265.4'
QUADRANGLE: OSAGE, WV
ACREAGE: 389.96 +/-
ACREAGE: 1194.41 +/-

TARGET FORMATION: MARCELLUS
WELL OPERATOR: NORTHEAST NATURAL ENERGY LLC
ADDRESS: 707 VIRGINIA STREET EAST, SUITE 1200
CITY: CHARLESTON STATE: WV ZIP CODE: 25301
ESTIMATED DEPTH: TVD: 8,074' TMD: 20,466'
DESIGNATED AGENT: JOHN ADAMS
ADDRESS: 707 VIRGINIA STREET EAST, SUITE 1200
CITY: CHARLESTON STATE: WV ZIP CODE: 25301

BOGGESS 5H EXISTING GAS WELLS September 26, 2018

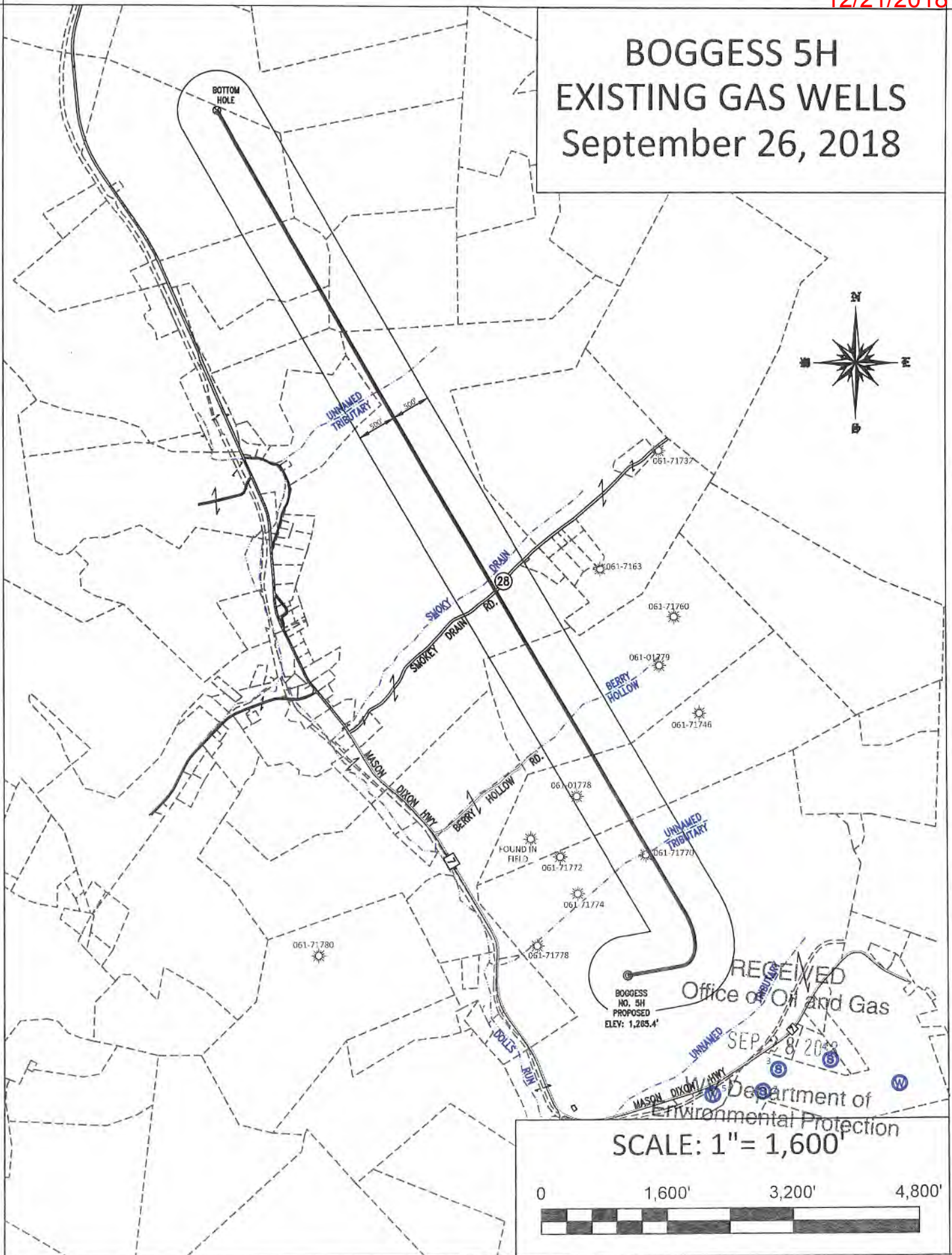

SCALE: 1" = 1,600'

