

SURFACE HOLE DEC. LONG: 80.213885
SURVEYED LONG: 80° 12' 50.0"

Latitude: 39° 42' 30" (NAD27)

Longitude: 80° 12' 30" (NAD27)

REFERENCES TO PROPOSED HORIZONTAL WELLS SURFACE LOCATIONS

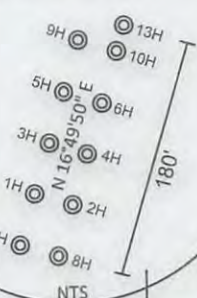

TOP HOLE (UTM NAD 83)
N) 4394325.7
E) 567416.2
BOTTOM HOLE (UTM NAD 83)
N) 4392636.5
E) 568522.7

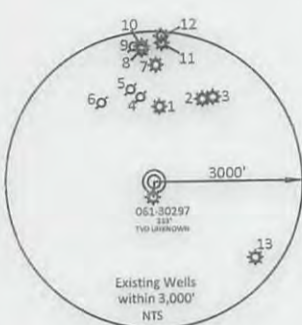

- WELL REFERENCE (API#, DISTANCE TO WELL)
- 061-30132
 - 061-70251
 - 061-30014
 - 061-71046
 - 061-30120
 - PLUGGED FOUND IN FIELD
 - 061-71042
 - 061-30130
 - PLUGGED FOUND IN FIELD
 - 061-71043
 - 061-01594
 - 061-01568
 - 061-71096

REFERENCE NOTES
Boundaries as shown taken from deeds, tax maps and field locations. A full boundary survey is not expressed nor implied. All bearings are based on true north. Ownership taken from public records MONONGALIA County, West Virginia MAY 2016
State Plane Coordinates & NAD 83 Lat/Long by differential submeter mapping grade GPS drafted by EAJL

NOTE:
NO WATER WELLS WERE FOUND WITHIN 250' OF THE CENTER OF WELL PAD.
NO DWELLINGS WERE FOUND WITHIN 625' OF THE CENTER OF WELL PAD.

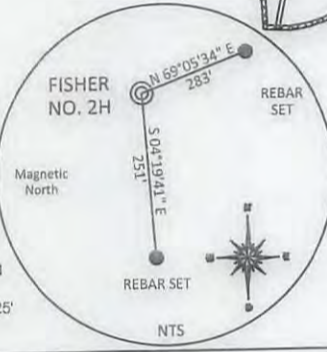

FILE #: NNE14
DRAWING #: 2384
SCALE: PLAT: 1" = 1400'
TICK: 1" = 2000'
MINIMUM DEGREE OF ACCURACY: 1/200
PROVEN SOURCE OF ELEVATION: SUBMETER MAPPING GRADE GPS

I, THE UNDERSIGNED, HEREBY CERTIFY THAT THIS PLAT IS CORRECT TO THE BEST OF MY KNOWLEDGE AND BELIEF AND SHOWS ALL THE INFORMATION REQUIRED BY LAW AND THE REGULATIONS ISSUED AND PRESCRIBED BY THE DEPARTMENT OF ENVIRONMENTAL PROTECTION.
Signed: [Signature]
L.L.S. #2124: Ernest J. Benchek III

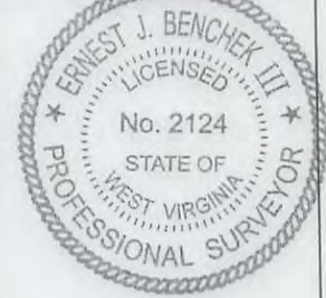

(+) DENOTES LOCATION OF WELL ON UNITED STATES TOPOGRAPHIC MAPS WYDEP
OFFICE OF OIL & GAS
601 57TH STREET
CHARLESTON, WV 25304

Well Type: Oil Waste Diposal Production Deep
 Gas Liquid Injection Storage Shallow

WATERSHED: DUNKARD CREEK
COUNTY/DISTRICT: MONONGALIA / CLAY
SURFACE OWNER: AARON K. FISHER
OIL & GAS ROYALTY OWNER: HENRY P. AMES, III, ET AL
LEASE NUMBERS: _____

DATE: MARCH 16, 2017
OPERATOR'S WELL #: FISHER NO. 2H
API WELL #: 47 61 01751 Mod
STATE COUNTY PERMIT

CURRENT ELEVATION: 1,453.04'
QUADRANGLE: BLACKSVILLE
ACREAGE: 52.203 +/-
ACREAGE: 562.9188 +/-

TARGET FORMATION: MARCELLUS
DRILL CONVERT DRILL DEEPER REDRILL FRACTURE OR STIMULATE
PLUG OFF FORMATION PERFORATE NEW FORMATION PLUG & ABANDON
CLEAN OUT & REPLUG OTHER CHANGE (SPECIFY): _____

ESTIMATED DEPTH: TVD: 8,276.50' TMD: 14,539.25'
DESIGNATED AGENT: JOHN ADAMS
ADDRESS: 707 VIRGINIA STREET EAST, SUITE 1200
CITY: CHARLESTON STATE: WV ZIP CODE: 25301

03/24/2017



WELL FISHER NO. 2H
QUAD: BLACKSVILLE, WV

03/24/2017

GRAPHIC SCALE
1578