

TOP HOLE (UTM NAD 83)  
 N) 4394328.2  
 E) 567407.4

BOTTOM HOLE (UTM NAD 83)  
 N) 4396133.5  
 E) 565506.6

REFERENCE NOTES  
 Boundaries as shown taken from deeds, tax maps and field locations. A full boundary survey is not expressed nor implied. All bearings are based on true north. Ownership taken from public records MONONGALIA County, West Virginia MAY 2014  
 State Plane Coordinates & NAD 83 Lat/Long by differential submeter mapping grade GPS  
 Drafted by: EAM

- WELL REFERENCE (API#, DISTANCE TO LATERAL)
- 061-30132
  - 061-70251
  - 061-30014
  - 061-71046
  - 061-30120
  - PLUGGED FOUND IN FIELD
  - 061-71042
  - 061-30130
  - PLUGGED FOUND IN FIELD
  - 061-71043
  - 061-01594
  - 061-01568

NOTE:  
 NO WATER WELLS WERE FOUND WITHIN 250' OF THE CENTER OF WELL PAD.  
 NO DWELLINGS WERE FOUND WITHIN 626' OF THE CENTER OF WELL PAD.

FILE #: NNE14

DRAWING #: 2377

SCALE: PLAT: 1" = 1400'  
TICK: 1" = 2000'

MINIMUM DEGREE OF ACCURACY: 1/200

PROVEN SOURCE OF ELEVATION: SUBMETER MAPPING GRADE GPS

I, THE UNDERSIGNED, HEREBY CERTIFY THAT THIS PLAT IS CORRECT TO THE BEST OF MY KNOWLEDGE AND BELIEF AND SHOWS ALL THE INFORMATION REQUIRED BY LAW AND THE REGULATIONS ISSUED AND PRESCRIBED BY THE DEPARTMENT OF ENVIRONMENTAL PROTECTION.

Signed: [Signature]

L.L.S. #2124 : Ernest J. Benchek III

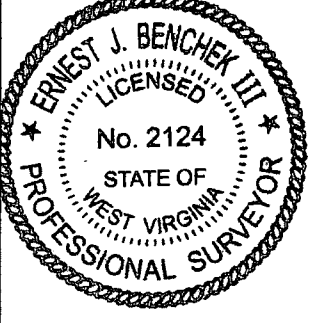

(+) DENOTES LOCATION OF WELL ON UNITED STATES TOPOGRAPHIC MAPS WVDEP

OFFICE OF OIL & GAS  
 601 57TH STREET  
 CHARLESTON, WV 25304

Well Type:  Oil  Waste Diposal  Production  Deep  
 Gas  Liquid Injection  Storage  Shallow

WATERSHED: DUNKARD CREEK

COUNTY/DISTRICT: MONONGALIA / CLAY

SURFACE OWNER: AARON K. FISHER

OIL & GAS ROYALTY OWNER: HENRY P. AMES, III, ET AL

LEASE NUMBERS: \_\_\_\_\_

DATE: OCTOBER 19, 2015

OPERATOR'S WELL #: FISHER NO. 1H

API WELL #: 47 61 01733  
 STATE COUNTY PERMIT

PROPOSED ELEVATION: 1,453.04'  
 CURRENT ELEVATION: 1,480'

QUADRANGLE: BLACKSVILLE

ACREAGE: 9.663 +/-

ACREAGE: 560.239 +/- **12/11/2015**

DRILL  CONVERT  DRILL DEEPER  REDRILL  FRACTURE OR STIMULATE   
 PLUG OFF FORMATION  PERFORATE NEW FORMATION  PLUG & ABANDON   
 CLEAN OUT & REPLUG  OTHER CHANGE  (SPECIFY): \_\_\_\_\_

TARGET FORMATION: MARCELLUS

ESTIMATED DEPTH: TVD: 8,276.5' TMD: 17,116.29'

WELL OPERATOR: NORTHEAST NATURAL ENERGY LLC

DESIGNATED AGENT: JOHN ADAMS

ADDRESS: 707 VIRGINIA STREET EAST, SUITE 1200

ADDRESS: 707 VIRGINIA STREET EAST, SUITE 1200

CITY: CHARLESTON STATE: WV ZIP CODE: 25301

CITY: CHARLESTON STATE: WV ZIP CODE: 25301

WELL: FISHER NO. 1H  
QUAD: BLACKSVILLE, WV

4706101733

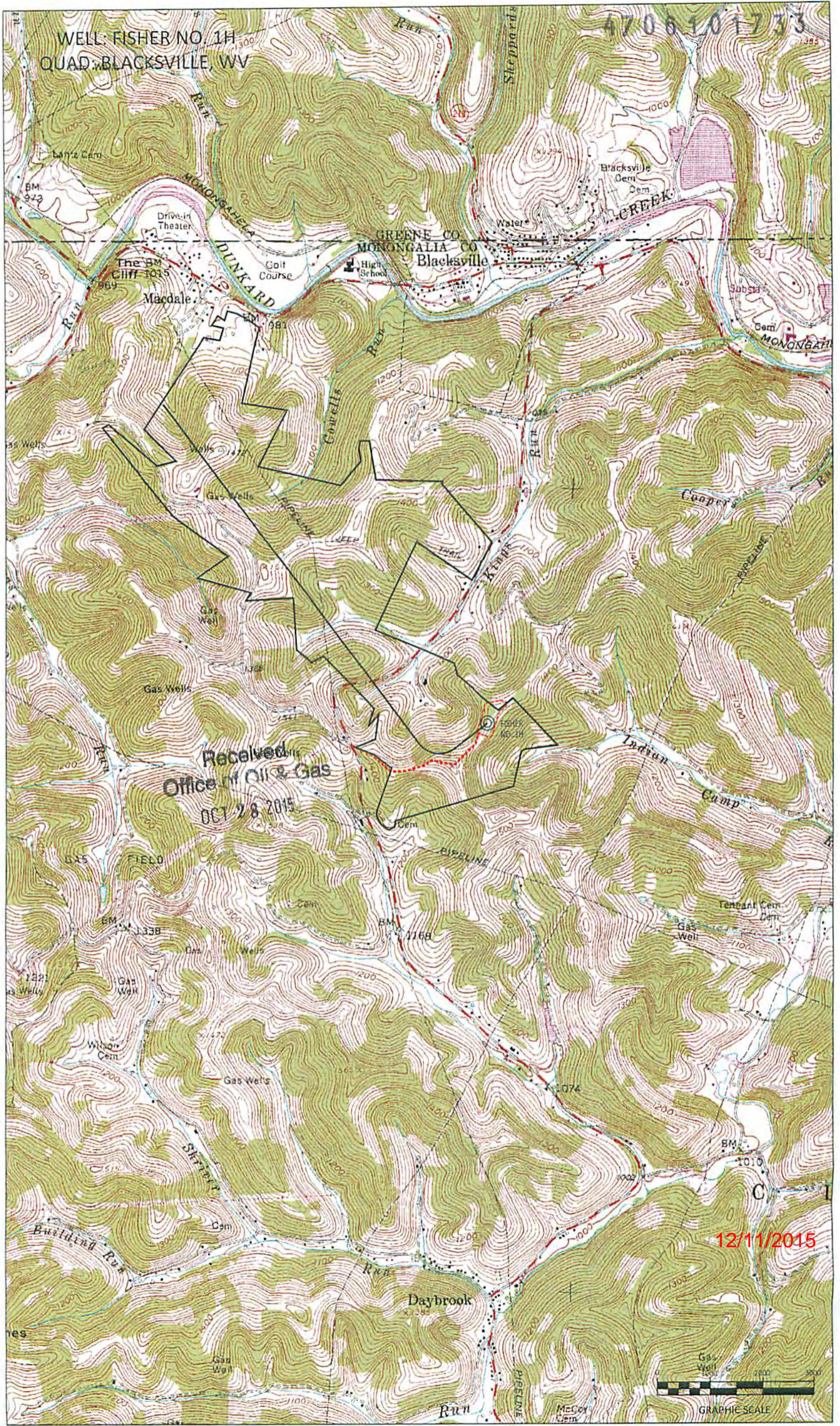

Received  
Office of Oil & Gas  
OCT 28 2015

12/11/2015



GRAPHIC SCALE