

TOP HOLE (UTM NAD 83)
N) 4395842.8
E) 573717.2
BOTTOM HOLE (UTM NAD 83)
N) 4393451.6
E) 574579.0

7,570' SOUTH OF LATITUDE
 BOTTOM HOLE 39°42'30"
 1,540' WEST OF LONGITUDE
 80°07'30"

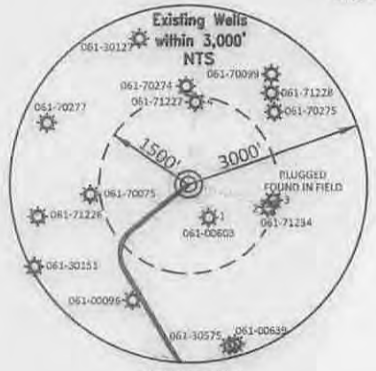

- WELL REFERENCE (API#, DISTANCE TO LATERAL)
- 061-00603 5 31°05'05" E 656'
 - 061-71234 5 73°36'58" E 1,388'
 - PLUGGED FOUND IN FIELD 5 78°57'36" E 1,450'
 - 061-71227 N 05°15'53" E 1,390'

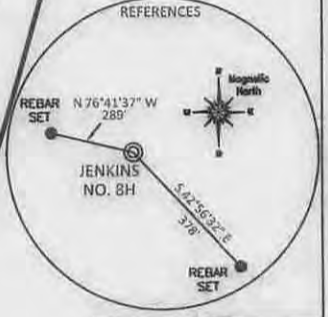

REFERENCE NOTES
 Boundaries as shown taken from deeds, tax maps and field locations. A full boundary survey is not expressed nor implied. All bearings are based on true north. Ownership taken from public records MONONGALIA County, West Virginia MAY 2014
 State Plane Coordinates & NAD 83 Lat/Long by differential submeter mapping grade GPS
 Drafted by: E.A.H.

FILE #: NNE16
 DRAWING #: 2530
 SCALE: PLAT: 1" = 1400'
TICK: 1" = 2000'
 MINIMUM DEGREE OF ACCURACY: 1/200
 PROVEN SOURCE OF ELEVATION: SUBMETER MAPPING GRADE GPS

I, THE UNDERSIGNED, HEREBY CERTIFY THAT THIS PLAT IS CORRECT TO THE BEST OF MY KNOWLEDGE AND BELIEF AND SHOWS ALL THE INFORMATION REQUIRED BY LAW AND THE REGULATIONS ISSUED AND PRESCRIBED BY THE DEPARTMENT OF ENVIRONMENTAL PROTECTION.
 Signed: [Signature]
 L.L.S. #2124: Ernest J. Benchek III



(+) DENOTES LOCATION OF WELL ON UNITED STATES TOPOGRAPHIC MAPS WVDEP
 OFFICE OF OIL & GAS
 601 57TH STREET
 CHARLESTON, WV 25304

Well Type: Oil Waste Diposal Production Deep
 Gas Liquid Injection Storage Shallow

WATERSHED: DUNKARD CREEK
 COUNTY/DISTRICT: MONONGALIA / CLAY
 SURFACE OWNER: LOIS A. JENKINS IRREVOCABLE TRUST
 OIL & GAS ROYALTY OWNER: LOIS A. JENKINS IRREVOCABLE TRUST
 LEASE NUMBERS: _____

DATE: MAY 19, 2015
 OPERATOR'S WELL #: JENKINS NO. 8H
 API WELL #: 47 61 01720 H6A
 STATE COUNTY PERMIT
 PROPOSED ELEVATION: 1,113.77'
 CURRENT ELEVATION: 1,128'
 QUADRANGLE: BLACKSVILLE
 ACREAGE: 96.84 +/-
 ACREAGE: 823.041 + 09/04/2015

DRILL CONVERT DRILL DEEPER REDRILL FRACTURE OR STIMULATE
 PLUG OFF FORMATION PERFORATE NEW FORMATION PLUG & ABANDON
 CLEAN OUT & REPLUG OTHER CHANGE (SPECIFY): _____

TARGET FORMATION: MARCELLUS
 ESTIMATED DEPTH: TVD: 7,935' TMD: 17,056'
 WELL OPERATOR: NORTHEAST NATURAL ENERGY LLC
 DESIGNATED AGENT: JOHN ADAMS
 ADDRESS: 707 VIRGINIA STREET EAST, SUITE 1200
 ADDRESS: 707 VIRGINIA STREET EAST, SUITE 1200
 CITY: CHARLESTON STATE: WV ZIP CODE: 25301

SURFACE HOLE DEC. LAT: 39.709186 SURVEYED LAT: 39° 42' 33.1"

WELL: JENKINS NO 8H
QUAD: BLACKSVILLE, WV

47 06 10 17 20

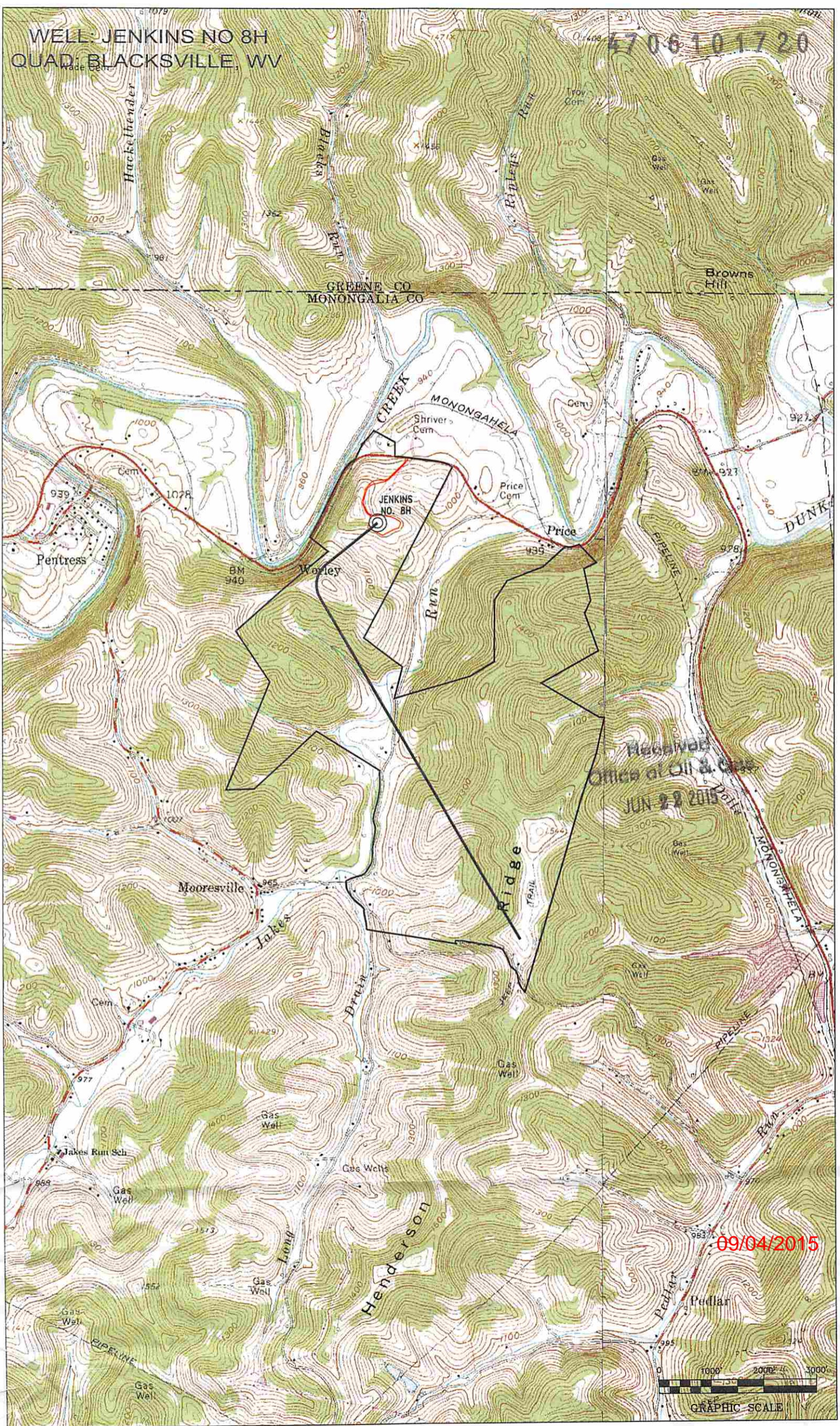

Received
Office of Oil & Gas
JUN 22 2015

09/04/2015

