

*Mod 1*

TOP HOLE (UTM 83)  
N) 4395295.0  
E) 572685.5  
BOTTOM HOLE (UTM 83)  
N) 4393447.0  
E) 574314.3

NO DWELLINGS WERE FOUND WITHIN 625'  
OF THE CENTER OF WELL PAD  
NO WATER WELLS WERE FOUND WITHIN 250'  
OF THE CENTER OF WELL PAD

- WELL REFERENCE (API#, DISTANCE TO LATERAL)
1. 061-00120
  2. 061-00125
  3. 061-30121
  4. 061-00126
  5. 061-00134
  6. 061-30187
  7. 061-71252
  8. 061-71251 N 42°52'01" W 1,345'
  9. 061-70273 N 84°24'05" W 719'
  10. 061-70075
  11. 061-71226
  12. 061-30151 N 66°16'46" E 896'
  13. 061-71250 S 63°55'54" E 1,376'
  14. 061-71256
  15. 061-00766
  16. 061-71260
  17. 061-71254 S 69°13'33" W 1,253'
  18. 061-71253
  19. 061-71255 S 50°27'10" W 1,213'
  20. 061-00101
  21. 061-30280
  22. 061-71259
  23. 061-30559
  24. 061-30531
  25. 061-71257
  26. 061-30338
  27. 061-00148
  28. 061-71258
  29. 061-30186 S 25°05'37" W 618'

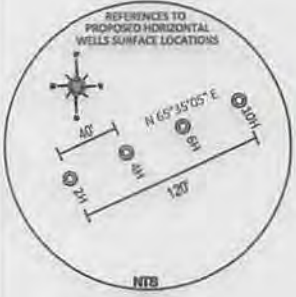
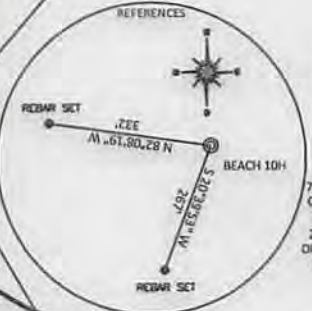
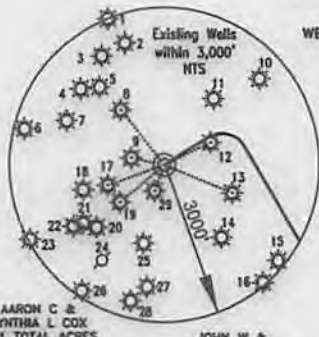

**REFERENCE NOTES**  
Boundaries as shown taken from deeds, tax maps and field locations. A full boundary survey is not expressed nor implied. All bearings are based on true north. Ownership taken from public records Ohio County, West Virginia OCTOBER 2013 State Plane Coordinates & NAD 83 Lat/Long by differential submeter mapping grade GPS Drafted by: E.A.M.



FILE #: NNE009  
DRAWING #: 2296  
SCALE: PLAT = (1"=1400')  
TICK MARK = (1"=2000')  
MINIMUM DEGREE OF ACCURACY: 1/200  
PROVEN SOURCE: SUBMETER MAPPING  
OF ELEVATION: GRADE GPS

I, THE UNDERSIGNED, HEREBY CERTIFY THAT THIS PLAT IS CORRECT TO THE BEST OF MY KNOWLEDGE AND BELIEF AND SHOWS ALL THE INFORMATION REQUIRED BY LAW AND THE REGULATIONS ISSUED AND PRESCRIBED BY THE DEPARTMENT OF ENVIRONMENTAL PROTECTION.  
Signed: *[Signature]*  
L.L.S. #2124 : Ernest J. Benchek III



(+) DENOTES LOCATION OF WELL ON UNITED STATES TOPOGRAPHIC MAPS  
WVDEP  
OFFICE OF OIL & GAS  
601 57TH STREET  
CHARLESTON, WV 25304

Well Type:  Oil  Waste Diposal  Production  Deep  
 Gas  Liquid Injection  Storage  Shallow

WATERSHED: DUNKARD CREEK ELEVATION: 1380'

COUNTY/DISTRICT: MONONGALIA / CLAY QUADRANGLE: BLACKSVILLE, WV.  
SURFACE OWNER: NANCY K. BEACH DAVIS & RUSSELL C. BEACH ACREAGE: 233.72 +/-  
OIL & GAS ROYALTY OWNER: (SEE ATTACHMENT) ACREAGE: 860.63 +/-  
LEASE NUMBERS: \_\_\_\_\_

DRILL  CONVERT  DRILL DEEPER  REDRILL  FRACTURE OR STIMULATE   
PLUG OFF FORMATION  PERFORATE NEW FORMATION  PLUG & ABANDON   
CLEAN OUT & REPLUG  OTHER CHANGE  (SPECIFY): \_\_\_\_\_

TARGET FORMATION: MARCELLUS ESTIMATED DEPTH: TVD: 8,215' TMD: 17,125'  
WELL OPERATOR: NORTHEAST NATURAL ENERGY LLC DESIGNATED AGENT: JOHN ADAMS  
ADDRESS: 707 VIRGINIA STREET SUITE 1200 ADDRESS: 707 VIRGINIA STREET SUITE 1200  
CITY: CHARLESTON STATE: WV ZIP CODE: 25301 CITY: CHARLESTON STATE: WV ZIP CODE: 25301

06/13/2014

WELL: BEACH 10H  
QUAD: BLACKSVILLE WV

