

2852.9'

(+) DENOTES LOCATION OF WELL ON U.S.G.S. TOPOGRAPHIC MAP

LATITUDE 39 40' 00"

LONGITUDE 80 20' 00" 10,678.7'

N

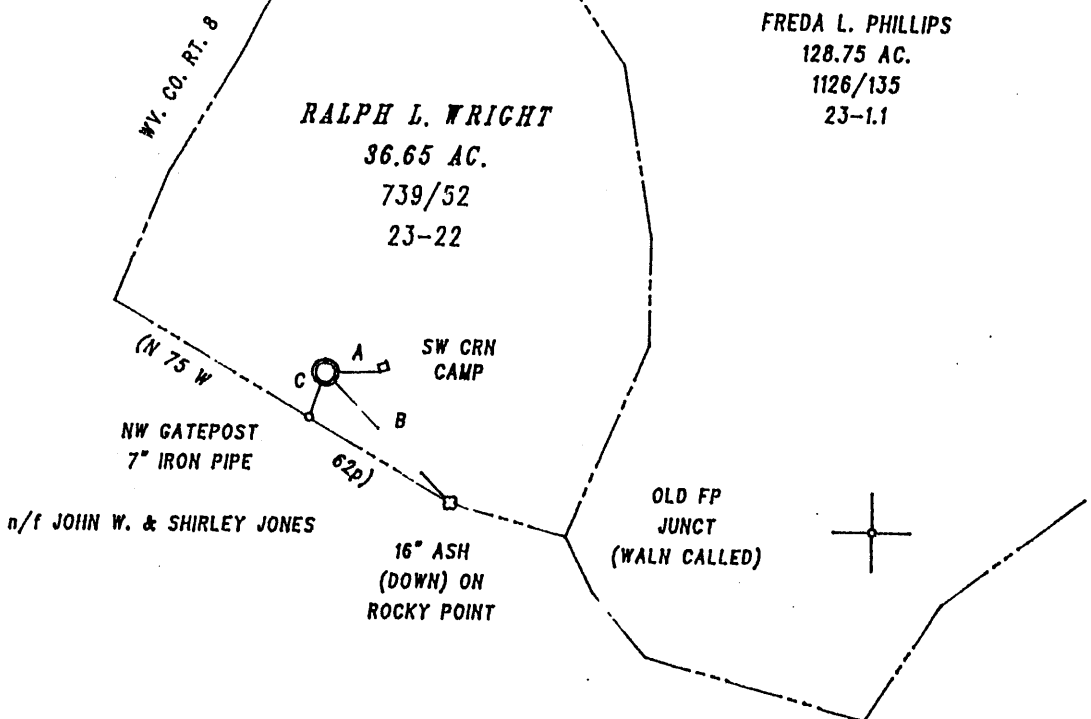

NOTE :

- 1) CONSOLIDATION COAL COMPANY OWNS THE MINERAL ON THIS TRACT.
- 2) THIS WELL IS AN EXISTING VENTILATION BORE-HOLE BEING CONVERTED TO A CBM GOB WELL.

TIE LINES

A - 73 24 31 142.92'
B - 120 10 08 470.63'
C - 73 24 31 142.92'

FILE NO. 02-HH-09
DRAWN BY : R.A. KITZMILLER
SCALE : 1 : 500'
MIN. DEGREE OF ACCURACY 1 / 200'
PROVEN SOURCE OF ELEVATION : _____
SPOT ELEVATION

I THE UNDERSIGNED, HEREBY CERTIFY THAT THIS PLAT IS CORRECT TO THE BEST OF MY KNOWLEDGE AND BELIEF AND SHOWS ALL THE INFORMATION REQUIRED BY LAW AND THE REGULATIONS ISSUED AND PRESCRIBED BY THE DIVISION OF ENVIRONMENTAL PROTECTION.

(SIGNED) Robert A. Kitzmiller
Professional Surveyor No. 635

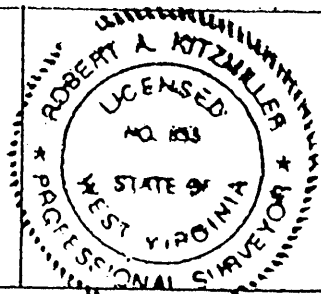

WV. DEPT. OF ENVIRONMENTAL PROTECTION
OFFICE OF OIL AND GAS DIVISION
1356 HANSFORD STREET
CHARLESTON, WV. 25301



DATE FEBRUARY 21, 20 02
OPERATOR'S WELL NO. L-106
API WELL NO. _____
47 - 061 - 014680
STATE COUNTY PERMIT NO.

WELL TYPE: OIL GAS CBM LIQUID INJECTION WASTE DISPOSAL
IF "GAS", PRODUCTION STORAGE DEEP SHALLOW
LOCATION: ELEVATION 1380' WATERSHED RANGE RUN OF WEST VIRGINIA FORK OF DUNKARD CREEK
DISTRICT BATTELLE COUNTY MONONGALIA
QUADRANGLE WADESTOWN NEAREST TOWN WADESTOWN
SURFACE OWNER RALPH L. & EDNA K. WRIGHT ACREAGE 36.65 AC.
OIL & GAS ROYALTY OWNER See Note LEASE ACREAGE ---
LEASE NO. ---

PROPOSED WORK: DRILL CONVERT DRILL DEEPER REDRILL FRACTURE OR STIMULATE
PLUG OFF OLD FORMATION PERFORATE NEW FORMATION
OTHER PHYSICAL CHANGE IN WELL (SPECIFY) EXISTING VENTILATION BOREHOLE BEING CONVERTED
PLUG AND ABANDON CLEAN OUT AND REPLUG TO GOB WELL. JAN 24 2005
TARGET FORMATION PITTSBURGH ESTIMATED DEPTH 1118'
WELL OPERATOR CNX GAS COMPANY LLC. (NORTH) DESIGNATED AGENT EDWIN L. MERRIFIELD
ADDRESS 1800 WASHINGTON ROAD ADDRESS 116 1/2 HUNSAKER STREET
PITTSBURGH, PA. 15421-1121 FAIRMONT, WV. 26554

(LOVERIDGE MINE (CBM 389) 6-6

PRECISION SURVEYS FORM IV-6

MONO COUNTY PERMIT NO. 14680

State of West Virginia
 Department of Environmental Protection
 Office of Oil and Gas

Well Operator's Report of Well Work

Farm Name: Wright, Ralph & Edna Operator Well No.: L-106

LOCATION: Elevation: 1380 Quadrangle: Wadestown

District: Battelle County: Monongalia
 Latitude: 10678.7 Feet South of 39 Deg. 40 Min. 00 Sec.
 Longitude: 2852.9 Feet West of 80 Deg. 20 Min. 00 Sec.

Company: CNX Gas Company LLC (North)

	Casing & Tubing	Used In Drilling	Left In Well	Cement Fill Up Cu. Ft.
Address: 1800 Washington Road Pittsburgh, PA 15241				
Agent: Edwin Merrifield				
Inspector: Steve Mossor				
Date Permit Issued: 1/21/2003				
Date Well Work Commenced: Existing Borehole				
Date Well Work Completed: Converted to well				
Verbal Plugging:				
Date Permission granted on:				
Rotary Cable Rig				
Total Depth (feet): 1118				
Fresh Water Depth (ft.):				
Salt Water Depth (ft.):				
Is coal being mined in area (N/Y)? No				
Coal Depths (ft.): 1100				

OPEN FLOW DATA

Producing formation Pittsburgh Coal Seam Pay zone depth (ft) 1100
 Gas: Initial open flow 155 MCF/d Oil: Initial open flow 0 Bbl/d
 Final open flow 155 MCF/d Final open flow 0 Bbl/d
 Time of open flow between initial and final tests 0 Hours
 Static rock pressure 1 psig (surface pressure) after - Hours

Second producing formation None Pay zone depth (ft) _____
 Gas: Initial open flow _____ MCF/d Oil: Initial open flow _____ Bbl/d
 Final open flow _____ MCF/d Final open flow _____ Bbl/d
 Time of open flow between initial and final tests _____ Hours
 Static rock pressure _____ psig (surface pressure) after _____ Hours

NOTE: ON BACK OF THIS FORM PUT THE FOLLOWING: 1). DETAILS OF PERFORATED INTERVALS, FRACTURING OR STIMULATING, PHYSICAL CHANGE, ETC. 2). THE WELL LOG WHICH IS A SYSTEMATIC DETAILED GEOLOGICAL RECORD OF ALL FORMATIONS INCLUDING COAL ENCOUNTERED BY THE WELLBORE.

Signed: Joseph P. Aman
 By: Joseph P. Aman
 Date: September 2, 2004

OCT 15 2004

