

LATITUDE 39°40'00"

LONGITUDE 80°17'30"



NOVA SHEETS HENDERSON

THADDEUS J. SAVINO

ALBERT & MARIE PRICE

BETTY J. MARTINO

FRANKLIN MICHAEL CHISLER

CONSOLIDATION COAL COMPANY

CONSOLIDATION COAL COMPANY
TM/PAR 1-23/9
170.5± AC

NELSON D. & CHERYL L. GALLAGHER

WELL L-32

KEVIN & DEBORAH RIFFLE

BILLY G. HIBBS

BILLY G. HIBBS

DONALD & JANICE WHITE

JOSEPH E. & SHEILA TENNANT

COORDINATES:
7,598.33' WEST
8,758' SOUTH

WELL LOCATION

UTM 17-NAD83
N:4388320.98
E:558477.12
NAD83, WV NORTH
N:417246.15
E:1738019.66
LAT/LOG DATUM-WGS84
LAT:39°38'33.64"
LON:80°19'06.51"

NOTE:

It is not the purpose or intention of this plat to represent surveyed locations of the surface or mineral parcels depicted hereon. The location of the boundary lines, as shown, are based on record deed descriptions, field evidence found and/or tax map position, unless otherwise noted.

OIL & GAS WELLS WITHIN 1200 ft.

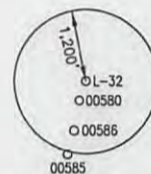

REFERENCE NOT TO SCALE



Blue Mountain Engineering
11023 MASON DIXON HIGHWAY
BURTON, WV 26562
PHONE: (304) 662-6486

FILE #: L-32
DRAWING #: L-32
SCALE: 1" = 800'
MINIMUM DEGREE OF ACCURACY: 1/2500
PROVEN SOURCE OF ELEVATION: U.S.G.S. MONUMENT THOMAS 1498.81'

I, THE UNDERSIGNED, HEREBY CERTIFY THAT THIS PLAT IS CORRECT TO THE BEST OF MY KNOWLEDGE AND BELIEF AND SHOWS ALL THE INFORMATION REQUIRED BY LAW AND THE REGULATIONS ISSUED AND PRESCRIBED BY THE DEPARTMENT OF ENVIRONMENTAL PROTECTION.

Signed: *George D. Six*

R.P.E.:

L.L.S.: P.S. No. 2000

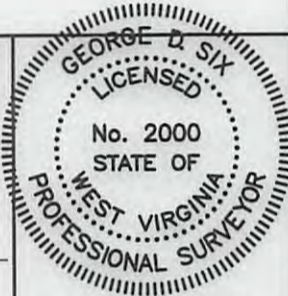

PLACE SEAL HERE

(+) DENOTES LOCATION OF WELL ON UNITED STATES TOPOGRAPHIC MAPS WVDEP
OFFICE OF OIL & GAS
601 57TH STREET
CHARLESTON, WV 25304



DATE: JULY 29, 2013

OPERATOR'S WELL #: L-32

API WELL #: 47 061 01447C P
STATE COUNTY PERMIT

Well Type: Oil Waste Disposal Production Deep
 Gas Liquid Injection Storage Shallow

WATERSHED: RIGHT BRANCH OF MIRACLE RUN ELEVATION: 1229'

COUNTY/DISTRICT: MONONGALIA / BATTELLE QUADRANGLE: WADESTOWN, WV-PA 7.5'

SURFACE OWNER: CONSOLIDATION COAL COMPANY ACREAGE: 170.5±

OIL & GAS ROYALTY OWNER: CONSOLIDATION COAL COMPANY, ET. AL. ACREAGE:

DRILL CONVERT DRILL DEEPER REDRILL FRACTURE OR STIMULATE
PLUG OFF OLD FORMATION PERFORATE NEW FORMATION PLUG & ABANDON
CLEAN OUT & REPLUG OTHER CHANGE (SPECIFY):

TARGET FORMATION: PITTSBURGH ESTIMATED DEPTH: 1020'

WELL OPERATOR CNX GAS COMPANY LLC DESIGNATED AGENT JEREMY JONES
Address 200 EVERGREENE Dr. Address 1 DOMINION DRIVE
City WAYNESBURG State PA Zip Code 15370 City JANE LEW State WV Zip Code 26378

11/08/2013

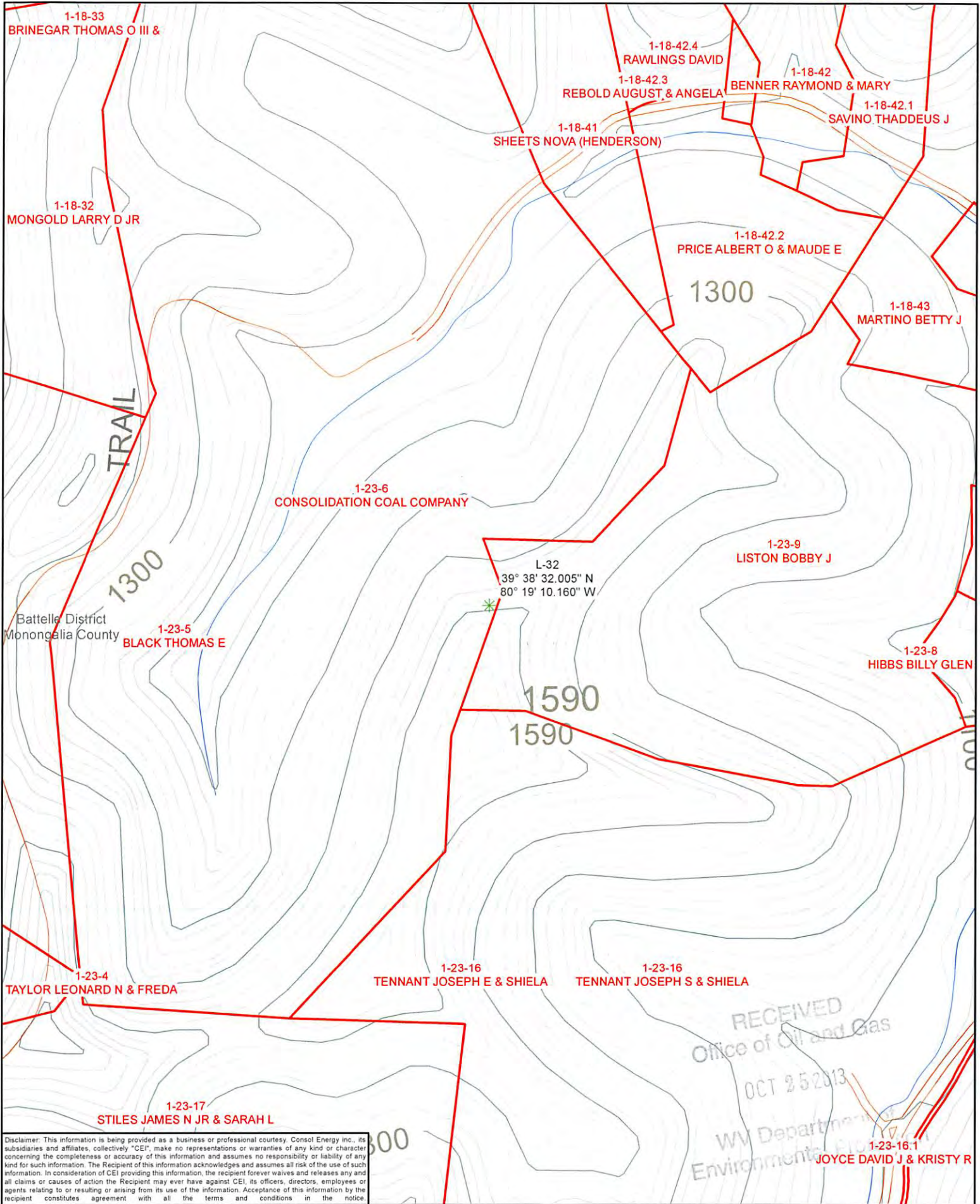

Disclaimer: This information is being provided as a business or professional courtesy. Consol Energy Inc., its subsidiaries and affiliates, collectively "CEI", make no representations or warranties of any kind or character concerning the completeness or accuracy of this information and assumes no responsibility or liability of any kind for such information. The Recipient of this information acknowledges and assumes all risk of the use of such information. In consideration of CEI providing this information, the recipient forever waives and releases any and all claims or causes of action the Recipient may ever have against CEI, its officers, directors, employees or agents relating to or resulting or arising from its use of the information. Acceptance of this information by the recipient constitutes agreement with all the terms and conditions in the notice.

RECEIVED
Office of Oil and Gas
OCT 25 2013
WV Department of Environmental Protection

Legend GOB Well Surface Property District / County		1 inch = 500 feet	
		Date: 7/10/2013 Prepared By: K. McCartney Revisions: Approved By:	This map is property of CONSOL Energy Inc. and contains information that is proprietary and confidential in nature and may not be copied or reproduced without prior written consent.

GOB Well Location Map
Well L-32 for Plugging
Loveridge Project Area