

LATITUDE 39° 40' 00"

10,065'

2,200'

LONGITUDE 80° 12' 30"

TOPO. LOC.  
BLACKSVILLE QUAD.  
7 1/2' SERIES

BLENDINE EDDY ET AL

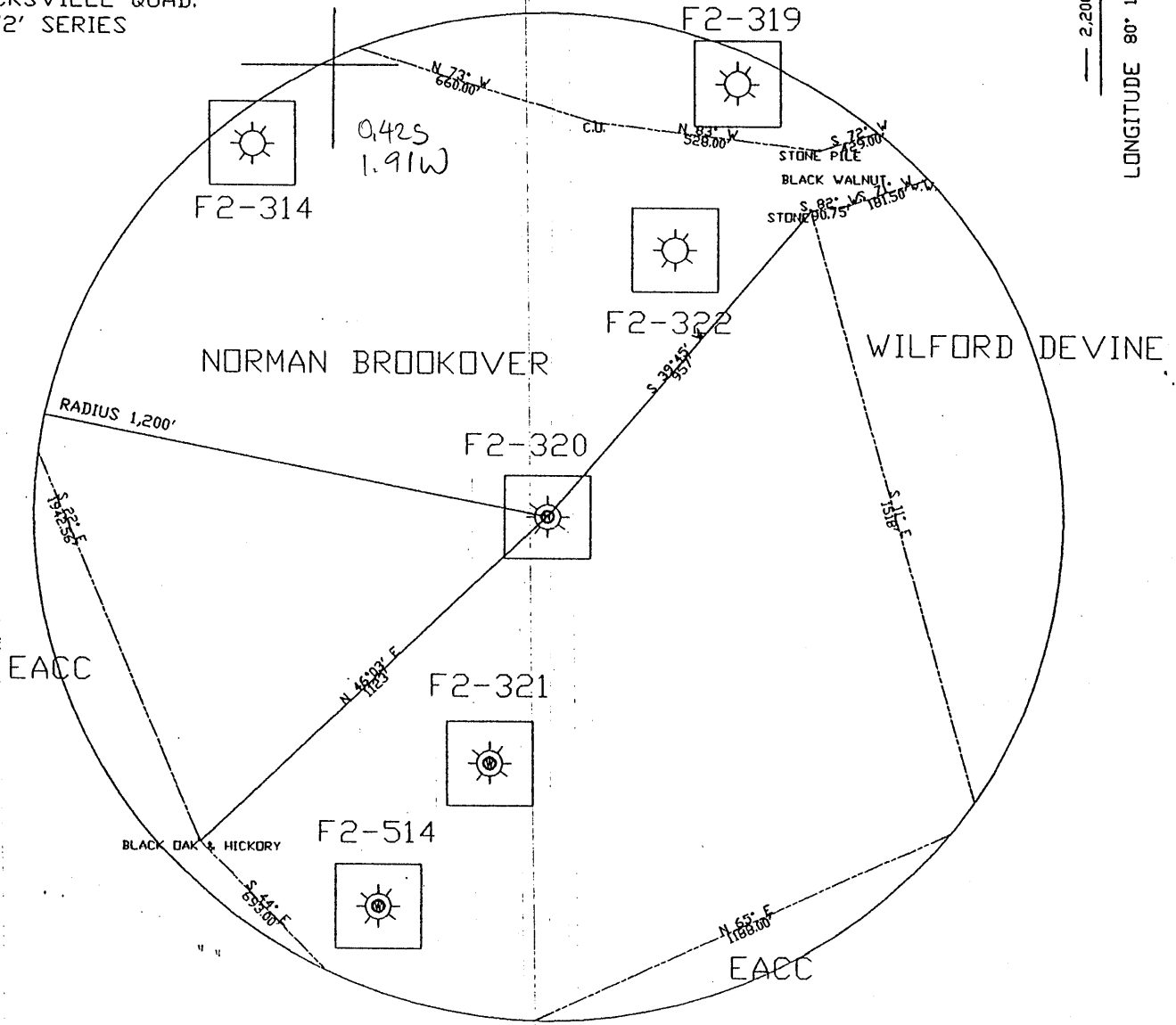

FILE NO. F2-2-342  
 DRAWING NO. F2-2-320  
 SCALE 1"=400'  
 MINIMUM DEGREE OF  
 ACCURACY 1/2500'  
 PROVEN SOURCE OF  
 ELEVATION USGS B.M.

I THE UNDERSIGNED, HEREBY CERTIFY  
 THAT THIS PLAT IS CORRECT TO THE  
 BEST OF MY KNOWLEDGE AND BELIEF AND  
 SHOWS ALL THE INFORMATION REQUIRED  
 BY LAW AND THE REGULATIONS ISSUED  
 AND PRESCRIBED BY THE DEPARTMENT OF  
 MINES.  
 (SIGNED) *John F. Ewell Jr.*  
 R.P.E. 11133 L.L.S.

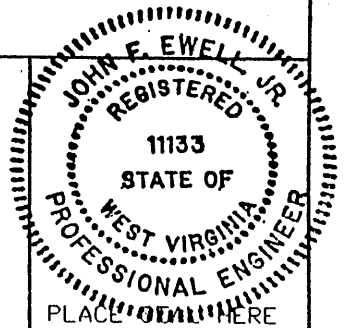

(+) DENOTES LOCATION OF  
 WELL ON UNITED STATES  
 TOPOGRAPHIC MAPS

DATE AUGUST 13, 2002  
 OPERATOR'S WELL NO F2-320  
 API WELL NO.

FORM IV-6

47-061-01442P  
 STATE COUNTY PERMIT

(8-78

STATE OF WEST VIRGINIA  
 DEPARTMENT OF ENVIRONMENTAL PROTECTION  
 OIL AND GAS DIVISION

was: 061 71133

WELL TYPE: OIL \_\_\_ GAS X LIQUID INJECTION \_\_\_ WASTE DISPOSAL \_\_\_  
 (IF 'GAS', PRODUCTION STORAGE \_\_\_ DEEP \_\_\_ SHALLOW X \_\_\_  
 LOCATION: ELEVATION 1,220' WATERSHED \_\_\_ DAYS RUN \_\_\_  
 DISTRICT CLAY COUNTY MONONGALIA  
 QUADRANGLE BLACKSVILLE  
 SURFACE OWNER NORMAN BROOKOVER ACREAGE 26.1  
 OIL & GAS ROYALTY OWNER DAYBROOK O & G # 2 LEASE ACREAGE \_\_\_  
 LEASE NO. ISAAC AMMONS 97.5 AC  
 PROPOSED WORK: DRILL \_\_\_ CONVERT \_\_\_ DRILL DEEPER \_\_\_ REDRILL X FRACTURE OR  
 STIMULATE \_\_\_ PLUG OFF OLD FORMATION \_\_\_ PERFORATE NEW  
 FORMATION \_\_\_ OTHER PHYSICAL CHANGE IN WELL (SPECIFY) \_\_\_

PLUG AND ABANDON \_\_\_ CLEAN OUT AND REPLUG X \_\_\_  
 TARGET FORMATION BAYARD SAND ESTIMATED DEPTH 3,190'  
 WELL OPERATOR EASTERN ASSOC. COAL CORP DESIGNATED AGENT EDWARD Y. HOY  
 ADDRESS 1044 MIRACLE RUN ROAD ADDRESS 1044 MIRACLE RUN ROAD  
FAIRVIEW WV. 26570 FAIRVIEW WV. 26570

MONO 1442 P

