

39° 40' 00" LATITUDE → 2205'

*Janice*  
*1/22/98*

CONSOLIDATION  
COAL COMPANY

WELL N 62°24'56" W  
#4183A

FREDA L. PHILLIPS  
125.415 ACRES

STONE

BREIDING

FENCE  
POST

PRICE

KING

PHILLIPS

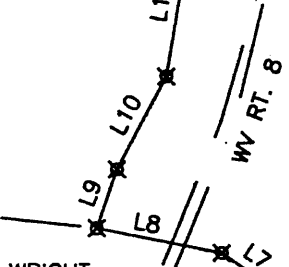

7820'

80° 20' 00" LONGITUDE

NORTH

LINE	BEARING	DISTANCE
L1	S 85°30'52" W	592.69'
L2	N 59°29'08" W	210.86'
L3	N 46°29'08" W	160.80'
L4	N 02°51'43" E	487.53'
L5	N 07°26'13" E	297.00'
L6	N 49°31'16" W	316.80'
L7	N 55°15'39" W	197.85'
L8	N 79°00' W	396.00'
L9	N 19°15'15" E	194.84'
L10	N 28°15'15" E	330.00'
L11	N 10°15'15" E	445.50'
L12	S 71°15'15" E	268.90'
L13	N 23°00' E	523.55'

LINE	BEARING	DISTANCE
L14	N 05°15' E	539.97'
L15	N 22°09'27" E	197.25'
L16	S 63°10' E	708.85'
L17	S 10°00' E	242.11'
L18	S 36°54'12" E	594.00'
L19	N 90°00' E	354.75'
L20	S 54°00' E	494.42'
L21	S 12°00' E	175.12'
L22	S 40°00' W	194.76'
L23	S 25°09'26" W	560.31'
L24	S 12°09'25" W	197.77'
L25	S 05°50'35" E	563.63'
L26	S 38°09'25" W	692.18'
L27	S 18°09'25" W	362.57'

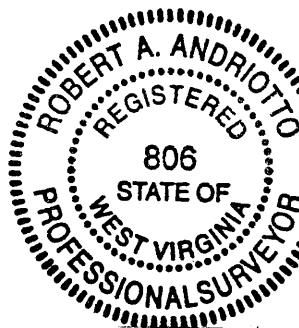
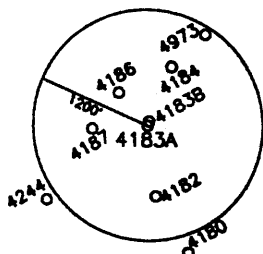

(+) DENOTES LOCATION OF WELL ON UNITED STATES TOPOGRAPHIC MAPS.  
DATE DECEMBER 8, 19 97

OPERATORS WELL NO. 4183A  
API WELL NO. 47 - 61 - 01292-P  
STATE COUNTY PERMIT

I THE UNDERSIGNED, HEREBY CERTIFY THAT THIS PLAT IS CORRECT TO THE BEST OF MY KNOWLEDGE AND BELIEF AND SHOWS ALL THE INFORMATION REQUIRED BY LAW AND THE REGULATIONS ISSUED AND PRESCRIBED BY THE DEPARTMENT OF ENERGY.

P.S. Robert A. Andriotto  
806

MINIMUM DEGREE OF ACCURACY 1 / 200 FILE NO. \_\_\_\_\_ SCALE 1" = 600'  
PROVEN SOURCE OF ELEVATION COMPANY NETWORK TIED INTO U.S.G.S.

WEST VIRGINIA DIVISION OF ENVIRONMENTAL PROTECTION OFFICE OF OIL AND GAS #10 McJUNKIN ROAD NITRO, WEST VIRGINIA 25143-2506



WELL TYPE: OIL  GAS  LIQUID INJECTION  WASTE DISPOSAL  "GAS" PRODUCTION  STORAGE  DEEP  SHALLOW

LOCATION: ELEVATION 1098.95' WATERSHED RANGE RUN  
DISTRICT BATTELLE COUNTY MONONGALIA QUADRANGLE WADESTOWN WV-PA 7.5'

SURFACE OWNER FREDA L. PHILLIPS ACREAGE 125.415  
ROYALTY OWNER \_\_\_\_\_ LEASE ACREAGE \_\_\_\_\_

PROPOSED WORK: \_\_\_\_\_ LEASE NO. \_\_\_\_\_  
DRILL  CONVERT  DRILL DEEPER  REDRILL  FRACTURE OR STIMULATE  PLUG OFF OLD

FORMATION \_\_\_\_\_ PERFORATE NEW FORMATION  PLUG AND ABANDON  CLEAN OUT AND REPLUG  OTHER

PHYSICAL CHANGE IN WELL (SPECIFY) \_\_\_\_\_ TARGET FORMATION \_\_\_\_\_ ESTIMATED DEPTH \_\_\_\_\_

WELL OPERATOR CONSOLIDATION COAL CO. DESIGNATED AGENT ROGER E. DUCKWORTH  
ADDRESS P.O. BOX 100 OSAGE, WV 26543 ADDRESS P.O. BOX 100 OSAGE, WV 26543

MONO COUNTY NAME PERMIT 1292-P

Latitude 39° 40'

1,162  
.04 W

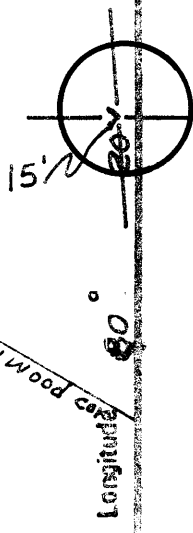
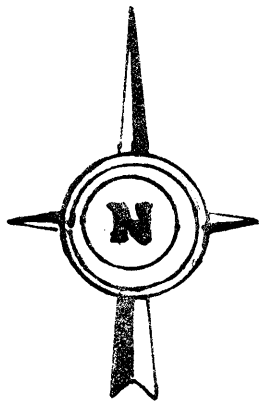

B.M. 1049.00

STONE Cor. L.E. Hartley

N31°00'E  
71.10 P.

STONE

N62°00'E  
44.75 P.  
TO IRONWOOD CAMP

Joseph Estol  
(The Range) Battle Dist.  
Monongalia County W.Va.  
Containing 128.75 Ac. + -  
Ref. Deed Book NO. 710 Pg. 465.

N5°15'E  
27.00 P.

STONE

Well No (9)  
El. 1100.00

N70°00'E  
54.42 Poles

N57°15'E  
42.30 Poles

N23°00'E  
32.20 P.

N74°00'E  
13.30 P.

STONE

Range Run

TO WADDESTOWN

STONE & Rd

Ammons Line

STONE

N42°00'E  
20 P.

New Location   
Drill Deeper   
Abandonment

Minimum Error of Closure 1" in 200'  
Source of Elevation U.S.G.S. App. 1 Mi. South Wadestown,  
Cn Sec. ST. Rt. (8)  
"I, the undersigned, hereby certify that this map is correct to the best of my knowledge and belief and shows all the information required by paragraph 6 of the rules and regulations of the oil and gas section of the mining laws of West Virginia."

Company BURLEY KAY MYERS  
 Address Reynoldsville West Va.  
 Farm Charles H. & Freda L. Phillips  
 Tract \_\_\_\_\_ Acres 128.75 Lease No. \_\_\_\_\_  
 Well (Farm) No. (9) Serial No. \_\_\_\_\_  
 Elevation (Spirit Level) 1100.00 Ft.  
 Quadrangle Mannington  
 County Monongalia District Battelle Dist  
 Land Surveyor Paul [unclear]  
 No. 350  
 File No. \_\_\_\_\_ Drawing No. \_\_\_\_\_  
 Date 9-1-1978 Scale 165.00 Ft. Per. 1"

STATE OF WEST VIRGINIA  
DEPARTMENT OF MINES  
OIL AND GAS DIVISION  
CHARLESTON  
  
WELL LOCATION MAP  
FILE NO. MON-715-A

+ Denotes location of well on United States Topographic Maps, scale 1 to 62,500 latitude and longitude lines being represented by border lines as shown.

- Denotes one inch spaces on border line of original tracing.

47-061 SEP 22 1978

Latitude

Longitude

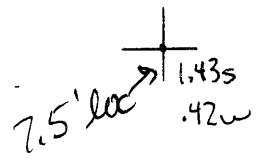

Topo Location

7.5' Loc. \_\_\_\_\_ 15' Loc. \_\_\_\_\_  
 \_\_\_\_\_ (calc.) \_\_\_\_\_

#95 on Co Rept

Company Burdley Kay Meyers

Farm C Phillips #9 (Joseph Estil 9)  
South Penn

15' Quad \_\_\_\_\_  
(sec.)

7.5' Quad Watstown

District Battelle

WELL LOCATION PLAT

County Obi Permit 30715  
 Was 70033

Battelle District, Monongalia County, W. Va.

1.1 mi. N. E. of St. Leo.

South Penn Oil Co.

Completed, June 24, 1909.

Elevation, 1105' B.

10" casing, 227'; 8 $\frac{1}{2}$ ", 1424'; 6-5/8", 1936'; 5-3/16", 2341';  
4 $\frac{1}{2}$ x4", 192'.

	Top.	Bottom.
Bluff Sand	515	
Mapletown Coal	825	
Pittsburgh Coal	930	
Salt Sand (water, 1875-95')	1845	1922
Pencil Cave	2140	2150
Big Lime	2150	2210
Big Injun Sand (gas, 2293')	2210	2365
Campbells Run Sand	3077	3120
Fourth Sand (oil, 3181') to bottom	3175	3181

Battelle District, Monongalia County, W. Va.

By South Penn Oil Co.

1.1 mi. N. E. of St. Leo.

Completed, June 24, 1909.

Elevation, 1105' B.

10" casing, 227'; 8", 1424'; 6-5/8", 1936'; 5-3/16", 2341';  
4 1/2" liner, 192'.

	Top.	Bottom.	Thickness.
Bluff Sand	515		
Coal, Mapletown (Swickley)	825		
Coal, Pittsburgh	950		
Salt Sand (water, 1875-1895')	1845	1922	77
Pencil Cove	2140	2150	10
Big Lime	2190	2250	60
Big Injun Sand (gas, 2293')	2210	2365	155
Campbell's Run Sand	3077	3120	43
Fourth Sand (oil, 3181'), to bottom	3175	3181	6

AFFIDAVIT OF PLUGGING AND FILLING WELL

AFFIDAVIT SHOULD BE MADE IN TRIPLICATE, one copy mailed to the Division, one copy to be retained by the Well Operator and the third copy (and extra copies if required) should be mailed to each coal operator at their respective addresses.

CONSOLIDATION COAL CO.  
Coal Operator or Owner  
P. O. BOX 100, OSAGE, WV  
Address

CONSOLIDATION COAL CO.  
Coal Operator or Owner  
P. O. BOX 100, OSAGE, WV  
Address

Lease or Property Owner  
Address

CONSOLIDATION COAL COMPANY  
Name of Well Operator  
P. O. BOX 100, OSAGE, WV 26543  
Complete Address  
April 02, 19 98

WELL LOCATION  
BATTELLE  
District  
MONONGALIA  
County  
#4183-A  
WELL NO.

STATE INSPECTOR SUPERVISING PLUGGING

RECEIVED  
Office of Oil & Gas

AFFIDAVIT

JAN 27 2005

STATE OF WEST VIRGINIA,  
County of UPSHUR

ss:

WV Department of  
Environmental Protection

G. ANDREW LANG and KEVIN S. WRIGHT  
being first duly sworn according to law depose and say that they are experienced in the work of plugging and filling oil and gas wells and were employed by CONSOLIDATION COAL CO. well operator, and participated in the work of plugging and filling the above well, that said work was commence on the 27TH day of FEB. 98 and that the well was plugged in the following manner:

Sand or Zone Record	Filling Material	Plugs Used	Casing Pulled	Casing Left In
Formation		Size & Kind		
		7" CASING	445.35'	703'
CLEAN OUT WITH 9 7/8" BIT TO 662' (TOP OF 7" CASING)				
REDUCE HOLE AND CLEAN OUT WITH 6 1/4" BIT. CLEAN OUT CEMENT				
PLUG IN 7" CASING FROM 710' TO 802'. CLEAN OUT 7" CASING WITH 6 1/4" BIT				
TO 1,808'. SEVEN INCH (7") CASING CEMENTED FROM 662' TO 787'.				
WASHOVER 7" CASING WITH 9" WASHOVER PIPE FROM 662' TO 787'.				
PULL 7" CASING FROM 662' TO 1105'. CLEAN HOLE WITH 9 7/8" BIT				
TO 1,100'. CLEAN HOLE WITH 6 1/4" MILL TO 1,808'. CLEAN 9 7/8" HOLE				
THRU PITTSBURGH COAL FROM 938' TO 946'. LEFT 7" CASING IN HOLE				
FROM 1,105' TO UNKNOWN. CEMENTED HOLE SOLID FROM 1,808'				
BACK TO SURFACE USING 640 SACKS OF POZ MIX AND 250 SACKS OF THIXATROPIC CEMENT				
CEMENT DID CIRCULATE. USED 1000 GALLONS OF MUD FLUSH. SENT CEMENT PLUG FROM				
1,806' TO 1,150' WITH 75/25 POZ MIX. SENT CEMENT PLUG FROM 1,150' TO 756' WITH				
THIXATROPIC CEMENT. SENT CEMENT PLUG FROM 756' TO SURFACE WITH 75/25 POZ MIX.				
TOTAL SOLID CEMENT PLUG: 1,808 FEET				
W		Description of Monument		
(Name)	PITTSBURGH	938' TO 946'	5' OF 4 1/2" CASING WITH PLAQUE STATING	
(Name)			CONSOLIDATION COAL COMPANY	
(Name)			WELL 4183A	
(Name)			PERMIT #47-61-01292-P	

and that the work of plugging and filling said well was completed on the 10th day of March 1

And further deponents saith not.

Sworn to and subscribed before me this 2ND day of

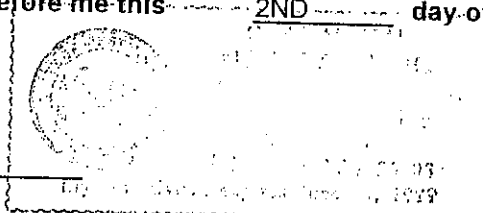

My commission expires:  
6-29-99

*Kevin S. Wright*  
*G. Andrew Lang*

April 1998  
*Charlotte Wenter*  
Notary Public

Permit No.  
47-61-01292-P

MONO 1292 P

FEB 04 2005

**RECEIVED**  
OCT 07 1987

AFFIDAVIT OF PLUGGING AND FILLING WELL

DIVISION OF OIL & GAS  
DEPARTMENT OF ENERGY

AFFIDAVIT SHOULD BE MADE IN TRIPLICATE, one copy mailed to the Division, one copy to be retained by the Well Operator and the third copy (and extra copies if required) should be mailed to each coal operator at their respective addresses.

Consolidated Coal Company  
Coal Operator or Owner  
Morgantown, W.V.  
Address

---

Coal Operator or Owner  
Address  
Charles Phillips  
Lease or Property Owner  
Wadestown, W.V.  
Address

Burley K. Myers  
Name of Well Operator  
Reynoldsville, W.V.  
Complete Address

---

Sept \_\_\_\_\_ 19 \_\_\_\_\_  
WELL AND LOCATION  
Batelle District  
Monongahela County

---

WELL NO. 9  
Joseph Estel Farm

STATE INSPECTOR SUPERVISING PLUGGING Bill Blosser

AFFIDAVIT

STATE OF WEST VIRGINIA,  
County of Harrison

ss:

and

being first duly sworn according to law depose and say that they are experienced in the work of plugging and filling oil and gas wells and were employed by Burley K. Myers, well operator, and participated in the work of plugging and filling the above well, that said work was commenced on the 1st day of Sept., 19 78, and that the well was plugged and filled in the following manner:

Sand or Zone Record Formation	Filling Material	Plugs Used Size & Kind	Casing	
			CSG PULLED	CSG LEFT IN
total depth	3181			
gel	3181-2900			
cement plug 100'	2900-2800			
gel	2800 to surface			
cement plug pulled	2200-2150 5" casing		2200'	14'
set cement plug pulled	1000' to 805 1000' 7"		1000'	936'
set 50' plug to surface				
Coal Seams				
(Name) <u>Pittsburg Coal</u>		7" pipe		
(Name)				
(Name)				
(Name)				

and that the work of plugging and filling said well was completed on the 1 day of May, 19 78.

And further deponents saith not.

Sworn to and subscribed before me this 2nd day of September, 19 87.

Burley K. Myers  
Broad Starkey  
Burley K. Myers  
Notary Public

OCT 19 1987

My commission expires:  
March 20, 1991

Permit No. 061-0715-A  
(30715)