



West Virginia Department of Environmental Protection
Office of Oil and Gas
WELL LOCATION FORM: GPS

API: 4706101269 WELL NO.: 023553

FARM NAME: Shriver

RESPONSIBLE PARTY NAME: CNX

COUNTY: Monongalia DISTRICT: Battelle

QUADRANGLE: Wadestown

SURFACE OWNER: CNX RCPC LLC

ROYALTY OWNER: CNX RCPC LLC

UTM GPS NORTHING: 4393340.31

UTM GPS EASTING: 558922.06 GPS ELEVATION: 1236.00

The Responsible Party named above has chosen to submit GPS coordinates in lieu of preparing a new well location plat for a plugging permit or assigned API number on the above well. The Office of Oil and Gas will not accept GPS coordinates that do not meet the following requirements:

1. Datum: NAD 1983, Zone: 17 North, Coordinate Units: meters, Altitude: height above mean sea level (MSL) – meters.
2. Accuracy to Datum – 3.05 meters
3. Data Collection Method:

Survey grade GPS : Post Processed Differential _____

Real-Time Differential

Mapping Grade GPS _____ : Post Processed Differential _____

Real-Time Differential _____

4. Letter size copy of the topography map showing the well location.

I the undersigned, hereby certify this data is correct to the best of my knowledge and belief and shows all the information required by law and the regulations issued and prescribed by the Office of Oil and Gas.

Raymond
Signature

Project MANAGER
Title

12-3-20
Date

RECEIVED
Office of Oil and Gas

DEC 10 2020

WV Department of
Environmental Protection

03/12/2021

4706101263P
21

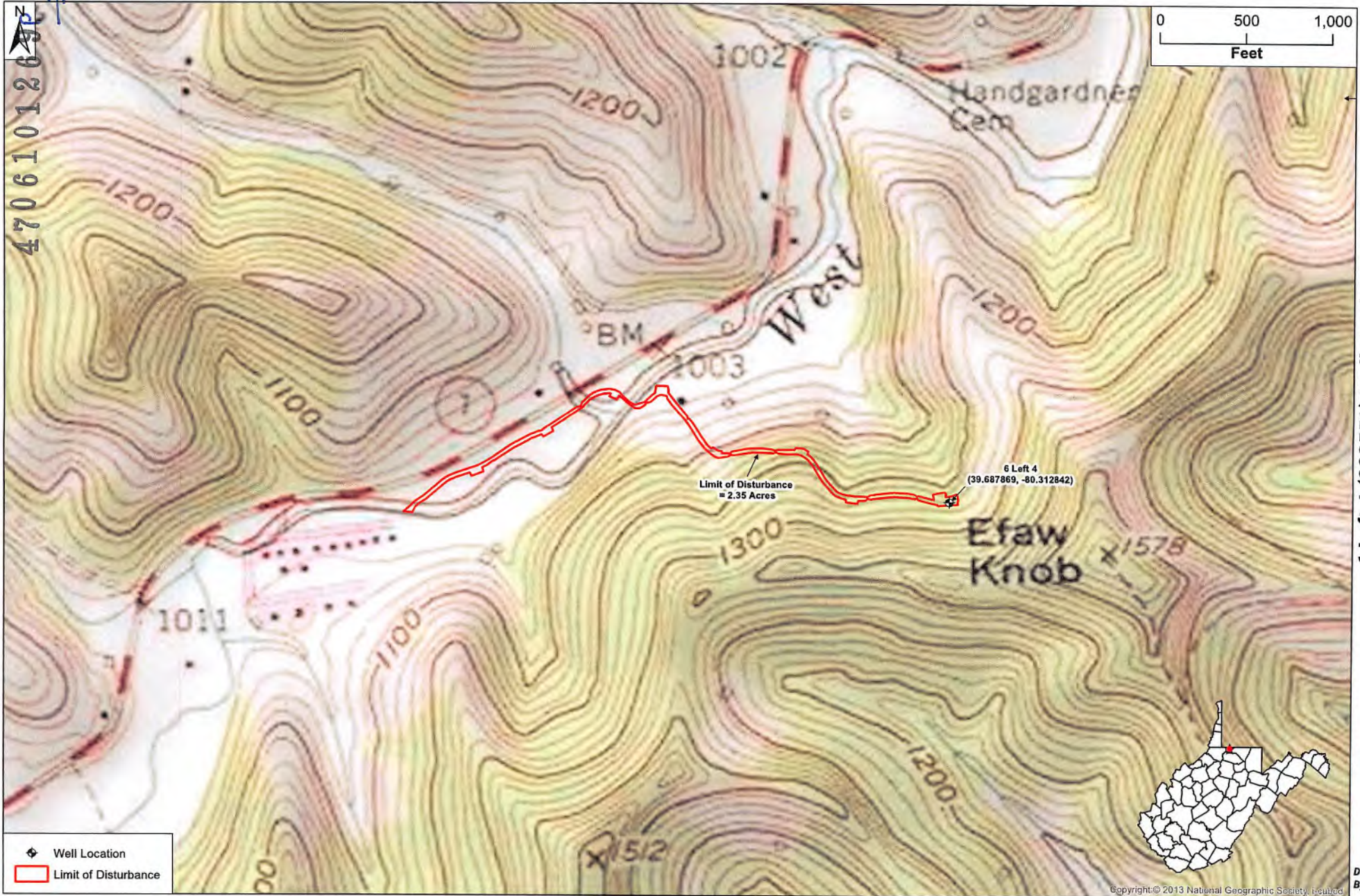

6 Left 4 (023553) Well Head
Site Location Topographic Map
Monroalia County, West Virginia



Date: 11/19/21
By: J. Stascak