

NORTH

D. King, estate
176.476 ac.

Bircher
41 ac.

(point in centerline of
road in property line)

stake ——— WEST
1226.30'

Location
912050

S32°54'W
643'

(87)

with

N65°38'W
1244'

Road

(87)

S14°00'E
1584.00'

7 1/2'

W. King
161.25 ac.

stake

N76°00'E
1664.9'

stake

Musgrove
65.582 ac.

There are no wells within
2400' of this location.

(+) DENOTES LOCATION OF WELL ON UNITED STATES TOPOGRAPHIC MAPS

FILE NO. _____
DRAWING NO. 1
SCALE 1" = 500'
MINIMUM DEGREE OF
ACCURACY 1 in 200
PROVEN SOURCE OF
ELEVATION Road junction 3,400'
SE of Location: elev. 1893'

I THE UNDERSIGNED, HEREBY CERTIFY THAT
THIS PLAT IS CORRECT TO THE BEST OF MY
KNOWLEDGE AND BELIEF AND SHOWS ALL THE
INFORMATION REQUIRED BY LAW AND THE REGU-
LATIONS ISSUED AND PRESCRIBED BY THE DEPART-
MENT OF ENERGY

(SIGNED) [Signature]
R.P.E. _____ L.L.S. 791

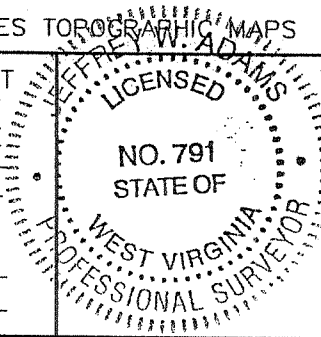

STATE OF WEST VIRGINIA
Division of Environmental Protection
OFFICE OF OIL AND GAS

DATE March 1 2004
OPERATOR'S WELL NO. 912050
API WELL NO. _____

WELL TYPE: OIL ___ GAS X LIQUID INJECTION ___ WASTE DISPOSAL ___
(IF "GAS") PRODUCTION ___ STORAGE ___ DEEP ___ SHALLOW X

LOCATION: ELEVATION 1789 WATER SHED Whiteday Creek
DISTRICT Clinton COUNTY Monongalia
QUADRANGLE Gladesville 7 1/2'

SURFACE OWNER Dorothea Rumble King, estate ACREAGE 41.25
OIL & GAS ROYALTY OWNER Dorothea R. King & Darlie R. Britton LEASE ACREAGE 41.25 out of 316
LEASE NO. 5070

PROPOSED WORK: DRILL ___ CONVERT ___ DRILL DEEPER ___ REDRILL ___ FRACTURE OR
STIMULATE ___ PLUG OFF OLD FORMATION X PERFORATE NEW
FORMATION X OTHER PHYSICAL CHANGE IN WELL (SPECIFY) _____

PLUG AND ABANDON ___ CLEAN OUT AND REPLUG ___
TARGET FORMATION Benson/Speechly ESTIMATED DEPTH 3750
WELL OPERATOR Columbia Natural Resources, Inc. DESIGNATED AGENT R. Mark Hackett
ADDRESS P.O. Box 6070, Charleston, WV 25362-0070 ADDRESS P.O. Box 6070, Charleston, WV 25362-0070

COUNTY NAME MONO
PERMIT 1214-W

DEEP WELL

(S. Burn Chapel 313) 6-6

JUL 09 2004

REFERENCES

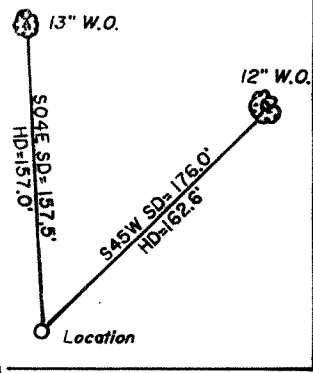

Bircher 41 ac.

D. King 176.467 ac.

W. King 161.25 ac.

Bunner 65.582 ac.

Location 2050

1192 (07)

(point in centerline of road in property line)

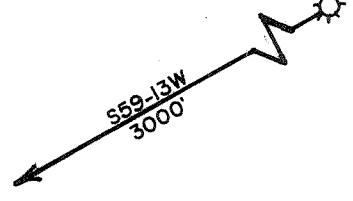

NORTH

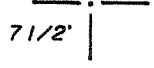

1.44S
2.21W

S14-00E 1584.0'

S32-54W 643'

N65-38W 1244'

N76-00E 1664.9'

(fd. corner fence post)

There are no wells within 2,400' of this location.

NOTE: Location is at least 400' from all lease lines.

(+) DENOTES LOCATION OF WELL ON UNITED STATES TOPOGRAPHIC MAPS

FILE NO. _____
 DRAWING NO. 1
 SCALE 1" = 500'
 MINIMUM DEGREE OF ACCURACY 1 in 200
 PROVEN SOURCE OF ELEVATION Road junction 3,400'
SE of Location; elev. 1893'

I THE UNDERSIGNED, HEREBY CERTIFY THAT THIS PLAT IS CORRECT TO THE BEST OF MY KNOWLEDGE AND BELIEF AND SHOWS ALL THE INFORMATION REQUIRED BY LAW AND THE REGULATIONS ISSUED AND PRESCRIBED BY THE DEPARTMENT OF ENERGY
 (SIGNED) Jeffrey W. Adams
 R.P.E. _____ L.L.S. 791

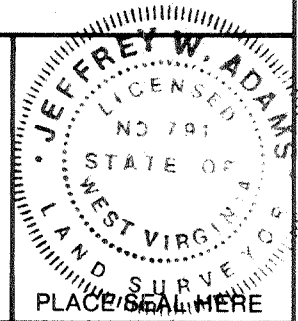

STATE OF WEST VIRGINIA
 Division of Environmental Protection
 OFFICE OF OIL AND GAS



DATE September 29, 19 95
 OPERATOR'S WELL NO. 2050
 API WELL NO. 47-061-01214
 STATE COUNTY PERMIT

WELL TYPE: OIL ___ GAS X LIQUID INJECTION ___ WASTE DISPOSAL ___
 (IF "GAS,") PRODUCTION ___ STORAGE X DEEP ___ SHALLOW ___

LOCATION: ELEVATION 1789 WATER SHED Whiteday Creek
 DISTRICT Clinton COUNTY Monongalia

QUADRANGLE Gladesville 7 1/2' Town NW
 SURFACE OWNER Dorothea Rumble King ACREAGE 41.25
 OIL & GAS ROYALTY OWNER Dorothea R. King & Darlie R. Britton LEASE ACREAGE 41.25 out of 316
 LEASE NO. 5070

PROPOSED WORK: DRILL X CONVERT ___ DRILL DEEPER ___ REDRILL ___ FRACTURE OR STIMULATE ___ PLUG OFF OLD FORMATION ___ PERFORATE NEW FORMATION X OTHER PHYSICAL CHANGE IN WELL (SPECIFY) _____

PLUG AND ABANDON ___ CLEAN OUT AND REPLUG ___
 TARGET FORMATION Huntersville/Chert ESTIMATED DEPTH 8300
 WELL OPERATOR Alamco, Inc. DESIGNATED AGENT Marty Perri
 ADDRESS P.O. Box 1740, Clarksburg, WV 26302-1740 ADDRESS P.O. Box 1740, Clarksburg, WV 26302-1740

DEEP WELL

FORM WW-6

COUNTY NAME PERMIT

State of West Virginia
Division of Environmental Protection
Section of Oil and Gas

Ac 13

Well Operator's Report of Well Work

Farm name: KING Operator Well No.: 912050

LOCATION: Elevation: 1789 Quadrangle: GLADESVILLE 7.5

District: CLINTON County: Monongalia

Latitude: 7650 Feet South of 39 Deg. 30 Min. 00 Sec.

Longitude 11175 Feet West of 79 Deg. 55 Min. 00 Sec.

Company: COLUMBIA NATURAL RESOURCES

	Casing & Tubing	Used in drilling	Left in well	Cement fill up Cu. Ft.
Address: Rt. 1, Box 107-10 Buckhannon, WV 26201				
Agent: Carl F. Starr				
Inspector: Terry Urban				
Date Permit Issued: 07/06/04				
Date Well Work Commenced: 1/10/04				
Date Well Work Completed: 1/31/05				
Verbal Plugging:				
Date Permission granted on:				
Rotary Cable Rig				
Total Depth (feet):				
Fresh Water depths (ft):				
Salt water depths (ft):				
Is coal being mined in area (Y/N)?				
Coal Depths (ft):				

OPEN FLOW DATA

Producing formation Marcellus Shale Pay zone depth (ft) 7594-7620
 Gas: Initial open flow N/A MCF/d Oil: Initial open flow N/A Bbl/d
 Final open flow 74 MCF/d Final open flow N/A Bbl/d
 Time of open flow between initial and final tests N/A Hours
 Static rock Pressure 1940 psig (surface pressure) after 72 Hours

Second producing formation _____ Pay zone depth (ft) _____
 Gas: Initial open flow N/A MCF/d Oil: Initial open flow N/A Bbl/d
 Final open flow _____ MCF/d Final open flow N/A Bbl/d
 Time of open flow between initial and final tests N/A Hours
 Static rock Pressure _____ psig (surface pressure) after _____ Hours

MAR 1 1 2005

NOTE: ON BACK OF THIS FORM PUT THE FOLLOWING: 1). DETAILS OF PERFORATED INTERVALS, FRACTURING OR STIMULATING, PHYSICAL CHANGE, ETC. 2). THE WELL LOG WHICH IS A SYSTEMATIC DETAILED GEOLOGICAL RECORD OF WELL FORMATIONS, INCLUDING COAL ENCOUNTERED BY THE WELLBORE.

Signed: COLUMBIA NATURAL RESOURCES, INC.

By: *Carl Starr*

Date: 2-18-05

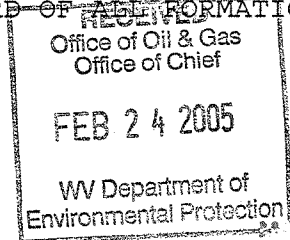

MONO 1214 W

NOV 17 1995

State of West Virginia
 Division of Environmental Protection
 Section of Oil and Gas

Permitting
 Office of Oil & Gas

Well Operator's Report of Well Work

Farm name: KING, DOROTHEA RUMBLE Operator Well No.: 2050

LOCATION: Elevation: 1,789.00 Quadrangle: GLADESVILLE

District: CLINTON County: MONONGALIA
 Latitude: 7650 Feet South of 39 Deg. 30Min. 0 Sec.
 Longitude 11175 Feet West of 79 Deg. 55 Min. 0 Sec.

Company: ALAMCO, INC.
 P. O. BOX 1740
 CLARKSBURG, WV 26302-1740

Agent: MARTY L. PERRI

Inspector: RANDAL MICK
 Permit Issued: 10/02/95
 Well work Commenced: 10/12/95
 Well work Completed: 10/24/95
 Verbal Plugging
 Permission granted on:
 Rotary X Cable _____ Rig
 Total Depth (feet) 8077
 Fresh water depths (ft) 48

Salt water depths (ft) None

Is coal being mined in area (Y/N)? N
 Coal Depths (ft): 169'-173'; 207'-210',
 274'-279'; 360'-365'

Casing & Tubing Size	Used in Drilling	Left in Well	Cement Fill Up Cu. Ft.
16"	20'	-	-
11-3/4"	300'	300'	Cement to Surface 150 Sks.
8-5/8"	2274'	2274'	Cement to Surface 670 Sks.
4-1/2"	-	8023'	165 Sks.

OPEN FLOW DATA

Producing formation Huntersville Chert Pay zone depth (ft) 7658'-7777'
 Gas: Initial open flow 0 MCF/d Oil: Initial open flow 0 Bbl/d
 Final open flow 987 MCF/d Final open flow 0 Bbl/d
 Time of open flow between initial and final tests 4 Hours
 Static rock Pressure 2080 psig (surface pressure) after 72 Hours

Second producing formation _____ Pay zone depth (ft) _____
 Gas: Initial open flow _____ MCF/d Oil: Initial open flow _____ Bbl/d
 Final open flow _____ MCF/d Final open flow _____ Bbl/d
 Time of open flow between initial and final tests _____ Hours
 Static rock Pressure _____ psig (surface pressure) after _____ Hours

NOTE: ON BACK OF THIS FORM PUT THE FOLLOWING: 1). DETAILS OF PERFORATED INTERVALS, FRACTURING OR STIMULATING, PHYSICAL CHANGE, ETC. 2). THE WELL LOG WHICH IS A SYSTEMATIC DETAILED GEOLOGICAL RECORD OF ALL FORMATIONS, INCLUDING COAL ENCOUNTERED BY THE WELLBORE.

For: ALAMCO, INC.

By: R. Mark Harbitt
 Date: 11/15/95

NOV 21 1995

Formations: 0-835' from Drillers Log Book - 835' to TD from Gamma Ray Log

<u>Top</u>	<u>Bottom</u>	<u>Type</u>
0	5	Fill
5	30	SH
30	55	SD & SH
55	70	SD
70	169	SD & SH
169	173	Coal
173	207	SD & SH
207	210	Coal
210	274	SD
274	279	Coal
279	317	SD
317	321	SH
321	360	SD & SH
360	365	Coal
365	420	SD & SH
420	500	SD
500	595	SD & SH
595	615	SH
615	835	SH & RR
835	848	Little Lime
848	872	SH
872	973	Big Lime
973	999	Keener
999	1061	Big Injun
1061	1069	SH
1069	1110	Pocono
1110	1194	SH
1194	1293	Weir
1293	1419	SH
1419	1430	Gantz
1430	1448	SH
1448	1465	50'
1465	1747	SH
1747	1761	Gordon
1761	1948	SH
1948	2004	4th Sand
2004	2037	SH
2037	2052	5th Sand
2052	2084	SH
2084	2121	Bayard Sand
2121	2770	SH
2770	2914	Speechley
2914	7241	Balltown
7241	7541	Tully
7541	7640	Marcellus
7640	7654	Onondaga
7654	7807	Huntersville
7807	7846	Needmore
7846	7857	B. Limestone
7857	7924	Oriskany
7924	8092	Helderberg
	8078	Drlg. TD
	8092	Log TD

Water, Coal, Gas

Water: 1/2" Stream @ 48' Damp @ 465'

Coal:

169' - 173'

207' - 210'

274' - 279'

360' - 365'

Oil: None

Gas Checks:

1002'	N/S
1998'	47 MCF/D
3724'	N/S
4954'	N/S
5954'	N/S
7227'	15 MCF/D
8077'	33 MCF/D

Treatment and Perforations:

Stimulation: 11/06/95

Perforations: (7658-7777')
27 Holes; Huntersville Chert

Frac: WF-30 W/15000# 80/100 Sand
and 6000# 20/40 Sand, 1197 BBLs
Total Fluid w/5% Hcl throughout
60000#

1) Date: September 27, 1995
2) Operator's well number
2050
3) API Well No: 47 - 061 - 1214
State - County - Permit

STATE OF WEST VIRGINIA
DEPARTMENT OF ENERGY, DIVISION OF OIL AND GAS

NOTICE AND APPLICATION FOR A WELL WORK PERMIT

4) Surface Owner(s) to be served:
(a) Name Dorothea Rumble King
Address Route 5, Box 531
Morgantown, WV 26505
(b) Name _____
Address _____
(c) Name _____
Address _____
6) Inspector Randal Mick
Address 111 Blackshere Drive
Mannington, WV 26582
Telephone (304)-986-3324

5) (a) Coal Operator:
Name NO RECORD DECLARATION
Address _____
(b) Coal Owner(s) with Declaration
Name Dorothea R. King
Address Route 5, Box 531
Morgantown, WV 26505
Name Darlie R. Britton
Address Route 9, Box 195
Morgantown, WV 26505
(c) Coal Lessee with Declaration
Name NO RECORD DECLARATION
Address _____

TO THE PERSON(S) NAMED ABOVE TAKE NOTICE THAT:

 Included is the lease or leases or other continuing contract or contracts by which I hold the right to extract oil and gas OR
XX Included is the information required by Chapter 22B, Article 1, Section 8(d) of the Code of West Virginia (see page 2)

I certify that as required under Chapter 22B of the West Virginia Code I have served copies of this notice and application, a location plat, and accompanying documents pages 1 through 11 on the above named parties, by:

- Personal Service (Affidavit attached)
- XX Certified Mail (Postmarked postal receipt attached)
- Publication (Notice of Publication attached)

I have read and understand Chapter 22B and 38 CSR 11-18, and I agree to the terms and conditions of any permit issued under this application.

I certify under penalty of law that I have personally examined and am familiar with the information submitted on this application form and all attachments, and that based on my inquiry of those individuals immediately responsible for obtaining the information, I believe that the information is true, accurate, and complete.

I am aware that there are significant penalties for submitting false information, including the possibility of fine and imprisonment.

Well Operator ADAMCO, INC.
By: W. Marty Lane
Its: Manager, Land
Address P. O. Box 1740
Clarksburg, WV 26302-1740
Telephone 304 623-6671

Subscribed and sworn before me this 27th day of September, 19 95

John M. Coy Notary Public
My commission expires December 9, 2002

21137

061-1214

Issued 10/02/95
Expires 10/02/97

STATE OF WEST VIRGINIA
DEPARTMENT OF ENERGY, DIVISION OF OIL AND GAS
WELL WORK PERMIT APPLICATION

Well Operator: ⁰¹⁰ ALAMCO, INC. 975 (4) 368

Operator's Well Number 2050 3) Elevation: 1789

Well type: (a) OIL ___/ or GAS XX/
(b) If Gas: Production XX/ Underground Storage ___/
Deep XX/ Shallow ___/

- 5) Proposed Target Formation(s): Huntersville Chert⁴⁶³
- 6) Proposed Total Depth: 8,300 feet
- 7) Approximate fresh water strata depths: 20', 240'
- 8) Approximate salt water depths: 1,200', 2,100'
- 9) Approximate coal seam depths: 140', 410'
- 10) Does land contain coal seams tributary to active mine? Yes ___/ No XX/
- 11) Proposed Well Work: SEE ATTACHED

12) CASING AND TUBING PROGRAM
TYPE SPECIFICATIONS FOOTAGE INTERVALS CEMENT

TYPE	SIZE	GRADE	WEIGHT PER FT	FOR DRILLING	LEFT IN WELL	Fill-Up (Cu. Ft.)
CONDUCTOR	11-3/4"	LS	32#	40'	-0-	NONE
FRESH WATER						
COAL						
SURFACE CSG	11"	J-55	32#	300'	300'	As required by 38 CSR 18-11-3 38 CSR 18-11-2
INTERMEDIATE	8-5/8"	J-55	24#	2,295'	2,295'	As required by 38 CSR 18-11-3 38 CSR 18-11-2
PRODUCTION	4-1/2"	M-75	11.60#	7,970'	7,970'	As required by 38 CSR 38-11-1

PACKERS: Kind NONE
Sizes
Depths Set

~~90677
41~~

For Division of Oil and Gas Use Only

- Fee(s) paid: Well Work Permit Reclamation Fund WPCP
- Plat WW-9 WW-2B Bond _____ Agent

WELL OPERATOR ALAMCO, INC.
OPERATOR WELL NO: 2050
FILE NUMBER 47-061- 1214

11. Proposed Well Work:

Well 2050 will be drilled to approximately 2,295' KB. The 8-5/8" casing will be set at approximately 2,295' KB and then cemented to surface. The well will then be drilled to 7,970' KB and the 4-1/2" casing set at approximately 7,970 KB. The 4-1/2" casing will be cemented to 6,600' KB. The well will then be hydraulically fractured in the Huntersville Chert Formation.

12. Plan for partial abandonment: