

LATITUDE 39° 40' 00"

LONGITUDE 08° 02' 00"

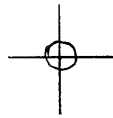

7'5 OGIS topo location

7.5' loc 2.76 S 15' loc _____
 ' 1.19 W (calc.) _____

Company _____

Farm _____

Quad WADESTOWN 7 1/2'

County MONONGALIA

District BATTELLE

WELL LOCATION MAP

File No. 061-0598

Obs 1130 ± (TOPO)

INSTRUCTIONS

- 1) Attach a photo copy of the location of the well on a 7.5 minute Quadrangle with the corresponding Longitude and Latitude.
- 2) Designate the location of the well with the symbol (+).

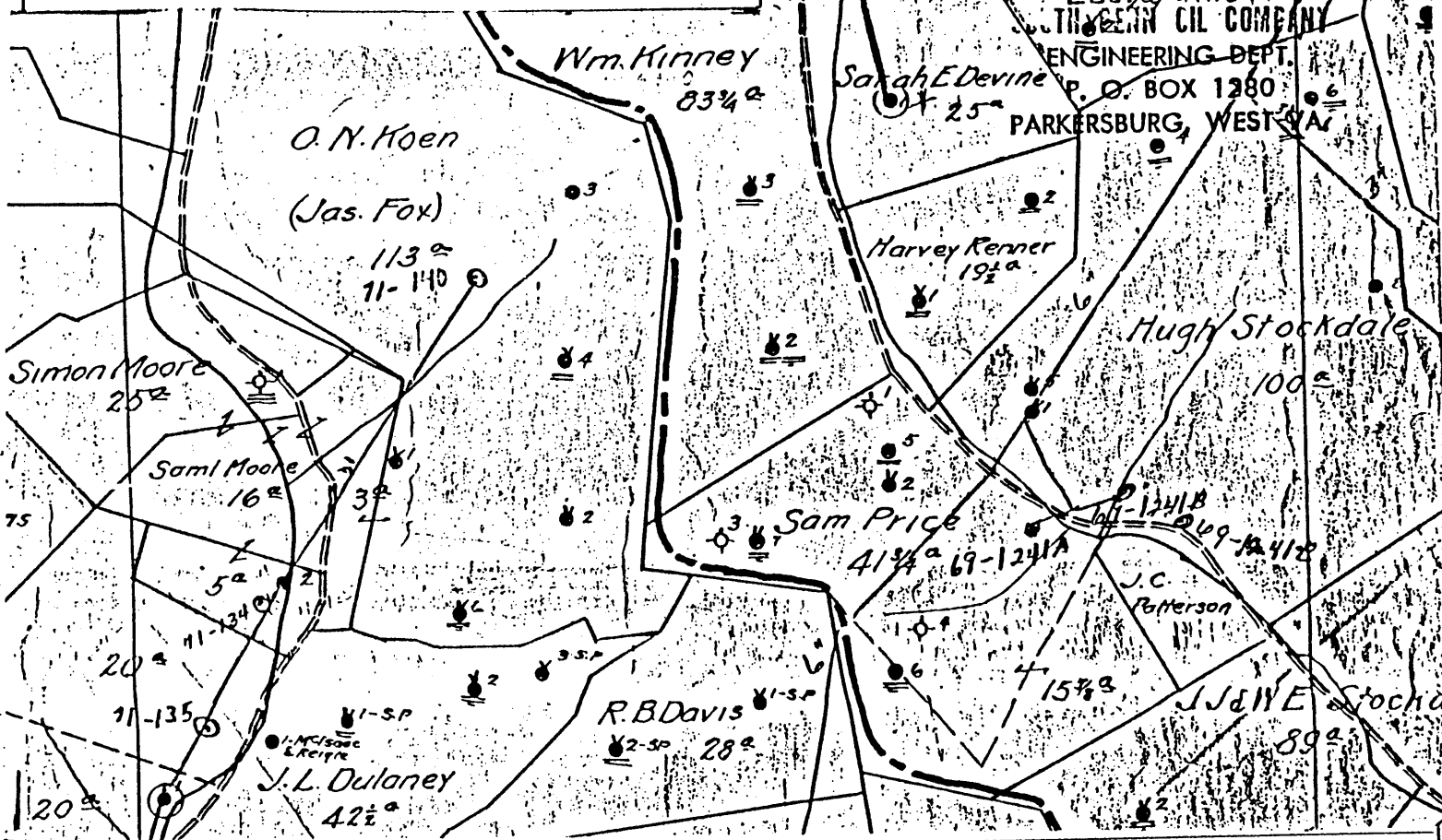

I, the undersigned, Hereby certify that this plat is correct to the best of my knowledge and belief.

SIGNED William R. Ice

TITLE Agent

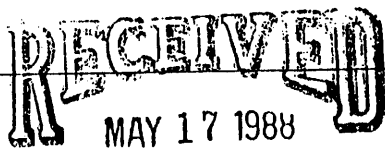

DATE 5-12, 1988

OPERATORS WELL NO 55-0534848-001
Sarah E. Devine H-1
 API WELL NO. 47-61-0598

DIVISION OF OIL & GAS
 DEPARTMENT OF ENERGY

STATE OF WEST VIRGINIA
 DEPARTMENT OF ENERGY
 OIL AND GAS DIVISION

OP - 33350

WELL TYPE: OIL GAS LIQUID INJECTION _____ WASTE DISPOSAL _____
 (IE "GAS" PRODUCTION _____ STORAGE _____ DEEP SHALLOW _____)

LOCATION: ELEVATION N. 12 S. E. 15 W. WATER SHED STREAM FROM ST. LEO INTO DUNKARD
 DISTRICT BATTELLE COUNTY MONONGALIA
 QUADRANGLE _____

SURFACE OWNER Robert Fluharty ACREAGE 120

OIL & GAS ROYALTY OWNER Robert Fluharty LEASE ACREAGE 120
 LEASE NO. 25346

PRODUCING FORMATION Fourth Sand TOTAL DEPTH 3273

WELL OPERATOR Royal E. Mocrex William R. Ice DESIGNATED AGENT William R. Ice

ADDRESS Rt #1, Box 179 ADDRESS Rt #1 Box 179
FAIRVIEW, W.VA. 26570 FAIRVIEW, W.VA. 26570

LATITUDE 39° 40'

LONGITUDE 80° 22' 30"

NORTH

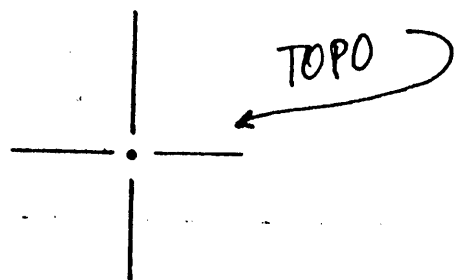
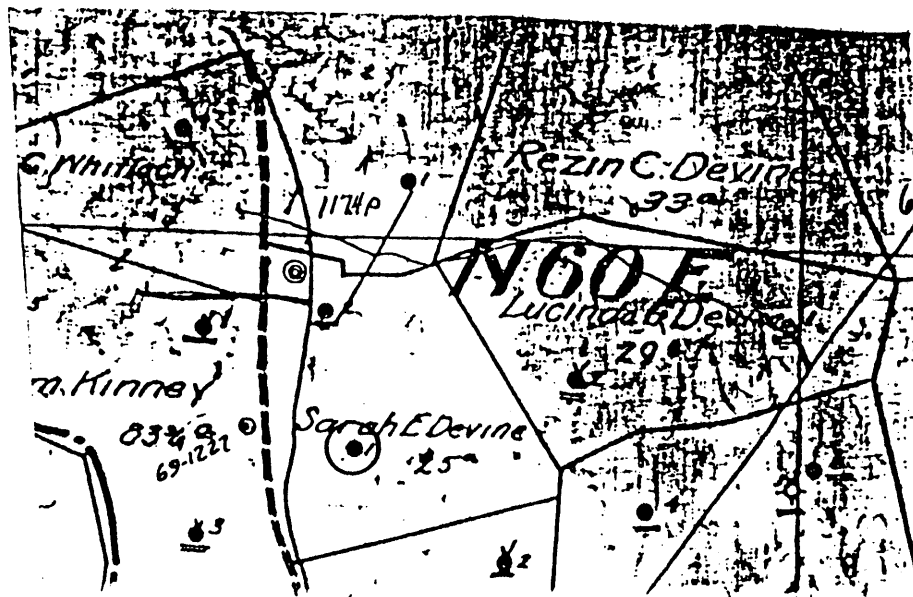

MINIMUM DEGREE OF ACCURACY _____
 PROVEN SOURCE OF ELEVATION _____

BY LAW AND THE REGULATIONS ISSUED AND PRESCRIBED BY THE DEPARTMENT OF MINES.
 (SIGNED) _____

R.P.E. _____ L.L.S. _____

PLACE SEAL HERE

(+) DENOTES LOCATION OF WELL ON UNITED STATES TOPOGRAPHIC MAPS

FORM IV-G
 (8-78)



DATE 7-9, 1979
 OPERATOR'S WELL NO. 1
 API WELL NO. 47-061-598
 STATE COUNTY PERMIT
SARAH E. DEVINE #1

STATE OF WEST VIRGINIA
 DEPARTMENT OF MINES
 OIL AND GAS DIVISION

WELL TYPE: OIL GAS _____ LIQUID INJECTION _____ WASTE DISPOSAL _____
 (IF "GAS", PRODUCTION _____ STORAGE _____ DEEP _____ SHALLOW
 LOCATION: ELEVATION _____ WATER SHED DUNKARD CREEK
 DISTRICT BATTELLE COUNTY MONONGALIA
 QUADRANGLE WADESTOWN 7.5

SURFACE OWNER _____ ACREAGE _____
 OIL & GAS ROYALTY OWNER _____ LEASE NO. _____ LEASE ACREAGE _____

PROPOSED WORK: DRILL _____ CONVERT _____ DRILL DEEPER _____ REDRILL _____ FRACTURE OR STIMULATE _____ PLUS OFF OLD FORMATION _____ PERFORATE NEW FORMATION _____ OTHER PHYSICAL CHANGE IN WELL (SPECIFY) _____

PLUG AND ABANDON _____ CLEAN OUT AND REPLUS _____
 TARGET FORMATION _____ ESTIMATED DEPTH _____
 WELL OPERATOR WILLIAM R. ICE, AGENT DESIGNATED AGENT WILLIAM R. ICE, AGENT
 ADDRESS RT 1 BOX 179 FAIRVIEW, WY 26570 ADDRESS RT 1 BOX 179 FAIRVIEW, WY 26570

Well No. 1 *David E. Kerwin* Farm.
 Lease No. *Battle* District *Monongalia* County.
 Rig built by *A. O. Co*

Well drilled by *Camelau R. Co* Contractor.
 Program drilling *22222* 1906 Completed *Aug 21* 1906

ROCK FORMATION	TOP.	BOTTOM.	REMARKS
<i>Gravel</i>		<i>14</i>	<i>size fine</i>
<i>Working Bone</i>	<i>1010</i>	<i>1015</i>	" "
<i>Big Sandstone</i>	<i>1485</i>	<i>1525</i>	" "
<i>Shale</i>	<i>1685</i>	<i>1785</i>	" "
<i>Sand</i>	<i>1920</i>	<i>1970</i>	" "
<i>Water</i>	<i>1955</i>		" "
<i>Big Sandstone</i>	<i>2250</i>	<i>2300</i>	" "
<i>Prize Sand</i>	<i>2220</i>	<i>2270</i>	" "
<i>Big Sandstone</i>	<i>2290</i>	<i>2475</i>	" "
<i>Big Sandstone</i>	<i>2910</i>	<i>3000</i>	<i>2915</i> "
<i>Shaly "</i>	<i>3020</i>	<i>3031</i>	" "
<i>Sandstone</i>	<i>3169</i>	<i>3200</i>	" "
<i>Oil</i>		<i>3176</i>	" "
<i>Yellows</i>	<i>3228</i>	<i>3235</i>	" "
<i>Sand</i>	<i>3261</i>		" "
<i>Oil in sand</i>		<i>3265</i>	" "
<i>Water</i>		<i>3273 1/2</i>	" "

FOURTH SAND

CASING RECORD.

Size	CHARGED TO WELL		PUT IN WELL		PULLED OUT		LEFT IN WELL		Transferred to Core Completion		Left at Well Not in Use	
	Post	In.	Post	In.	Post	In.	Post	In.	Post	In.	Post	In.
<i>10</i>			<i>350</i>	<i>10</i>	<i>350</i>	<i>10</i>						
<i>8 1/2</i>			<i>1480</i>		<i>1430</i>							
<i>6 3/4</i>			<i>2250</i>									
<i>5 1/2</i>			<i>2405</i>									
<i>4 1/2 x 4</i>			<i>198</i>									

Shot 1/4/13 - 1095'

865.190