

LATITUDE
39° 40' 00"

9.925'

3.025'

WELL #
N TENNANT 4
47-061-00532

NORTH

SURROUNDING WELLS
WITHIN 1200' RADIUS



LONGITUDE 80° 07' 30"

UTM ZONE 17N NAD83 CONUS	LAT/LONG NAD27 CONUS
NORTHING 4,390,180 METERS	39° 39' 29.9" N
EASTING 572,047 METERS	80° 09' 37.2" W

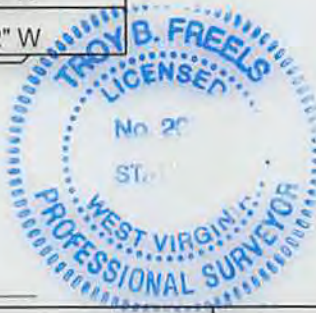

(+) DENOTES LOCATION OF WELL ON UNITED STATES TOPOGRAPHIC MAPS.
 DATE JULY 30, 20 14
 OPERATORS WELL NO. N. TENNANT #4
 API WELL NO. 47 - 061 - 00532 ^P
 STATE COUNTY PERMIT

I THE UNDERSIGNED, HEREBY CERTIFY THAT THIS PLAT IS CORRECT TO THE BEST OF MY KNOWLEDGE AND BELIEF AND SHOWS ALL THE INFORMATION REQUIRED BY LAW AND THE REGULATIONS ISSUED AND PRESCRIBED BY THE DEPARTMENT OF ENVIRONMENTAL PROTECTION.
 P.S. T.B.F.
 2002

MINIMUM DEGREE OF ACCURACY: 1 / 2500 FILE NO.: BLACKSVILLE 9.DWG
 SCALE: 1"=2000'
 PROVEN SOURCE OF ELEVATION: GPS METADATA OR COMPANY NETWORK TIED INTO U.S.G.S.

WV DEP
 OFFICE OF OIL AND GAS
 601 57TH ST., CHARLESTON, WV 25304



WELL TYPE: OIL GAS LIQUID INJECTION WASTE DISPOSAL "GAS" PRODUCTION STORAGE DEEP SHALLOW

LOCATION: ELEVATION: 1178.55' WATERSHED: JAKES RUN OF DUNKARD CREEK
 DISTRICT: CLAY COUNTY: MONONGALIA QUADRANGLE: BLACKSVILLE, WV/PA 7.5'
 SURFACE OWNER: A. KEITH MICHAELS ACREAGE: 206± ACRES
 ROYALTY OWNER: _____ LEASE ACREAGE: _____
 PROPOSED WORK: _____ LEASE NO.: _____
 DRILL: _____ CONVERT: _____ DRILL DEEPER: _____ REDRILL: _____ FRACTURE OR STIMULATE: _____ PLUG OFF OLD: _____
 FORMATION: _____ PERFORATE NEW FORMATION: _____ PLUG AND ABANDON: CLEAN OUT AND REPLUG: _____ OTHER: _____
 PHYSICAL CHANGE IN WELL (SPECIFY): _____ TARGET FORMATION: NONE
 ESTIMATED DEPTH: _____

WELL OPERATOR: CONSOLIDATION COAL COMPANY DESIGNATED AGENT: RONNIE HARSH
 ADDRESS: 1 BRIDGE ST., MONONGAH, WV 26554 ADDRESS: 1 BRIDGE ST., MONONGAH, WV 26554

08/29/2014

61005329

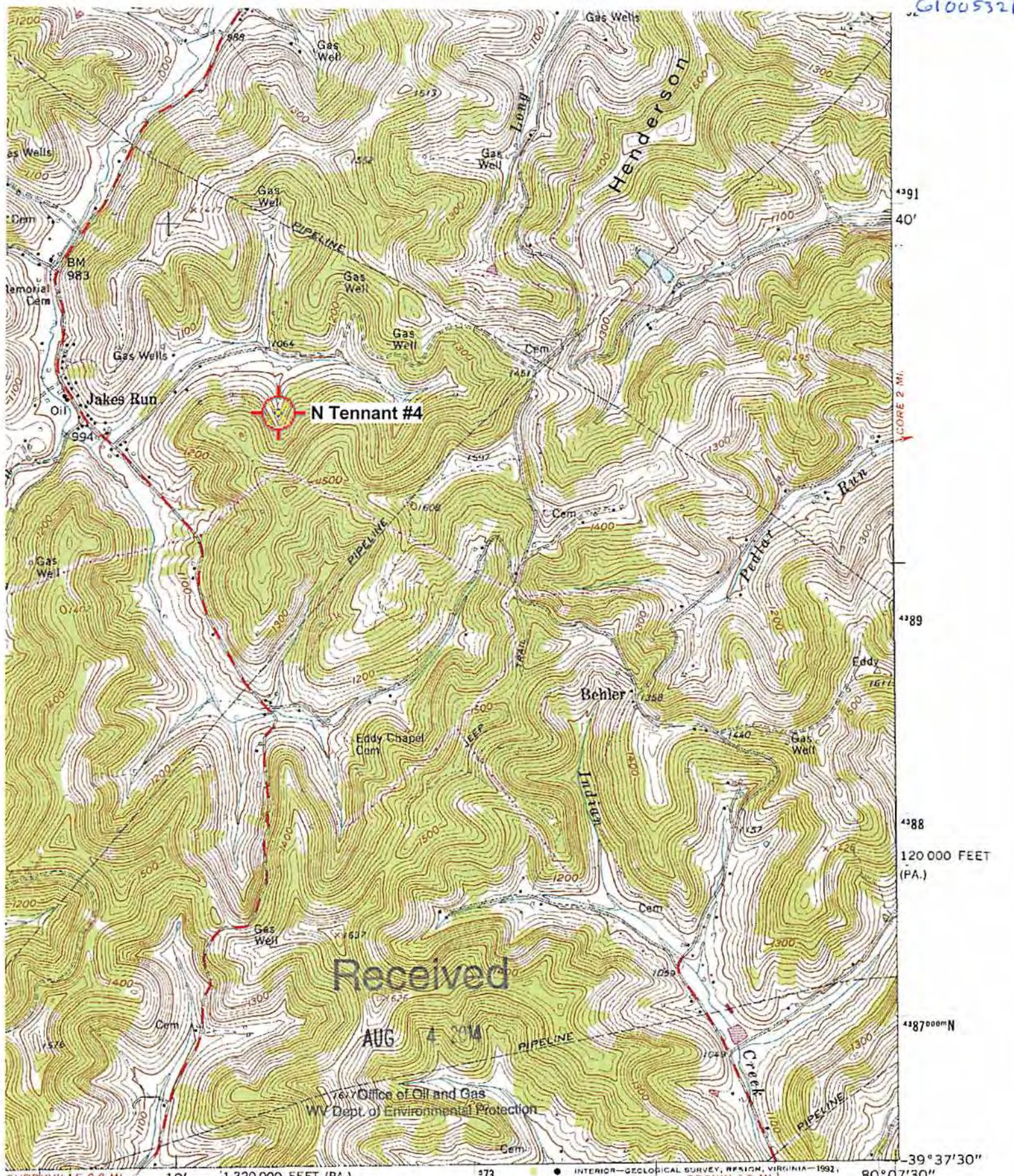

Received

AUG 4 2014

Office of Oil and Gas
WV Dept. of Environmental Protection

CURDYVILLE 0.8 MI.
BAXTER 6.5 MI.



'Blacksville; WV,PA' Scale: 1" = 0.379Mi 610Mt 2,000Ft, 1 Mi = 2.640" , 1 cm = 240Mt

39° 37' 30"
80° 07' 30"
(RIVESVILLE)
5963 II SE