

LATITUDE 39° 40' 00"

00' 51.88" LONGITUDE

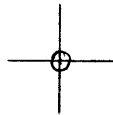

7'5 OGIS topo location

7.5' LOC 2.78 S 15' LOC _____
' 1.73 W (calc.) _____

Company _____

Farm _____

Quad WADESTOWN 7 1/2'

County MONONGALIA

District BATTELLE

WELL LOCATION MAP

File No. 061-0496

Obs 1200 ± (TOPO)

39° 40'

80° 15'

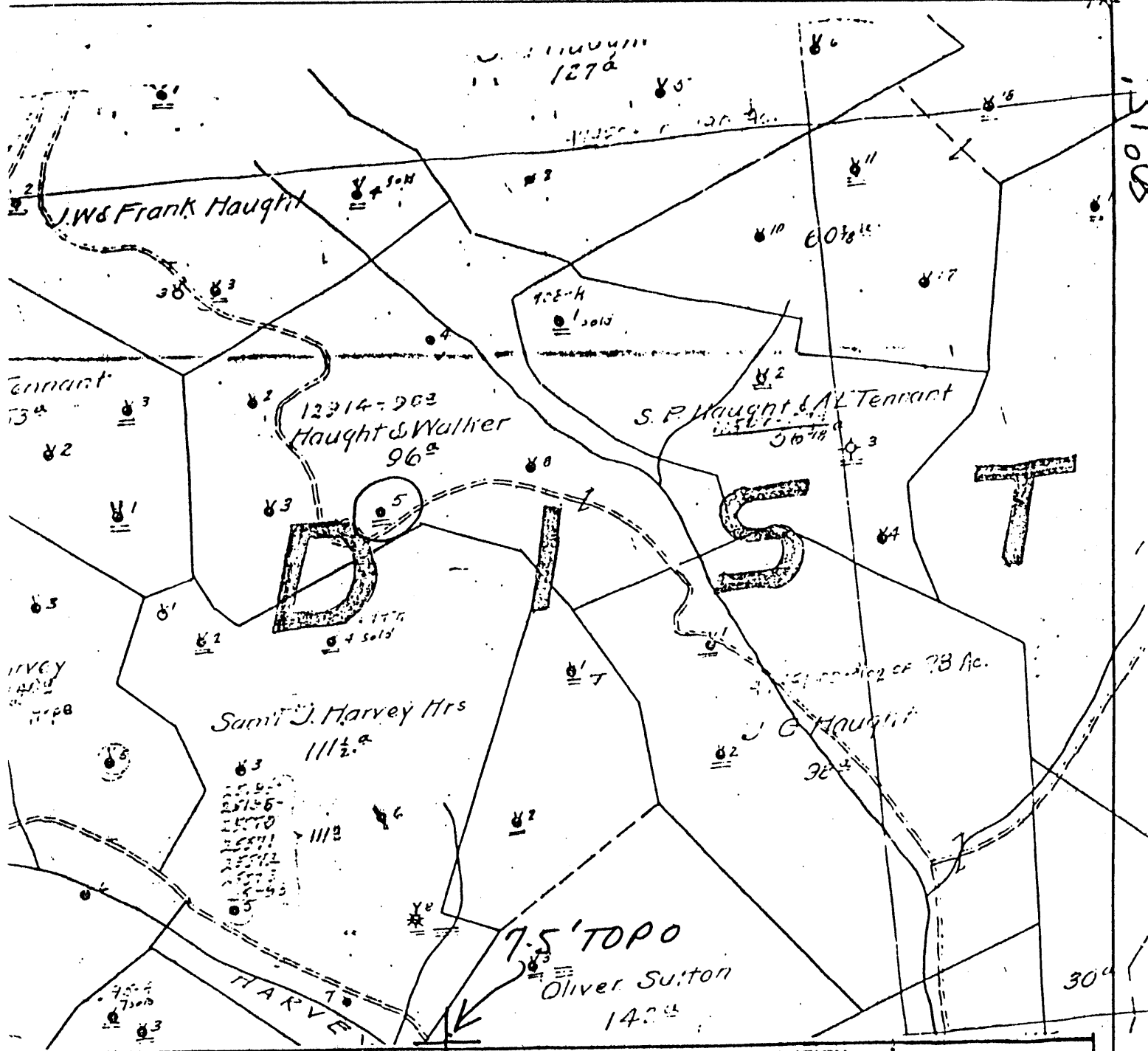

| | | |
|----------------------------------|--|-----------------|
| FILE NO. _____ | I THE UNDERSIGNED, HEREBY CERTIFY THAT THIS PLAT IS CORRECT TO THE BEST OF MY KNOWLEDGE AND BELIEF AND SHOWS ALL THE INFORMATION REQUIRED BY LAW AND THE REGULATIONS ISSUED AND PRESCRIBED BY THE DEPARTMENT OF MINES. (SIGNED) _____ | PLACE SEAL HERE |
| DRAWING NO. _____ | | |
| SCALE _____ | | |
| MINIMUM DEGREE OF ACCURACY _____ | | |
| PROVIN SOURCE OF ELEVATION _____ | | |
| | R.P.E. _____ L.L.S. _____ | |

(+) DENOTES LOCATION OF WELL ON UNITED STATES TOPOGRAPHIC MAPS
FORM IV-B (8-79)

STATE OF WEST VIRGINIA
DEPARTMENT OF MINES
OIL AND GAS DIVISION

DATE 8-27, 1980
OPERATOR'S WELL NO 5
API WELL NO. 47-061-496
STATE COUNTY PERMIT

N-61-E N-12 E-19

WELL TYPE: OIL GAS LIQUID INJECTION _____ WASTE DISPOSAL _____
(IF "GAS", PRODUCTION _____ STORAGE _____ DEEP _____ SHALLOW)

LOCATION: ELEVATION _____ WATER SHED Paw Paw
DISTRICT BATTELLE COUNTY MONONGALIA
QUADRANGLE WADSWORTH, WV 7.5'

SURFACE OWNER _____ ACREAGE _____
OIL & GAS ROYALTY OWNER _____ LEASE ACREAGE _____

LEASE NO. _____

PROPOSED WORK: DRILL _____ CONVERT _____ DRILL DEEPER _____ REDRILL _____ FRACTURE OR STIMULATE _____ PLUG OFF OLD FORMATION _____ PERFORATE NEW FORMATION _____ OTHER PHYSICAL CHANGE IN WELL (SPECIFY) _____

PLUG AND ABANDON _____ CLEAN OUT AND REPLUG _____

TARGET FORMATION _____ ESTIMATED DEPTH _____

WELL OPERATOR _____ DESIGNATED AGENT JAMES A. CREWS
ADDRESS PENNZOIL COMPANY ADDRESS PENNZOIL COMPANY
P. O. DRAWER 1588 P. O. DRAWER 1588
PARKERSBURG, W. VA 26101 PARKERSBURG, W. VA. 26101

UNRECORDED #C

NO. 1

SOUTH PENN OIL COMPANY—COMPLETION

SERIAL NO. _____ FARM Haight & Walker WELL NO. 5
 ELEVATION _____ N. 12 S. _____ E. 19 W. _____
 LEASE NO. _____ ACRES _____
 WATERS OF Paw Paw
 DISTRICT Battelle COUNTY Monongalia STATE W. Va.
 DRILLING COMMENCED 5/24/1898 COMPLETED 8/20/1898 DEPTH 3142

| SANDS | TOP | BOTTOM | ELEV. TOP | CASING USED |
|------------------------|------|--------|-----------|-----------------------|
| PGH. COAL OR BIG LIME- | 905 | | | 10" 220 |
| Big Injun | 2215 | 2365 | | 8 1/2" 1446 |
| 1st. pay-Good | 2285 | | | 6 5/8" 1884 |
| Gordon | 3115 | 3156 | | 5 3/16" 2356 |
| 1st. pay | 3136 | | | 4X4 1/2" 302 |
| Fourth | 3159 | | | PACKERS AND DEPTH SET |
| Oil-1st. | 3167 | | | |

INITIAL PROD. No record SAND Gordon DEPTH 3136
 GAS TEST No " Fourth " 3173

SHOT 1 QUARTS 20
 REMARKS D.D. Gordon to Fourth June 1915. Second pay in Fourth at 3173. Total depth 3186'.

REPORTED BY [Signature] ABANDONED _____

3186
 3136
 44

061-496