

39° 37' 30" LATITUDE

80° 12' 30" LONGITUDE

7'5 OGIS topo location

7.5' loc 0.015 15' loc _____
' 0.52W (calc.) _____

Company _____

Farm _____

Quad GRANT TOWN 7 1/2'

County MONONGALIA

District CLAY

WELL LOCATION MAP

File No. OGI-0456

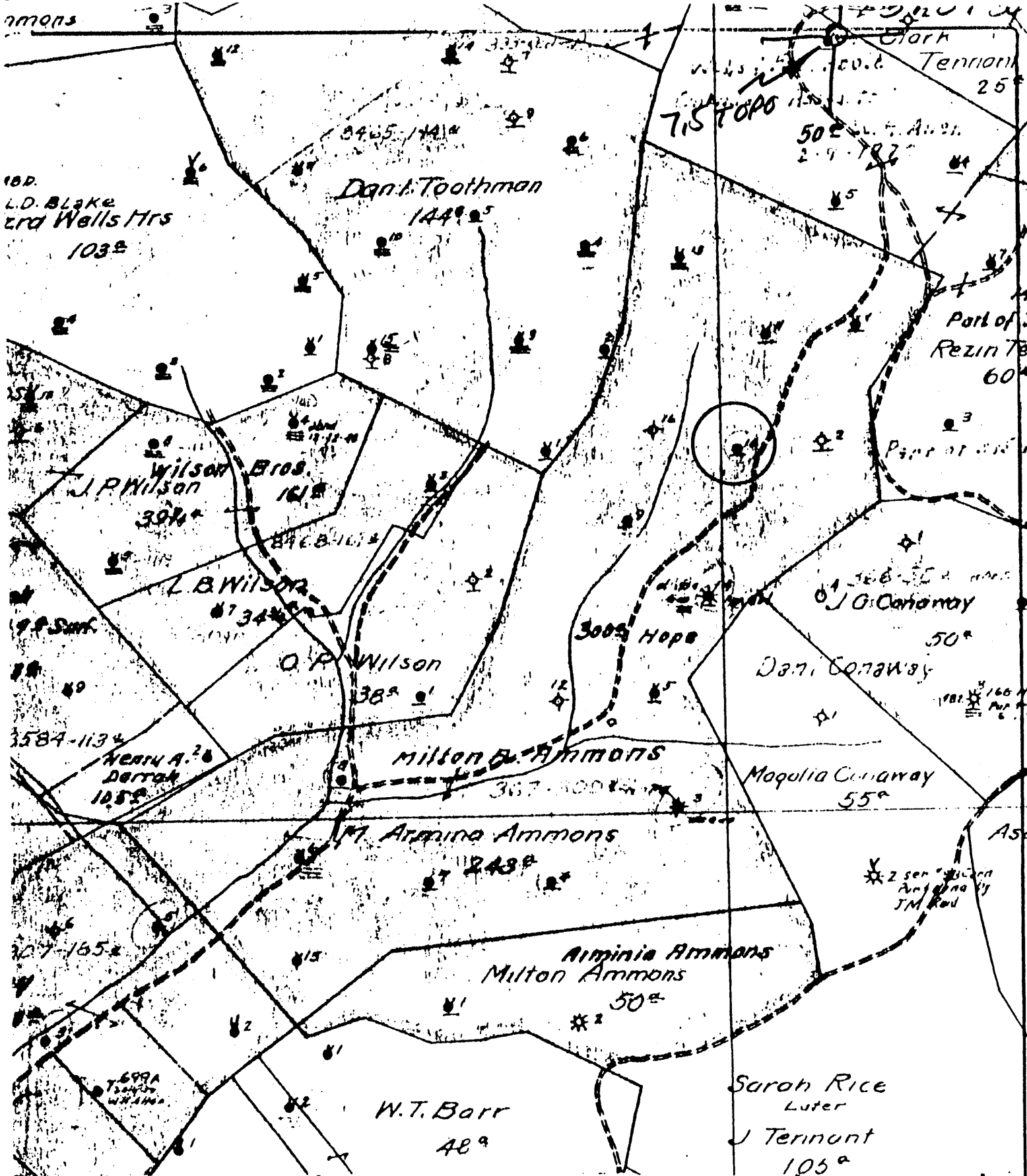

+) DENOTES LOCATION OF WELL ON UNITED STATES TOPOGRAPHIC MAPS

FORM IV-6

(8-78)

V6ZEN11E22



STATE OF WEST VIRGINIA
DEPARTMENT OF MINES
OIL AND GAS DIVISION

WELL TYPE: OIL GAS LIQUID INJECTION WASTE DISPOSAL
(IF "GAS", PRODUCTION STORAGE DEEP SHALLOW
LOCATION: ELEVATION 1240 WATER SHED BENNEFIELD PRONG
DISTRICT CLAY COUNTY MONONGALIA
QUADRANGLE GRANT TOWN 7.5'

SURFACE OWNER _____ ACREAGE _____
OIL & GAS ROYALTY OWNER _____ LEASE ACREAGE _____
LEASE NO. _____

PROPOSED WORK: DRILL CONVERT DRILL DEEPER REDRILL FRACTURE OR STIMULATE PLUS OFF OLD FORMATION PERFORATE NEW FORMATION OTHER PHYSICAL CHANGE IN WELL (SPECIFY) _____

PLUG AND ABANDON CLEAN OUT AND REPLUG
TARGET FORMATION _____ ESTIMATED DEPTH _____
WELL OPERATOR Pennzoil Company DESIGNATED AGENT James A. Crews
ADDRESS P. O. Box 1588 ADDRESS P. O. Box 1588
Parkersburg, WV 26101 Parkersburg, WV 26101

DATE 1-24-1979
OPERATOR'S WELL NO. 10
API WELL NO. _____
47-061-0456
STATE COUNTY PERMIT

M.A. Ammons-10

Well No. **10** *M. Commons* Farm.
 Lease No. District *Monong.* County.
 Rig built by Contractor.
 Well drilled by
 Began drilling *July 14 1894* Completed *June 24 1894*

ROCK FORMATION	TOP	BOTTOM	S. L. M.	REMARKS
<i>Pgh. Coal.</i>	<i>710</i>			<i>ft. 1241.49</i>
<i>Big Spring</i>	<i>2000</i>			<i>ft. 1240.17</i>
<i>1st pay</i>	<i>2097</i>			
<i>2nd pay</i>	<i>2111</i>			
<i>Total depth</i>		<i>2136</i>		

CASING RECORD

Size	CHARGED TO WELL		PUT IN WELL		PULLED OUT		LEFT IN WELL		Transferred before Completion		Left at Well Not in Use	
	Feet	In.	Feet	In.	Feet	In.	Feet	In.	Feet	In.	Feet	In.
<i>10</i>	<i>735</i>											
<i>8 1/4</i>	<i>845</i>											
<i>6 3/8</i>	<i>1740</i>											
<i>5 3/16</i>	<i>295</i>											

Production }
 First 24 Hours } Bbls. Signed Dept.

47-061-0456