

LATITUDE 39° 37' 30"

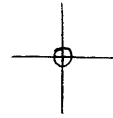

80° 12' 30" LONGITUDE

7'5 OGIS topo location

7.5' loc 0.51 S
' 0.72 W

15' loc _____
(calc.) _____

Company _____

Farm _____

Quad GRANT TOWN 7 1/2'

County MONONGALIA

District CLAY

WELL LOCATION MAP

File No. OG1-0452

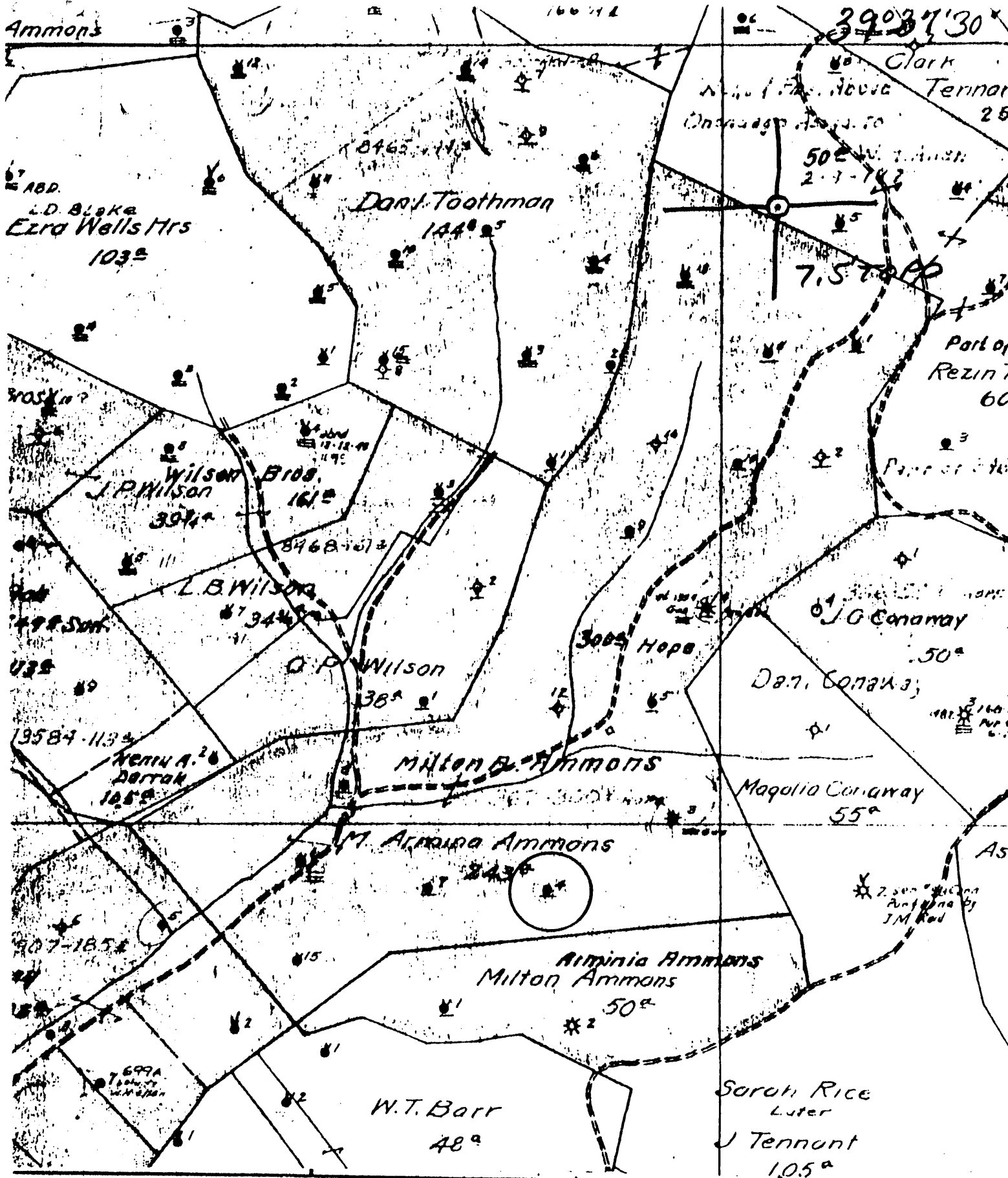

(+) DENOTES LOCATION OF WELL ON UNITED STATES TOPOGRAPHIC MAPS

FORM IV-6 (8-78)

162E N11E22



STATE OF WEST VIRGINIA DEPARTMENT OF MINES OIL AND GAS DIVISION

DATE 1-24-1979
 OPERATOR'S WELL NO. 4
 API WELL NO. 47-061-0452
 STATE COUNTY PERMIT

WELL TYPE: OIL GAS LIQUID INJECTION WASTE DISPOSAL
 (IF "GAS", PRODUCTION STORAGE DEEP SHALLOW
 LOCATION: ELEVATION 1232 WATER SHED BENNEFIELD PRONG
 DISTRICT CLAY COUNTY MONONGALIA
 QUADRANGLE GRANT TOWN 7.51

SURFACE OWNER _____ ACREAGE _____
 OIL & GAS ROYALTY OWNER _____ LEASE ACREAGE _____
 LEASE NO. _____

PROPOSED WORK: DRILL CONVERT DRILL DEEPER REDRILL FRACTURE OR STIMULATE PLUS OFF OLD FORMATION PERFORATE NEW FORMATION OTHER PHYSICAL CHANGE IN WELL (SPECIFY) _____

PLUS AND ABANDON CLEAN OUT AND REPLUS
 TARGET FORMATION _____ ESTIMATED DEPTH _____
 WELL OPERATOR Pennzoil Company DESIGNATED AGENT James A. Crews
 ADDRESS P. O. Box 1588 ADDRESS P. O. Box 1588
 Parkersburg, WV 26101 Parkersburg, WV 26101

N.A. Ammons - 4

Well No. *4* *M. A. Ammons* Farm _____ Acres _____
 Lease No. _____ District _____ County *Wingfield* State *W. Va.*
 Contractor _____
 Drilling Commenced *Feb 21 1893* Drilling Completed *May 6 1893*
 N. S. E. W.

ROCK FORMATION	TOP	BOTTOM	Steel Line Measurement	REMARKS
<i>Off. Coal</i>	<i>660</i>			<i>Elev. Ft. 1285.10</i>
<i>Red Limestone</i>	<i>1970</i>			<i>gd. 1237.70</i>
<i>1st Fly</i>	<i>2056</i>			
<i>2nd Fly</i>	<i>2066</i>			
<i>Total depth</i>			<i>2089</i> <i>2095</i>	

Casing Pulled 10" - 715'

CASING RECORD AS TALLIED. NOT STEEL LINE MEASUREMENT

SIZE	PUT IN WELL		PULLED OUT		LEFT IN WELL		Shot Date	Amount Sand Result	Packer Size	Depth Set
	FEET	IN.	FEET	IN.	FEET	IN.				
<i>10</i>	<i>715</i>									
<i>8 1/4</i>	<i>784</i>									
<i>6 5/8</i>	<i>1675</i>									
<i>5 3/16</i>	<i>286</i>									

Production First 24 Hours Bbls. Gas Test.....

Approved by..... Superintendent.