

N/F
Monongahela Power Co.

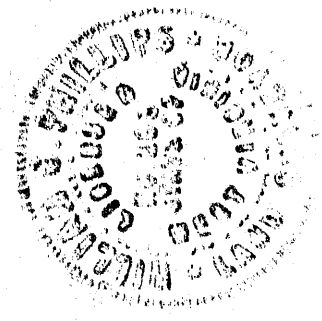

COAL OWNED BY Consolidation Coal Co. Inc. Osage, W. Va.

- NEW LOCATION
- RECONDITION
- DRILL DEEPER
- ABANDONMENT

"I, the undersigned, hereby certify that this map is correct to the best of my knowledge and belief and shows all the information required by paragraph 6 of the rules and regulations of the oil and gas section of the mining laws of West Virginia."
Minimum degree of accuracy is one part in 2500

Signed William G. Phillips

COMPANY	Keystone Gas Co.
ADDRESS	Mellon Bank Bldg. — Cantonburg, Pa.
FARM	Monongahela Power Co.
MAP	ACRES <u>350.86</u> LEASE NO.
WELL (FARM) NO.	<u>18</u> SERIAL NO.
ELEVATION (SPIRIT LEVEL)	<u>1102.20</u>
QUADRANGLE	<u>Morgantown, W. Va. — Pa. NW</u>
COUNTY	<u>Monongalia</u> DISTRICT <u>Cass</u>
POINT OF PROVEN ELEVATION	<u>Floor Elev. of sub station top of hill near Fort Martindale Power Plant</u>
FILE NO.	DRAWING NO.
DATE <u>March 17, 1972</u>	SCALE <u>1" = 1000'</u>

STATE OF WEST VIRGINIA
DEPARTMENT OF MINES
OIL AND GAS DIVISION
CHARLESTON
WELL LOCATION MAP
FILE NO. Mon-330-DD

+ DENOTES LOCATION OF WELL ON UNITED STATES TOPOGRAPHIC MAPS, SCALE 1 TO 62,500, LATITUDE AND LONGITUDE LINES BEING REPRESENTED BY BORDER LINES AS SHOWN.
— DENOTES ONE INCH SPACES ON BORDER LINE OF ORIGINAL TRACING.

0 1 2 3

LATITUDE 39° 45'

1

2

3



79

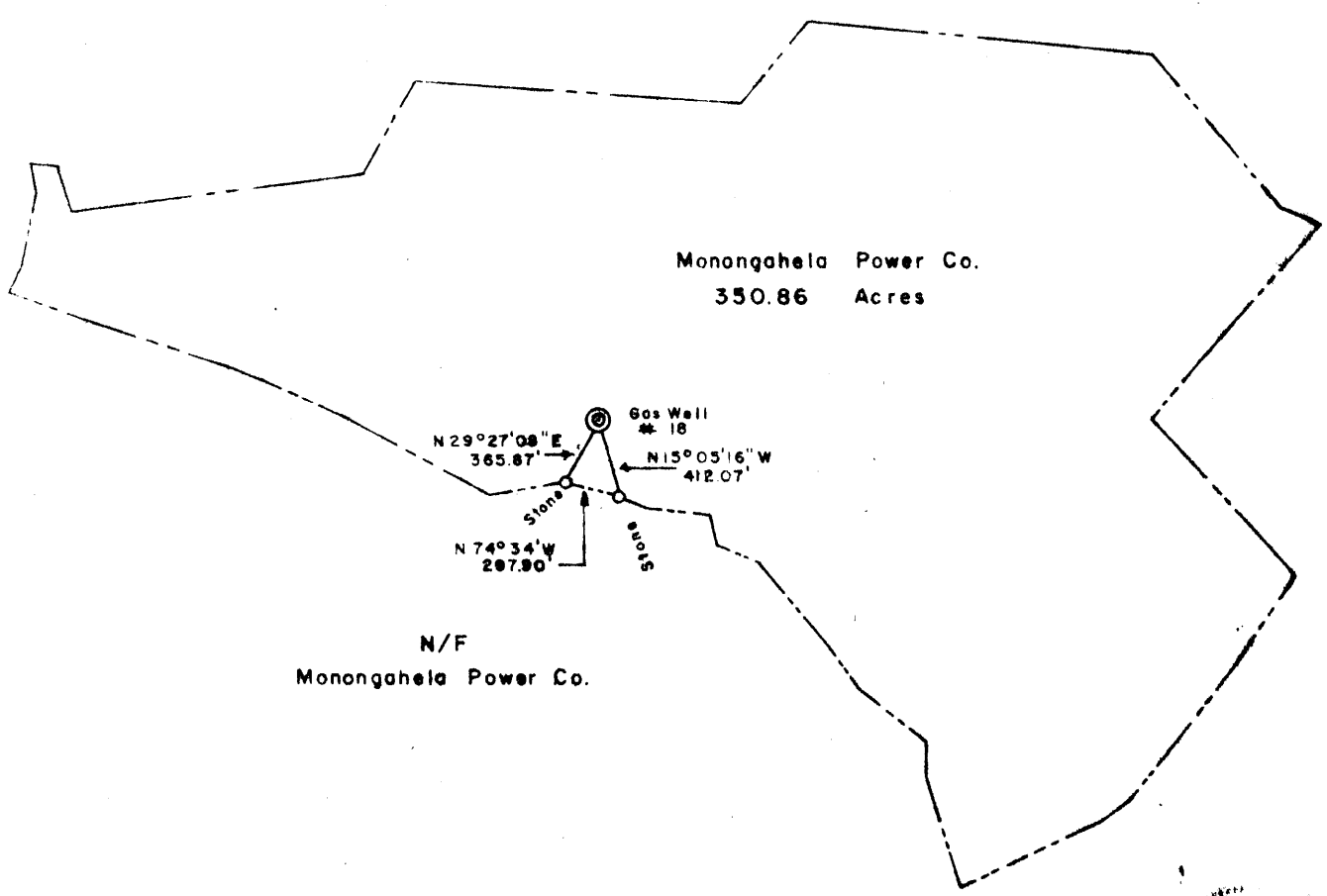

COAL OWNED BY Consolidation Coal Co. Inc. Cass, W. Va.

- NEW LOCATION
- RECONDITION
- ~~ABANDONMENT~~
- ABANDONMENT - 5-19-92

"I, the undersigned, hereby certify that this map is correct to the best of my knowledge and belief and shows all the information required by paragraph 6 of the rules and regulations of the oil and gas section of the mining laws of West Virginia."
 Minimum degree of accuracy is one part in 2500

Signed William S. Phillips

COMPANY	Keystone Gas Co.
ADDRESS	Mellon Bank Bldg. - Canonsburg, Pa.
FARM	Monongahela Power Co.
MAP	ACRES 350.86 LEASE NO.
WELL (FARM) NO.	18 SERIAL NO.
ELEVATION (SPIRIT LEVEL)	1102.29
QUADRANGLE	Morgantown, W. Va. - Pa. NW
COUNTY	Monongalia DISTRICT Cass
POINT OF PROVEN ELEVATION	Floor Elev. of sub station top of hill near Fort Martin Power Plant
FILE NO.	DRAWING NO.
DATE	March 17, 1972 SCALE 1" = 1000'

STATE OF WEST VIRGINIA
 DEPARTMENT OF MINES
 OIL AND GAS DIVISION
 CHARLESTON
WELL LOCATION MAP
 File No. Mon-330-207

+ DENOTES LOCATION OF WELL ON UNITED STATES TOPOGRAPHIC MAPS, SCALE 1 TO 62,500. LATITUDE AND LONGITUDE BEING REPRESENTED BY BORDER LINES AS SHOWN.

- DENOTES ONE INCH SPACES ON BORDER LINES OF MAPS.

MAY 30 1972



RECEIVED
MAY 15 1972

STATE OF WEST VIRGINIA
DEPARTMENT OF MINES
Oil and Gas Division

OIL & GAS DIVISION
DEPT. OF MINES

WELL RECORD

Rotary _____ Oil _____
Cable Gas _____
Recycling _____ Comb. _____
Water Flood _____ Storage _____
Disposal _____ **Dry** (Kind) _____

Quadrangle Morgantown 15'
Permit No. 330 DD

Company <u>Keystone Gas Company</u>	Casing and Tubing	Used in Drilling	Left in Well	Cement fill up Cu. ft. (Sks.)
Address <u>Mellon Bk. Bldg, Canonsburg, Pa.</u>	Size			
Farm (formerly) <u>M.J. Garlow Acres 350.86</u>	20 1/2			
Location (waters) <u>Monongahela River</u>	Cond.			
Well No. <u>18</u> Elev. <u>1102.2</u>	13 10"	60'		
District <u>Cass</u> County <u>Monongahela</u>	9 5/8			
The surface of tract is owned in fee by <u>Monongahela Power Company</u>	8 5/8	843'		
Address <u>Fairmont</u>	XX 6 5/8	1202'		
Mineral rights are owned by <u>J. Floyd Garlow Est.</u> Address <u>Clarksburg, W. Va.</u>	5 1/2	1268'		
Drilling Commenced <u>April 14, 1972</u>	4 1/2			
Drilling Completed <u>May 3, 1972</u>	3			
Initial open flow <u>TSTM</u> cu. ft. _____ bbls.	2			
Final production _____ cu. ft. per day _____ bbls.	Liners Used			
Well open _____ hrs. before test _____ RP.				
Well treatment details: <u>None</u>	Attach copy of cementing record.	None		

Coal was encountered at 530 Feet _____ Inches
Fresh water 405 Feet _____ Salt Water 842, 1436 Feet _____
Producing Sand None Depth _____

Formation	Color	Hard or Soft	Top Feet	Bottom Feet	Oil, Gas or Water	* Remarks
			0	<u>1426</u>		See original log. Slight amount of gas coming from Big Injun. <u>Corrected depth</u>
Sand, light			<u>1400</u>	1425		
Slate & shells, gray			1425	1436		
<input checked="" type="checkbox"/> Sand, gray - <u>sharp</u>			1436	1445	Water	
Slate & Shells, gray			1445	1487		
<input checked="" type="checkbox"/> Sand, gray - <u>hard</u>			1487	1603		
Slate & shells, gray			1603	1660		
Sand			1660	1685		
Slate & lime shells, gray			1685	1749		
<input checked="" type="checkbox"/> Sand, gray			1749	1780	Berea	
Slate & lime shells, gray			1780	1830		
<input checked="" type="checkbox"/> Sand, gray - <u>hard</u>			1830	1885	G antz	
Slate & lime shells			1885	1894		
<input checked="" type="checkbox"/> Sand, gray, <u>sharp</u>			1894	1954	Fifty foot	
Slate and shells, gray			1954	2024		
Red rock			2024	2051		
<input checked="" type="checkbox"/> Sand, light gray <u>sharp</u>			2051	2064		
Slate & lime, gray			2064	2076		
Red rock and lime shells			2076	2253		

(over)

* Indicates Electric Log tops in the remarks section.

MAY 22 1972

Formation	Color	Hard or Soft	Top Feet	Bottom Feet	Oil, Gas or Water	* Remarks
✓ Sand, gray, hard			2253	2265	Fifth	(Mon -325 prod. from 5 th sd.)
Red rock and sand shells			2265	2312		
Sand, pink			2312	2335		
✓ Sand, gray			2335	2355	Bayard	
Slate and shells, gray			2355	2377		
✓ Sand, gray, hard			2377	2407	Elizabeth	
Slate and shells, gray			2407	2649		
Lime and shells, gray			2649	2768		
Gritty lime and shells, gray			2768	2879		
Slate and lime shells, gray			2879	2909		
Gritty lime shells, gray			2909	3002		
Lime shells and slate, gray			3002	3058	Total depth	Speechley? (T.D. at approx. Speechley ~ 3015-303)
Originally Drilled - 1922			to TD. 1400'			
Well No. 12922 (Marshall)			J. Garlow)			

3058
1400
1658' new
footage

Date May 12 1972

APPROVED *W. K. Campbell* Owner
PRESIDENT

By

(Title)



STATE OF WEST VIRGINIA
DEPARTMENT OF MINES

RECEIVED
APR 10 1972
OIL & GAS
DEPT. OF MINES

Oil and Gas Division

OIL AND GAS WELL PERMIT APPLICATION

TO THE DEPARTMENT OF MINES,
Charleston, W. Va.

DATE April 7, 1972

Surface Owner Monongahela Power Co.
Address Fairmont, West Va. 26550
Mineral Owner J. Floyd Garlow Estate
Union National Bank
Address Clarksburg, West Va. 26301
Coal Owner Consolidation Coal Co.
Christopher Coal Div.
Address Osage, West Virginia 26543
Coal Operator _____
Address _____

Company Keystone Gas Company
Address Mellon Bank Bldg, Canonsburg, Pa.
* Farm Monongahela Power Co Acres 350.86
Location (waters) Monongahela River
Well No. 18 Elevation 1102.2**
District Cass County Monongalia
Quadrangle Morgantown (15')

*formerly M. J. Garlow
**current survey

THIS PERMIT MUST BE POSTED AT THE WELL SITE

All provisions being in accordance with Chapter 22, of the W. Va. Code, the location is hereby approved for deepening. This permit shall expire if operations have not commenced by August 14, 1972.

INSPECTOR TO BE NOTIFIED Mr. Wm. Blosser
Box 24 Fairmont PH: 362-9105
Calgary W.Va. 26566

Robert K. Erdel
Deputy Director - Oil & Gas Division

GENTLEMEN:

The undersigned well operator is entitled to drill upon the above named farm or tract of land for oil and gas, having fee title thereto, (or as the case may be) under grant or lease dated December 8, 19 21 by Marshall J. and Eva C. Garlow made to Morton Van Voorhis and recorded on the 28th day of November 19 27, in Monongalia County, Book 218 Page 416

NEW WELL DRILL DEEPER REDRILL FRACTURE OR STIMULATE
 OIL AND GAS WELL ORIGINALLY DRILLED BEFORE JUNE 5, 1969.
Gas well originally drilled in 1922, no permit number.

The enclosed plat was prepared by a registered engineer or licensed land surveyor and all coal owners and/or operators have been notified as of the above date.

The above named coal owners and/or operator are hereby notified that any objection they wish to make, or are required to make by Section 3 of the Code, must be received by, or filed with the Department of Mines within ten (10) days. *

Copies of this notice and the enclosed plat were mailed by registered mail, ~~or delivered~~ to the above named coal operators or coal owners at their above shown respective address ~~day~~ ~~boxes~~ on the same day with the mailing or delivery of this copy to the Department of Mines at Charleston, West Virginia.

Very truly yours,
(Sign Name) Robert K. Erdel President

Well Operator
Keystone Gas Company
Mellon Bank Building
Street
Canonsburg, Pennsylvania
City or Town
State

*SECTION 3 If no objections are filed or found by the Department of mines, within said period of ten days from the receipt of notice and plat by the department of mines, to said proposed location, the department shall forthwith issue to the well operator a permit reciting the filing of such plat, that no objections have been made by the coal operators or found thereto by the department and that the same is approved and the well operator authorized to proceed.

Mon-330-00 PERMIT NUMBER
Shaw

**THIS IS AN ESTIMATE ONLY
ACTUAL INFORMATION WILL BE SUBMITTED ON OG-10 UPON COMPLETION**

PROPOSED WORK ORDER TO _____ DRILL _____ DEEPEN _____ FRACTURE-STIMULATE _____
 DRILLING CONTRACTOR: (If Known) RESPONSIBLE AGENT:
 NAME Keystone Gas Company NAME Melvin Peluchetti
 ADDRESS Canonsburg, Pa. ADDRESS 415 N. Front St.-Wheeling, W. Va
 TELEPHONE (412) 745-4130 TELEPHONE (304) 232-8336
 ESTIMATED DEPTH OF COMPLETED WELL: 3100' ROTARY _____ CABLE TOOLS
 PROPOSED GEOLOGICAL FORMATION: Speechley
 TYPE OF WELL: OIL _____ GAS COMB. _____ STORAGE _____ DISPOSAL _____
 RECYCLING _____ WATER FLOOD _____ OTHER _____

TENTATIVE CASING PROGRAM:

CASING AND TUBING SIZE	USED FOR DRILLING	LEFT IN WELL	CEMENT FILL UP OR SACKS - CUBIC FT.
20 - 16			
13 - 10	60	-	
9 - 5/8			
8 - 5/8	843	843	
<input checked="" type="checkbox"/> 6-5/8	1202	1202	
5 1/2	1268	1268	
4 1/2			
3			Perf. Top
2			Perf. Bottom
Liners			Perf. Top
			Perf. Bottom

APPROXIMATE FRESH WATER DEPTHS 405 FEET SALT WATER 842 FEET
 APPROXIMATE COAL DEPTHS 530
 IS COAL BEING MINED IN THE AREA? No BY WHOM? _____

TO DRILL:

SUBMIT FIVE (5) COPIES OF OG - 1, \$100.00 PERMIT FEE, PERFORMANCE BOND AND PERMANENT COPY OF PLAT.

TO DRILL DEEPER OR REDRILL:

SUBMIT FIVE (5) COPIES OF OG - 1, SHOWING ORIGINAL PERMIT NUMBER AND PERFORMANCE BOND. ON WELLS DRILLED PRIOR TO 1929, A PERMANENT COPY OF THE PLAT AND THE ORIGINAL WELL RECORD MUST ALSO BE SUBMITTED.

TO FRACTURE - STIMULATE:

OIL AND/OR GAS WELL ORIGINALLY DRILLED BEFORE JUNE 5, 1929, FIVE (5) COPIES OG - 1, PERFORMANCE BOND, PERMANENT PLAT AND ORIGINAL WELL RECORD.

OIL AND/OR GAS WELL ORIGINALLY DRILLED ON AND/OR AFTER JUNE 5, 1929, FIVE COPIES OG - 1, SHOWING ORIGINAL PERMIT NUMBER, AND PERFORMANCE BOND.

Required forms must be filed within ninety (90) days of completion for bond release. Inspector to be notified twenty-four (24) hours in advance.

The following waiver must be completed by the coal operator if the permit is to be issued within ten days of receipt thereof.

WAIVER: I the undersigned, Agent for Consolidation Coal Company, Owner or Operator of the coal under this lease have examined and place on our mine maps this proposed well location.

We the Consolidation Coal Company have no objections to said well being drilled at this location, providing operator has complied with all rules and regulations in Articles 4, 5, and 7, Chapter 22 of the West Virginia Code.

For Coal Company

Official Title

STATE OF WEST VIRGINIA
DEPARTMENT OF MINES
OIL AND GAS WELLS DIVISION

AFFIDAVIT OF PLUGGING AND FILLING WELL

AFFIDAVIT SHOULD BE MADE IN TRIPLICATE, ONE COPY MAILED TO THE DEPARTMENT, ONE COPY TO BE RETAINED BY THE WELL OPERATOR AND THE THIRD COPY (AND EXTRA COPIES IF REQUIRED) SHOULD BE MAILED TO EACH COAL OPERATOR AT THEIR RESPECTIVE

ADDRESSES
 Coal Operator: Compton Coal Co.
Christiansburg, Va.
 Coal Operator or Owner: Osage, West Virginia
 Address: Attn: Mr. Frank Burchinal

NAME OF WELL OPERATOR
Sellen National Bank Building
Canonsburg, Pennsylvania
 COMPLETE ADDRESS: JUNE 19 1972

WELL AND LOCATION
 District: Class
 County: Monongalia
 Well No.: 18
Monongahela Power Company
Formerly M. L. Garlow Farm

COAL OPERATOR OR OWNER
 ADDRESS

LEASE OR PROPERTY OWNER
 ADDRESS

STATE INSPECTOR SUPERVISING PLUGGING: William Blosser, Colfax, W. Va.

AFFIDAVIT

STATE OF WEST VIRGINIA,
 County of _____ } ss:

ROY BROWN and ELMER MOORE
 being first duly sworn according to law depose and say that they are experienced in the work of plugging and filling oil and gas wells and were employed by KEYSTONE GAS COMPANY, well operator, and participated in the work of plugging and filling the above well, that said work was commenced on the 30 day of MAY, 19 72, and that the well was plugged and filled in the following manner:

BAND OR ZONE RECORD FORMATION	FILLING MATERIAL	PLUGS USED SIZE & KIND	CASING	
			OSG PULLED	CSG LEFT IN
	FILLED with GEL	3058-1426		
	CEMENT PLUG (99 ft)	1426-1327		
	FILLED with GEL	1327-1268		
	PULLED 5" CASING		1268	
	CEMENT PLUG (30 ft)	1268-1230		
	FILLED with GEL	1230-843		
	CEMENT PLUG (20 ft)	843-823		
	FILLED with GEL	823-570		
	CEMENT PLUG (60 ft)	570-510	THRU COAL SEAM	
	PULLED 7" CASING		690	512
	FILLED with GEL	510-20		
	CEMENT PLUG (20 ft)	to SURFACE	WITH MARKER	
COAL SEAMS			DESCRIPTION OF MONUMENT	
(NAME)			13 feet 7" CASING	
(NAME)				
(NAME)				
(NAME)				

and that the work of plugging and filling said well was completed on the 16 day of JUNE, 19 72.

And further deponents saith not.

ROY BROWN
ELMER MOORE

Sworn to and subscribed before me this 22 day of June, 19 72.

My commission expires:

Notary Public.
 Permit No. MON 330-P