



West Virginia Department of Environmental Protection
Office of Oil and Gas
WELL LOCATION FORM: GPS

API: 47-061-00324 WELL NO.: 7109

FARM NAME: Garner

RESPONSIBLE PARTY NAME: Erika Whetstone

COUNTY: Monongalia DISTRICT: Morgan

QUADRANGLE: Masontown

SURFACE OWNER: WILLIAM A JR, MELANIE E & DOW S DELORENZO

ROYALTY OWNER: _____

UTM GPS NORTHING: 4,384,120.838

UTM GPS EASTING: 601,243.110 GPS ELEVATION: 593.531

The Responsible Party named above has chosen to submit GPS coordinates in lieu of preparing a new well location plat for a plugging permit or assigned API number on the above well. The Office of Oil and Gas will not accept GPS coordinates that do not meet the following requirements:

1. Datum: NAD 1983, Zone: 17 North, Coordinate Units: meters, Altitude: height above mean sea level (MSL) – meters.
2. Accuracy to Datum – 3.05 meters
3. Data Collection Method:
Survey grade GPS : Post Processed Differential
Real-Time Differential
Mapping Grade GPS : Post Processed Differential
Real-Time Differential
4. Letter size copy of the topography map showing the well location.

RECEIVED
Office of Oil and Gas
JUL 18 2017
WV Department of
Environmental Protection

I the undersigned, hereby certify this data is correct to the best of my knowledge and belief and shows all the information required by law and the regulations issued and prescribed by the Office of Oil and Gas.

Erika Whetstone _____
Signature Title Date 7/6/17

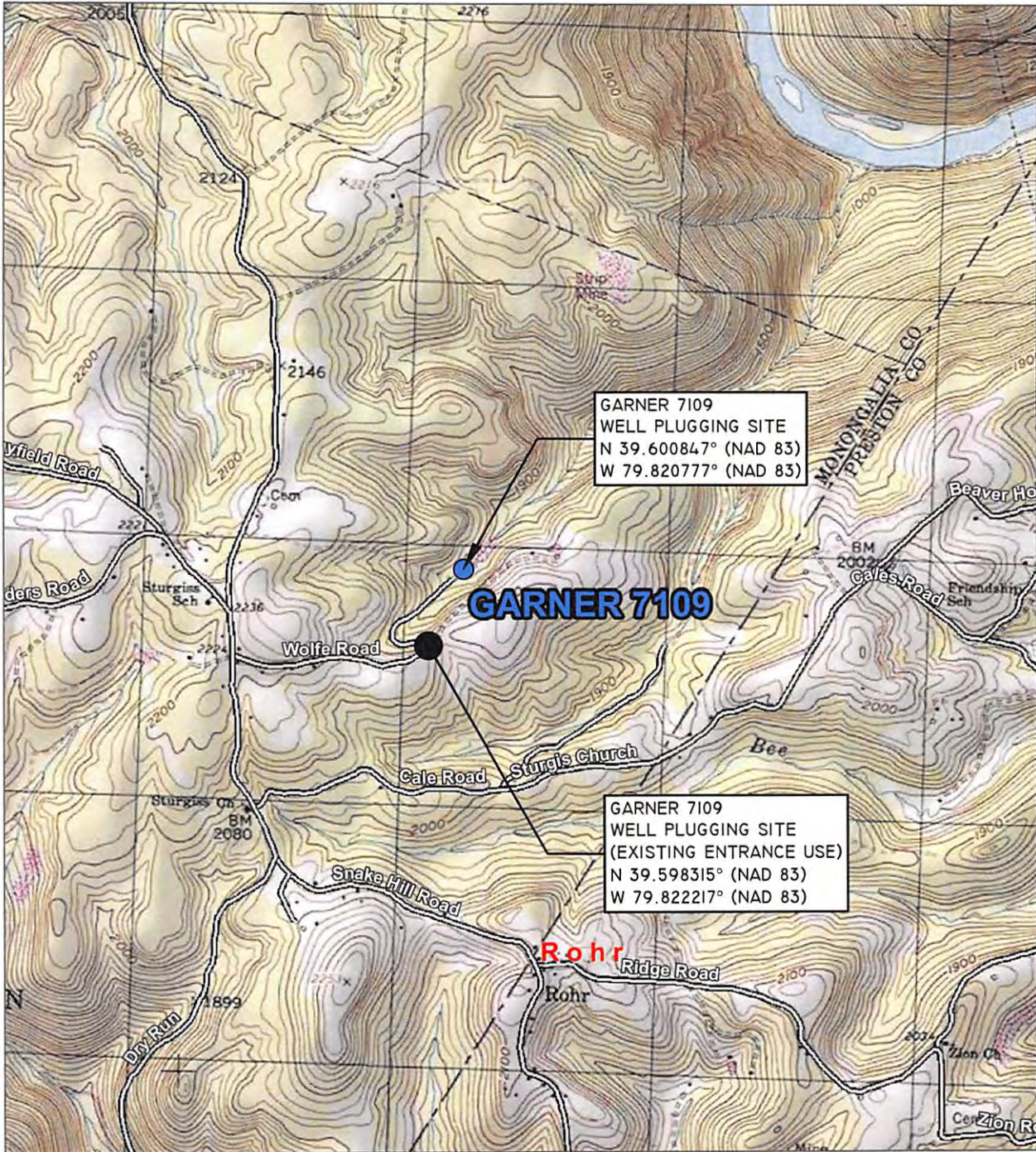

RECEIVED
Office of Oil and Gas

LOCATION MAP
MASONTOWN, WV 7.5M USGS QUADRANGLE
SCALE: 1"=2000'



JUL 18 2017
WV Department of Environmental Protection
Blue Mountain Inc.
 Engineers and Land Surveyors
 Woman Owned Small Business
 11023 Mason Dixon Hwy.
 Burton, WV 26562-9656
 (304) 662-6486

LOCATION MAP
GAS WELL PLUGGING
GARNER 7109 GAS WELL
 MORGAN DISTRICT
 MONONGALIA COUNTY, WV
 CONSOL GAS COMPANY
 200 HALLAM ROAD
 WASHINGTON, PA 15301

DRAWN BY: LLF
CHECKED BY: WPF
DATE: 06/10/2017
SCALE: 1"=2000'
WATERSHED: BULL RUN-CHEAT RIVER
PAGE <u>4</u> OF <u>4</u>