

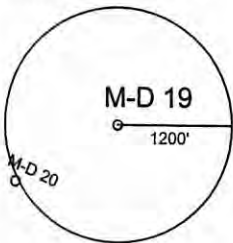

NORTH

SURROUNDING WELLS WITHIN 1200' RADIUS



UTM Z17N NAD83 CONUS		LAT/LONG NAD27 CONUS	
NORTHING	4,394,235 M	39° 41' 46.7" N	
EASTING	552,697 M	80° 23' 08.1" W	

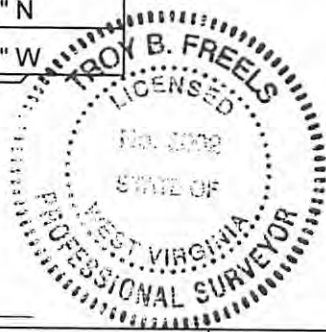

I THE UNDERSIGNED, HEREBY CERTIFY THAT THIS PLAT IS CORRECT TO THE BEST OF MY KNOWLEDGE AND BELIEF AND SHOWS ALL THE INFORMATION REQUIRED BY LAW AND THE REGULATIONS ISSUED AND PRESCRIBED BY THE DEPARTMENT OF ENVIRONMENTAL PROTECTION.
P.S. 2002

(*) DENOTES LOCATION OF WELL ON UNITED STATES TOPOGRAPHIC MAPS.

DATE NOVEMBER 16, 20 11

OPERATORS WELL NO. M-D 19

API WELL NO. 47 - 61 - 00090 P
STATE COUNTY PERMIT

CANCELLED

MINIMUM DEGREE OF ACCURACY: 1/2500 FILE NO.: HUNDRED 6.DWG
SCALE: 1"=2000'
PROVEN SOURCE OF ELEVATION: COMPANY NETWORK TIED INTO U.S.G.S.

WV DEP
OFFICE OF OIL AND GAS
601 57TH ST., CHARLESTON, WV 25304



WELL TYPE: OIL GAS LIQUID INJECTION WASTE DISPOSAL "GAS" PRODUCTION STORAGE DEEP SHALLOW

LOCATION: ELEVATION: 1224.32' WATERSHED: CAMP RUN OF WEST VIRGINIA FORK OF DUNKARD CREEK

DISTRICT: BATTELLE COUNTY: MONONGALIA QUADRANGLE: HUNDRED, WV 7.5'

SURFACE OWNER: CONSOLIDATION COAL COMPANY ACREAGE: 66.5± ACRES

ROYALTY OWNER: _____ LEASE ACREAGE: _____

PROPOSED WORK: _____ LEASE NO.: _____

DRILL: _____ CONVERT: _____ DRILL DEEPER: _____ REDRILL: _____ FRACTURE OR STIMULATE: _____ PLUG OFF OLD: _____

FORMATION: _____ PERFORATE NEW FORMATION: _____ PLUG AND ABANDON: CLEAN OUT AND REPLUG: _____ OTHER: _____

PHYSICAL CHANGE IN WELL (SPECIFY): _____ TARGET FORMATION: NONE

ESTIMATED DEPTH: _____

WELL OPERATOR: CONSOLIDATION COAL COMPANY DESIGNATED AGENT: RONNIE HARSH

ADDRESS: 1 BRIDGE ST., MONONGAH, WV 26554 ADDRESS: 1 BRIDGE ST., MONONGAH, WV 26554

10/10/2014

COUNTY NAME PERMIT