

Latitude  $37^{\circ} 55'$

$\oplus$  Topog. Location

Longitude  $82^{\circ} 15'$

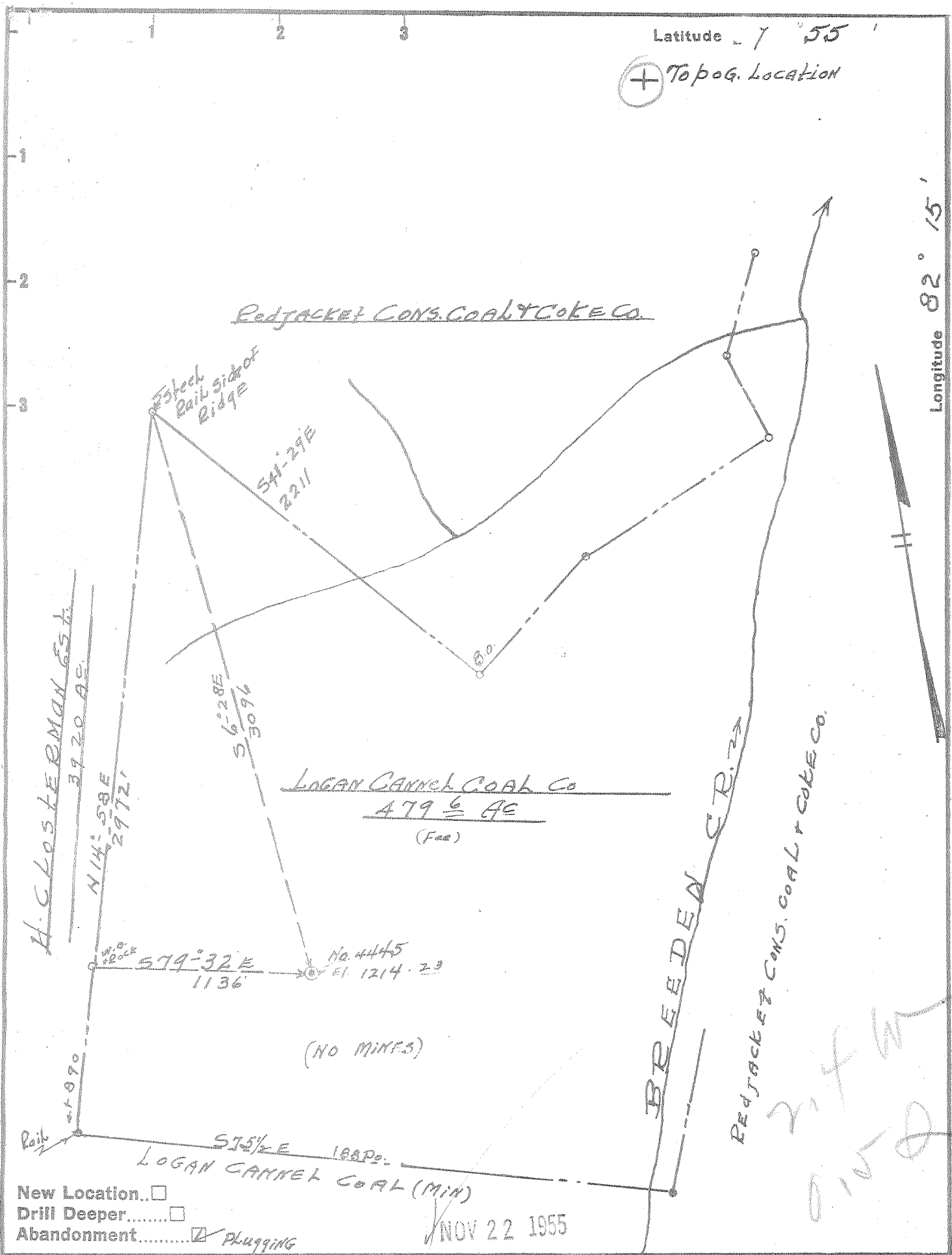

New Location..

Drill Deeper.....

Abandonment.....  Plugging

Company E.C. WARE

Address BEAUTY, Ky.

Farm LOGAN CANNEL COAL Co-

Tract BREEDEN Acres 479 6 Lease No. \_\_\_\_\_

Well (Farm) No. 4445 Serial No. \_\_\_\_\_

Elevation (Spirit Level) 1214.23

Quadrangle NAUGATUCK, W. VA - Ky.

County Mingo District HARNEY

Engineer R.M. Reed

Engineer's Registration No. 1826

File No. B-A Drawing No. 219-L

Date Oct. 26, 1955 Scale 1" = 660'

STATE OF WEST VIRGINIA  
DEPARTMENT OF MINES  
OIL AND GAS DIVISION  
CHARLESTON

WELL LOCATION MAP  
FILE NO. MIN-35-A

$\oplus$  Denotes location of well on United States Topographic Maps, scale 1 to 62,500, latitude and longitude lines being represented by border lines as shown.

— Denotes one inch spaces on border line of original tracing.

6-6 (244)



STATE OF WEST VIRGINIA  
DEPARTMENT OF MINES  
OIL AND GAS DIVISION

148

WELL RECORD

Permit No. 35-A Oil or Gas Well Oil  
(KIND)

Company	The Preston Oil Co.	Casing and Tubing	Used in Drilling	Left in Well	Packers
Address	Charleston, W. Va.	Size			
Farm	Logan Cannel Coal Co. Acres <u>976.6</u>	16			Kind of Packer
Location (waters)		13			
Well No.	<u>445</u> Elev. <u>1247.3</u>	10	10'	10'	Size of
District	Harvey County <u>Mingo</u>	8 1/2			Depth set
The surface of tract is owned in fee by	Logan Cannel Coal Co. Address <u>Huntington, W. Va.</u>	6%	1295'	1295'	Perf. top
Mineral rights are owned by	Logan Cannel Coal Co. Address <u>Huntington, W. Va.</u>	5 3/16			Perf. bottom
Drilling commenced		3			Perf. top
Drilling completed	<u>Sept. 8, 1926</u>	2	1432'	1432'	Perf. bottom
Date Shot	From _____ To _____	Liners Used			Perf. top
With					Perf. bottom
Open Flow	/10ths Water in _____ Inch				
	/10ths Merc. in _____ Inch				
Volume	Cu. Ft.				
Rock Pressure	lbs. _____ hrs.				
Oil	bbls., 1st 24 hrs.				
Fresh water	feet _____ feet				
Salt water	feet _____ feet				
		CASING CEMENTED	SIZE	No. Ft.	Date
		COAL WAS ENCOUNTERED AT <u>320</u> FEET _____ INCHES			
		<u>445</u> FEET _____ INCHES FEET _____ INCHES			
		_____ FEET _____ INCHES FEET _____ INCHES			

Formation	Color	Hard or Soft	Top	Bottom	Oil, Gas or Water	Depth Found	Remarks
Surface			0	10	Water	10	
Sand			10	105			
Slate			105	115			
Sand			115	135			
Slate			135	210			
Sand			210	220			
Slate			220	234			
Sand			234	270			
Slate			270	320			
Coal			320	323			
Slate & Shells			323	430			
Sand			430	440			
Slate			440	445			
Coal			445	447			
Slate			447	462			
Lime			462	472			
Slate			472	490			
Sand			490	510			
Slate & Shells			510	540			
Lime			540	580			
Slate & Shells			580	630			
Lime			630	672			
Slate			672	735			
Lime			735	800			
Slate			800	915			
Salt Sand			915	955			
Slate Break			955	957	XXXXXX		
				?			

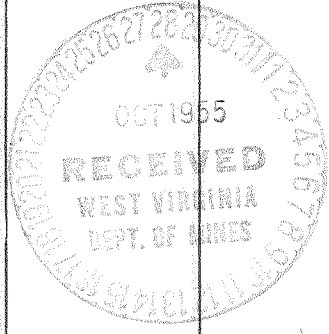

Note:  
Owned by Old Colony Oil & Gas Co.  
Purchased by United Fuel Gas Co.  
Sept. 2, 1930. JAN. 23 1956