

Lat. 37° 55'

Long 82° 10'

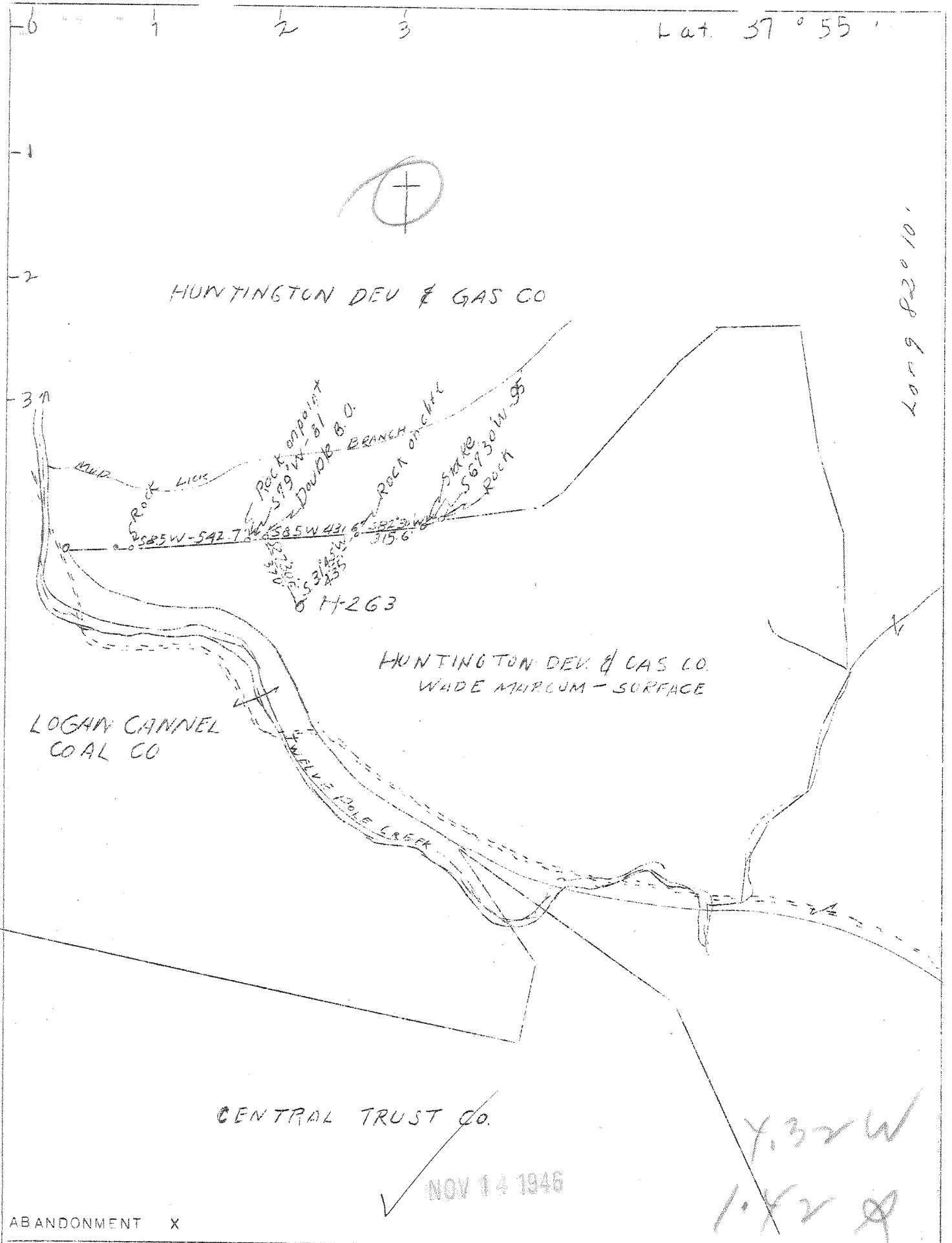

ABANDONMENT	X
COMPANY	HUNTINGTON DEV. & GAS CO.
ADDRESS	CHARLESTON, W. VA.
FARM	HUNTINGTON DEV. & GAS CO. FEE - MIN
TRACT	ACRES 124.2 LEASE NO.
WELL (FARM) NO.	SERIAL NO. H263
ELEVATION	883 BAR
QUAD	PANGLE HOLDEN
COUNTY	MINGO DISTRICT HARVEY
ENGINEER	G. H. MOORE
ENGINEER'S REG. NO.	662
FILE NO.	28-27 DRAWING NO.
OCT. 3, 1946	SCALE 1"=600'

STATE OF WEST VIRGINIA  
 DEPARTMENT OF MINES  
 OIL AND GAS DIVISION  
 CHARLESTON  
 WELL LOCATION MAP  
 FILE NO. MINGO 16A

+ DENOTES LOCATION OF WELL ON U.S. TOPOGRAPHIC MAPS, SCALE 1 TO 62,500 LATITUDE AND LONGITUDE LINES BEING REPRESENTED BY BORDER LINES AS SHOWN.  
 - DENOTES ONE INCH SPACES ON BORDER LINE OF ORIGINAL TRACING.

6-6 (243)

HUNTINGTON DEV. & GAS CO. NO. H-263 - HUNTINGTON DEV. & GAS CO. - MINGO-16A



STATE OF WEST VIRGINIA  
DEPARTMENT OF MINES  
OIL AND GAS DIVISION

*Completed no inspection*

87

Permit No. 16-A

WELL RECORD  
(Abandonment)

Oil or Gas Well **GAS**  
(KIND)

Company Huntington Development & Gas Company  
Address P.O. Box 1273 Charleston 25, W. Va.  
Farm Huntington Dev & Gas Co. Acres 109.7  
Location (waters) West Fork of 12 Pole Creek  
Well No. H - 263 Elev. \_\_\_\_\_  
District \_\_\_\_\_ County Mingo?  
The surface of tract is owned in fee by \_\_\_\_\_  
Address \_\_\_\_\_  
Mineral rights are owned by Huntington Dev & Gas Co.  
Charleston Address W. Va.

Drilling commenced \_\_\_\_\_  
Drilling completed October 15-21  
Date Shot \_\_\_\_\_ From \_\_\_\_\_ To \_\_\_\_\_  
With \_\_\_\_\_

Open Flow \_\_\_\_\_ /10ths Water in \_\_\_\_\_ Inch  
\_\_\_\_\_ /10ths Merc. in \_\_\_\_\_ Inch  
Volume No record Cu. Ft.  
Rock Pressure No record lbs. \_\_\_\_\_ hrs.  
Oil \_\_\_\_\_ bbls., 1st 24 hrs.  
Fresh water \_\_\_\_\_ feet \_\_\_\_\_ feet  
Salt water \_\_\_\_\_ feet \_\_\_\_\_ feet

Casing and Tubing	Used in Drilling	Left in Well	Packers
Size			Kind of Packer _____
16			
13			
10		20'	Size of _____
8 1/4			
6 5/8		1240'	Depth set _____
5 3/16			
3			Perf. top _____
2 Tubing		2272'	Perf. bottom _____
Liners Used			Perf. top _____
			Perf. bottom _____

CASING CEMENTED \_\_\_\_\_ SIZE \_\_\_\_\_ No. Ft. \_\_\_\_\_ Date \_\_\_\_\_  
COAL WAS ENCOUNTERED AT \_\_\_\_\_ FEET \_\_\_\_\_ INCHES  
\_\_\_\_\_ FEET \_\_\_\_\_ INCHES FEET \_\_\_\_\_ INCHES  
\_\_\_\_\_ FEET \_\_\_\_\_ INCHES FEET \_\_\_\_\_ INCHES

Formation	Color	Hard or Soft	Top	Bottom	Oil, Gas or Water	Depth Found	Remarks
							Gas in Berea about 2250'
							We haven't any record of this well.

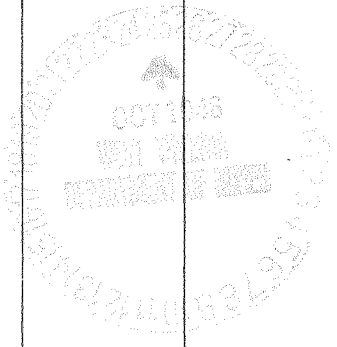

SEP 14 1949

Formation	Color	Hard or Soft	Top	Bottom	Oil, Gas or Water	Depth Found	Remarks

Date October 25, 1946

APPROVED Huntington Development & Gas Co., Owner

By G. H. Moore  
 (Title) Chief Engineer

