

RED JACKET CON. COAL and COKE CO.

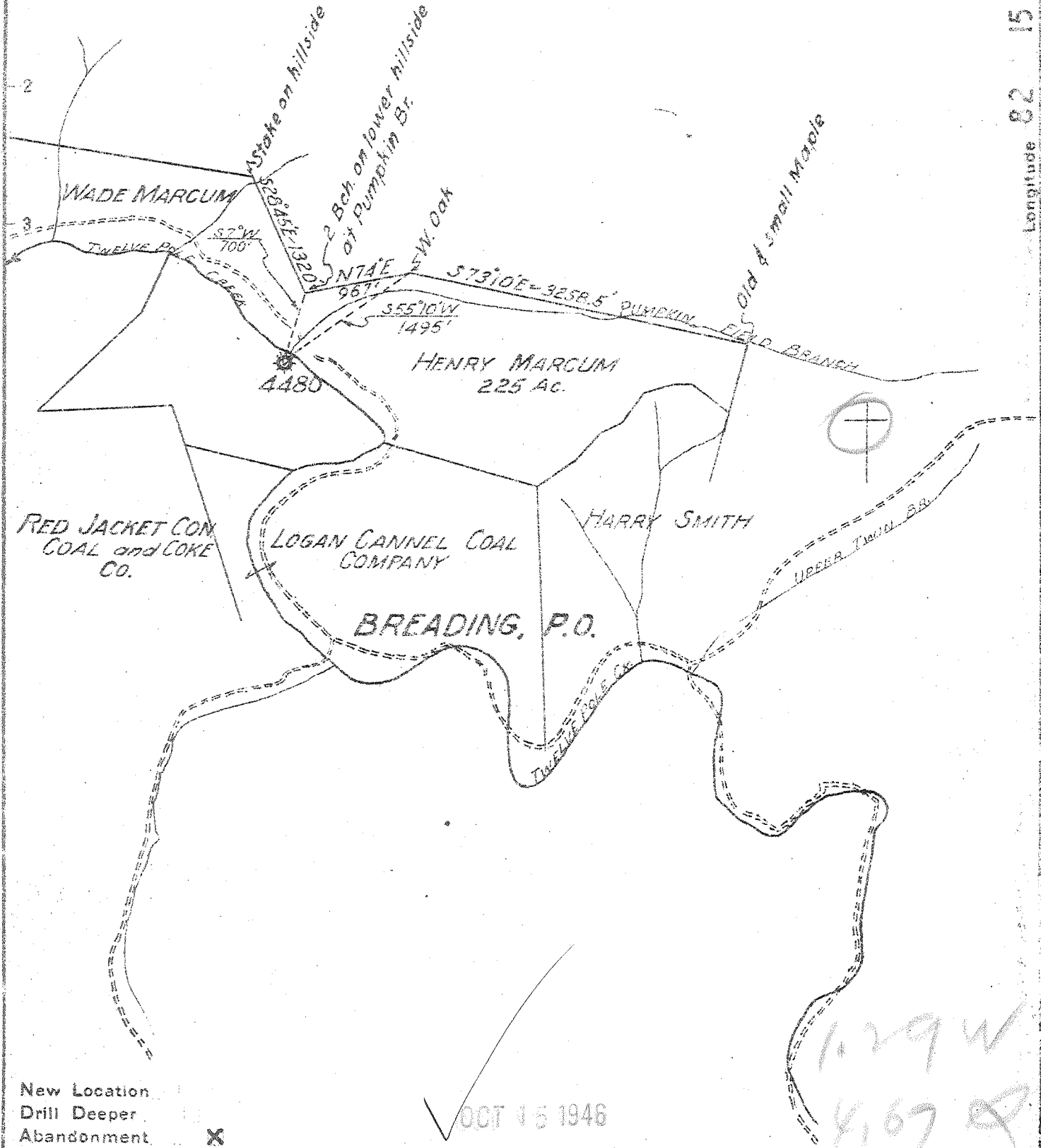

New Location
 Drill Deeper
 Abandonment X

OCT 15 1946

Company	UNITED FUEL GAS CO.		
Address	CHARLESTON, W. VA.		
Farm	HENRY MARCUM		
Tract	Acres 445	Lease No.	34699
Well (Farm) No.	3	Serial No.	4480
Elevation (Spirit Level)	797.42'		
Quadrangle	NAUGATUCK		
County	MINGO	District	HARVEY
Engineer			
Engineer's Registration No.	662		
File No.	26-29	Drawing No.	
Date	OCT. 2, 1946		
Scale	1" = 1320'		

STATE OF WEST VIRGINIA
 DEPARTMENT OF MINES
 OIL AND GAS DIVISION
 CHARLESTON

WELL LOCATION MAP
 FILE NO. MINGO-15-A

+ Denotes location of well on United States Topographic Maps, scale 1 to 62,500, latitude and longitude lines being represented by border lines as shown.

- Denotes one inch spaces on border line of original tracing.

HENRY MARCUM No. 3 (4480) - UNITED FUEL GAS CO. - MIN-15-A

HENRY HARCUM NO. 4480 WELL.

15A

Harvey District, Mingo County, W. Va.

By United Fuel Gas Co., Box 1273, Charleston, 25, W. Va.

Abandoned under permit Mingo-.....-A7

On 445 acres, on Pumpkinfield Branch of Twelvepole Creek.

Elevation, 797.42' L.

Minerals owned by Harry Smith, Breeden, W. Va.

Drilling commenced April 30, 1929; completed May 15, 1929.

Volume, 2,339,000 cu. ft.

8 1/2" casing, 16'; 6", 291'; 5", 779'; 3" tubing, 912'; all left in.

Anchor pecker, 3 x 5, set at 764'.

Coal was encountered at 283-285'.

Gas well. Record to Dept. of Mines dated Oct. 3, 1946.

Record to ROT from Mrs. Griffith September 14, 1946. Old File No. 68.

	Top.	Bottom.
Coal	283	285
Salt Sand (gas, 610-615')	509	708
Slate	708	710
Lime	710	717
Sand	717	766
Lime	766	830
Sand	830	860
Lime	860	890
Sand (gas, 895-904')	890	910
Total depth		910



STATE OF WEST VIRGINIA
DEPARTMENT OF MINES
OIL AND GAS DIVISION

88

WELL RECORD
(Abandonment)

Oil or Gas Well GAS
(KIND)

Permit No. 15-A
Company United Fuel Gas Company
Address P.O. Box 1273, Charleston 25, W. Va.
Farm Henry Marcum Acres 445
Location (waters) Pumpkin Field Br. of 12 Pole Cr.
Well No. 4480 Elev. 797.42 L
District Harvey County Hingo
The surface of tract is owned in fee by _____
Address _____
Mineral rights are owned by Harry Smith
Address Breedon, W. Va.
Drilling commenced April 30, 1929
Drilling completed May 15, 1929
Date Shot _____ From _____ To _____
With _____
Open Flow _____ /10ths Water in _____ Inch
_____ /10ths Merc. in _____ Inch
Volume 2,339,000 Cu. Ft.
Rock Pressure _____ lbs. _____ hrs.
Oil _____ bbls., 1st 24 hrs.
Fresh water _____ feet _____ feet
Salt water _____ feet _____ feet

Casing and Tubing	Used in Drilling	Left in Well	Packers
Size			
16			Kind of Packer <u>Anchor</u>
13			
10			Size of <u>3"X5-3/16"</u>
8 1/4	<u>16</u>	<u>16</u>	
6 5/8	<u>291</u>	<u>291</u>	Depth set <u>764'</u>
5 3/16	<u>779</u>	<u>779</u>	
3		<u>912</u>	Perf. top _____
2			Perf. bottom _____
Liners Used			Perf. top _____
			Perf. bottom _____

CASING CEMENTED _____ SIZE _____ No. Ft. _____ Date _____

COAL WAS ENCOUNTERED AT 283 FEET 24 INCHES

FEET INCHES FEET INCHES

FEET INCHES FEET INCHES

Formation	Color	Hard or Soft	Top	Bottom	Oil, Gas or Water	Depth Found	Remarks
Coal			283	285			
Salt Sand			509	708	Gas	610-615	
Slate			708	710			
Lime			710	717			
Sand			717	766			
Lime			766	830			
Sand			830	860			
Lime			860	890			
Sand			890	910	Gas	895-904	
Total Depth				910			

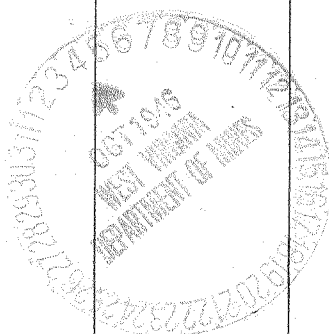

SEP 14 1949

Formation	Color	Hard or Soft	Top	Bottom	Oil, Gas or Water	Depth Found	Remarks

Date October 3, 1946

APPROVED UNITED FUEL GAS COMPANY, Owner

By G. H. Morse
(Title) Chief Engineer (R)