

NOTE: THERE ARE NO DWELLINGS OR KNOWN WATER WELLS WITHIN 200' OF THE PROPOSED WELL.

REFERENCES

STA 587
PMBK/PK NAIL
ELEV. 1006.3'

STA 589
PMBK/PK NAIL
ELEV. 1005.8'

S 18° 37' 22" E 32.4'

S 66° 31' 01" E 35.5'

PROPOSED WELL SITE #2171
SCALE: 1" = 200'

State Plane
WV South Nad 27
N = 230,232.4420
E = 1,666,766.3150

State Plane
UTM NAD 83
Zone 17 (Meter)
N = 4,165,021.44
E = 398,479.09

Geographic Nad 27
LAT = 37° 37' 35.78"
LONG = 82° 09' 02.28"

LEGEND

+ DENOTES LOCATION WELL ON UNITED STATES TOPOGRAPHICAL MAPS

○ PROPOSED WELL

○ PLUGGED WELL

☼ EXISTING WELL

⊙ SURVEY STATION

— TREE

— ROADS

— RAILROAD

— STREAM, DRAIN, CREEK

DRAWING No. WVA2171.DWG

SCALE 1" = 500'

MINIMUM DEGREE OF ACCURACY 1 IN 2,500

PROVEN SOURCE OF ELEVATION USGS B.M. MONUMENT # 672

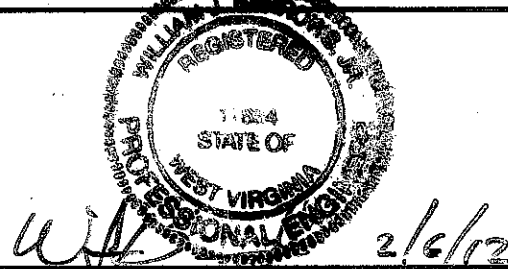

B & B Engineering, LLC
36 Hatfield Lane
Prestonsburg, KY 41653
Phone: (606) 874-7005

STATE OF WEST VIRGINIA
DIVISION OF ENVIRONMENTAL PROTECTION
OFFICE OF OIL AND GAS
CHARLESTON, WV. 25304

DATE: 02/06/12
OPERATOR'S WELL NO. 2171
API WELL NO. 49-59-02232
STATE COUNTY PERMIT

WELL TYPE: OIL GAS LIQUID INJECTION WASTE DISPOSAL
(IF "GAS") PRODUCTION OR STORAGE DEEP OR SHALLOW

LOCATION: ELEVATION 1006.5 WATER SHED MATE CREEK
DISTRICT MAGNOLIA COUNTY MINGO
QUADRANGLE DEL BARTON

SURFACE OWNER EVALYNN KINDER, et al. ACREAGE +/- 241
OIL & GAS ROYALTY OWNER KINZER BUSINESS REALTY, LTD. et al. LEASE ACREAGE +/- 241
LEASE No. 1145

PROPOSED WORK: DRILL CONVERT DRILL DEEPER REDRILL FRACTURE OR STIMULATE
PLUG OFF OLD FORMATION PERFORATE NEW FORMATION
OTHER PHYSICAL CHANGE IN WELL (SPECIFY) _____

PLUG AND ABANDON CLEAN OUT AND REPLUG

TARGET FORMATION B. LIME, BEREA, B. SHALE ESTIMATED DEPTH +/- 4370
WELL OPERATOR QUALITY NATURAL GAS, LLC DESIGNATED AGENT JAMES HILL
ADDRESS Allen, Kentucky 41601 ADDRESS HC 71 Rt. 4, BOX 87A WHARNCLIFFE, WV 25651

04/27/2012

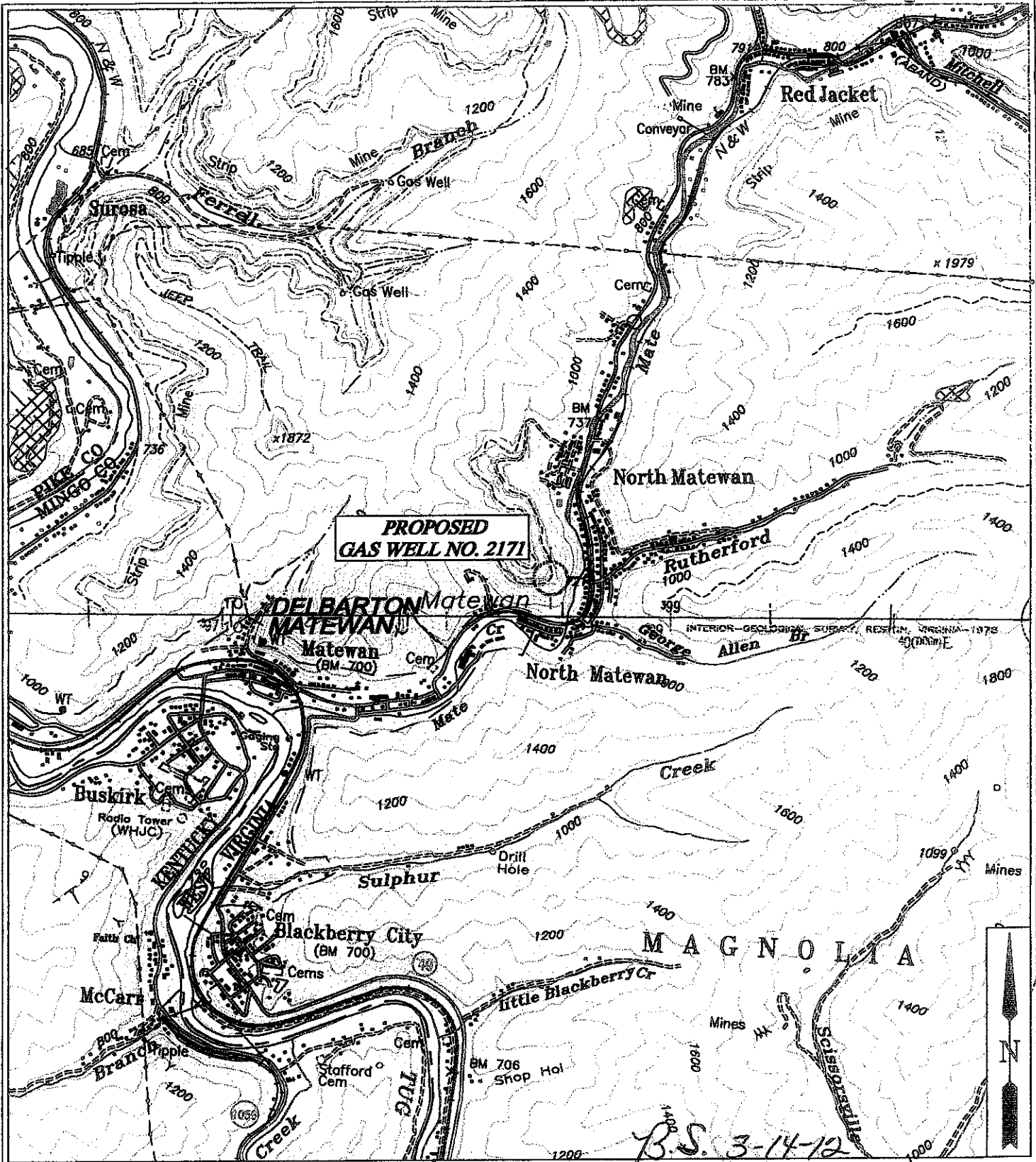

**PROPOSED
GAS WELL NO. 2171**

B.S. 3-14-12

B & B Engineering, LLC
 36 Hatfield Lane
 Prestonsburg, KY 41653
 Phone: (608) 784-7005

QUALITY NATURAL GAS, LLC.
LOCATION MAP
 PROPOSED GAS WELL NO. 2171

QUAD: DELBARTON
SCALE: 1" = 2000'
DATE: 02/06/2012
FILE NAME: WVA2171VIC.DWG