

Latitude 37 55

0
6815

Longitude 82

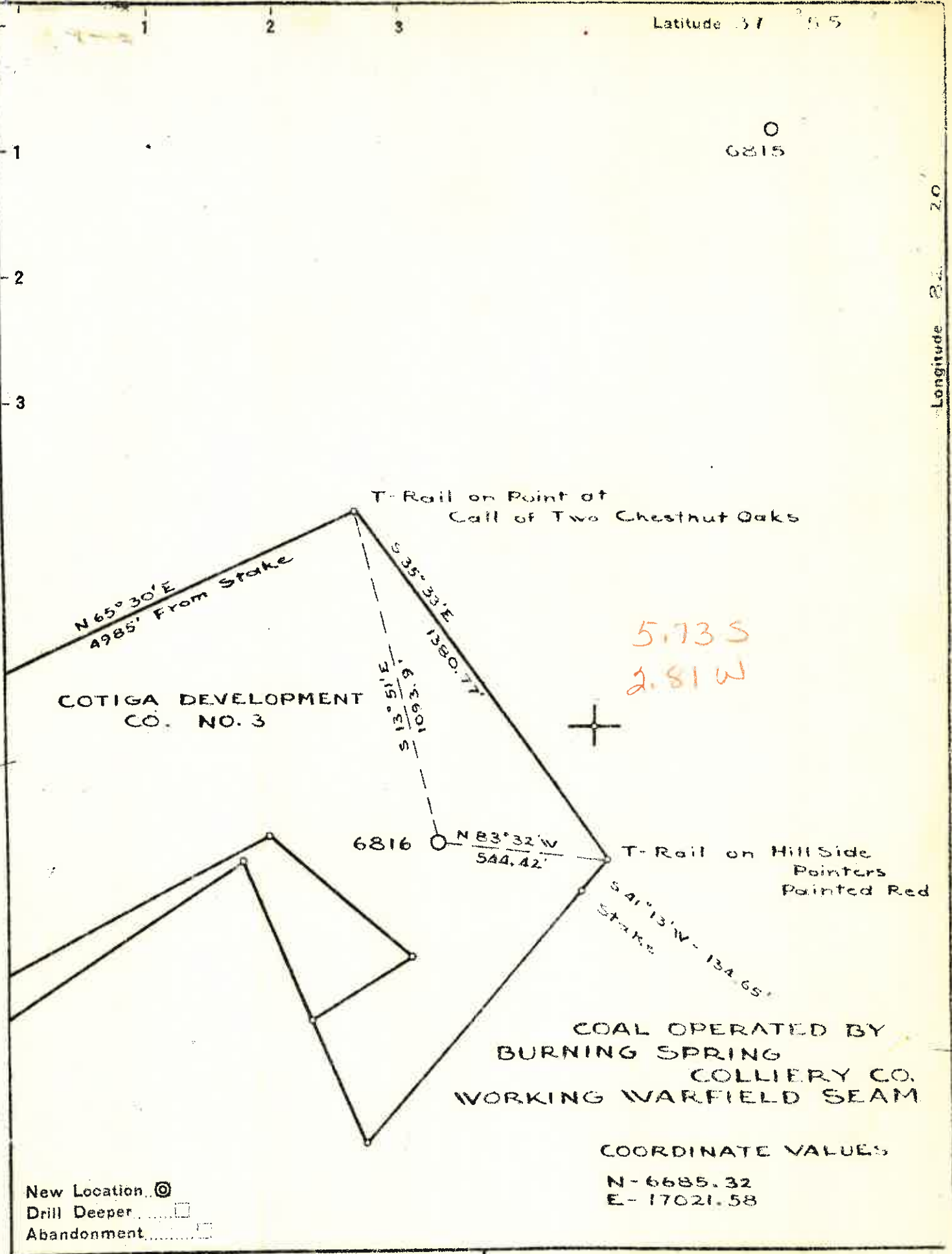

5.73 S
2.81 W

COORDINATE VALUES
 N-6685.32
 E-17021.58

New Location
 Drill Deeper
 Abandonment

Company UNITED FUEL GAS CO.
 Address CHARLESTON, W.VA.
 Farm COTIGA DEV. CO.
 Tract 75 Acres 3985. Lease No. Pt. 42832
 Well (Farm) No. 3 Serial No. 6816
 Elevation (Spirit Level) 1230.50'
 Quadrangle NAUGATUCK
 County MINGO District KERMIT
 Engineer Paul E. [Signature]
 Engineer's Registration No. 669
 File No. 20-23 Drawing No. _____
 Date NOV. 26-51 Scale 1" = 400'

STATE OF WEST VIRGINIA
 DEPARTMENT OF MINES
 OIL AND GAS DIVISION
 CHARLESTON

WELL LOCATION MAP
 FILE NO. MIN-301

+ Denotes location of well on United States Topographic Maps, scale 1 to 62,500. Latitude and longitude lines being represented by border lines as shown.
 - Denotes one inch spaces on border lines of original tracing

6-6 243

WEST VIRGINIA DEPARTMENT OF MINES
OIL & GAS DIVISION
W E L L R E C O R D

Permit No. MIN 301
Naugatuck Quad.

Gas

Company	United Fuel Gas Co.	CASING & TUBING	
Address	Box 1273, Charleston 25, W. Va.		
Farm	Cotiga Development Co. #3 Acres 3955.75	13 3/8	5
Location	Middle Burning Creek	10 3/4	550
Well No.	6016 Elev. 1230.5	7"	1744
District	Kermit County - Mingo	3 Tubing	1973
Mineral	Cotiga Development Co., 17th & Chestnut Sts., Philadelphia, Pa.		
Commenced	12/3/51	Hook wall Packer	
Completed	2/24/52	3" x 6 5/8" x 16"	
Date Shot	2/27/52 from 2562 to 3353	1955'	
With	5400# DuPont Gelatin		
Open Flow	9/10ths Water in 2"		
Volume	127 M		
R.P.	65# 40 hours		

Surface	0	4	Berea Grit	2440	2555
Sand	4	40	Brown Shale	2555	2630
Slate	40	70	White Slate	2630	2669
Sand	70	120	Brown Shale	2669	2966
Slate	120	130	White Slate	2966	3070
Sand	160	195	Brown Shale	3070	3334
Coal	195	198	White Slate	3334	3353
Slate	198	210	TOTAL DEPTH		3353'
Sand	210	250			
Slate	250	260	Water 195' 3 BPH		
Sand	260	296	Water 295' HPW		
Slate & Shells	296	418	Water 1173' 4 BPH		
Sand	418	430	LOW hole reduced at 1622'		
Slate	430	452	Gas 1772-1774' 2/10 W 2" 60 M		
Coal	452	455	Gas 1669-1672' 3/10 W 2" 73 M		
Sand	455	460			
Slate & Shells	460	700	Test before shot 5/10 W 2" 94 M		
Sand	700	762	Shot 2/27/52 with 5400# DuPont Gelatin		
Slate	762	807	from 2562-3353		
Sand	807	865	Test 20 hours after shot 9/10 W 2" 127 M		
Slate & Shells	865	1045			
Sand	1045	1270	FINAL OPEN FLOW - 127 M - Br. Shale		
Slate & Shells	1270	1350	40 Hr. R.P. 65#		
Sand	1350	1395			
Slate & Shells	1395	1400	Shut in 2/20/52 in 3" Tubing.		
Red Rock	1400	1495			
Slate & Shells	1495	1510			
Red Rock	1510	1520			
Slate & Shells	1520	1602			
Red Rock	1602	1615			
Slate	1615	1618			
Sand	1618	1632			
Slate & Shells	1632	1665			
Black Lime	1665	1709			
Big Lime	1709	1690			
Injun Sand	1690	1955			