

10/29/79

1100'

Latitude 39° 22' 30" (15') 39° 25'

TOPO 7 1/2 Min

Longitude 78° 52' 30" (15') 78° 50'

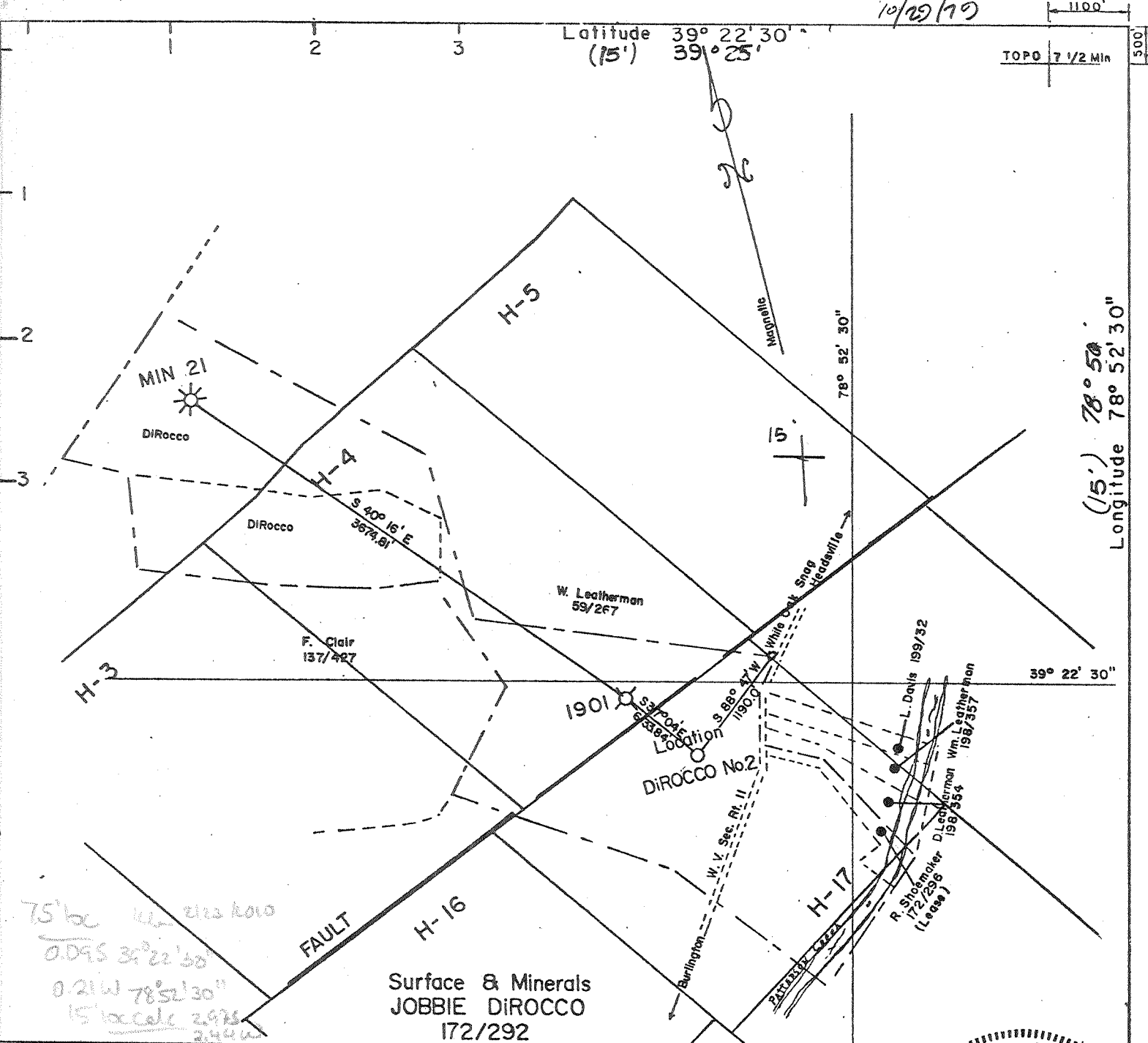

FILE NO. _____
 DRAWING NO. _____
 SCALE 1" = 1000'
 MINIMUM DEGREE OF ACCURACY 1 in 200
 PROVEN SOURCE OF ELEVATION B.M. on Headsville Bridge - E.L. 686

I THE UNDERSIGNED, HEREBY CERTIFY THAT THIS PLAT IS CORRECT TO THE BEST OF MY KNOWLEDGE AND BELIEF AND SHOWS ALL THE INFORMATION REQUIRED BY LAW AND THE REGULATIONS ISSUED AND PRESCRIBED BY THE DEPARTMENT OF MINES.
 (SIGNED) Charles L. Logsdon
 R.P.E. _____ L.L.S. 69

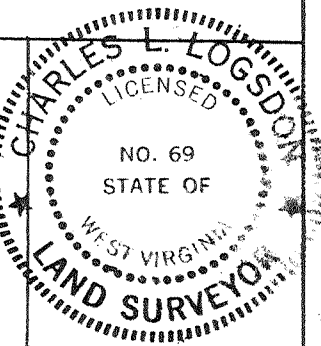

(+) DENOTES LOCATION OF WELL ON UNITED STATES TOPOGRAPHIC MAPS
 FORM IV-6 (8-78)

DATE Oct. 24, 19 79
 OPERATOR'S WELL NO. _____
 API WELL NO. 47 - 057 - 0030 - P
 STATE COUNTY PERMIT

STATE OF WEST VIRGINIA
 DEPARTMENT OF MINES
 OIL AND GAS DIVISION

WELL TYPE: OIL ___ GAS LIQUID INJECTION ___ WASTE DISPOSAL ___
 (IF "GAS,") PRODUCTION STORAGE ___ DEEP ___ SHALLOW ___
 LOCATION: ELEVATION 793.18 WATER SHED Patterson Creek
 DISTRICT Cabin Run COUNTY Mineral
 QUADRANGLE Burlington, KEYSER 15'
 SURFACE OWNER Jobbie DiRocco ACREAGE 133
 OIL & GAS ROYALTY OWNER Jobbie DiRocco LEASE ACREAGE 133
 LEASE NO. _____
 PROPOSED WORK: DRILL CONVERT ___ DRILL DEEPER ___ REDRILL ___ FRACTURE OR STIMULATE ___ PLUG OFF OLD FORMATION ___ PERFORATE NEW FORMATION ___ OTHER PHYSICAL CHANGE IN WELL (SPECIFY) _____

PLUG AND ABANDON ___ CLEAN OUT AND REPLUG ___
 TARGET FORMATION Oriskany Sand ESTIMATED DEPTH T.D. 2400' ±
 WELL OPERATOR Upland Resources DESIGNATED AGENT Ralph E. Webb, AGent
 ADDRESS 1700 Benedum-Trees Building ADDRESS Rt.1, Box 117
Pittsburgh, Pa. 15222 Burlington, WVa 26710-0117

MIN 0030-P

10/29/79

1100'

Latitude 39° 22' 30" (15') 39° 25'

TOPO 7 1/2 Min

Longitude 78° 50' (15') 78° 52' 30"

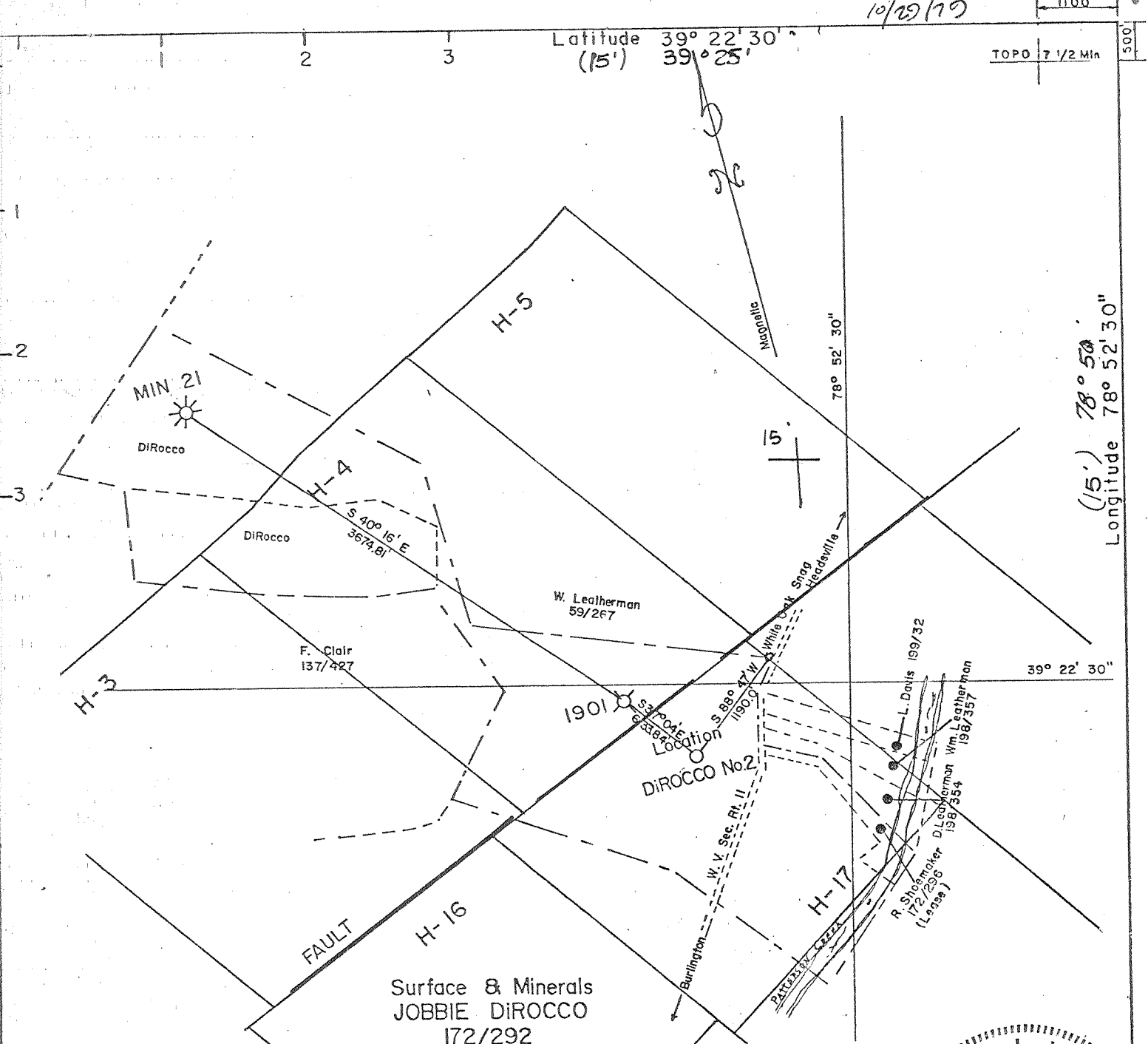

Surface & Minerals
JOBIE DIROCCO
172/292

FILE NO. _____
 DRAWING NO. _____
 SCALE 1" = 1000'
 MINIMUM DEGREE OF ACCURACY 1 in 200
 PROVEN SOURCE OF ELEVATION B.M. on Headsville Bridge - El. 686

I THE UNDERSIGNED, HEREBY CERTIFY THAT THIS PLAT IS CORRECT TO THE BEST OF MY KNOWLEDGE AND BELIEF AND SHOWS ALL THE INFORMATION REQUIRED BY LAW AND THE REGULATIONS ISSUED AND PRESCRIBED BY THE DEPARTMENT OF MINES.
 (SIGNED) Charles L. Logsdon
 R.P.E. _____ L.L.S. 69

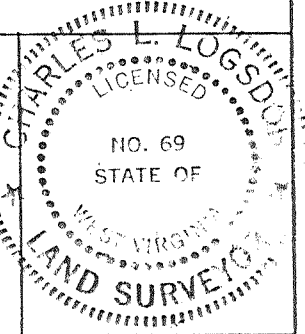

(+) DENOTES LOCATION OF WELL ON UNITED STATES TOPOGRAPHIC MAPS

DATE Oct. 24, 19 79
 OPERATOR'S WELL NO. _____
 API WELL NO. 47-057-0030-P
 STATE COUNTY PERMIT

STATE OF WEST VIRGINIA
 DEPARTMENT OF MINES
 OIL AND GAS DIVISION

Plugging Cancelled

WELL TYPE: OIL ___ GAS LIQUID INJECTION ___ WASTE DISPOSAL ___
 (IF "GAS,") PRODUCTION STORAGE ___ DEEP ___ SHALLOW ___
 LOCATION: ELEVATION 793.18 WATERSHED Patterson Creek
 DISTRICT Cabin Run COUNTY Mineral
 QUADRANGLE Burlington, KEYSER 15'
 SURFACE OWNER Jobbie DiRocco ACREAGE 133
 OIL & GAS ROYALTY OWNER Jobbie DiRocco LEASE ACREAGE 133
 LEASE NO. _____
 PROPOSED WORK: DRILL CONVERT ___ DRILL DEEPER ___ REDRILL ___ FRACTURE OR STIMULATE ___ PLUG OFF OLD FORMATION ___ PERFORATE NEW FORMATION ___ OTHER PHYSICAL CHANGE IN WELL (SPECIFY) _____

PLUG AND ABANDON ___ CLEAN OUT AND REPLUG ___
 TARGET FORMATION Oriskany Sand ESTIMATED DEPTH T.D. 2400' ±
 WELL OPERATOR Upland Resources DESIGNATED AGENT TROY A. BRADY JR.
 ADDRESS 1700 Benedum-Tress Building ADDRESS P.O. Bx 371
Pittsburgh, Pa. 15222 Buckhannon WV 26201

DEC 3 1980

0030

10/29/79

1100'

Latitude 39° 22' 30" (15')

TOPD 7 1/2 Min

Longitude 78° 52' 30" (15')

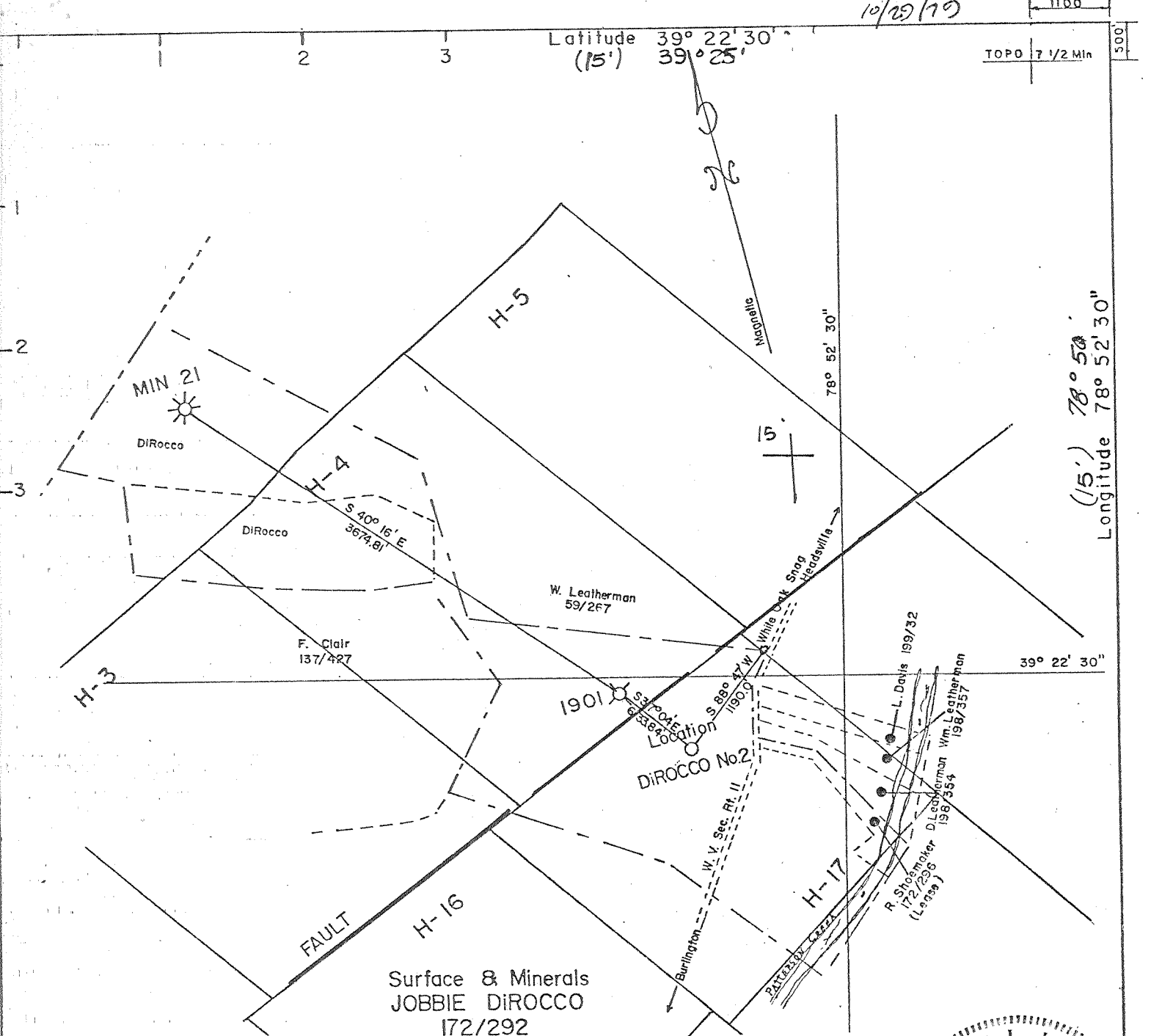

Surface & Minerals
JOBIE DIROCCO
172/292

FILE NO. _____
 DRAWING NO. _____
 SCALE 1" = 1000'
 MINIMUM DEGREE OF ACCURACY 1 in 200
 PROVEN SOURCE OF ELEVATION B.M. on Headsville Bridge - El. 686

I THE UNDERSIGNED, HEREBY CERTIFY THAT THIS PLAT IS CORRECT TO THE BEST OF MY KNOWLEDGE AND BELIEF AND SHOWS ALL THE INFORMATION REQUIRED BY LAW AND THE REGULATIONS ISSUED AND PRESCRIBED BY THE DEPARTMENT OF MINES.
 (SIGNED) Charles L. Logsdon
 R.P.E. _____ L.L.S. 69

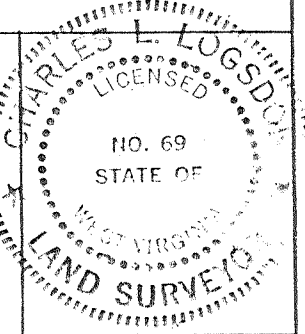

(+) DENOTES LOCATION OF WELL ON UNITED STATES TOPOGRAPHIC MAPS

DATE Oct. 24, 19 79
 OPERATOR'S WELL NO. _____
 API WELL NO. 47-057-0030-P
 STATE COUNTY PERMIT

FORM IV-6
(8-78)

STATE OF WEST VIRGINIA
 DEPARTMENT OF MINES
 OIL AND GAS DIVISION

WELL TYPE: OIL ___ GAS LIQUID INJECTION ___ WASTE DISPOSAL ___
 (IF "GAS,") PRODUCTION STORAGE ___ DEEP ___ SHALLOW ___
 LOCATION: ELEVATION 793.18 WATER SHED Patterson Creek
 DISTRICT Cabin Run COUNTY Mineral
 QUADRANGLE Burlington, KEYSER 15'
 SURFACE OWNER Jobbie DiRocco ACREAGE 133
 OIL & GAS ROYALTY OWNER Jobbie DiRocco LEASE ACREAGE 133
 LEASE NO. _____
 PROPOSED WORK: DRILL CONVERT ___ DRILL DEEPER ___ REDRILL ___ FRACTURE OR STIMULATE ___ PLUG OFF OLD FORMATION ___ PERFORATE NEW FORMATION ___ OTHER PHYSICAL CHANGE IN WELL (SPECIFY) _____

PLUG AND ABANDON ___ CLEAN OUT AND REPLUG ___
 TARGET FORMATION Oriskany Sand ESTIMATED DEPTH T.D. 2400' ±
 WELL OPERATOR Upland Resources DESIGNATED AGENT TROY A. BRADY JR.
 ADDRESS 1700 Benedum-Tress Building ADDRESS P.O. Bx 371
Pittsburgh, Pa. 15222 Buckhannon WV 26201

MIN 0030

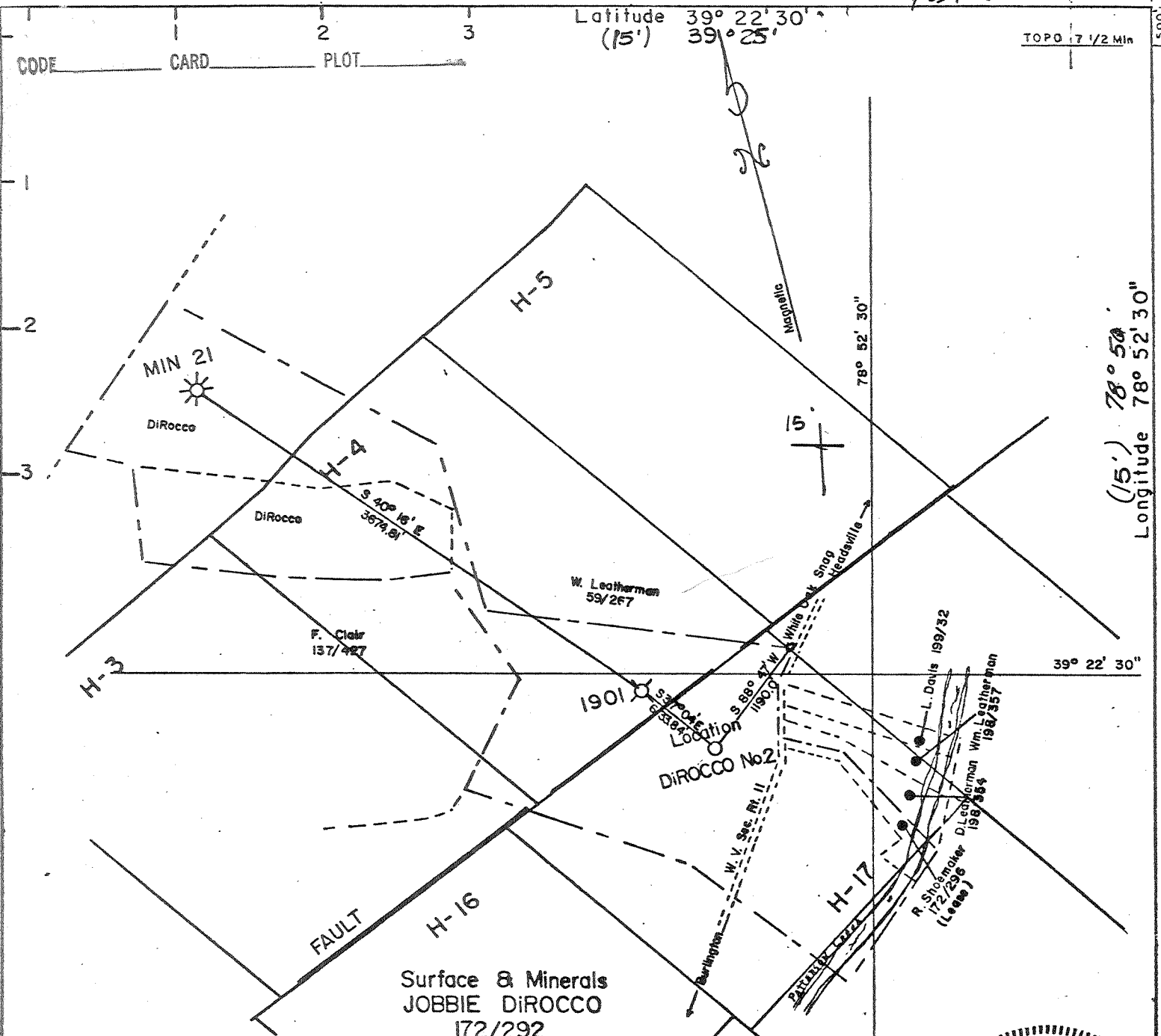

FILE NO. _____
 DRAWING NO. _____
 SCALE 1" = 1000'
 MINIMUM DEGREE OF
 ACCURACY 1 in 200
 PROVEN SOURCE OF
 ELEVATION B.M. on Headsville
Bridge - El. 686

I THE UNDERSIGNED, HEREBY CERTIFY THAT
 THIS PLAT IS CORRECT TO THE BEST OF MY
 KNOWLEDGE AND BELIEF AND SHOWS ALL THE
 INFORMATION REQUIRED BY LAW AND THE REGU-
 LATIONS ISSUED AND PRESCRIBED BY THE DEPART-
 MENT OF MINES.
 (SIGNED) Charles L. Logsdon
 R.P.E. _____ L.L.S. 69

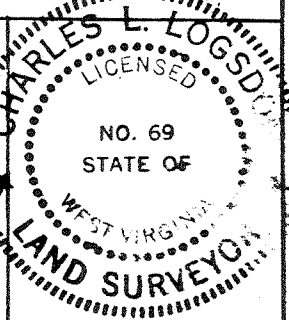

(+) DENOTES LOCATION OF
 WELL ON UNITED STATES
 TOPOGRAPHIC MAPS
 FORM IV-6
 (8-78)

DATE Oct. 24, 19 79
 OPERATOR'S WELL NO. _____
 API WELL NO. _____
47 - 057 - 0030 - P
 STATE COUNTY PERMIT

STATE OF WEST VIRGINIA
 DEPARTMENT OF MINES
 OIL AND GAS DIVISION

Plugging Cancelled

WELL TYPE: OIL ___ GAS LIQUID INJECTION ___ WASTE DISPOSAL ___
 (IF "GAS,") PRODUCTION STORAGE ___ DEEP ___ SHALLOW ___
 LOCATION: ELEVATION 793.18 WATER SHED Patterson Creek
 DISTRICT Cabin Run COUNTY Mineral
 QUADRANGLE Burlington, KEYSER 15'
 SURFACE OWNER Jobbie DiRocco ACREAGE 133
 OIL & GAS ROYALTY OWNER Jobbie DiRocco LEASE ACREAGE 133
 LEASE NO. _____
 PROPOSED WORK: DRILL CONVERT ___ DRILL DEEPER ___ REDRILL ___ FRACTURE OR
 STIMULATE ___ PLUG OFF OLD FORMATION ___ PERFORATE NEW
 FORMATION ___ OTHER PHYSICAL CHANGE IN WELL (SPECIFY) _____

DEC 09 1984

PLUG AND ABANDON ___ CLEAN OUT AND REPLUG ___
 TARGET FORMATION Oriskany Sand ESTIMATED DEPTH T.D. 2400' ±
 WELL OPERATOR Upland Resources DESIGNATED AGENT Troy A BRADY JR.
 ADDRESS 1700 Benedum Trust Building ADDRESS P.O. Bx 371
Pittsburgh, Pa. 15222 Buckhannon WV 26201

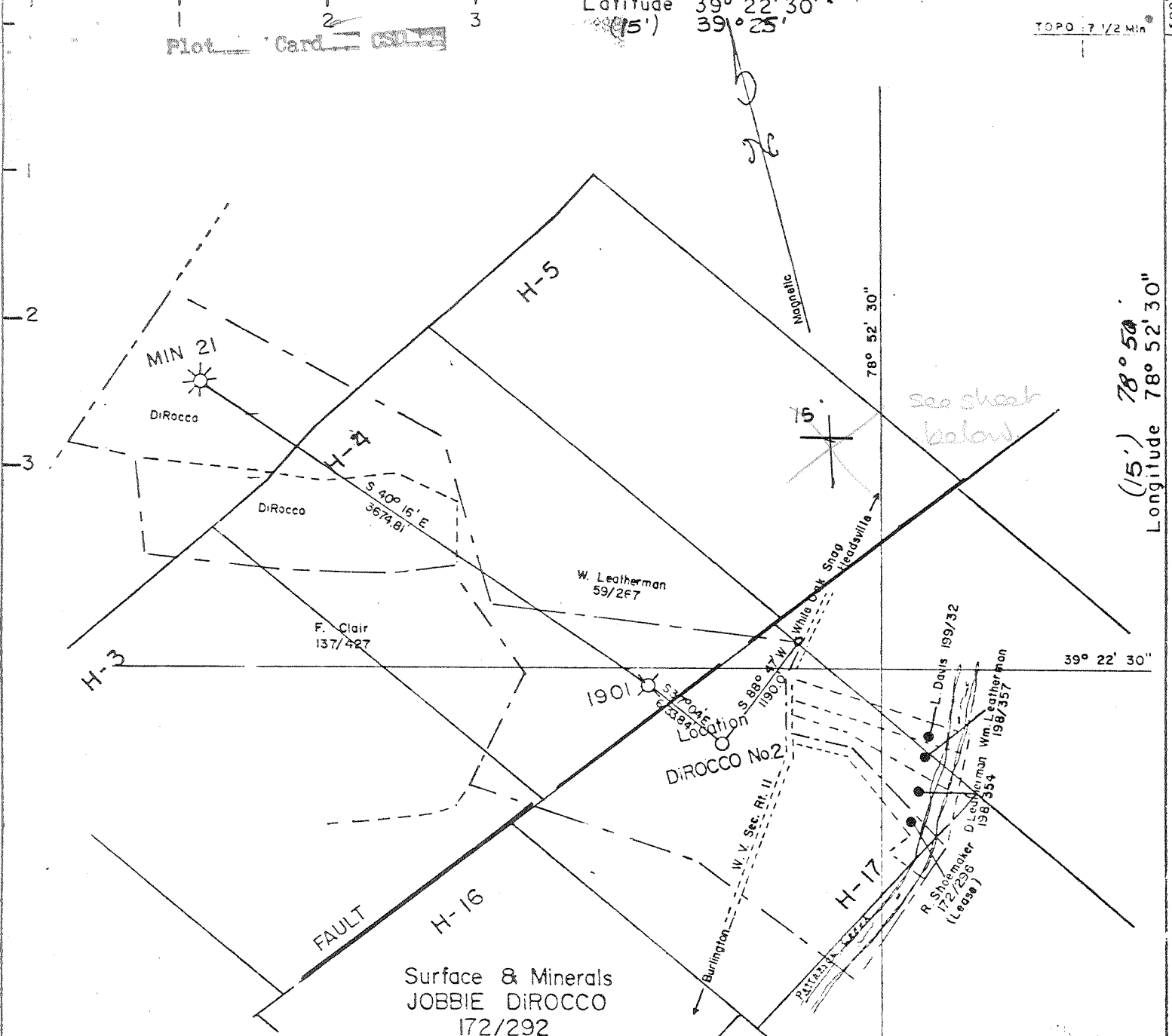

FILE NO. _____
 DRAWING NO. _____
 SCALE 1" = 1000'
 MINIMUM DEGREE OF ACCURACY 1 in 200
 PROVEN SOURCE OF ELEVATION B.M. on Headsville Bridge - El. 686

I THE UNDERSIGNED, HEREBY CERTIFY THAT THIS PLAT IS CORRECT TO THE BEST OF MY KNOWLEDGE AND BELIEF AND SHOWS ALL THE INFORMATION REQUIRED BY LAW AND THE REGULATIONS ISSUED AND PRESCRIBED BY THE DEPARTMENT OF MINES.
 (SIGNED) [Signature]
 R.P.E. _____ L.L.S. 69

DATE Oct 24, 19 79
 OPERATOR'S WELL NO. _____
 APIWELL NO. 47 - 057 - 0030 - P
 STATE COUNTY PERMIT

(+) DENOTES LOCATION OF WELL ON UNITED STATES TOPOGRAPHIC MAPS
 FORM IV-6 (3-78)
 STATE OF WEST VIRGINIA
 DEPARTMENT OF MINES
 OIL AND GAS DIVISION
 WELL TYPE: OIL ___ GAS LIQUID INJECTION ___ WASTE DISPOSAL ___
 (IF "GAS,") PRODUCTION STORAGE ___ DEEP ___ SHALLOW ___
 LOCATION: ELEVATION 793.18 WATERSHED Patterson Creek
 DISTRICT Cabin Run COUNTY Mineral
 QUADRANGLE Burlington, KEYSER 15'
 SURFACE OWNER Jobbie DiRocco ACREAGE 133
 OIL & GAS ROYALTY OWNER Jobbie DiRocco LEASE ACREAGE 133
 LEASE NO. _____
 PROPOSED WORK: DRILL CONVERT ___ DRILL DEEPER ___ REDRILL ___ FRACTURE OR STIMULATE ___ PLUG OFF OLD FORMATION ___ PERFORATE NEW FORMATION ___ OTHER PHYSICAL CHANGE IN WELL (SPECIFY) _____
 PLUG AND ABANDON ___ CLEAN OUT AND REPLUG ___
 TARGET FORMATION Oriskany Sand ESTIMATED DEPTH T.D. 2400' ±
 WELL OPERATOR Upland Resources DESIGNATED AGENT TROY A BRADY JR.
 ADDRESS 1700 Benedum-Trees Building ADDRESS P.O. Bx 371
Pittsburgh, Pa. 15222 BUCK HANNOH V/V 26201

MAY 17 1982

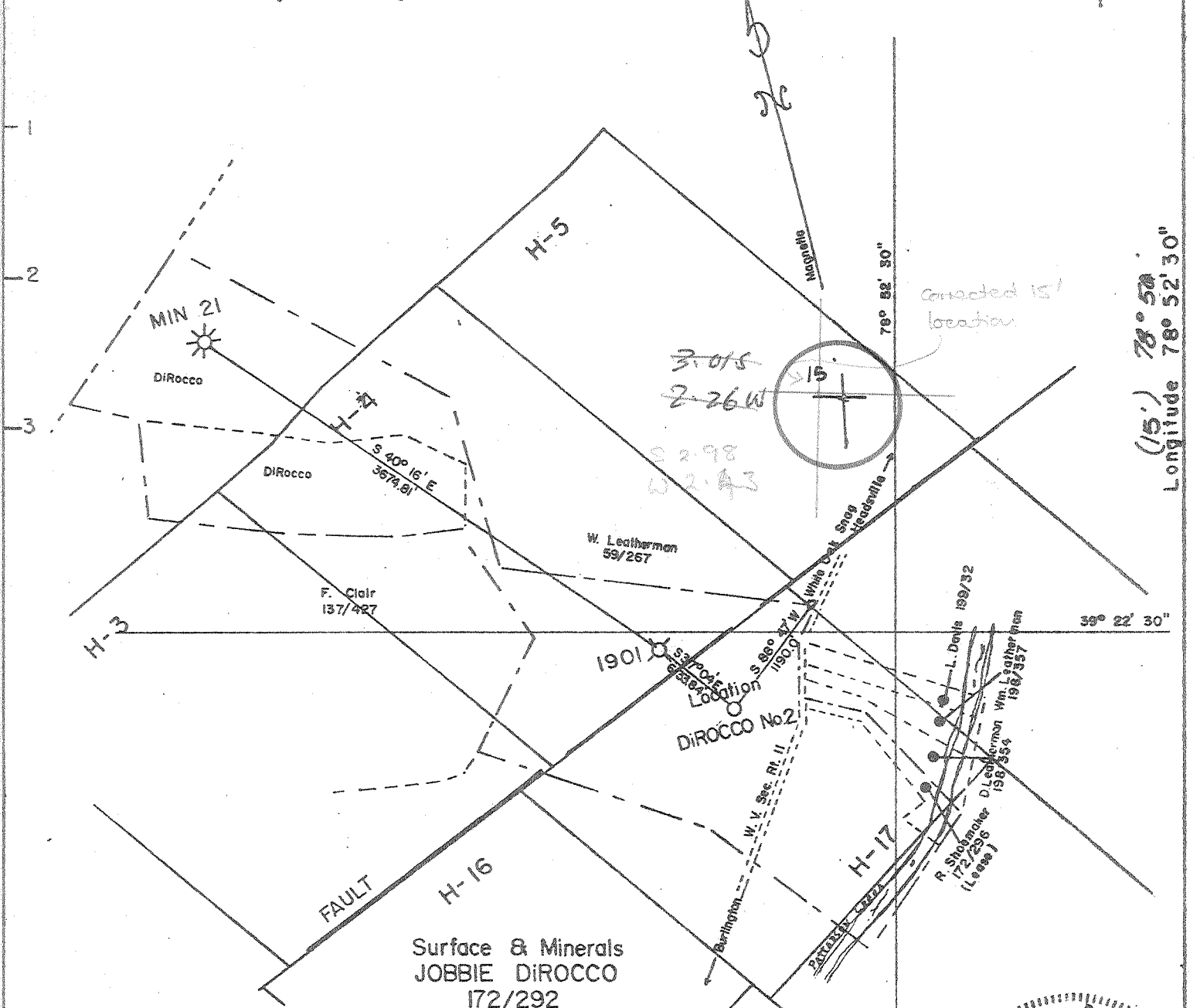

FILE NO. _____
 DRAWING NO. _____
 SCALE 1" = 1000'
 MINIMUM DEGREE OF ACCURACY 1 in 200
 PROVEN SOURCE OF ELEVATION B.M. on Headsville Bridge - El. 686

I THE UNDERSIGNED, HEREBY CERTIFY THAT THIS PLAT IS CORRECT TO THE BEST OF MY KNOWLEDGE AND BELIEF AND SHOWS ALL THE INFORMATION REQUIRED BY LAW AND THE REGULATIONS ISSUED AND PRESCRIBED BY THE DEPARTMENT OF MINES.
 (SIGNED) Charles L. Logsdon
 R.P.E. _____ L.L.S. 69

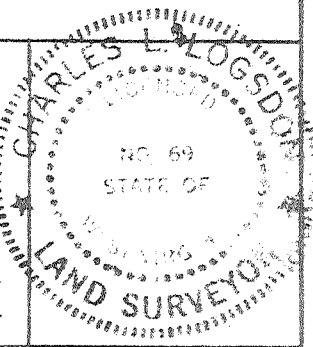

(+) DENOTES LOCATION OF WELL ON UNITED STATES TOPOGRAPHIC MAPS

DATE Oct 24, 19 79

OPERATOR'S WELL NO. _____

API WELL NO. 47 - 057 - 0030

STATE COUNTY: _____ PERMIT _____

FORM IV-6 (8-78)

STATE OF WEST VIRGINIA
 DEPARTMENT OF MINES
 OIL AND GAS DIVISION

WELL TYPE: OIL ___ GAS LIQUID INJECTION ___ WASTE DISPOSAL ___
 (IF "GAS,") PRODUCTION STORAGE ___ DEEP ___ SHALLOW ___

LOCATION: ELEVATION 793.18 WATER SHED Patterson Creek
 DISTRICT Cabin Run COUNTY Mineral
 QUADRANGLE Burlington, KEYSER 15' C

SURFACE OWNER Jobbie DiRocco ACREAGE 133
 OIL & GAS ROYALTY OWNER Jobbie DiRocco LEASE ACREAGE 133
 LEASE NO. _____

PROPOSED WORK: DRILL CONVERT ___ DRILL DEEPER ___ REDRILL ___ FRACTURE OR STIMULATE ___ PLUG OFF OLD FORMATION ___ PERFORATE NEW FORMATION ___ OTHER PHYSICAL CHANGE IN WELL (SPECIFY) _____

PLUG AND ABANDON ___ CLEAN OUT AND REPLUG ___
 TARGET FORMATION Oriskany Sand ESTIMATED DEPTH T.D. 2400' ±
 WELL OPERATOR Upland Resources DESIGNATED AGENT TROY A. BRADY, JR.
 ADDRESS 1700 Benedum-Tress Building ADDRESS P.O. Bx 371
Pittsburgh, Pa. 15222 Buckhannon WV 26201

NOV 14 1979

Deep Well 6-6 Headsville (302)



W 1 N 30

STATE OF WEST VIRGINIA
DEPARTMENT OF MINES JUL - 9 1981

Oil and Gas Division

WELL RECORD

Quadrangle BURLINGTON
Permit No. 47-057-0030

Rotary _____ Oil _____
Cable XX Gas XX
Recycling _____ Comb. _____
Water Flood _____ Storage _____
Disposal _____ (Kind) _____

Company Upland Resources, c/o Huntley & Huntley, Inc.
Address 1700 Benedum-Trees Bldg., Pgh. Pa. 15222
Farm DiRocco Acres 133
Location (waters) Patterson Creek
Well No. 2 Elev. 793
District Cabin Run County Mineral
The surface of tract is owned in fee by Jobbie & Georgia DiRocco
Address 1705 S. Cleve. Mass. Rd., Copley, Ohio
Mineral rights are owned by Same as above 44321
Address _____
Drilling Commenced 11/22/79
Drilling Completed 12/20/79
Initial open flow -0- cu. ft. -0- bbls.
Final production 73 M cu. ft. per day _____ bbls.
Well open 24 hrs. before test 460# RP.

Casing and Tubing	Used in Drilling	Left in Well	Cement fill up Cu. ft. (Sks.)
Size 20-16			
Cond. 13-10"			
9 5/8			
8 5/8	403'	403'	Cemented to Surface
7			
5 1/2			
4 1/2	1770'	1770'	Cemented to Surface
3			
2			
Lines Used			

Well treatment details: Attach copy of cementing record.
Well fraced and acidized by Halliburton, Hydrochloric -2-21 Gel, 29,000 nitrogen, 30,000 500 barrels water, 1,000 gal acid.
73 MCF

Coal was encountered at No Coal Feet _____ Inches _____
Fresh water 85' Feet _____ Salt Water _____ Feet _____
Producing Sand Oriskany Depth 1571-1690

Formation	Color	Hard or Soft	Top Feet	Bottom Feet	Oil, Gas or Water	* Remarks
Gamma Ray Log:						
Sand & Shale			0	1,276'		Water at 85'
Selinsgrove			1,276'	1,366'		
Marcellus			1,366'	1,434'		
Tioga Metabentonite			1,434'	1,451'		
Onondaga Limestone			1,451'	1,504'		
Needmore Shale			1,504'	1,571'		
Oriskany			1,571'	1,690'		Show gas at 1,572'
Helderberg Limestone			1,690'	--		Show gas at 1,694'
		TOTAL DEPTH		1,700'		
						btm 4 1/2 1770 log to 1786

* Indicates Electric Log tops in the remarks section.

(over)



STATE OF WEST VIRGINIA
DEPARTMENT OF MINES

SEP 26 1979

Oil and Gas Division

OIL AND GAS WELL PERMIT APPLICATION

TO THE DEPARTMENT OF MINES,
Charleston, W. Va.

DATE September 26, 1979
Upland Resources, Inc.
Company c/o Huntley & Huntley, Inc.
Address 1700 Benedum-Trees Bldg., Pitt. Pa.
Farm Jobbie & G. Di Rocco Acres 133 15222
Location (waters) Patterson Creek
Well No. 2 Elevation 793
District Cabin Run County Mineral
Quadrangle Burlington

Surface Owner Jobbie & Georgia Di Rocco
Address 1705 S. Cleve. Mass. Rd., Copley, OH 44321
Mineral Owner Same as above
Address _____
Coal Owner No Coal
Address _____
Coal Operator NA
Address _____

THIS PERMIT MUST BE POSTED AT THE WELL SITE

All provisions being in accordance with Chapter 22,
of the W. Va. Code, the location is hereby approved
for drilling. This permit shall expire if
operations have not commenced by 6-30-80.

INSPECTOR
TO BE NOTIFIED Robert S. Stewart
ADDRESS P. O. Box 345, Jane Lew, W.Va. 26378
PHONE 304-884-7782

[Signature]
Deputy Director - Oil & Gas Division

GENTLEMEN:

The undersigned well operator is entitled to drill upon the above named farm or tract of land for oil and gas, having fee title thereto, (or as the case may be) under grant or lease dated May 24 1978 by Jobbie & Georgia Di Rocco made to Upland Resources, Inc. and recorded on the 8 th day of June 1978, in Mineral County, Book 210 Page 638
XXX NEW WELL _____ DRILL DEEPER _____ REDRILL _____ FRACTURE OR STIMULATE
_____ OIL AND GAS WELL ORIGINALLY DRILLED BEFORE JUNE 5, 1969.

The enclosed plat was prepared by a registered engineer or licensed land surveyor and all coal owners and/or operators have been notified as of the above date.

The above named coal owners and/or operator are hereby notified that any objection they wish to make, or are required to make by Section 3 of the Code, must be received by, or filed with the Department of Mines within ten (10) days.*

Copies of this notice and the enclosed plat were mailed by registered mail, or delivered to the above named coal operators or coal owners at their above shown respective address _____ day _____ before, or on the same day with the mailing or delivery of this copy to the Department of Mines at Charleston, West Virginia.

Huntley & Huntley, Inc., Agents for
Very truly yours, Robert Stewart
(Sign Name) _____
Well Operator President

PLEASE SUBMIT COPIES OF ALL
GEOPHYSICAL LOGS DIRECTLY TO:

WEST VIRGINIA GEOLOGICAL AND
ECONOMIC SURVEY
P. O. BOX 879
MORGANTOWN, WEST VIRGINIA 26505
AC-304 - 292-6331

Address _____
of _____
Well Operator _____
1700 Benedum-Trees Bldg.
Street _____
Pittsburgh
City or Town _____
Pennsylvania 15222
State _____

*SECTION 3 . . . If no objections are filed or found by the Department of mines, within said period of ten days from the receipt of notice and plat by the department of mines, to said proposed location, the department shall forthwith issue to the well operator a permit reciting the filing of such plat, that no objections have been made by the coal operators or found thereto by the department and that the same is approved and the well operator authorized to proceed.

BLANKET DONE

47-057-0030 PERMIT NUMBER

"I have read and understand the reclamation requirements as set forth in Chapter 22, Article 4, Section 12-b and will carry out the specified requirements."
Signed by Robert Stewart

THIS IS AN ESTIMATE ONLY
ACTUAL INFORMATION WILL BE SUBMITTED ON OG-10 UPON COMPLETION

PROPOSED WORK ORDER TO XXX DRILL _____ DEEPEN _____ FRACTURE-STIMULATE _____
 DRILLING CONTRACTOR: (If Known) _____ RESPONSIBLE AGENT: _____
 NAME Talkington-Brady, Inc. NAME Troy A. Brady, Jr.
 ADDRESS P.O. Box 371, Buckhannon, W.Va. 26201 ADDRESS P.O. Box 371, Buckhannon, W.Va. 26201
 TELEPHONE 304-472-4677 TELEPHONE 304-472-4677
 ESTIMATED DEPTH OF COMPLETED WELL: 2400' ROTARY _____ CABLE TOOLS XXX
 PROPOSED GEOLOGICAL FORMATION: Oriskany
 TYPE OF WELL: OIL _____ GAS XXX COMB. _____ STORAGE _____ DISPOSAL _____
 RECYCLING _____ WATER FLOOD _____ OTHER _____

TENTATIVE CASING PROGRAM:

CASING AND TUBING SIZE	USED FOR DRILLING	LEFT IN WELL	CEMENT FILL UP OR SACKS - CUBIC FT.
20 - 16			
13 - 10			
9 - 5/8			
8 - 5/8	400'	400'	Cement to surface
7			
5 1/2			
4 1/2	2400'	2400'	Cement to surface
3			Perf. Top
2			Perf. Bottom
Lines			Perf. Top
			Perf. Bottom

APPROXIMATE FRESH WATER DEPTHS 50'-80' FEET _____ SALT WATER Non expected FEET _____
 APPROXIMATE COAL DEPTHS 200-250 No. Coal _____
 IS COAL BEING MINED IN THE AREA? No BY WHOM? _____

TO DRILL:

SUBMIT FIVE (5) COPIES OF OG - 1, \$100.00 PERMIT FEE, PERFORMANCE BOND AND PERMANENT COPY OF PLAT.

TO DRILL DEEPER OR REDRILL:

SUBMIT FIVE (5) COPIES OF OG - 1, SHOWING ORIGINAL PERMIT NUMBER AND PERFORMANCE BOND. ON WELLS DRILLED PRIOR TO 1929, A PERMANENT COPY OF THE PLAT AND THE ORIGINAL WELL RECORD MUST ALSO BE SUBMITTED.

TO FRACTURE - STIMULATE:

OIL AND/OR GAS WELL ORIGINALLY DRILLED BEFORE JUNE 5, 1929, FIVE (5) COPIES OG - 1, PERFORMANCE BOND, PERMANENT PLAT AND ORIGINAL WELL RECORD.

OIL AND/OR GAS WELL ORIGINALLY DRILLED ON AND/OR AFTER JUNE 5, 1929. FIVE COPIES OG - 1, SHOWING ORIGINAL PERMIT NUMBER, AND PERFORMANCE BOND.

Required forms must be filed within ninety (90) days of completion for bond release. Inspector to be notified twenty-four (24) hours in advance.

The following waiver must be completed by the coal operator if the permit is to be issued within ten days of receipt thereof.

WAIVER: I the undersigned, Agent for _____ Coal Company, Owner or Operator of the coal under this lease have examined and place on our mine maps this proposed well location.

We the _____ Coal Company have no objections to said well being drilled at this location, providing operator has complied with all rules and regulations in Articles 4, 5, and 7, Chapter 22 of the West Virginia Code.

For Coal Company

Official Title

RECEIVED
Environmental Protection

STATE OF WEST VIRGINIA
DIVISION OF ENVIRONMENTAL PROTECTION
SECTION OF OIL AND GAS

MAY 3 1 94 AFFIDAVIT OF PLUGGING AND FILLING WELL

AFFIDAVIT SHOULD BE IN TRIPLICATE, one copy mailed to the Division, one copy to be retained by the Well Operator and the third copy (and extra copies if required) should be mailed to each coal operator at their respective addresses.

Farm name: DiROCCO, JOBBIE Operator Well No.: DiROCCO #2

LOCATION: Elevation: 793.18 Quadrangle: HEADSVILLE
District: CABIN RUN County: MINERAL
Latitude: 500 Feet South of 39 Deg. 22 Min. 30 Sec.
Longitude 1100 Feet West of 78 Deg. 52 Min. 30 Sec.

Well Type: OIL _____ GAS x

Company: Upland Resources Coal Operator N.A.
PO Box 429 or Owner _____
Keyser, WV 26726 _____

Agent: Ralph Webb Coal Operator N.A.
or Owner _____

Permit Issued: 12/13/93

AFFIDAVIT

STATE OF WEST VIRGINIA,
County of Upshur ss:

Robert L. Wharton and Thearl Clutter being first duly sworn according to law depose and say that they are experienced in the work of plugging and filling oil and gas wells and were employed by the above named well operator, and participated in the work of plugging and filling the above well, and Phillip Tracy Oil and Gas Inspector representing the Director, say that said work was commenced on the _____ day of February, 1994, and that the well was plugged and filled in the following manner:

TYPE	FROM	TO	PIPE REMOVED	LEFT
Set Bridge Plug at 1495 ft.				
Cement	100	0		
6% Gel in Hole				

Handwritten signature and date: 6/1/94

Description of monument: Erect 6" casing 30" above ground with ID per DOE Reg. and that the work of plugging and filling said well was completed on the 4th day of February, 1994.

And further deponents saith not.

Sworn and subscribe before me this 18th day of February, 1994
My commission expires: November 3, 2003

R L Wharton
Thearl Clutter
Gene Murray
Notary Public

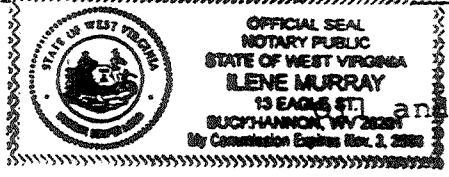

Gas Inspector: Phillip Tracy JUN 3 1994