

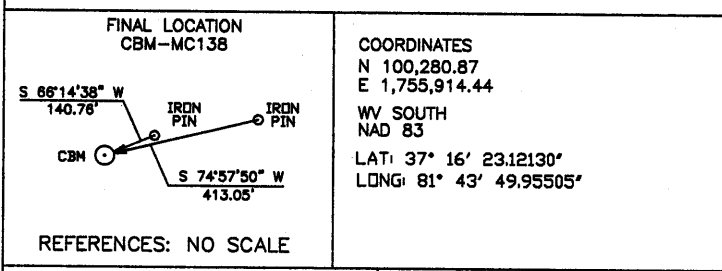

FINAL LOCATION  
CBM-MC138



FILE NO. \_\_\_\_\_  
DRAWING NO. \_\_\_\_\_  
SCALE 1" = 2000'  
MINIMUM DEGREE OF ACCURACY 1: 2,500  
PROVEN SOURCE OF ELEVATION SURVEYED

I THE UNDERSIGNED, HEREBY CERTIFY THAT THIS PLAT IS CORRECT TO THE BEST OF MY KNOWLEDGE AND BELIEF AND SHOWS ALL THE INFORMATION REQUIRED BY LAW AND THE REGULATIONS ISSUED AND PRESCRIBED BY THE DEPARTMENT OF MINES.  
(SIGNED) [Signature] 12/30/11  
R.P.E. \_\_\_\_\_ L.L.S. \_\_\_\_\_

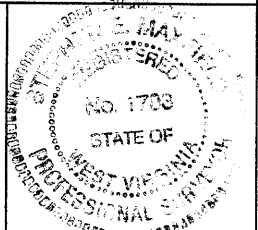

(+) DENOTES LOCATION OF WELL ON UNITED STATES TOPOGRAPHIC MAPS  
FORM IV-6  
(8-78)



DATE DECEMBER 27, 2011  
OPERATOR'S WELL NO. CBM-MC138  
API WELL NO. 47-047-02821  
STATE \_\_\_\_\_ COUNTY \_\_\_\_\_ PERMIT \_\_\_\_\_

Division of Environmental Protection  
Office of Oil & Gas

WELL TYPE: OIL  GAS  LIQUID INJECTION  WASTE DISPOSAL   
IF "GAS": PRODUCTION  STORAGE  DEEP  SHALLOW   
LOCATION: ELEVATION 2267.18' WATER SHED LITTLE SLATE CR., DRY FORK CR. OF TUG RIVER  
DISTRICT BIG CREEK COUNTY MCDOWELL  
QUADRANGLE WAR  
SURFACE OWNER BERWIND LAND COMPANY ACREAGE 718.40  
OIL & GAS ROYALTY OWNER BERWIND LAND COMPANY LEASE ACREAGE 31.425.18  
LEASE NO. 490001  
PROPOSED WORK: DRILL  CONVERT  DRILL DEEPER  REDRILL  FRACTURE OR STIMULATE  PLUG OFF OLD FORMATION  PERFORATE NEW FORMATION  OTHER PHYSICAL CHANGE IN WELL (SPECIFY) \_\_\_\_\_  
PLUG AND ABANDON  CLEAN OUT AND REPLUG   
TARGET FORMATION \_\_\_\_\_ ESTIMATED DEPTH \_\_\_\_\_  
WELL OPERATOR CNX GAS COMPANY LLC DESIGNATED AGENT Kent Wright  
ADDRESS 2481 JOHN NASH BLVD. BLUEFIELD, WV 24701 ADDRESS One Dominion Drive P.O. Box 1248 Jane Lew, WV 26378 Phone 304-884-2158

WV GEOLOGICAL SURVEY  
MORGANTOWN, WV

MAY 3 2012

RECEIVED